

# AIF In-Line Centrifugal Duct Fans

4" to 14"

147 to 1400 CFM



## Features/Specifications:

- 5 year warranty
- Heavy gauge, drawn steel housing with baked epoxy finish
- Low noise and vibration
- Maintenance free/smooth operation
- Automatic reset thermal overload protection
- 120V operation, other voltages available
- 100% speed controllable
- CUL Listed

## Fan Component:

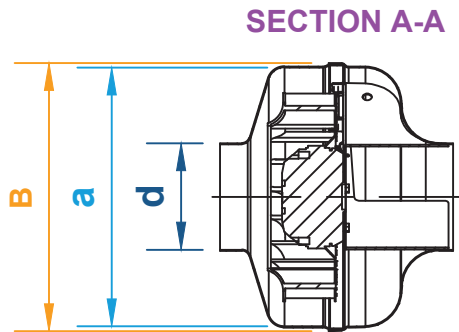
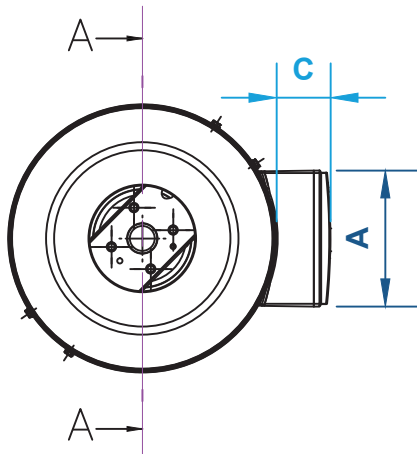
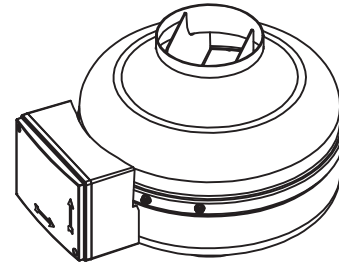
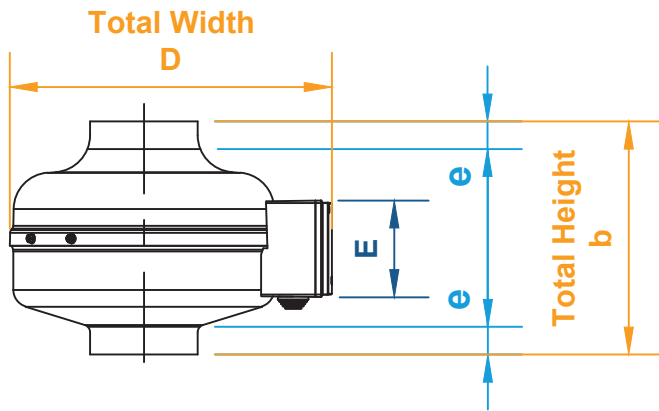

Model	a	b	d	e	A	B	C	D	E	Ship Wt. (lbs)
AIF100A ES	9.5	8.3	3.9	1.0	4.9	9.8	2.2	11.7	3.5	7.5
AIF100B	9.5	8.3	3.9	1.0	4.9	9.8	2.2	11.7	3.5	8.0
AIF125A ES	9.5	8.3	4.8	1.0	4.9	9.8	2.2	11.7	3.5	7.5
AIF125B	9.5	8.3	4.8	1.0	4.9	9.8	2.2	11.7	3.5	7.5
AIF150A ES	9.5	8.3	5.8	1.0	4.9	9.8	2.2	11.7	3.5	7.5
AIF150B ES	13.2	9.1	5.8	1.0	4.9	13.5	2.2	15.4	3.5	12.5
AIF200A ES	13.2	9.1	7.8	1.0	4.9	13.5	2.2	15.4	3.5	12.0
AIF200B ES	13.2	9.1	7.8	1.0	4.9	13.5	2.2	15.4	3.5	15.0
AIF250 ES	13.2	9.1	9.8	1.0	4.9	13.5	2.2	15.4	3.5	15.0
AIF300A ES	15.9	11.8	11.8	1.2	4.9	16.2	2.2	18.1	3.5	18.0
AIF300B ES	15.9	11.8	11.8	1.2	4.9	16.2	2.2	18.1	3.5	18.0



**Performance/Information:**

EDP #	Catalog No.	Watts	RPM	Capacity (CFM) @ "S.P."								
				0	0.2	0.4	0.6	0.8	1.0	1.2	1.5	2
23202	AIF100A ES	43.5	2580	147	130	107	82	57	34	11		
23190	AIF100B	83.4	2620	150	140	127	112	94	74	53	23	
23203	AIF125A ES	44.4	2520	179	150	121	87	49	14			
23191	AIF125B	85.4	2750	183	160	141	122	101	77	51	14	
23204	AIF150A ES	46.8	2390	235	190	148	97	44				
23192	AIF150B ES	89.2	2450	308	260	216	175	139	108	81	47	
23205	AIF200A ES	84.5	2500	368	300	234	184	149	114	70		
23193	AIF200B ES	188	2550	579	520	453	387	329	282	245	206	154
23206	AIF250 ES	197	2470	616	550	488	431	379	330	286	227	143
23207	AIF300A ES	206	2450	780	700	595	420	330	290	255	210	132
23194	AIF300B ES	312	2780	970	910	803	680	559	453	367	273	164

**AIF In-Line Duct Fan Accessories**

EDP #	Catalog No.	Ship Wt.	Description
23201	PS-DB	1.5	Pressure Sensing Switch Kit
24855	485210	1	Variable Speed Controller, 1 Phase, 5 amp speed control
23163	DF-4	1	4" Diffuser Vent
23177	DF-5	1	5" Diffuser Vent
23164	DF-6	1	6" Diffuser Vent
23170	DF-8	1.4	8" Diffuser Vent
23180	DF-10	1.8	10" Diffuser Vent
23179	DF-12	2	12" Diffuser Vent
23165	BD-4	1	4" Backdraft Hamper
23166	BD-6	1	6" Backdraft Hamper
23171	BD-8	1.2	8" Backdraft Hamper
23172	BD-10	1.4	10" Backdraft Hamper
23178	BD-12	1.6	12" Backdraft Hamper

**Ordering:**

Fan No.	EDP #	Qty.	Catalog No.	CFM	RPM	Watts	Pressure	Comments

Project		Location	
Engineer		Contractor	

Submitted by		Date		Approved by		Date	
--------------	--	------	--	-------------	--	------	--