

## ARMSTRONG® 3/8" Drive Locking Extensions

- Made in the USA - Quality and Availability
- Knurling on the Extension Shaft Provides a Non-Slip Grip to Quickly Run Down / Remove Fasteners
- Socket is Securely Locked to the Extension and Will Not Disengage Until Knurled Sleeve is Pulled, Safety and Convenience



| Cat. No. | UPC No.      | Packaging | Length    | Wobble | Product Weight | Shelf Pack Qty. |
|----------|--------------|-----------|-----------|--------|----------------|-----------------|
| 11-934   | 781412119343 | Bagged    | 3.000 in  | No     | 0.20 lb        | 1               |
| 11-936   | 781412119367 | Bagged    | 6.000 in  | No     | 0.37 lb        | 1               |
| 11-937   | 781412119374 | Bagged    | 8.000 in  | No     | 0.49 lb        | 1               |
| 11-939   | 781412119398 | Bagged    | 12.000 in | No     | 0.73 lb        | 1               |

## ARMSTRONG® 3/8" Drive 6 and 12 Point SAE Standard Length Sockets

- Made in the USA - Quality and Availability
- Radius Corner Design Engages the Flats of the Fastener, Not the Corners, Providing Up to 15% -20% More Torque While Reducing Fastener Rounding, Enhancing the Turning of Worn Fasteners
- EYE-D™ Markings Optimize Size Visibility, Also Providing SAE / Metric Differentiation
- Unique Socket Retention Method, Cold Form Ball Recess, Provides Consistent Secure Retention of the Socket to the Drive Tool Eliminating the Possibility of Either a Loose Fit or Tight Fit
- Socket Wall Dimensions are Optimized to Provide Strength While Retaining Access to Restricted Fasteners
- Meets or Exceeds ASME B107.1-2002 and US Federal Spec. GGG-W-641 E

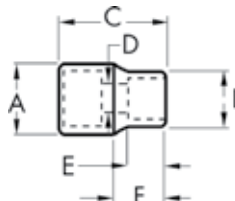

| Cat. No. | UPC No.      | Packaging | Drive Type | Fastener Size | Dim. A: Drive End | Dim. B: Wrench End | Dim. C: Overall Length | Dim. D: Bolt Clearance | Dim. E: Wrench Depth | Dim. F: Length to Shoulder | Product Weight | Shelf Pack Qty. |
|----------|--------------|-----------|------------|---------------|-------------------|--------------------|------------------------|------------------------|----------------------|----------------------------|----------------|-----------------|
| 11-008D  | 781412110081 | Bagged    | 6 Point    | 1/4 in        | 0.658 in          | 0.414 in           | 0.938 in               | 0.170 in               | 0.166 in             | 0.438 in                   | 0.04 lb        | 1               |
| 11-010D  | 781412110104 | Bagged    | 6 Point    | 5/16 in       | 0.658 in          | 0.458 in           | 0.938 in               | 0.319 in               | 0.166 in             | 0.438 in                   | 0.05 lb        | 1               |
| 11-011D  | 781412110111 | Bagged    | 6 Point    | 11/32 in      | 0.658 in          | 0.518 in           | 0.938 in               | 0.300 in               | 0.235 in             | 0.438 in                   | 0.05 lb        | 1               |
| 11-012D  | 781412110128 | Bagged    | 6 Point    | 3/8 in        | 0.658 in          | 0.560 in           | 0.938 in               | 0.381 in               | 0.224 in             | 0.438 in                   | 0.05 lb        | 1               |
| 11-014D  | 781412110142 | Bagged    | 6 Point    | 7/16 in       | 0.655 in          | 0.655 in           | 0.938 in               | 0.443 in               | 0.250 in             | -                          | 0.05 lb        | 1               |
| 11-016D  | 781412110166 | Bagged    | 6 Point    | 1/2 in        | 0.724 in          | 0.724 in           | 0.968 in               | 0.507 in               | 0.275 in             | -                          | 0.07 lb        | 1               |
| 11-018D  | 781412110180 | Bagged    | 6 Point    | 9/16 in       | 0.777 in          | 0.777 in           | 0.968 in               | 0.570 in               | 0.460 in             | -                          | 0.07 lb        | 1               |
| 11-020D  | 781412110203 | Bagged    | 6 Point    | 5/8 in        | 0.862 in          | 0.862 in           | 1.013 in               | 0.638 in               | 0.500 in             | -                          | 0.09 lb        | 1               |
| 11-022   | 781412110227 | Bagged    | 6 Point    | 11/16 in      | 0.952 in          | 0.952 in           | 1.013 in               | 0.696 in               | 0.500 in             | -                          | 0.10 lb        | 1               |
| 11-024   | 781412110241 | Bagged    | 6 Point    | 3/4 in        | 1.001 in          | 1.001 in           | 1.128 in               | 0.759 in               | 0.660 in             | -                          | 0.14 lb        | 1               |
| 11-026D  | 781412110265 | Bagged    | 6 Point    | 13/16 in      | 1.076 in          | 1.076 in           | 1.128 in               | 0.828 in               | 0.680 in             | -                          | 0.15 lb        | 1               |
| 11-028D  | 781412110289 | Bagged    | 6 Point    | 7/8 in        | 1.167 in          | 1.167 in           | 1.250 in               | 0.884 in               | 0.750 in             | -                          | 0.22 lb        | 1               |
| 11-030   | 781412110302 | Bagged    | 6 Point    | 15/16 in      | 1.250 in          | 1.250 in           | 1.240 in               | 0.906 in               | 0.760 in             | -                          | 0.28 lb        | 1               |
| 11-032D  | 781412110326 | Bagged    | 6 Point    | 1 in          | 1.310 in          | 1.310 in           | 1.378 in               | 0.980 in               | 0.800 in             | -                          | 0.28 lb        | 1               |
| 11-108   | 781412111088 | Bagged    | 12 Point   | 1/4 in        | 0.660 in          | 0.417 in           | 0.938 in               | 0.170 in               | 0.165 in             | 0.438 in                   | 0.04 lb        | 1               |
| 11-110   | 781412111101 | Bagged    | 12 Point   | 5/16 in       | 0.660 in          | 0.458 in           | 0.938 in               | 0.319 in               | 0.166 in             | 0.438 in                   | 0.05 lb        | 1               |
| 11-111   | 781412111118 | Bagged    | 12 Point   | 11/32 in      | 0.660 in          | 0.586 in           | 0.960 in               | 0.351 in               | 0.275 in             | 0.438 in                   | 0.05 lb        | 1               |
| 11-112D  | 781412111125 | Bagged    | 12 Point   | 3/8 in        | 0.660 in          | 0.560 in           | 0.938 in               | 0.381 in               | 0.224 in             | -                          | 0.05 lb        | 1               |
| 11-114D  | 781412111149 | Bagged    | 12 Point   | 7/16 in       | 0.655 in          | 0.655 in           | 0.938 in               | 0.443 in               | 0.250 in             | -                          | 0.05 lb        | 1               |

| Cat. No. | UPC No.      | Packaging | Drive Type | Fastener Size | Dim. A: Drive End | Dim. B: Wrench End | Dim. C: Overall Length | Dim. D: Bolt Clearance | Dim. E: Wrench Depth | Dim. F: Length to Shoulder | Product Weight | Shelf Pack Qty. |
|----------|--------------|-----------|------------|---------------|-------------------|--------------------|------------------------|------------------------|----------------------|----------------------------|----------------|-----------------|
| 11-116D  | 781412111163 | Bagged    | 12 Point   | 1/2 in        | 0.724 in          | 0.724 in           | 0.968 in               | 0.507 in               | 0.275 in             | -                          | 0.07 lb        | 1               |
| 11-118D  | 781412111187 | Bagged    | 12 Point   | 9/16 in       | 0.777 in          | 0.777 in           | 0.968 in               | 0.570 in               | 0.460 in             | -                          | 0.07 lb        | 1               |
| 11-119   | 781412111194 | Bagged    | 12 Point   | 19/32 in      | 0.863 in          | 0.863 in           | 1.013 in               | 0.602 in               | 0.500 in             | -                          | 0.09 lb        | 1               |
| 11-120   | 781412111200 | Bagged    | 12 Point   | 5/8 in        | 0.862 in          | 0.862 in           | 1.013 in               | 0.633 in               | 0.500 in             | -                          | 0.10 lb        | 1               |
| 11-122   | 781412111224 | Bagged    | 12 Point   | 11/16 in      | 0.952 in          | 0.952 in           | 1.013 in               | 0.696 in               | 5.000 in             | -                          | 0.14 lb        | 1               |
| 11-124   | 781412111248 | Bagged    | 12 Point   | 3/4 in        | 1.003 in          | 1.003 in           | 1.128 in               | 0.759 in               | 0.660 in             | -                          | 0.15 lb        | 1               |
| 11-126   | 781412111262 | Bagged    | 12 Point   | 13/16 in      | 1.076 in          | 1.076 in           | 1.128 in               | 0.821 in               | 0.680 in             | -                          | 0.22 lb        | 1               |
| 11-128   | 781412111286 | Bagged    | 12 Point   | 7/8 in        | 1.167 in          | 1.167 in           | 1.250 in               | 0.884 in               | 0.750 in             | -                          | 0.28 lb        | 1               |
| 11-130   | 781412111309 | Bagged    | 12 Point   | 15/16 in      | 1.250 in          | 1.250 in           | 1.240 in               | 0.906 in               | 0.760 in             | -                          | 0.28 lb        | 1               |
| 11-132   | 781412111323 | Bagged    | 12 Point   | 1 in          | 1.310 in          | 1.310 in           | 1.378 in               | 0.980 in               | 0.800 in             | -                          | 0.28 lb        | 1               |

## ARMSTRONG® 3/8" Drive 12 Point SAE AS954 Standard Length Aerospace Sockets

- Made in the USA - Quality and Availability
- Meets or Exceeds Aerospace Standard ASME AS954E-2004
- Radius Corner Design Engages the Flats of the Fastener, Not the Corners, Providing Up to 15% -20% More Torque While Reducing Fastener Rounding, Enhancing the Turning of Worn Fasteners
- Thinner Socket Wall Dimensions Provide Increased Access to Restricted Fasteners with No Loss in Socket Strength
- Bolt Clearance Holes Have Larger Diameters and Depths to Accommodate a Wider Variety of Fasteners
- Special Plating Process Prevents Corrosion Under the Harshlest of Conditions
- Unique Socket Retention Method, Cold Form Ball Recess, Provides Consistent Secure Retention of the Socket to the Drive Tool Eliminating the Possibility of Either a Loose Fit or Tight Fit



| Cat. No. | UPC No.      | Packaging | Drive Type | Fastener Size | Dim. A: Drive End | Dim. B: Wrench End | Dim. C: Overall Length | Dim. D: Bolt Clearance | Dim. E: Wrench Depth | Dim. F: Length to Shoulder | Product Weight | Shelf Pack Qty. |
|----------|--------------|-----------|------------|---------------|-------------------|--------------------|------------------------|------------------------|----------------------|----------------------------|----------------|-----------------|
| 36-312   | 781412363128 | Bagged    | 12 Point   | 3/8 in        | 0.656 in          | 0.544 in           | 1.013 in               | 0.32 in                | 0.28 in              | 0.495 in                   | 0.04 lb        | 1               |
| 36-314   | 781412363142 | Bagged    | 12 Point   | 7/16 in       | 0.654 in          | 0.654 in           | 1.128 in               | 0.39 in                | 0.38 in              | -                          | 0.05 lb        | 1               |
| 36-316   | 781412363166 | Bagged    | 12 Point   | 1/2 in        | 0.724 in          | 0.724 in           | 1.128 in               | 0.455 in               | 0.38 in              | -                          | 0.06 lb        | 1               |
| 36-318   | 781412363180 | Bagged    | 12 Point   | 9/16 in       | 0.777 in          | 0.777 in           | 1.193 in               | 0.545 in               | 0.58 in              | -                          | 0.06 lb        | 1               |
| 36-320   | 781412363203 | Bagged    | 12 Point   | 5/8 in        | 0.862 in          | 0.862 in           | 1.303 in               | 0.617 in               | 0.74 in              | -                          | 0.08 lb        | 1               |
| 36-322   | 781412363227 | Bagged    | 12 Point   | 11/16 in      | 0.952 in          | 0.952 in           | 1.378 in               | 0.672 in               | 0.8 in               | -                          | 0.11 lb        | 1               |
| 36-324   | 781412363241 | Bagged    | 12 Point   | 3/4 in        | 1.002 in          | 1.002 in           | 1.503 in               | 0.735 in               | 0.93 in              | -                          | 0.13 lb        | 1               |
| 36-326   | 781412363265 | Bagged    | 12 Point   | 13/16 in      | 1.076 in          | 1.076 in           | 1.563 in               | 0.798 in               | 1.03 in              | -                          | 0.14 lb        | 1               |
| 36-328   | 781412363289 | Bagged    | 12 Point   | 7/8 in        | 1.167 in          | 1.167 in           | 1.745 in               | 0.78 in                | 0.9 in               | -                          | 0.21 lb        | 1               |
| 36-330   | 781412363302 | Bagged    | 12 Point   | 15/16 in      | 1.244 in          | 1.244 in           | 1.76 in                |                        | 1.188 in             | -                          | 0.24 lb        | 1               |
| 36-332   | 781412363326 | Bagged    | 12 Point   | 1 in          | 1.307 in          | 1.307 in           | 1.759 in               | 1.005 in               | 1.232 in             | -                          | 0.28 lb        | 1               |