

Wiedergabe einer Vereinfachung dieses Dokuments, Verändern und Mithaltung eines Inhalts sind
verboten, soweit nicht ausdrücklich gestattet. Zuwiderhandlungen verpflichten zu Schadenersatz. Alle
Rechte für den Fall der Patent-, Gebrauchsmuster- oder Geschmacksmustererlangung vorbehalten.
"Schutzvermerk nach DIN ISO 16016 beachten" Technische Änderungen vorbehalten!

Issued with CAD/ Changes to be made only on the CAD/CAM model

The reproduction, distribution and utilization of this document as well as the
communication of its contents to others without explicit authorization is
expressly prohibited. All rights reserved in the event of the grant of a patent, utility model or design.
"Observe protective note according to DIN ISO 16016" Technical data is subject to change without notice!

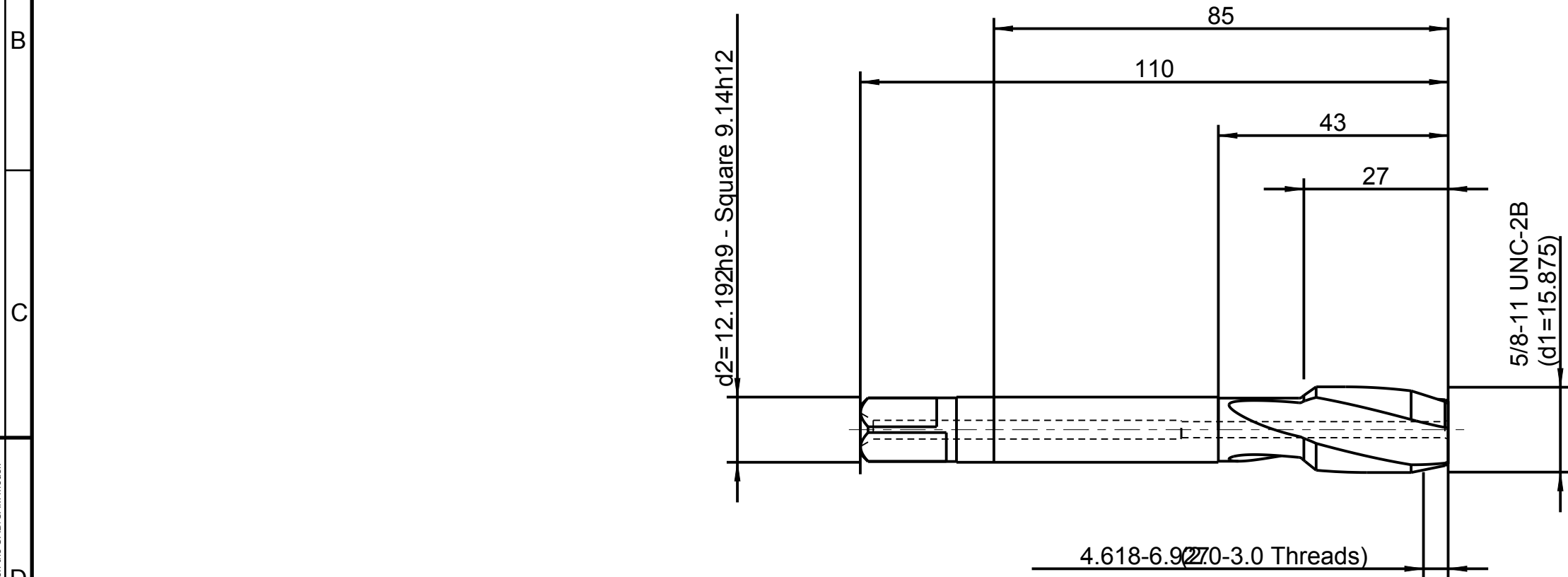

Identification

EMUGE-STEEL Rekord 2D-STEEL-IKZ-TICN 5/8-11 UNC-2B
15°29'/180 Kom.-Nr.

<div><div><div>EMUGE</div><div>FRANKEN</div></div><div>EMUGE-Werk Richard Glimpel GmbH & Co. KG www.emuge-franken.com</div></div>							Document Type		Documentary drawing		
							Description				
							US-Rek.2D-STEEL-IKZ-TICN				
							5/8-11 UNC-2B				
General tolerances ISO 2768-mk						Sheet	View				
<div>><div>6301204001000</div></div>						1/1					
<div>≤ 63012040010002000</div>						Scale					
<div>±0,1 ±0,2 ±0,3 ±0,5 ±0,8 ±1,2</div>						1:1					
Issued by		Date of issue		Replaced by		Material no.		Order no.			
CAD/TF		18.05.2018						CU979000.5015			
Checked by		Date		Replacement for		Customer drawing no.		Drawing no.			
								CU979000.5015			

A
B
C
D
E
F