

## Floating holders with side lock holder

### Product information

- straight shank d3 with whistle notch flat
- suitable for conventional and high performance multi-fluted reamers, because of no angle compensation
- central coolant supply max. 80 bar
- drive flat on tool shank necessary
- for tool shank tolerance h6

### Scope of delivery

- for other shank  $\varnothing$  order reduction sleeves Guhring no. 4095 separately
- order hexagon chuck key Guhring no. 4912 separately
- further sizes with differing radial play are available on request

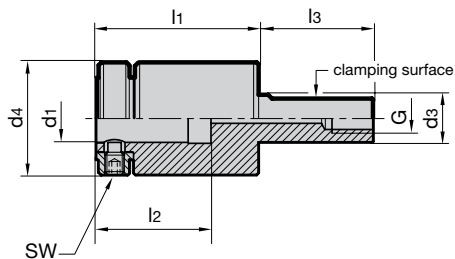

Series Number **4167**

$d_3$ g6 mm	for holder $d_{1h6}$ mm	recommended tool- $\varnothing$	$d_4$ mm	$l_1$ mm	$l_2$ mm	$l_3$ mm	G	SW	radial play	Order Code	EDP Numbers
20	20	up to $\varnothing$ 28	49	75	50	50	1/8	4	0.12	20.020	9041670200200
25	25	$\varnothing$ 10 - $\varnothing$ 36	59	85	60	60	1/4	5	0.12	25.025	9041670250250
32	32	$\varnothing$ 16 - $\varnothing$ 60	80	92	63	80	3/8	6	0.12	32.032	9041670320320

## Short floating holders with side lock holder

### Product information

- straight shank d3 with whistle notch flat
- suitable for conventional and high performance multi-fluted reamers, because of no angle compensation
- central coolant supply max. 80 bar
- drive flat on tool shank necessary
- for tool shank tolerance h6

### Scope of delivery

- for other shank  $\varnothing$  order reduction sleeves Guhring no. 4095 separately
- order hexagon chuck key Guhring no. 4912 separately
- further sizes with differing radial play are available on request

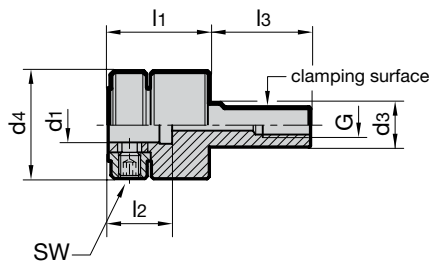

Series Number **4169**

$d_3$ g6 mm	for holder $d_{1h6}$ mm	recommended tool- $\varnothing$	$d_4$ mm	$l_1$ mm	$l_2$ mm	$l_3$ mm	G	SW	radial play	Order Code	EDP Numbers
20	10	up to $\varnothing$ 14	38.5	46	25	40	1/8	3	0.08	10.020	9041690100200
20	16	up to $\varnothing$ 22	49	46	29	46	1/8	4	0.10	16.020	9041690160200
20	20	up to $\varnothing$ 28	49	46	29	46	1/8	4	0.12	20.020	9041690200200