

## Mini floating holders with side lock holder

### Product information

- holder shank with lateral clamping surface
- suitable for conventional and high performance multi-fluted reamers, because of no angle compensation
- very compact design for restricted space
- central coolant supply max. 80 bar
- drive flat on tool shank necessary
- for tool shank tolerance h6

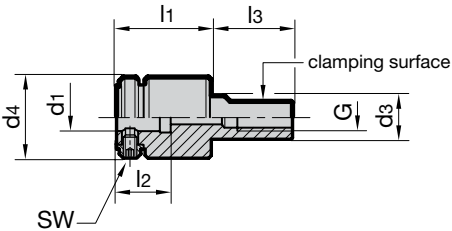

### Scope of delivery

- for other shank  $\varnothing$  order reduction sleeves Guhring no. 4097 separately
- order hexagon chuck key Guhring no. 4912 separately
- further sizes with differing radial play are available on request



Series Number **4174**

$d_3$ g6 mm	for holder $d_{1,h6}$ mm	recommended tool- $\varnothing$	$d_4$ mm	$l_1$ mm	$l_2$ mm	$l_3$ mm	G	SW	radial play	Order Code	EDP Numbers
16	10	to $\varnothing$ 14	30	35	20	30	1/8	2.5	0.12	10.016	9041740100160

## Floating holder with ER collet holder

### Product information

- straight shank  $d_3$  with whistle notch flat
- suitable for conventional and high performance multi-fluted reamers, because of no angle compensation
- for the application of internally cooled reamers use metallic sealed collets type DM Guhring no. 4175
- central coolant supply max. 80 bar

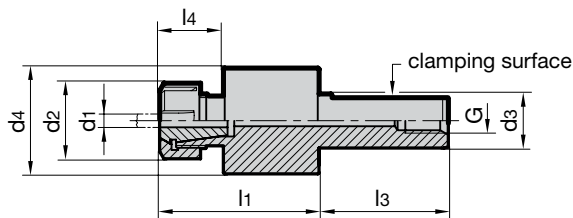

### Scope of delivery

- incl. retaining nut
- order collet Guhring no. 4175 or 4307 as well as clamping key Guhring no. 4913 separately
- further sizes with differing radial play are available on request



Series Number **4098**

$d_3$ g6 mm	recommended tool- $\varnothing$ d1 mm	clamping range	$d_2$ mm	$d_4$ mm	$l_1$ mm	$l_3$ mm	$l_4$ mm	G	radial play	Order Code	EDP Numbers
16	bis $\varnothing$ 16	ER20 $\varnothing$ 1-13	34	49.5	74	40	29.5	1/8	0.06	20.016	9040980200160
20	$\varnothing$ 4 - $\varnothing$ 24	ER25 $\varnothing$ 2-16	42	59	84	50	35	1/8	0.06	25.020	9040980250200
25	bis $\varnothing$ 16	ER20 $\varnothing$ 1-13	34	49.5	74	60	29.5	1/4	0.08	20.025	9040980200250
25	$\varnothing$ 4 - $\varnothing$ 24	ER25 $\varnothing$ 2-16	42	59	84	60	35	1/4	0.08	25.025	9040980250250
32	$\varnothing$ 6 - $\varnothing$ 30	ER32 $\varnothing$ 3-20	50	64	91	80	35.5	3/8	0.10	32.032	9040980320320
40	$\varnothing$ 6 - $\varnothing$ 30	ER32 $\varnothing$ 3-20	50	64	91	80	35.5	1/2	0.12	32.040	9040980320400