

Metric clamping sleeves for HPC clamping chucks, sealed version

Product information

- for use with HPC clamping chucks
- sealed design for coolant fed tools
- for tool shank tolerance h6

Scope of delivery

- incl. length setting screw

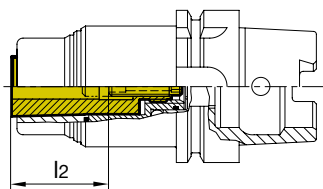
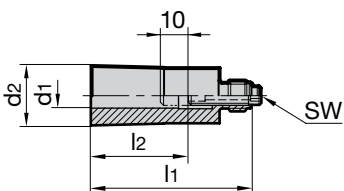

Series Number

4235

**Nominal size	for shank Ø d_1 h6 inch	d_2 mm	l_1 mm	l_2 mm	SW	Order Code	EDP Numbers
20	3	24.6	66	28	4	3.020	9042350030200
20	4	24.6	66	28	4	4.020	9042350040200
20	5	24.6	66	28	4	5.020	9042350050200
20	6	24.6	66	36	4	6.020	9042350060200
20	8	24.6	66	36	4	8.020	9042350080200
20	10	24.6	66	40	4	10.020	9042350100200
20	12	24.6	66	45	4	12.020	9042350120200
20	14	24.6	66	45	4	14.020	9042350140200
20	16	24.6	66	48	4	16.020	9042350160200
20	18	24.6	66	48	4	18.020	9042350180200
20	20	24.6	66	50	4	20.020	9042350200200
32	20	45.5	90	50	4	20.032	9042350200320
32	22	45.5	90	50	4	22.032	9042350220320
32	25	45.5	90	56	4	25.032	9042350250320
32	32	45.5	90	59	4	32.032	9042350320320
25	16	39	87.5	48	4	16.025	9042350160250
25	20	39	87.5	50	4	20.025	9042350200250
25	22	39	87.5	50	4	22.025	9042350220250
25	25	39	87.5	56	4	25.025	9042350250250
25	32	39	87.5	60	4	32.025	9042350320250

**HPC chuck bore nominal size must match clamping sleeve nominal size