

Inch clamping sleeves for HPC clamping chucks, sealed version

Product information

- for use with HPC clamping chucks
- sealed design for coolant fed tools
- for tool shank tolerance h6

Scope of delivery

- incl. length setting screw

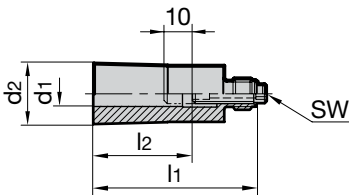

Series Number 4237

**Nominal size	for shank Ø d1 h6 inch	d2 mm	l1 mm	l2 mm	SW	Order Code	EDP Numbers
20	1/8"	24.6	66	28	4	1.020	9042370010200
20	3/16"	24.6	66	28	4	2.020	9042370020200
20	1/4"	24.6	66	36	4	3.020	9042370030200
20	5/16"	24.6	66	36	4	4.020	9042370040200
20	3/8"	24.6	66	40	4	5.020	9042370050200
20	7/16"	24.6	66	45	4	6.020	9042370060200
20	1/2"	24.6	66	45	4	7.020	9042370070200
20	9/16"	24.6	66	45	4	8.020	9042370080200
20	5/8"	24.6	66	48	4	9.020	9042370090200
20	11/16"	24.6	66	48	4	10.020	9042370100200
20	3/4"	24.6	66	50	4	11.020	9042370110200
25	3/4"	39	87.5	50	4	1.025	9042370010250
25	1"	39	87.5	56	4	2.025	9042370020250
32	3/4"	45.5	90	50	4	1.032	9042370010320
32	1"	45.5	90	56	4	2.032	9042370020320
32	1 1/4"	45.5	90	59	4	3.032	9042370030320

**HPC chuck bore nominal size must match clamping sleeve nominal size