

# ISO taper hydraulic chucks HMC 3000 for clamping small diameters

## Product information

- perfect concentricity:  $< 3 \mu\text{m}$  at  $10 \times d_1$
- balancing quality: G2.5 / 25,000 rev./min or  $U < 1 \text{gmm}$
- ISO taper to DIN 69871 form AD/B
- high clamping force
- quick, simple handling and accurate length setting
- IC and GÜHROJET peripheral cooling ensure optimal chip evacuation and tool lubrication

## Scope of delivery

- incl. length adjustment screw
- incl. hexagon chuck key Guhring no. 4912
- order pull studs Guhring no. 4925, 4926 separately

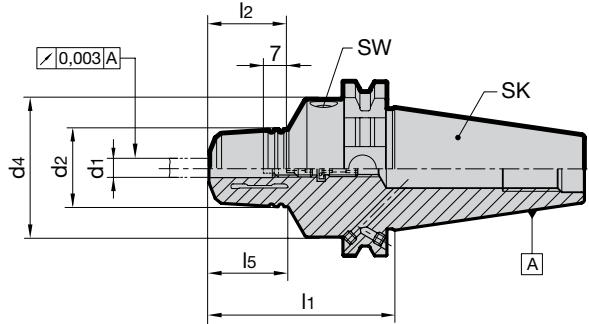

**GÜHROJET**

Series Number **4619**

ISO taper	for shank $\text{Ø } d_{1 \text{ h6}}$ mm	$d_2$ mm	$d_4$ mm	$l_1$ mm	$l_2$ mm	$l_5$ mm	SW	Order Code	EDP Numbers
40	3	28	49.5	84.5	34	34	5	3.040	9046190030400
40	4	28	49.5	84.5	34	34	5	4.040	9046190040400
40	5	28	49.5	84.5	34	34	5	5.040	9046190050400