

MAS/BT hydraulic chucks HMC 3000 for clamping small diameters

Product information

- perfect concentricity: $< 3 \mu\text{m}$ at 10xd1
- balancing quality: G2.5 / 25,000 rev./min or U < 1gmm
- MAS/BT to JIS B 6339 form AD/B (*: version AD without coolant supply over collar)
- high clamping force
- quick, simple handling and accurate length setting
- IC and GÜHROJET peripheral cooling ensure optimal chip evacuation and tool lubrication

Scope of delivery

- incl. length adjustment screw
- incl. hexagon chuck key Guhring no. 4912
- order pull studs Guhring no. 4927, 4928 separately



GÜHROJET

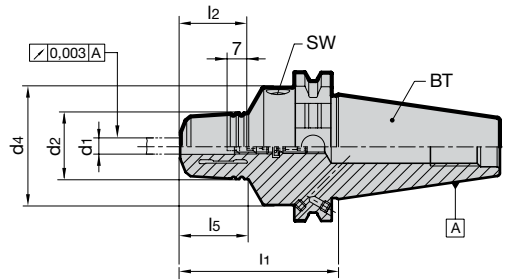

Series Number **4620**

BT	for shank Ø $d_{1\text{h6}}$ mm	d_2 mm	d_4 mm	l_1 mm	l_2 mm	l_5 mm	SW	Order Code	EDP Numbers
30*	3	28	-	55	34	22.5	4	3.030	9046200030300
30*	4	28	-	55	34	22.5	4	4.030	9046200040300
30*	5	28	-	55	34	22.5	4	5.030	9046200050300
40	3	28	44.5	94	34	48.5	5	3.040	9046200030400
40	4	28	44.5	94	34	48.5	5	4.040	9046200040400
40	5	28	44.5	94	34	48.5	5	5.040	9046200050400