

Shrink fit extensions

Product information

- for clamping in hydraulic chucks or shrink fit chucks
- internal cooling suitable
- we recommend the use of special cooling adaptors Guhring no. 4419
- for carbide tool shanks in tolerance h6 (from d1 14mm also HSS possible)

Scope of delivery

- incl. setting screw Guhring no. 4977 or 4904
- special dimensions on request

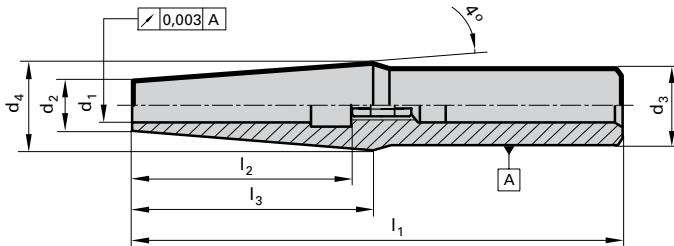

Series Number **4719**

for shank Ø d_1 h6 mm	d_2 mm	d_3 h6 mm	d_4 mm	l_1 mm	l_2 mm	incl. setting screw Guh. no. Code no.	Order Code	EDP Numbers
3	7	16	16	115	30	9049040050160	3.016	9047190030160
4	7	16	16	115	35	9049040060160	4.016	9047190040160
5	8	16	16	115	40	9049040080180	5.016	9047190050160
6	10	16	16	115	36	9049770060140	6.016	9047190060160
8	12	16	16	115	36	9049770080140	8.016	9047190080160
10	14	16	16	115	41	9049770100140	10.016	9047190100160
12	16	16	23	115	46	9049770120140	12.016	9047190120160
3	7	20	16	115	30	9049040050160	3.020	9047190030200
4	8	20	17	115	35	9049040060160	4.020	9047190040200
5	9	20	18	115	40	9049040080180	5.020	9047190050200
6	10	20	19	115	36	9049770060140	6.020	9047190060200
8	12	20	20	115	36	9049770080140	8.020	9047190080200
10	14	20	20	115	41	9049770100140	10.020	9047190100200
12	16	20	20	115	46	9049770120140	12.020	9047190120200
14	20	20	29	150	46	9049770120140	14.020	9047190140200
14	20	25	29	150	46	9049770120140	14.025	9047190140250
16	24	25	33	150	49	9049770160140	16.025	9047190160250
3	10	20	20	160	30	9049040050160	3.120	9047190031200
4	10	20	20	160	35	9049040060160	4.120	9047190041200
5	10	20	20	160	40	9049040080180	5.120	9047190051200
6	14	20	20	160	36	9049770060140	6.120	9047190061200
8	14	20	20	160	36	9049770080140	8.120	9047190081200
10	20	25	25	160	41	9049770100140	10.125	9047190101250
12	20	25	25	160	46	9049770120140	12.125	9047190121250
14	20	25	29	160	46	9049770160140	14.125	9047190141250
16	22	25	33	160	49	9049770160140	16.125	9047190161250
18	27	32	32	160	49	9049770160140	18.132	9047190181320
20	27	32	32	160	51	9049770201140	20.132	9047190201320
3	10	20	20	200	30	9049040050160	3.220	9047190032200
4	10	20	20	200	35	9049040060160	4.220	9047190042200
5	10	20	20	200	40	9049040080180	5.220	9047190052200
6	14	20	20	200	36	9049770060140	6.220	9047190062200
8	14	20	20	200	36	9049770080140	8.220	9047190082200
10	20	25	25	200	41	9049770100140	10.225	9047190102250
12	20	25	25	200	46	9049770120140	12.225	9047190122250
14	20	32	32	200	46	9049770160140	14.232	9047190142320
16	24	32	32	200	49	9049770160140	16.232	9047190162320
18	27	32	32	200	49	9049770200140	18.232	9047190182320
20	27	32	32	200	51	9049770201140	20.232	9047190202320