



16573305
Edition 4
January 2014

Air Grinder

88V Series

Parts Information



Save These Instructions

IR Ingersoll Rand®

88V Series Air Grinder - Parts List

Item	Part Description	Part Number	Item	Part Description	Part Number	
‡ 1	Cylinder Case Assembly		21A	Exhaust Deflector (for 88V60-EU, 88V77 and 88V85)	88V77-123	
	for models ending in -EU	88V60-EU-A25				
	for all other models	88V60-A25	21B	Exhaust Baffle (for 88V60-EU, 88V77 and 88V85)	88V77-311	
2	Throttle Valve Assembly	88V60-A302				
† • 3	Seal (2)	C321-606	25	Dead Handle	88V60-48	
4	Inlet Bushing	88V60-38	27	Arbor	88V60-204-P10-C	
				for 88V60 (Blue)	88V60-204-P10	
				for 88V77 (Green)	88V77-204-P10	
				for 88V85 (Red)	88V85-204-P10	
† • 5	Inlet Bushing Screen	834-61	28	Front Rotor Bearing	R380-105	
† • 6	Throttle Valve Spring	99V60-262	29	Front End Plate	88V60-11	
7	Throttle Valve Seat Support Assembly	88V60-A303	• 30	Rotor Key	88V60-70	
† • 8	Air Strainer Screen	834-61	31	Rotor	88V60-53	
† • 9	Valve Seat	R4-159A	† • 32	Vane Packet (set of 4 Vanes)	88V60-42-4	
10	Valve Seat Washer	99V60-155	33	Cylinder	88V60-3	
11	Valve Screw Lock Washer	H54U-352	• 34	Cylinder Dowel	88V60-98	
12	Valve Seat Screw	PS3-83	35	Rear End Plate	88V60-12-C	
• 13	Throttle Lever Pin	MR-100	† • 36	Rear End Plate Gasket	88V60-739-C	
14	Locking Lever Assembly	88V60-A400	37	Controller Assembly		
15	Lever Lock	88V60-402			for 88V60 (6000 rpm)	88V60-A524-C
16	Lever Lock Spring	88V60-405			for 88V77 (7700 rpm)	88V77-A524-C
17	Lever Lock Pin	502B-120			for 88V85 (8500 rpm)	88V85-A524-C
*	Nameplate Kit (for 88V60-EU-A25)	88V-EU-K301	38	Rear End Bearing	99V60-105	
*	Nameplate Screw (for 88V60-EU-A25) (4)	BN403-302	39	Disc Spring	99V-246	
*	Warning Label (for 88V60-EU-A25)	EU-99	40	Nozzle	88V60-19	
*	Nameplate Kit (for 88V60-A25)	88V-K301	† • 42	Motor Clamp Belleville Washer (2)	88V60-207	
	Nameplate Screw (4)	BN403-302				
	Warning Label	WARNING-2-99				
20	Exhaust Deflector	99V60-23				
21	Exhaust Deflector Screw (3)	99V60-200				

* Not Illustrated.

• To keep downtime to a minimum, it is desirable to have on hand certain repair parts. We recommend that you stock one (pair or set) of each part indicated by a bullet (•) for every four tools in service.

‡ Whenever a new Cylinder Case Assembly is installed, select the correct Nameplate from the Nameplate Kit and attach it to the Cylinder Case with the Nameplate Screws.

† Indicates Tune-up Kit part.

88V Series Air Grinder Guards, Flanges and Spacers - Exploded View

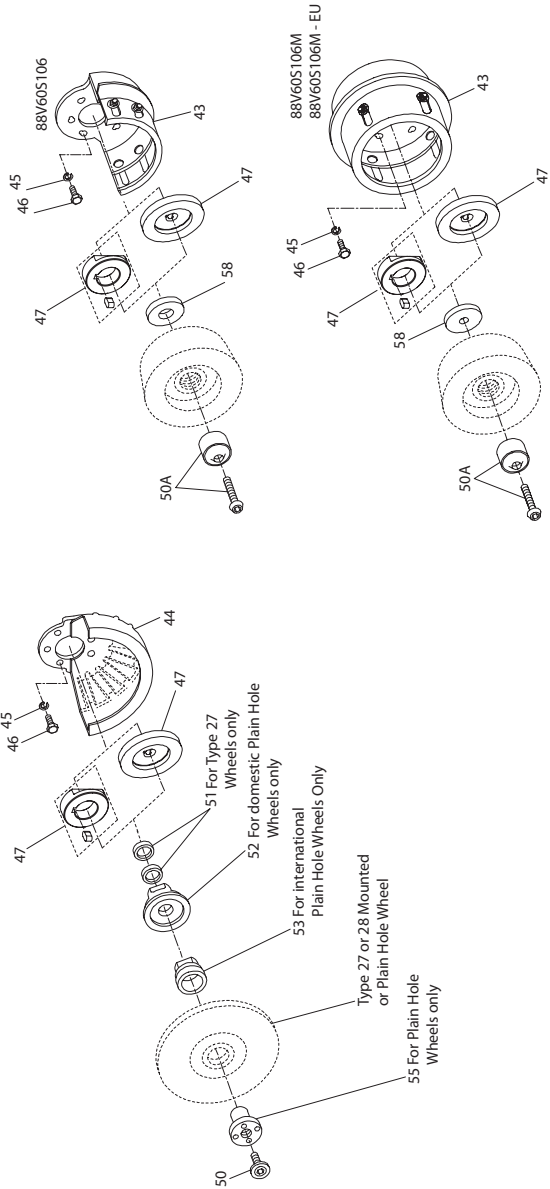

(Dwg. TPA732-3)

88V Series Air Grinder Guards, Flanges and Spacers - Parts List

Item	Part Description	Part Number	Item	Part Description	Part Number
43	Cup Wheel Guard		55	Depressed Center Wheel Nut (for Plain Hole Wheels)	99V85-186
	for 88V60S106	88V60-A216			
	for 88V60S106M	88V60-A216M	56	Depressed Center Wheel Nut Spanner Wrench	D32-26
44	Depressed Center Wheel Guard (for Type 27 or 28 Wheels)		57	Disc Wheel Flange Wrench (for 88V60P107M, 88V60P109M, 88V77107M and 88V85P107M)	7RAQT4-254
	for 88V60P109 and 88V60P109M	88V60-106-9			
	for 88V60P107, 88V60P107M, 88V77P107, 88V77P107M	88V60-106-7	58	Wheel Flange (for 88V60S106, 88V60S106M and 88V60S106M-EU)	88V60-86A
	and 88V85P107M		*	Piped-Away Exhaust Kit	88V60-K184
45	Cylinder Case Screw Lock Washer (5)	10BM-67	*	Exhaust Hose Clamp	DG30-67
46	Cylinder Case Screw (5)	99V60-638	*	Exhaust Elbow	88V60-167
47	Autobalancer Assembly (Model ending in EU)	99V60-A713	*	Exhaust Elbow Gasket	99V60-49
	Wheel Flange Assembly	99V60-86-AC			
48	Autobalancer Wrench	88V60-169	*	Exhaust Elbow Screw (3)	FEA100-112
50	Wheel Retaining Screw (for Type 27 and Type 28 Mounted Wheels and Type 28 Plain Hole Wheels)	99V60-219	*	Exhaust Hose Band Assembly	99V60-A927
			*	Cap Screw (2)	JC3350-103
			*	Nut (6)	G8-120A
50A	Wheel Retaining Screw Assembly (for Type 6 or Type 11 Cup Wheels)	99V60-A219C	*	Exhaust Hose Band (4)	99V60-927
*	Wheel Retaining Screw Wrench	88V-562	*	Screw (4)	MT1-36-7/8
51	Depressed Center Wheel Spacer (for Type 27 Plain Hole Wheels) (2)	99V-286	*	Controller Wrench	88V60-950
			*	Seal Pressing Tool	99V60-951
52	Depressed Center Wheel Flange (for 7" and 9" diameter Type 27 and Type 28 Plain Hole Wheels)	99V60-386	*	Bearing Clamp Assembly	99V60-A952
			*	Deflector Screw Wrench	R2J-562
53	Depressed Center Wheel Flange Assembly (for 180 mm and 230 mm diameter Type 27 Plain Hole Depressed Center Wheels)	99V60-386-M	*	Tune-up Kit (includes illustrated parts: 3 [2], 5, 6, 9, 32, 36, 40 and 42)	88V/88H-TK3

* Not Illustrated.

Parts and Maintenance

When the life of the tool has expired, it is recommended that the tool be disassembled, degreased and parts be separated by material so that they can be recycled.

Tool repair and maintenance should only be carried out by an authorized Service Center.

Refer all communications to the nearest **Ingersoll Rand** Office or Distributor.

Related Documentation

For additional information refer to:

Product Safety Information Manual 04584959.

Product Information Manuals 16573222 and 16576092.

Maintenance Information Manual 16573362.

Manuals can be downloaded from ingersollrandproducts.com

Notes:

Notes:

ingersollrandproducts.com

© 2014 *Ingersoll Rand*

