



2017

S U M M E R / F A L L
P R O M O P A C K

Indexable Drilling Offers



1.5D

DRA Magic Drill



DRZ Magic Drill



HOLESHO™ Drill



VALID THROUGH
December 31, 2017

KPTI Company Overview

Established in April 2014, KPTI unifies two of the world's leading cutting tool manufacturers, Kyocera Tycom Corporation (KTC) and the Cutting Tool Division of Kyocera Industrial Ceramics Corporation (KICC-CT).

The new company creates a combined enterprise that optimizes the strengths of both organizations and facilitates expansion of Kyocera's overall cutting tool-related business in North America. The new combined entity will unify cutting tool resources to create greater efficiencies while positioning the new organization for continued success.

Customers will benefit from a unified sales and support team offering improved customer service and an expanded portfolio of cutting tool products and solutions for the automotive, aerospace, general machining, medical, power generation, printed circuit board and steel markets.

KPTI North American Operations

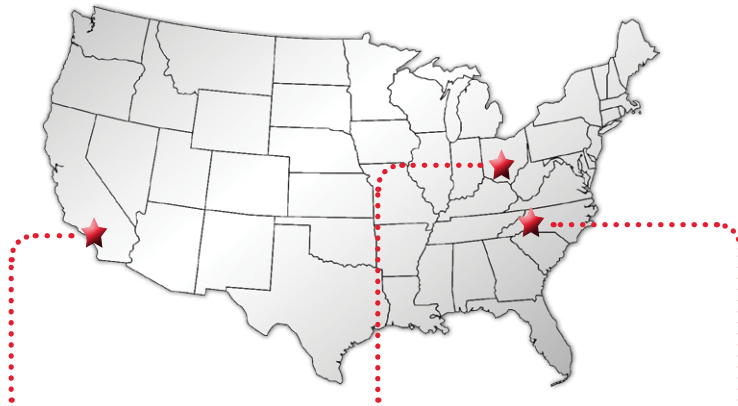

Costa Mesa, CA

Wapakoneta, OH

Hendersonville, NC



Administration & Manufacturing

- Administration & Accounting Center
- Micro-Tools Manufacturing
- Printed Circuit Board Drill Manufacturing
- Micro-Tools & PCB Sales & Customer Service Center

Steel Tool Holder Manufacturing

- Indexable Drills
- Milling End Mills & Face Mills
- Boring Bars
- Turning and Grooving Holders
- API Ring Groovers

Sales, Tech Center & Marketing

- North American Tech Center
- North American Sales, Marketing & Customer Service Center

KPTI

Manufactured Products



Steel Toolholders for Milling, Turning, Grooving, Threading and Drilling Metal

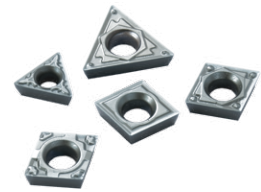

Indexable metal cutting inserts made of carbide, ceramic, cermet, Cubic Boron Nitride, and Polycrystalline diamond



Solid carbide cutting tools for tight tolerance and micro-diameter metal cutting applications

KPTI Markets Served



Automotive



Aerospace



Medical



Printed Circuit Board



Power Generation

Explore the Many Ways to Save with the Kyocera 2017 Summer / Fall Promo Pack

In 2017 Kyocera Precision Tools, Inc. is offering more ways to advance your productivity while also reducing your tooling costs. With our wide array of indexable and solid round cutting tools, we strive to be your primary source for high-quality, cost-effective solutions for all of your metal cutting needs. Read below for our latest cost-savings opportunities.

To learn more about KPTI, please visit www.kyoceraprecisiontools.com.

Drilling Solutions

DRA Magic Drills	Kits Include 1 Drill Body and 2 Insert Tips	P4
	FREE Drill Body with Purchase of Designated Number of Inserts	P4
DRZ Magic Drills	Kits Include 1 Drill Body and 10 Inserts	P12
HOLESHOT Drills	Kits Include 1 Drill Body and 10 Inserts	P18

How to Order

We sell our high-performance lineup of indexable and solid round cutting tools through our North American Distribution Partners. When placing an order for items in this Promo Pack, please reference the promo code provided.

To locate an Authorized Kyocera Distributor, please visit www.kyoceraprecisiontools.com/locate



DRA Magic Drill Kits

High Efficiency and Low Cutting Force Modular Drill

Excellent Hole Accuracy

S-curve reduces thrust force and controls vibration

Fine Chip Breaking Even in Deep Hole Drilling Applications

Optimized chip thinning for stable chip evacuation

Long Tool Life and Stable Machining of Various Workpieces

MEGACOAT NANO grade PR1535 is used to machine various materials from steel to stainless steel

New 1.5D Flange and Straight Shank Sizes Added! NEW

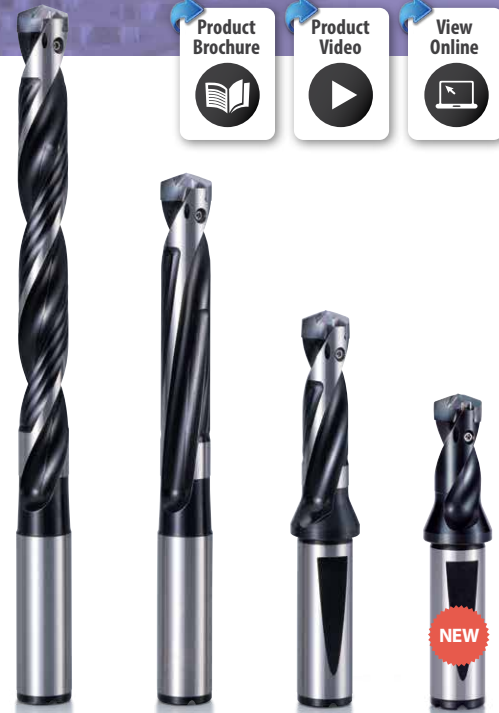

1 Low Cutting Force Design Improves Hole Accuracy

The special chisel edge with S-curve reduces thrust force and controls vibration.

Cutting Edge Image

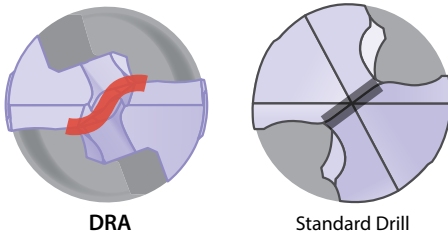

2 Optimal Web Thickness Limits Deflection

The hole accuracy is improved by controlling drill deflection with a 20% thicker web compared with Competitor A.

Web Thickness Comparison

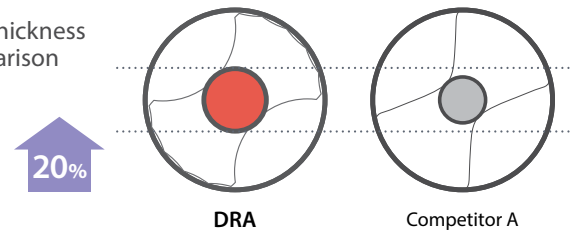

Low Cutting Force Comparison (In-house Evaluation)

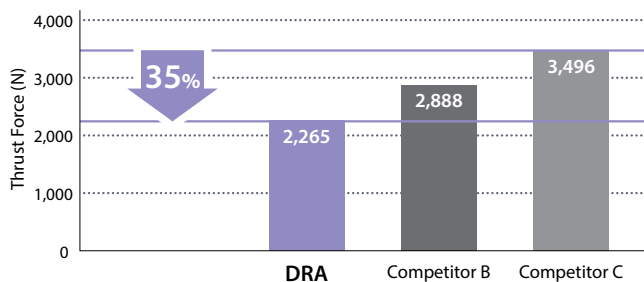

Cutting Conditions : Vc = 390sfm, f = 0.010ipr, Drilling Diameter 0.551", Drilling Depth 1.772", Wet

Roundness · Cylindricity Comparison (In-house Evaluation)

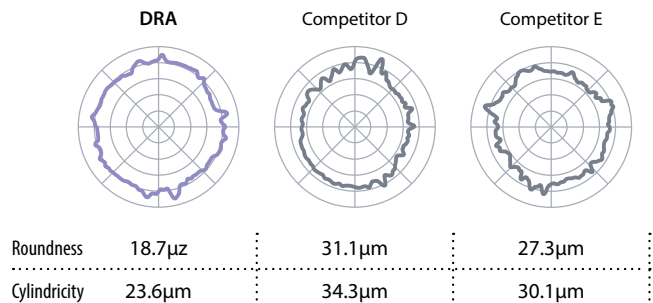

Cutting Conditions : Vc = 390sfm, f = 0.012ipr, Drilling Diameter 0.551", Measurement Position 2.165", Wet Workpiece : 1049 Steel

All 2017 Summer / Fall Promo Offers Valid through December 31, 2017

All promo items are available exclusively through Authorized North American Kyocera Precision Tool Distributors. Please use specified Promo Code when placing orders.

To locate a distributor visit www.kyoceraprecisiontools.com/locate. Prices Shown Valid in U.S. Only.

DRA Toolholders (Straight Shank - 1.5D) NEW

Choose (1) 1.5D Drill Body and (2) Inserts for Special Kit Price or Purchase (9) Inserts and Receive a 1.5D Drill Body FREE

Chosen inserts must fit purchased drill body but do not need to be the same.

Promo Code: **KYO-DRA-KIT**

Promo Code: **KYO-DRA-FREE**

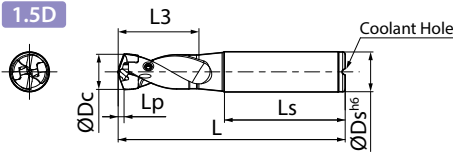

For Lp dimension, reference insert dimension table.

Part Number	Stock	U.S. Kit Price	Dimension (in)						Applicable Insert See Page 32-33	Seat Size	Spare Parts	
			ØDc		ØDs	L	L3	Ls			Clamp Screw	Wrench
			min.	max.								
SS0375-DRA080M-1.5	●	\$219.00	0.313	0.331	0.375	2.608	0.504	1.575	DA0794M-GM ~ DA0840M-GM	080	HS-2524TRP	
SS0375-DRA085M-1.5	●	\$219.00	0.335	0.350		2.657	0.531		DA0850M-GM ~ DA0890M-GM	085		
SS0375-DRA090M-1.5	●	\$219.00	0.354	0.370		2.707	0.563		DA0900M-GM ~ DA0940M-GM	090		
SS0500-DRA095M-1.5	●	\$219.00	0.374	0.390	0.500	2.953	0.591	1.772	DA0950M-GM ~ DA0990M-GM	095	HS-2534TRP	FTP-5
SS0500-DRA100M-1.5	●	\$219.00	0.394	0.409		3.002	0.622		DA1000M-GM ~ DA1040M-GM	100		
SS0500-DRA105M-1.5	●	\$239.00	0.413	0.429		3.051	0.650		DA1050M-GM ~ DA1090M-GM	105		
SS0500-DRA110M-1.5	●	\$239.00	0.433	0.449	0.625	3.140	0.681	1.890	DA1100M-GM ~ DA1140M-GM	110	HS-2534TRP	FTP-6
SS0500-DRA115M-1.5	●	\$239.00	0.453	0.469		3.189	0.709		DA1150M-GM ~ DA1190M-GM	115		
SS0625-DRA120M-1.5	●	\$239.00	0.472	0.488		3.356	0.740		DA1200M-GM ~ DA1240M-GM	120		
SS0625-DRA125M-1.5	●	\$239.00	0.492	0.508	0.750	3.406	0.768	1.969	DA1250M-GM ~ DA1290M-GM	125	HS-3048TRP	FTP-6
SS0625-DRA130M-1.5	●	\$239.00	0.512	0.528		3.455	0.799		DA1300M-GM ~ DA1340M-GM	130		
SS0625-DRA135M-1.5	●	\$239.00	0.531	0.547		3.504	0.827		DA1350M-GM ~ DA1390M-GM	135		
SS0625-DRA140M-1.5	●	\$239.00	0.551	0.567	1.000	3.553	0.858	2.205	DA1400M-GM ~ DA1440M-GM	140	HS-4067TRP	FTP-7
SS0625-DRA145M-1.5	●	\$239.00	0.571	0.590		3.602	0.886		DA1450M-GM ~ DA1490M-GM	145		
SS0625-DRA150M-1.5	●	\$249.00	0.591	0.626		3.740	0.917		DA1500M-GM ~ DA1590M-GM	150		
SS0750-DRA160M-1.5	●	\$249.00	0.630	0.665	0.750	3.957	0.976	1.969	DA1600M-GM ~ DA1690M-GM	160	HS-4067TRP	FTP-7
SS0750-DRA170M-1.5	●	\$259.00	0.669	0.705		4.055	1.035		DA1700M-GM ~ DA1790M-GM	170		
SS0750-DRA180M-1.5	●	\$289.00	0.709	0.744		4.193	1.094		DA1800M-GM ~ DA1890M-GM	180		
SS1000-DRA190M-1.5	●	\$309.00	0.748	0.783	1.000	4.528	1.154	2.205	DA1900M-GM ~ DA1990M-GM	190	HS-4067TRP	FTP-7
SS1000-DRA200M-1.5	●	\$359.00	0.787	0.823		4.626	1.213		DA2000M-GM ~ DA2090M-GM	200		
SS1000-DRA210M-1.5	●	\$379.00	0.827	0.846		4.724	1.272		DA2100M-GM ~ DA2150M-GM	210		
SS1000-DRA220M-1.5	●	\$379.00	0.866	0.886	1.000	4.862	1.331	2.205	DA2200M-GM ~ DA2250M-GM	220	HS-4067TRP	FTP-7
SS1000-DRA230M-1.5	●	\$389.00	0.906	0.937		4.961	1.390		DA2300M-GM ~ DA2381M-GM	230		
SS1000-DRA240M-1.5	●	\$389.00	0.945	0.965		5.059	1.449		DA2400M-GM ~ DA2450M-GM	240		
SS1000-DRA250M-1.5	●	\$419.00	0.984	1.004	5.157	1.508	DA2500M-GM ~ DA2550M-GM	250				

● : U.S. Stock

Kit Includes 1 Drill Body and 2 Inserts

KYOCERA Precision Tools, Inc.

P: 800.823.7284 • F: 828.692.1344 • E: ctsales@kyocera.com
Official Website | www.kyoceraprecisiontools.com

DRA Toolholders (with Flange - 1.5D) NEW

Choose **(1) 1.5D Drill Body** and **(2) Inserts** for Special Kit Price or Purchase **(9) Inserts** and Receive a **1.5D Drill Body FREE**

Chosen inserts must fit purchased drill body but do not need to be the same.

Promo Code: **KYO-DRA-KIT**

Promo Code: **KYO-DRA-FREE**

1.5D

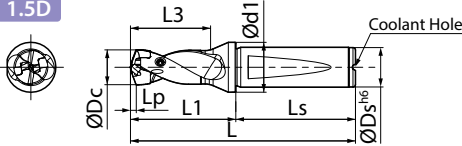

For Lp dimension, reference insert dimension table.

Part Number	Stock	U.S. Kit Price	Dimension (in)								Applicable Insert See Page 32-33	Seat Size	Spare Parts	
			ØDc		ØDs	L	L1	L3	Ls	Ød1			Clamp Screw	Wrench
			min.	max.										
SF0500-DRA080M-1.5	●	\$239.00	0.313	0.331	0.500	2.805	1.033	0.504	1.772	0.630	DA0794M-GM ~ DA0840M-GM	080	HS-2524TRP	
SF0500-DRA085M-1.5	●	\$239.00	0.335	0.350		2.854	1.083	0.531			DA0850M-GM ~ DA0890M-GM	085		
SF0500-DRA090M-1.5	●	\$239.00	0.354	0.370		2.904	1.132	0.563			DA0900M-GM ~ DA0940M-GM	090		
SF0500-DRA095M-1.5	●	\$239.00	0.374	0.390		2.953	1.181	0.591			DA0950M-GM ~ DA0990M-GM	095		
SF0625-DRA100M-1.5	●	\$239.00	0.394	0.409	0.625	3.120	1.230	0.622	1.890	0.787	DA1000M-GM ~ DA1040M-GM	100	HS-2534TRP	FTP-5
SF0625-DRA105M-1.5	●	\$239.00	0.413	0.429		3.169	1.280	0.650			DA1050M-GM ~ DA1090M-GM	105		
SF0625-DRA110M-1.5	●	\$239.00	0.433	0.449		3.258	1.368	0.681			DA1100M-GM ~ DA1140M-GM	110		
SF0625-DRA115M-1.5	●	\$239.00	0.453	0.469		3.307	1.417	0.709			DA1150M-GM ~ DA1190M-GM	115		
SF0625-DRA120M-1.5	●	\$239.00	0.472	0.488		3.356	1.467	0.740			DA1200M-GM ~ DA1240M-GM	120		
SF0625-DRA125M-1.5	●	\$239.00	0.492	0.508		3.406	1.516	0.768			DA1250M-GM ~ DA1290M-GM	125		
SF0625-DRA130M-1.5	●	\$239.00	0.512	0.528		3.455	1.565	0.799			DA1300M-GM ~ DA1340M-GM	130		
SF0625-DRA135M-1.5	●	\$239.00	0.531	0.547		3.504	1.614	0.827			DA1350M-GM ~ DA1390M-GM	135		
SF0625-DRA140M-1.5	●	\$239.00	0.551	0.567		3.553	1.663	0.858			DA1400M-GM ~ DA1440M-GM	140		
SF0625-DRA145M-1.5	●	\$239.00	0.571	0.590		3.602	1.713	0.886			DA1450M-GM ~ DA1490M-GM	145		
SF0750-DRA150M-1.5	●	\$239.00	0.591	0.626	0.750	3.819	1.850	0.917	1.969	0.984	DA1500M-GM ~ DA1590M-GM	150	HS-3048TRP	FTP-6
SF0750-DRA160M-1.5	●	\$239.00	0.630	0.665		3.957	1.988	0.976			DA1600M-GM ~ DA1690M-GM	160		
SF0750-DRA170M-1.5	●	\$259.00	0.669	0.705		4.055	2.087	1.035			DA1700M-GM ~ DA1790M-GM	170		
SF0750-DRA180M-1.5	●	\$279.00	0.709	0.744		4.193	2.224	1.094			DA1800M-GM ~ DA1890M-GM	180		
SF0750-DRA190M-1.5	●	\$299.00	0.748	0.783	4.291	2.323	1.154	DA1900M-GM ~ DA1990M-GM	190					
SF1000-DRA200M-1.5	●	\$349.00	0.787	0.823	1.000	4.626	2.421	1.213	2.205	1.260	DA2000M-GM ~ DA2090M-GM	200	HS-4067TRP	FTP-7
SF1000-DRA210M-1.5	●	\$359.00	0.827	0.846		4.724	2.520	1.272			DA2100M-GM ~ DA2150M-GM	210		
SF1000-DRA220M-1.5	●	\$359.00	0.866	0.886		4.862	2.657	1.331			DA2200M-GM ~ DA2250M-GM	220		
SF1000-DRA230M-1.5	●	\$389.00	0.906	0.937		4.961	2.756	1.390			DA2300M-GM ~ DA2381M-GM	230		
SF1000-DRA240M-1.5	●	\$389.00	0.945	0.965		5.059	2.854	1.449			DA2400M-GM ~ DA2450M-GM	240		
SF1000-DRA250M-1.5	●	\$419.00	0.984	1.004		5.157	2.953	1.508			DA2500M-GM ~ DA2550M-GM	250		

● : U.S. Stock

Kit Includes 1 Drill Body and 2 Inserts

All 2017 Summer / Fall Promo Offers Valid through December 31, 2017

All promo items are available exclusively through Authorized North American Kyocera Precision Tool Distributors. Please use specified Promo Code when placing orders.

To locate a distributor visit www.kyoceraprecisiontools.com/locate. Prices Shown Valid in U.S. Only.

DRA Toolholders (with Flange - 3D)

Choose (1) 3D Drill Body and (2) Inserts for Special Kit Price or Purchase (10) Inserts and Receive a 3D Drill Body FREE

Chosen inserts must fit purchased drill body but do not need to be the same.

Promo Code: **KYO-DRA-KIT**

Promo Code: **KYO-DRA-FREE**

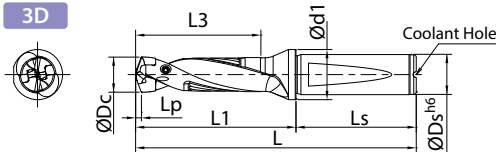

For Lp dimension, reference insert dimension table.



Part Number	Stock	U.S. Kit Price	Dimension (in)							Applicable Insert See Page 32-33	Seat Size	Spare Parts							
			ØDc		ØDs	L	L1	L3	Ls			Ød1	Clamp Screw	Wrench					
			min.	max.															
SF0500-DRA080M-3	●	\$249.00	0.313	0.331	0.500	3.307	1.535	1.004	1.772	0.630	DA0794M-GM ~ DA0840M-GM	080	HS-2524TRP						
SF0500-DRA085M-3	●	\$249.00	0.335	0.350		3.386	1.614	1.063			DA0850M-GM ~ DA0890M-GM	085							
SF0500-DRA090M-3	●	\$249.00	0.354	0.370		3.465	1.693	1.122			DA0900M-GM ~ DA0940M-GM	090							
SF0500-DRA095M-3	●	\$249.00	0.374	0.390		3.543	1.772	1.181			DA0950M-GM ~ DA0990M-GM	095							
SF0625-DRA100M-3	●	\$249.00	0.394	0.409	0.625	3.740	1.850	1.240	1.890	0.787	DA1000M-GM ~ DA1040M-GM	100	HS-2534TRP	FTP-5					
SF0625-DRA105M-3	●	\$269.00	0.413	0.429		3.819	1.929	1.299			DA1050M-GM ~ DA1090M-GM	105							
SF0625-DRA110M-3	●	\$269.00	0.433	0.449		3.937	2.047	1.358			DA1100M-GM ~ DA1140M-GM	110							
SF0625-DRA115M-3	●	\$269.00	0.453	0.469		4.016	2.126	1.417			DA1150M-GM ~ DA1190M-GM	115							
SF0625-DRA120M-3	●	\$269.00	0.472	0.488		4.094	2.205	1.476			DA1200M-GM ~ DA1240M-GM	120							
SF0625-DRA125M-3	●	\$269.00	0.492	0.508		4.173	2.283	1.535			DA1250M-GM ~ DA1290M-GM	125							
SF0625-DRA130M-3	●	\$269.00	0.512	0.528		4.252	2.362	1.594			DA1300M-GM ~ DA1340M-GM	130							
SF0625-DRA135M-3	●	\$279.00	0.531	0.547		4.331	2.441	1.654			DA1350M-GM ~ DA1390M-GM	135							
SF0625-DRA140M-3	●	\$279.00	0.551	0.567		4.409	2.520	1.713			DA1400M-GM ~ DA1440M-GM	140							
SF0625-DRA145M-3	●	\$279.00	0.571	0.590		4.488	2.598	1.772			DA1450M-GM ~ DA1490M-GM	145							
SF0750-DRA150M-3	●	\$299.00	0.591	0.626		0.750	4.764	2.795			1.890	1.969			0.984	DA1500M-GM ~ DA1590M-GM	150	HS-3048TRP	FTP-6
SF0750-DRA160M-3	●	\$299.00	0.630	0.665			4.961	2.992			2.008					DA1600M-GM ~ DA1690M-GM	160		
SF0750-DRA170M-3	●	\$309.00	0.669	0.705	5.118		3.150	2.126	DA1700M-GM ~ DA1790M-GM	170									
SF0750-DRA180M-3	●	\$339.00	0.709	0.744	5.315		3.346	2.244	DA1800M-GM ~ DA1890M-GM	180									
SF0750-DRA190M-3	●	\$359.00	0.748	0.783	5.472	3.504	2.362	DA1900M-GM ~ DA1990M-GM	190										
SF1000-DRA200M-3	●	\$419.00	0.787	0.823	1.000	5.866	3.661	2.480	2.205	1.260	DA2000M-GM ~ DA2090M-GM	200	HS-4067TRP	FTP-7					
SF1000-DRA210M-3	●	\$429.00	0.827	0.846		6.024	3.819	2.598			DA2100M-GM ~ DA2150M-GM	210							
SF1000-DRA220M-3	●	\$429.00	0.866	0.886		6.220	4.016	2.717			DA2200M-GM ~ DA2250M-GM	220							
SF1000-DRA230M-3	●	\$459.00	0.906	0.937		6.378	4.173	2.835			DA2300M-GM ~ DA2381M-GM	230							
SF1000-DRA240M-3	●	\$469.00	0.945	0.965		6.535	4.331	2.953			DA2400M-GM ~ DA2450M-GM	240							
SF1000-DRA250M-3	●	\$509.00	0.984	1.004		6.693	4.488	3.071			DA2500M-GM ~ DA2550M-GM	250							

● : U.S. Stock

Kit Includes 1 Drill Body and 2 Inserts

KYOCERA Precision Tools, Inc.

P: 800.823.7284 • F: 828.692.1344 • E: ctsales@kyocera.com
Official Website | www.kyoceraprecisiontools.com

DRA Toolholders (with Flange - 5D)

Choose (1) 5D Drill Body and (2) Inserts for Special Kit Price or Purchase (11) Inserts and Receive a 5D Drill Body FREE

Chosen inserts must fit purchased drill body but do not need to be the same.

Promo Code: **KYO-DRA-KIT**

Promo Code: **KYO-DRA-FREE**

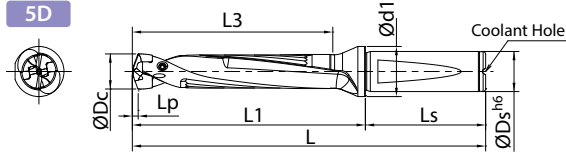

For Lp dimension, reference insert dimension table.



Part Number	Stock	U.S. Kit Price	Dimension (in)								Applicable Insert See Page 32-33	Seat Size	Spare Parts	
			ØDc		ØDs	L	L1	L3	Ls	Ød1			Clamp Screw	Wrench
			min.	max.										
SF0500-DRA080M-5	●	\$279.00	0.313	0.331	0.500	3.976	2.205	1.673	1.772	0.630	DA0794M-GM ~ DA0840M-GM	080	HS-2524TRP	
SF0500-DRA085M-5	●	\$279.00	0.335	0.350		4.094	2.323	1.772			DA0850M-GM ~ DA0890M-GM	085		
SF0500-DRA090M-5	●	\$279.00	0.354	0.370		4.213	2.441	1.870			DA0900M-GM ~ DA0940M-GM	090		
SF0500-DRA095M-5	●	\$279.00	0.374	0.390		4.331	2.559	1.969			DA0950M-GM ~ DA0990M-GM	095		
SF0625-DRA100M-5	●	\$289.00	0.394	0.409	0.625	4.567	2.677	2.067	1.890	0.787	DA1000M-GM ~ DA1040M-GM	100	HS-2534TRP	FTP-5
SF0625-DRA105M-5	●	\$309.00	0.413	0.429		4.685	2.795	2.165			DA1050M-GM ~ DA1090M-GM	105		
SF0625-DRA110M-5	●	\$309.00	0.433	0.449		4.843	2.953	2.264			DA1100M-GM ~ DA1140M-GM	110		
SF0625-DRA115M-5	●	\$299.00	0.453	0.469		4.961	3.071	2.362			DA1150M-GM ~ DA1190M-GM	115		
SF0625-DRA120M-5	●	\$309.00	0.472	0.488		5.079	3.189	2.461			DA1200M-GM ~ DA1240M-GM	120		
SF0625-DRA125M-5	●	\$309.00	0.492	0.508		5.197	3.307	2.559			DA1250M-GM ~ DA1290M-GM	125		
SF0625-DRA130M-5	●	\$309.00	0.512	0.528		5.315	3.425	2.657			DA1300M-GM ~ DA1340M-GM	130		
SF0625-DRA135M-5	●	\$309.00	0.531	0.547		5.433	3.543	2.756			DA1350M-GM ~ DA1390M-GM	135		
SF0625-DRA140M-5	●	\$309.00	0.551	0.567		5.551	3.661	2.854			DA1400M-GM ~ DA1440M-GM	140		
SF0625-DRA145M-5	●	\$309.00	0.571	0.590		5.669	3.780	2.953			DA1450M-GM ~ DA1490M-GM	145		
SF0750-DRA150M-5	●	\$339.00	0.591	0.626		0.750	6.024	4.055			3.150	1.969		
SF0750-DRA160M-5	●	\$339.00	0.630	0.665	6.299		4.331	3.346	DA1600M-GM ~ DA1690M-GM	160				
SF0750-DRA170M-5	●	\$349.00	0.669	0.705	6.535		4.567	3.543	DA1700M-GM ~ DA1790M-GM	170				
SF0750-DRA180M-5	●	\$389.00	0.709	0.744	6.811		4.843	3.740	DA1800M-GM ~ DA1890M-GM	180				
SF0750-DRA190M-5	●	\$409.00	0.748	0.783	7.047	5.079	3.937	DA1900M-GM ~ DA1990M-GM	190					
SF1000-DRA200M-5	●	\$479.00	0.787	0.823	1.000	7.520	5.315	4.134	2.205	1.260	DA2000M-GM ~ DA2090M-GM	200	HS-4067TRP	FTP-7
SF1000-DRA210M-5	●	\$489.00	0.827	0.846		7.756	5.551	4.331			DA2100M-GM ~ DA2150M-GM	210		
SF1000-DRA220M-5	●	\$489.00	0.866	0.886		8.031	5.827	4.528			DA2200M-GM ~ DA2250M-GM	220		
SF1000-DRA230M-5	●	\$519.00	0.906	0.937		8.268	6.063	4.724			DA2300M-GM ~ DA2381M-GM	230		
SF1000-DRA240M-5	●	\$539.00	0.945	0.965		8.504	6.299	4.921			DA2400M-GM ~ DA2450M-GM	240		
SF1000-DRA250M-5	●	\$579.00	0.984	1.004		8.740	6.535	5.116			DA2500M-GM ~ DA2550M-GM	250		

● : U.S. Stock

Kit Includes 1 Drill Body and 2 Inserts

All 2017 Summer / Fall Promo Offers Valid through December 31, 2017

All promo items are available exclusively through Authorized North American Kyocera Precision Tool Distributors. Please use specified Promo Code when placing orders.

To locate a distributor visit www.kyoceraprecisiontools.com/locate. Prices Shown Valid in U.S. Only.

DRA Toolholders (with Flange - 8D)

Choose (1) 8D Drill Body and (2) Inserts for Special Kit Price or Purchase (12) Inserts and Receive a 8D Drill Body FREE

Chosen inserts must fit purchased drill body but do not need to be the same.

Promo Code: **KYO-DRA-KIT**

Promo Code: **KYO-DRA-FREE**

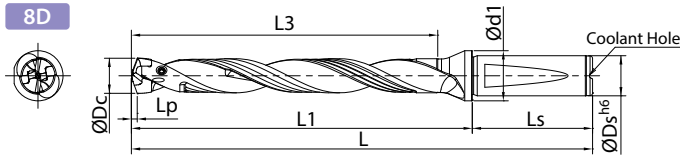

For Lp dimension, reference insert dimension table.



Part Number	Stock	U.S. Kit Price	Dimension (in)							Applicable Insert See Page 32-33	Seat Size	Spare Parts							
			ØDc		ØDs	L	L1	L3	Ls			Ød1	Clamp Screw	Wrench					
			min.	max.															
SF0500-DRA080M-8	●	\$329.00	0.313	0.331	0.500	4.961	3.189	2.677	1.772	0.630	DA0794M-GM ~ DA0840M-GM	080	HS-2524TRP						
SF0500-DRA085M-8	●	\$329.00	0.335	0.350		5.157	3.386	2.835			DA0850M-GM ~ DA0890M-GM	085							
SF0500-DRA090M-8	●	\$329.00	0.354	0.370		5.315	3.543	2.992			DA0900M-GM ~ DA0940M-GM	090							
SF0500-DRA095M-8	●	\$329.00	0.374	0.390		5.512	3.740	3.150			DA0950M-GM ~ DA0990M-GM	095							
SF0625-DRA100M-8	●	\$339.00	0.394	0.409	0.625	5.787	3.898	3.307	1.890	0.787	DA1000M-GM ~ DA1040M-GM	100	HS-2534TRP	FTP-5					
SF0625-DRA105M-8	●	\$359.00	0.413	0.429		5.984	4.094	3.465			DA1050M-GM ~ DA1090M-GM	105							
SF0625-DRA110M-8	●	\$359.00	0.433	0.449		6.181	4.291	3.622			DA1100M-GM ~ DA1140M-GM	110							
SF0625-DRA115M-8	●	\$359.00	0.453	0.469		6.378	4.488	3.780			DA1150M-GM ~ DA1190M-GM	115							
SF0625-DRA120M-8	●	\$369.00	0.472	0.488		6.535	4.646	3.937			DA1200M-GM ~ DA1240M-GM	120							
SF0625-DRA125M-8	●	\$359.00	0.492	0.508		6.732	4.843	4.094			DA1250M-GM ~ DA1290M-GM	125							
SF0625-DRA130M-8	●	\$369.00	0.512	0.528		6.890	5.000	4.252			DA1300M-GM ~ DA1340M-GM	130							
SF0625-DRA135M-8	●	\$359.00	0.531	0.547		7.087	5.197	4.409			DA1350M-GM ~ DA1390M-GM	135							
SF0625-DRA140M-8	●	\$359.00	0.551	0.567		7.244	5.354	4.567			DA1400M-GM ~ DA1440M-GM	140							
SF0625-DRA145M-8	●	\$359.00	0.571	0.590		7.441	5.551	4.724			DA1450M-GM ~ DA1490M-GM	145							
SF0750-DRA150M-8	●	\$379.00	0.591	0.626		0.750	7.913	5.945			5.039	1.969			0.984	DA1500M-GM ~ DA1590M-GM	150	HS-3048TRP	FTP-6
SF0750-DRA160M-8	●	\$389.00	0.630	0.665			8.307	6.339			5.354					DA1600M-GM ~ DA1690M-GM	160		
SF0750-DRA170M-8	●	\$399.00	0.669	0.705	8.661		6.693	5.669	DA1700M-GM ~ DA1790M-GM	170									
SF0750-DRA180M-8	●	\$449.00	0.709	0.744	9.055		7.087	5.984	DA1800M-GM ~ DA1890M-GM	180									
SF0750-DRA190M-8	●	\$469.00	0.748	0.783	9.409	7.441	6.299	DA1900M-GM ~ DA1990M-GM	190										
SF1000-DRA200M-8	●	\$549.00	0.787	0.823	1.000	10.000	7.795	6.614	2.205	1.260	DA2000M-GM ~ DA2090M-GM	200	HS-4067TRP	FTP-7					
SF1000-DRA210M-8	●	\$559.00	0.827	0.846		10.354	8.150	6.929			DA2100M-GM ~ DA2150M-GM	210							
SF1000-DRA220M-8	●	\$559.00	0.866	0.886		10.748	8.543	7.244			DA2200M-GM ~ DA2250M-GM	220							
SF1000-DRA230M-8	●	\$599.00	0.906	0.937		11.102	8.898	7.559			DA2300M-GM ~ DA2381M-GM	230							
SF1000-DRA240M-8	●	\$609.00	0.945	0.965		11.457	9.252	7.874			DA2400M-GM ~ DA2450M-GM	240							
SF1000-DRA250M-8	●	\$659.00	0.984	1.004		11.811	9.606	8.189			DA2500M-GM ~ DA2550M-GM	250							

● : U.S. Stock

Kit Includes 1 Drill Body and 2 Inserts

KYOCERA Precision Tools, Inc.

P: 800.823.7284 • F: 828.692.1344 • E: ctsales@kyocera.com
 Official Website | www.kyoceraprecisiontools.com

DRA Inserts

Cutting Diameter $\varnothing 0.313'' \sim \varnothing 0.528''$ ($\varnothing 7.94\text{mm} \sim \varnothing 13.40\text{mm}$)

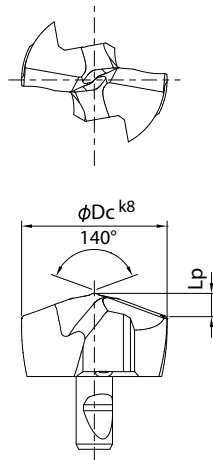

k8 Tolerance

$\varnothing Dc$ (in)	k8 (in)	$\varnothing Dc$ (mm)	k8 (mm)
0.313 ~ 0.394	+0.0009 0	7.94 ~ 10.00	+0.022 0
0.394 ~ 0.709	+0.0011 0	10.10 ~ 18.00	+0.027 0
0.713 ~ 1.004	+0.0013 0	18.10 ~ 25.50	+0.033 0

k8 is the dimension tolerance of the insert.
It is not the tolerance of the cutting diameter.

1st Recommendation

Steel PR1535	Cast Iron PR1525
-----------------	---------------------

Description	Dimensions			Grade		Seat Size	Applicable Toolholder
	$\varnothing Dc$		L_p (in)	PR1535	PR1525		
	in	mm					
DA0794M-GM	0.313	7.94	0.053	●	●	080	SS0375-DRA080M-○ SF0500-DRA080M-○
DA0800M-GM	0.315	8.00	0.053	●	●		
DA0810M-GM	0.319	8.10	0.054	●	●		
DA0818M-GM	0.322	8.18	0.054	●	●		
DA0820M-GM	0.323	8.20	0.055	●	●		
DA0830M-GM	0.327	8.30	0.055	●	●		
DA0840M-GM	0.331	8.40	0.056	●	●		
DA0850M-GM	0.335	8.50	0.057	●	●		
DA0860M-GM	0.339	8.60	0.057	●	●	085	SS0375-DRA085M-○ SF0500-DRA085M-○
DA0870M-GM	0.343	8.70	0.058	●	●		
DA0880M-GM	0.346	8.80	0.059	●	●		
DA0890M-GM	0.350	8.90	0.060	●	●		
DA0900M-GM	0.354	9.00	0.060	●	●	090	SS0375-DRA090M-○ SF0500-DRA090M-○
DA0910M-GM	0.358	9.10	0.061	●	●		
DA0920M-GM	0.362	9.20	0.061	●	●		
DA0930M-GM	0.366	9.30	0.062	●	●		
DA0940M-GM	0.370	9.40	0.063	●	●		
DA0950M-GM	0.374	9.50	0.063	●	●	095	SS0500-DRA095M-○ SF0500-DRA095M-○
DA0953M-GM	0.375	9.53	0.064	●	●		
DA0960M-GM	0.378	9.60	0.064	●	●		
DA0970M-GM	0.382	9.70	0.065	●	●		
DA0980M-GM	0.386	9.80	0.066	●	●		
DA0990M-GM	0.390	9.90	0.066	●	●	100	SS0500-DRA100M-○ SF0625-DRA100M-○
DA1000M-GM	0.394	10.00	0.067	●	●		
DA1010M-GM	0.398	10.10	0.068	●	●		
DA1020M-GM	0.402	10.20	0.068	●	●		
DA1030M-GM	0.406	10.30	0.069	●	●		
DA1040M-GM	0.409	10.40	0.070	●	●		

Description	Dimensions			Grade		Seat Size	Applicable Toolholder
	$\varnothing Dc$		L_p (in)	PR1535	PR1525		
	in	mm					
DA1050M-GM	0.413	10.50	0.071	●	●	105	SS0500-DRA105M-○ SF0625-DRA105M-○
DA1060M-GM	0.417	10.60	0.071	●	●		
DA1070M-GM	0.421	10.70	0.072	●	●		
DA1072M-GM	0.422	10.72	0.072	●	●		
DA1080M-GM	0.425	10.80	0.073	●	●		
DA1090M-GM	0.429	10.90	0.073	●	●		
DA1100M-GM	0.433	11.00	0.074	●	●		
DA1110M-GM	0.437	11.10	0.074	●	●		
DA1120M-GM	0.441	11.20	0.075	●	●		
DA1130M-GM	0.445	11.30	0.076	●	●		
DA1140M-GM	0.449	11.40	0.076	●	●		
DA1150M-GM	0.453	11.50	0.077	●	●	115	SS0500-DRA115M-○ SF0625-DRA115M-○
DA1160M-GM	0.457	11.60	0.078	●	●		
DA1170M-GM	0.461	11.70	0.079	●	●		
DA1180M-GM	0.465	11.80	0.079	●	●		
DA1190M-GM	0.469	11.90	0.080	●	●		
DA1200M-GM	0.472	12.00	0.080	●	●	120	SS0625-DRA120M-○ SF0625-DRA120M-○
DA1210M-GM	0.476	12.10	0.081	●	●		
DA1220M-GM	0.480	12.20	0.081	●	●		
DA1230M-GM	0.484	12.30	0.082	●	●		
DA1240M-GM	0.488	12.40	0.083	●	●		
DA1250M-GM	0.492	12.50	0.083	●	●	125	SS0625-DRA125M-○ SF0625-DRA125M-○
DA1260M-GM	0.496	12.60	0.084	●	●		
DA1270M-GM	0.500	12.70	0.085	●	●		
DA1280M-GM	0.504	12.80	0.086	●	●		
DA1290M-GM	0.508	12.90	0.086	●	●		
DA1300M-GM	0.512	13.00	0.087	●	●	130	SS0625-DRA130M-○ SF0625-DRA130M-○
DA1310M-GM	0.516	13.10	0.087	●	●		
DA1320M-GM	0.520	13.20	0.088	●	●		
DA1330M-GM	0.524	13.30	0.089	●	●		
DA1340M-GM	0.528	13.40	0.089	●	●		

● : U.S. Stock

Inserts Sold in 1 Piece Boxes | Kits Include 2 Inserts

All 2017 Summer / Fall Promo Offers Valid through December 31, 2017

All promo items are available exclusively through Authorized North American Kyocera Precision Tool Distributors. Please use specified Promo Code when placing orders.

To locate a distributor visit www.kyoceraprecisiontools.com/locate. Prices Shown Valid in U.S. Only.

1st Recommendation

Steel
PR1535

Cast Iron
PR1525

DRA Inserts (Continued)

Cutting Diameter Ø0.531" ~ Ø1.004" (Ø13.50mm ~ Ø25.50mm)

Description	Dimensions			Grade		Seat Size	Applicable Toolholder	Description	Dimensions			Grade		Seat Size	Applicable Toolholder
	ØDc		Lp (in)	PR1535	PR1525				ØDc		Lp (in)	PR1535	PR1525		
	in	mm							in	mm					
DA1350M-GM	0.531	13.50	0.090	●	●	135	SS0625-DRA135M-○ SF0625-DRA135M-○	DA1800M-GM	0.709	18.00	0.120	●	●	180	SS0750-DRA180M-○ SF0750-DRA180M-○
DA1360M-GM	0.535	13.60	0.091	●	●			DA1810M-GM	0.713	18.10	0.120	●	●		
DA1370M-GM	0.539	13.70	0.092	●	●			DA1820M-GM	0.717	18.20	0.121	●	●		
DA1380M-GM	0.543	13.80	0.092	●	●			DA1830M-GM	0.720	18.30	0.122	●	●		
DA1390M-GM	0.547	13.90	0.093	●	●			DA1840M-GM	0.724	18.40	0.122	●	●		
DA1400M-GM	0.551	14.00	0.092	●	●	DA1850M-GM	0.728	18.50	0.123	●	●				
DA1410M-GM	0.555	14.10	0.092	●	●	DA1860M-GM	0.732	18.60	0.124	●	●				
DA1420M-GM	0.559	14.20	0.093	●	●	DA1870M-GM	0.736	18.70	0.125	●	●				
DA1430M-GM	0.563	14.30	0.094	●	●	DA1880M-GM	0.740	18.80	0.125	●	●				
DA1440M-GM	0.567	14.40	0.094	●	●	DA1890M-GM	0.744	18.90	0.126	●	●				
DA1450M-GM	0.571	14.50	0.095	●	●	DA1900M-GM	0.748	19.00	0.126	●	●				
DA1460M-GM	0.575	14.60	0.096	●	●	DA1905M-GM	0.750	19.05	0.127	●	●				
DA1468M-GM	0.578	14.68	0.096	●	●	DA1910M-GM	0.752	19.10	0.127	●	●				
DA1470M-GM	0.579	14.70	0.097	●	●	DA1920M-GM	0.756	19.20	0.128	●	●				
DA1480M-GM	0.583	14.80	0.097	●	●	DA1930M-GM	0.760	19.30	0.129	●	●				
DA1490M-GM	0.587	14.90	0.098	●	●	DA1940M-GM	0.764	19.40	0.129	●	●				
DA1500M-GM	0.591	15.00	0.099	●	●	DA1950M-GM	0.768	19.50	0.130	●	●				
DA1510M-GM	0.594	15.10	0.100	●	●	DA1960M-GM	0.772	19.60	0.131	●	●				
DA1520M-GM	0.598	15.20	0.101	●	●	DA1970M-GM	0.776	19.70	0.132	●	●				
DA1530M-GM	0.602	15.30	0.101	●	●	DA1980M-GM	0.780	19.80	0.132	●	●				
DA1540M-GM	0.606	15.40	0.102	●	●	DA1990M-GM	0.783	19.90	0.133	●	●				
DA1550M-GM	0.610	15.50	0.103	●	●	DA2000M-GM	0.787	20.00	0.133	●	●				
DA1560M-GM	0.614	15.60	0.103	●	●	DA2010M-GM	0.791	20.10	0.134	●	●				
DA1570M-GM	0.618	15.70	0.104	●	●	DA2020M-GM	0.795	20.20	0.134	●	●				
DA1580M-GM	0.622	15.80	0.105	●	●	DA2030M-GM	0.799	20.30	0.135	●	●				
DA1590M-GM	0.626	15.90	0.106	●	●	DA2040M-GM	0.803	20.40	0.136	●	●				
DA1600M-GM	0.630	16.00	0.106	●	●	DA2050M-GM	0.807	20.50	0.136	●	●				
DA1610M-GM	0.634	16.10	0.107	●	●	DA2060M-GM	0.811	20.60	0.137	●	●				
DA1620M-GM	0.638	16.20	0.107	●	●	DA2064M-GM	0.813	20.64	0.137	●	●				
DA1630M-GM	0.642	16.30	0.108	●	●	DA2070M-GM	0.815	20.70	0.138	●	●				
DA1640M-GM	0.646	16.40	0.109	●	●	DA2080M-GM	0.819	20.80	0.139	●	●				
DA1650M-GM	0.650	16.50	0.110	●	●	DA2090M-GM	0.823	20.90	0.139	●	●				
DA1660M-GM	0.654	16.60	0.110	●	●	DA2100M-GM	0.827	21.00	0.140	●	●				
DA1667M-GM	0.656	16.67	0.111	●	●	DA2150M-GM	0.846	21.50	0.143	●	●				
DA1670M-GM	0.657	16.70	0.111	●	●	DA2200M-GM	0.866	22.00	0.146	●	●				
DA1680M-GM	0.661	16.80	0.112	●	●	DA2223M-GM	0.875	22.23	0.148	●	●				
DA1690M-GM	0.665	16.90	0.112	●	●	DA2250M-GM	0.886	22.50	0.150	●	●				
DA1700M-GM	0.669	17.00	0.113	●	●	DA2300M-GM	0.906	23.00	0.153	●	●				
DA1710M-GM	0.673	17.10	0.113	●	●	DA2350M-GM	0.925	23.50	0.156	●	●				
DA1720M-GM	0.677	17.20	0.114	●	●	DA2381M-GM	0.937	23.81	0.158	●	●				
DA1730M-GM	0.681	17.30	0.115	●	●	DA2400M-GM	0.945	24.00	0.159	●	●				
DA1740M-GM	0.685	17.40	0.116	●	●	DA2450M-GM	0.965	24.50	0.163	●	●				
DA1746M-GM	0.687	17.46	0.116	●	●	DA2500M-GM	0.984	25.00	0.165	●	●				
DA1750M-GM	0.689	17.50	0.116	●	●	DA2540M-GM	1.000	25.40	0.168	●	●				
DA1760M-GM	0.693	17.60	0.117	●	●	DA2550M-GM	1.004	25.50	0.169	●	●				
DA1770M-GM	0.697	17.70	0.118	●	●										
DA1780M-GM	0.701	17.80	0.118	●	●										
DA1790M-GM	0.705	17.90	0.119	●	●										

● : U.S. Stock

Inserts Sold in 1 Piece Boxes | Kits Include 2 Inserts

KYOCERA Precision Tools, Inc.

P: 800.823.7284 • F: 828.692.1344 • E: ctsales@kyocera.com
Official Website | www.kyoceraprecisiontools.com



DRZ Magic Drill Kits

Stable and Efficient Indexable Drills

Four Cutting Edges per Insert

Promotes cost savings and increased efficiency with a single insert in both pockets

Smooth Chip Evacuation

Molded chipbreaker produces three separate chips for smooth chip evacuation

MEGACOAT PVD for Long Tool Life

MEGACOAT PVD coated carbides for stable machining of a variety of applications

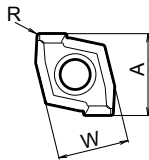
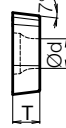

DRZ Magic Drill Inserts													
Usage Classification		P	Carbon Steel / Alloy Steel					★	☆				
			Mold Steel					★					
★ 1st Choice ☆ 2nd Choice		M	Stainless Steel					☆	★				
			K	Gray Cast Iron							★		
		Ductile Cast Iron											
		N					Non-ferrous Metals						
Insert		Part Number	Dimensions (in)					Angle	MEGACOAT				Uncoated Carbide
			A	T	Ød	W	rε	α	PR1230	PR1225	PR1210	KW10	
  	ZCMT 050203	0.232	0.094	0.091	0.107	0.012	7°	●	●	●	●		
	06T204	0.276	0.110	0.098	0.236	0.016	7°	●	●	●	●		
	080304	0.381	0.125	0.114	0.323	0.016	7°	●	●	●	●		
	10T304	0.473	0.156	0.173	0.409	0.016	7°	●	●	●	●		
	12T306	0.562	0.156	0.220	0.504	0.024	7°	●	●	●	●		
	150408	0.702	0.187	0.220	0.622	0.031	7°	●	●	●	●		

● : U.S. Stock

Inserts sold in 10 piece boxes

All 2017 Summer / Fall Promo Offers Valid through December 31, 2017

All promo items are available exclusively through Authorized North American Kyocera Precision Tool Distributors. Please use specified Promo Code when placing orders.

To locate a distributor visit www.kyoceraprecisiontools.com/locate. Prices Shown Valid in U.S. Only.

Inch Dia. / Inch Shank
DRZ Toolholders (Ø0.562"~Ø2.000")



Choose (1) Drill Body and (10) Inserts

Choose your drill and insert grade.
 Promo Code: **KYO-DRZ-KIT**

2xD

Drill Description	Stock	Drill Dia.	Insert Description See ☺ Page 34	Grades (Pick 1)	Kit Option	
					Kit Insert Qty.	U.S. Kit Price
S75-DRZ5621125-05G	●	0.562"	ZCMT050203	PR1230 Carbon Steel & Alloy Steel PR1225 Stainless Steel PR1210 Gray and Nodular Cast Iron KW10 Non-ferrous Metals	10	\$299.00
S100-DRZ6251250-06G	●	0.625"	ZCMT06T204		10	\$309.00
S100-DRZ6561312-06G	●	0.656"			10	\$309.00
S100-DRZ6881375-06G	●	0.688"			10	\$309.00
S100-DRZ7501500-06G	●	0.750"			10	\$309.00
S100-DRZ8121625-06G	●	0.812"			10	\$309.00
S100-DRZ8751750-08G	●	0.875"	ZCMT080304		10	\$309.00
S100-DRZ9381875-08G	●	0.938"			10	\$309.00
S100-DRZ10002000-08G	●	1.000"			10	\$349.00
S100-DRZ10622125-10G	●	1.062"	ZCMT10T304		10	\$349.00
S100-DRZ11252250-10G	●	1.125"			10	\$349.00
S100-DRZ11882375-10G	●	1.188"			10	\$349.00
S100-DRZ12502500-10G	●	1.250"			10	\$349.00
S125-DRZ13122625-12G	●	1.312"	ZCMT12T306		10	\$349.00
S125-DRZ13752750-12G	●	1.375"			10	\$349.00
S125-DRZ14382875-12G	●	1.438"			10	\$349.00
S125-DRZ15003000-12G	●	1.500"			10	\$349.00
S125-DRZ15623125-12G	●	1.562"			10	\$419.00
S125-DRZ16253250-15G	●	1.625"			10	\$419.00
S125-DRZ16883375-15G	●	1.688"			10	\$419.00
S125-DRZ17503500-15G	●	1.750"		10	\$419.00	
S125-DRZ18123625-15G	●	1.812"	ZCMT150408	10	\$419.00	
S125-DRZ18753750-15G	●	1.875"		10	\$419.00	
S125-DRZ19383875-15G	●	1.938"		10	\$419.00	
S125-DRZ20004000-15G	●	2.000"		10	\$419.00	

DRZ
Magic Drills
2xD

● : U.S. Stock

KYOCERA Precision Tools, Inc.

P: 800.823.7284 • F: 828.692.1344 • E: ctsales@kyocera.com
 Official Website | www.kyoceraprecisiontools.com

Inch Dia. / Inch Shank
DRZ Toolholders (Ø0.562"~Ø2.000")

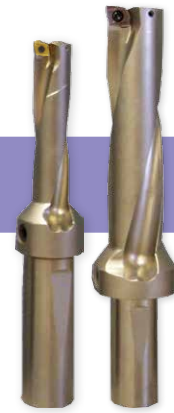

Choose (1) Drill Body and (10) Inserts

Choose your drill and insert grade.
 Promo Code: **KYO-DRZ-KIT**

3xD

Drill Description	Stock	Drill Dia.	Insert Description See Page 34	Grades (Pick 1)	Kit Option		
					Kit Insert Qty.	U.S. Kit Price	
S75-DRZ5621687-05G	●	0.562"	ZCMT050203	PR1230 Carbon Steel & Alloy Steel PR1225 Stainless Steel PR1210 Gray and Nodular Cast Iron KW10 Non-ferrous Metals	10	\$299.00	
S100-DRZ6251875-06G	●	0.625"	ZCMT06T204		10	\$309.00	
S100-DRZ6561969-06G	●	0.656"			10	\$309.00	
S100-DRZ6882062-06G	●	0.688"			10	\$309.00	
S100-DRZ7502250-06G	●	0.750"			10	\$309.00	
S100-DRZ8122438-06G	●	0.812"			10	\$309.00	
S100-DRZ8752625-08G	●	0.875"	ZCMT080304		10	\$309.00	
S100-DRZ9382814-08G	●	0.938"			10	\$309.00	
S100-DRZ10003000-08G	●	1.000"			10	\$349.00	
S100-DRZ10623187-10G	●	1.062"	ZCMT10T304		10	\$349.00	
S100-DRZ11253375-10G	●	1.125"			10	\$349.00	
S100-DRZ11883562-10G	●	1.188"			10	\$349.00	
S100-DRZ12503750-10G	●	1.250"	ZCMT12T306		10	\$349.00	
S125-DRZ13123938-12G	●	1.312"			10	\$369.00	
S125-DRZ13754125-12G	●	1.375"			10	\$369.00	
S125-DRZ14384312-12G	●	1.438"			10	\$369.00	
S125-DRZ15004500-12G	●	1.500"			10	\$369.00	
S125-DRZ15624688-12G	●	1.562"			10	\$449.00	
S125-DRZ16254875-15G	●	1.625"			ZCMT150408	10	\$449.00
S125-DRZ16885062-15G	●	1.688"				10	\$449.00
S125-DRZ17505250-15G	●	1.750"	10	\$449.00			
S125-DRZ18125438-15G	●	1.812"	10	\$449.00			
S125-DRZ18755625-15G	●	1.875"	10	\$449.00			
S125-DRZ19385812-15G	●	1.938"	10	\$449.00			
S125-DRZ20006000-15G	●	2.000"	10	\$449.00			

● : U.S. Stock

All 2017 Summer / Fall Promo Offers Valid through December 31, 2017

All promo items are available exclusively through Authorized North American Kyocera Precision Tool Distributors. Please use specified Promo Code when placing orders.

To locate a distributor visit www.kyoceraprecisiontools.com/locate. Prices Shown Valid in U.S. Only.

Metric Dia. / Inch Shank
DRZ Toolholders (Ø13mm~Ø49mm)



Choose (1) Drill Body and (10) Inserts

Choose your drill and insert grade.
 Promo Code: **KYO-DRZ-KIT**

3xD

Drill Description	Stock	Drill Dia.	Insert Description See Page 34	Grades (Pick 1)	Kit Option	
					Kit Insert Qty.	U.S. Kit Price
DRZ Magic Drills 3xD Metric Diameter Inch Shank	●	13.0mm	ZCMT050203	PR1230 Carbon Steel & Alloy Steel PR1225 Stainless Steel PR1210 Gray and Nodular Cast Iron KW10 Non-ferrous Metals	10	\$309.00
	●	13.5mm			10	\$309.00
	●	14.0mm			10	\$309.00
	●	14.5mm			10	\$309.00
	●	15.0mm			10	\$309.00
	●	15.5mm			10	\$309.00
	●	16.0mm	ZCMT06T204		10	\$309.00
	●	16.5mm			10	\$309.00
	●	17.0mm			10	\$309.00
	●	18.0mm			10	\$309.00
	●	18.5mm			10	\$309.00
	●	19.0mm			10	\$309.00
	●	19.5mm	ZCMT080304		10	\$309.00
	●	20.0mm			10	\$309.00
	●	21.0mm			10	\$309.00
	●	21.5mm			10	\$319.00
	●	22.0mm			10	\$319.00
	●	22.0mm			10	\$319.00
	●	23.0mm	ZCMT10T304		10	\$319.00
	●	24.0mm			10	\$319.00
	●	25.0mm			10	\$319.00
	●	26.0mm			10	\$349.00
	●	27.0mm			10	\$349.00
	●	28.0mm			10	\$349.00
	●	29.0mm	ZCMT12T306		10	\$349.00
	●	30.0mm			10	\$349.00
	●	31.0mm			10	\$349.00
	●	32.0mm			10	\$349.00
	●	33.0mm			10	\$359.00
	●	34.0mm			10	\$349.00
	●	35.0mm	ZCMT150408		10	\$349.00
	●	36.0mm			10	\$349.00
	●	37.0mm			10	\$349.00
	●	38.0mm			10	\$349.00
	●	39.0mm			10	\$419.00
	●	40.0mm			10	\$419.00
	●	41.0mm	ZCMT150408		10	\$419.00
	●	42.0mm			10	\$419.00
	●	43.0mm			10	\$419.00
	●	44.0mm			10	\$419.00
	●	45.0mm			10	\$419.00
	●	46.0mm			10	\$419.00
●	47.0mm	ZCMT150408	10	\$419.00		
●	48.0mm		10	\$419.00		
●	49.0mm		10	\$419.00		

● : U.S. Stock

KYOCERA Precision Tools, Inc.

P: 800.823.7284 • F: 828.692.1344 • E: ctsales@kyocera.com
 Official Website | www.kyoceraprecisiontools.com

Inch Dia. / Inch Shank
DRZ Toolholders (Ø0.562"~Ø2.000")



Choose (1) Drill Body and (10) Inserts

Choose your drill and insert grade.
 Promo Code: **KYO-DRZ-KIT**

4xD

Drill Description	Stock	Drill Dia.	Insert Description See Page 34	Grades (Pick 1)	Kit Option	
					Kit Insert Qty.	U.S. Kit Price
S75-DRZ5622250-05G	●	0.562"	ZCMT050203	PR1230 Carbon Steel & Alloy Steel PR1225 Stainless Steel PR1210 Gray and Nodular Cast Iron KW10 Non-ferrous Metals	10	\$319.00
S100-DRZ6252500-06G	●	0.625"	ZCMT06T204		10	\$319.00
S100-DRZ6882750-06G	●	0.688"			10	\$319.00
S100-DRZ7503000-06G	●	0.750"			10	\$319.00
S100-DRZ8123250-06G	●	0.812"			10	\$319.00
S100-DRZ8753500-08G	●	0.875"	ZCMT080304		10	\$319.00
S100-DRZ9383750-08G	●	0.938"			10	\$319.00
S100-DRZ10004000-08G	●	1.000"			10	\$319.00
S125-DRZ10624250-10G	●	1.062"	ZCMT10T304		10	\$369.00
S125-DRZ11254500-10G	●	1.125"			10	\$369.00
S125-DRZ11884750-10G	●	1.188"			10	\$369.00
S125-DRZ12505000-10G	●	1.250"			10	\$369.00
S125-DRZ13125250-12G	●	1.312"	ZCMT12T306		10	\$369.00
S125-DRZ13755500-12G	●	1.375"			10	\$369.00
S125-DRZ14385750-12G	●	1.438"			10	\$369.00
S125-DRZ15006000-12G	●	1.500"			10	\$369.00
S125-DRZ15626250-12G	●	1.562"			10	\$369.00
S125-DRZ16256500-15G	●	1.625"			ZCMT150408	10
S150-DRZ16886750-15G	●	1.688"	10			\$419.00
S150-DRZ17507000-15G	●	1.750"	10			\$419.00
S150-DRZ18127250-15G	●	1.812"	10	\$419.00		
S150-DRZ18757500-15G	●	1.875"	10	\$419.00		
S150-DRZ19387750-15G	●	1.938"	10	\$419.00		
S150-DRZ20008000-15G	●	2.000"	10	\$419.00		

● : U.S. Stock

All 2017 Summer / Fall Promo Offers Valid through December 31, 2017

All promo items are available exclusively through Authorized North American Kyocera Precision Tool Distributors. Please use specified Promo Code when placing orders.

To locate a distributor visit www.kyoceraprecisiontools.com/locate. Prices Shown Valid in U.S. Only.

Inch Dia. / Inch Shank
DRZ Toolholders (Ø1.062" ~ Ø2.000")



Choose (1) Drill Body and (10) Inserts

Choose your drill and insert grade.
 Promo Code: **KYO-DRZ-KIT**

5xD

Drill Description	Stock	Drill Dia.	Insert Description See Page 34	Grades (Pick 1)	Kit Option		
					Kit Insert Qty.	U.S. Kit Price	
DRZ Magic Drills 5xD	S125-DRZ10625310-10G	●	1.062"	ZCMT10T304	PR1230 Carbon Steel & Alloy Steel PR1225 Stainless Steel PR1210 Gray and Nodular Cast Iron KW10 Non-ferrous Metals	10	\$419.00
	S125-DRZ11255625-10G	●	1.125"			10	\$419.00
	S125-DRZ11885940-10G	●	1.188"			10	\$419.00
	S125-DRZ12506250-10G	●	1.250"			10	\$419.00
	S125-DRZ13126560-12G	●	1.312"			ZCMT12T306	10
	S125-DRZ13756875-12G	●	1.375"	10			\$449.00
	S125-DRZ14387190-12G	●	1.438"	10			\$449.00
	S125-DRZ15007500-12G	●	1.500"	10			\$449.00
	S125-DRZ15627810-12G	●	1.562"	10			\$449.00
	S125-DRZ16258125-15G	●	1.625"	ZCMT150408		10	\$459.00
	S150-DRZ16888440-15G	●	1.188"			10	\$459.00
	S150-DRZ17508750-15G	●	1.750"			10	\$459.00
	S150-DRZ18129060-15G	●	1.812"			10	\$459.00
	S150-DRZ18759375-15G	●	1.875"			10	\$459.00
	S150-DRZ19389690-15G	●	1.938"			10	\$459.00
	S150-DRZ200010000-15G	●	2.000"	10		\$459.00	

● : U.S. Stock



HOLESHOT™ Kits

DR Indexable Drills

Optimized Flute Design

Maximum rigidity and good chip evacuation

Patented Swept Back Design

Enables drilling of stacked plates and welded assemblies

Excellent Chip Control

Reduces slug formation with superior chip control



Patented Swept Back Design



HOLESHOT Drill Inserts

Usage Classification	P	Carbon Steel / Alloy Steel		★			
		Mold Steel		★			
★ 1st Choice ☆ 2nd Choice	M	Stainless Steel		☆			
		K	Gray Cast Iron				
			Ductile Cast Iron				
Insert	Part Number	Dimensions (in)				Angle	MEGACOAT
		A	T	Ød	rε	α	PR1230
	WCMX 040204-M1A	1/4	0.094	0.110	1/64	7°	●
	050308-M1	5/16	1/8	0.125	1/32		●
	050308-M1A	5/16	1/8	0.125	1/32		●
	06T308-M1	3/8	5/32	0.146	1/32		●
	06T308-M1A	3/8	5/32	0.146	1/32		●

WCMX...M1 : General purpose drilling insert. First choice for medium-high carbon steel, tool steels, and cast iron. Tougher edge than **M1A** chipbreaker.

WCMX...M1A : First choice for low-carbon steel and other "sticky" materials. Freer cutting than **M1** chipbreaker

● : U.S. Stock

Inserts sold in 10 piece boxes

All 2017 Summer / Fall Promo Offers Valid through December 31, 2017

All promo items are available exclusively through Authorized North American Kyocera Precision Tool Distributors. Please use specified Promo Code when placing orders.

To locate a distributor visit www.kyoceraprecisiontools.com/locate. Prices Shown Valid in U.S. Only.

HOLESHOT™ (Ø0.688"~Ø1.156")

Choose (1) Drill Body and (10) Inserts

Choose your drill and insert.
 Promo Code: **KYO-DR-KIT**



Drill Description	Stock	Drill Dia.	Insert Description (Pick 1) See Page 40	Grades (Pick 1)	Kit Option	
					Kit Insert Qty.	U.S. Kit Price
Drill Diameter 0.688"~1.156"	●	0.688"	WCMX040204M1A	PR1230 Carbon Steel & Alloy Steel	10	\$249.00
	●	0.709" (18mm)			10	\$249.00
	●	0.719"			10	\$249.00
	●	0.750"			10	\$269.00
	●	0.781"			10	\$269.00
	●	0.787" (20mm)			10	\$269.00
	●	0.813"			10	\$269.00
	●	0.827" (21mm)			10	\$269.00
	●	0.844"			10	\$269.00
	●	0.866" (22mm)			10	\$279.00
	●	0.866" (22mm)	10		\$309.00	
	●	0.875"	10		\$279.00	
	●	0.875"	10		\$309.00	
	●	0.906" (23mm)	10		\$279.00	
	●	0.906" (23mm)	10		\$309.00	
	●	0.937"	10		\$279.00	
	●	0.937"	10		\$309.00	
	●	0.945" (24mm)	10		\$279.00	
	●	0.945" (24mm)	10		\$309.00	
	●	0.969"	10		\$279.00	
	●	0.969"	10		\$309.00	
	●	0.984" (25mm)	10		\$279.00	
	●	0.984" (25mm)	10		\$309.00	
	●	1.000"	10		\$279.00	
	●	1.000"	10		\$309.00	
	●	1.024" (26mm)	10		\$279.00	
	●	1.024" (26mm)	10		\$309.00	
	●	1.031"	10		\$349.00	
	●	1.031"	10		\$369.00	
	●	1.062" (27mm)	10		\$349.00	
	●	1.062" (27mm)	10		\$369.00	
	●	1.094"	10		\$349.00	
	●	1.094"	10		\$369.00	
	●	1.102" (28mm)	10		\$349.00	
	●	1.102" (28mm)	10		\$369.00	
	●	1.125"	10		\$349.00	
	●	1.125"	10		\$369.00	
	●	1.142" (29mm)	10		\$349.00	
	●	1.142" (29mm)	10		\$369.00	
	●	1.156"	10		\$349.00	
●	1.156"	10	\$369.00			

KYOCERA Precision Tools, Inc.

P: 800.823.7284 • F: 828.692.1344 • E: ctsales@kyocera.com
 Official Website | www.kyoceraprecisiontools.com

● : U.S. Stock

HOLESHOT™ (Ø1.181"~Ø1.562")



Choose (1) Drill Body and (10) Inserts

Choose your drill and insert.
 Promo Code: **KYO-DR-KIT**

Drill Description	Stock	Drill Dia.	Insert Description (Pick 1) See Page 40	Grades (Pick 1)	Kit Option	
					Kit Insert Qty.	U.S. Kit Price
DR-1181	●	1.181" (30mm)	WCMX06T308M1 WCMX06T308M1A	PR1230 Carbon Steel & Alloy Steel	10	\$349.00
DR-1181-X3N	●	1.181" (30mm)			10	\$369.00
DR-1187	●	1.187"			10	\$349.00
DR-1187-X3N	●	1.187"			10	\$369.00
DR-1219	●	1.219"			10	\$349.00
DR-1219-X3N	●	1.219"			10	\$369.00
DR-1250	●	1.250"			10	\$349.00
DR-1250-X3N	●	1.250"			10	\$369.00
DR-1260	●	1.260" (32mm)			10	\$349.00
DR-1260-X3N	●	1.260" (32mm)			10	\$369.00
DR-1281	●	1.281"			10	\$349.00
DR-1281-X3N	●	1.281"			10	\$369.00
DR-1299	●	1.299" (33mm)			10	\$349.00
DR-1299-X3N	●	1.299" (33mm)			10	\$369.00
DR-1312	●	1.312"			10	\$349.00
DR-1312-X3N	●	1.312"			10	\$369.00
DR-1339	●	1.339" (34mm)			10	\$349.00
DR-1339-X3N	●	1.339" (34mm)			10	\$369.00
DR-1344	●	1.344"			10	\$349.00
DR-1344-X3N	●	1.344"			10	\$369.00
DR-1375	●	1.375"			10	\$349.00
DR-1375-X3N	●	1.375"			10	\$369.00
DR-1406	●	1.406"			10	\$389.00
DR-1406-X3N	●	1.406"			10	\$399.00
DR-1417	●	1.417" (36mm)			10	\$389.00
DR-1417-X3N	●	1.417" (36mm)			10	\$399.00
DR-1437	●	1.437"			10	\$389.00
DR-1437-X3N	●	1.437"			10	\$399.00
DR-1457	●	1.457" (37mm)			10	\$389.00
DR-1457-X3N	●	1.457" (37mm)			10	\$399.00
DR-1469	●	1.469"			10	\$389.00
DR-1469-X3N	●	1.469"			10	\$399.00
DR-1496	●	1.496" (38mm)			10	\$389.00
DR-1496-X3N	●	1.496" (38mm)			10	\$399.00
DR-1500	●	1.500"			10	\$389.00
DR-1500-X3N	●	1.500"			10	\$399.00
DR-1531	●	1.531"			10	\$399.00
DR-1531-X3N	●	1.531"			10	\$429.00
DR-1535-X3N	●	1.535" (39mm)			10	\$429.00
DR-1562	●	1.562"			10	\$399.00
DR-1562-X3N	●	1.562"	10	\$429.00		

Drill Diameter
1.181"~1.562"

All 2017 Summer / Fall Promo Offers Valid through December 31, 2017

● : U.S. Stock

All promo items are available exclusively through Authorized North American Kyocera Precision Tool Distributors. Please use specified Promo Code when placing orders.

To locate a distributor visit www.kyoceraprecisiontools.com/locate. Prices Shown Valid in U.S. Only.

HOLESHOT™ (Ø1.575"~Ø2.000")



Choose (1) Drill Body and (10) Inserts

Choose your drill and insert.
 Promo Code: **KYO-DR-KIT**

Drill Description	Stock	Drill Dia.	Insert Description (Pick 1) See Page 40	Grades (Pick 1)	Kit Option	
					Kit Insert Qty.	U.S. Kit Price
DR-1575	●	1.575" (40mm)	WCMX050308M1 WCMX050308M1A	PR1230 Carbon Steel & Alloy Steel	10	\$399.00
DR-1575-X3N	●	1.575" (40mm)			10	\$429.00
DR-1594	●	1.594"			10	\$399.00
DR-1594-X3N	●	1.594"			10	\$429.00
DR-1614	●	1.614" (41mm)			10	\$399.00
DR-1614-X3N	●	1.614" (41mm)			10	\$429.00
DR-1625	●	1.625"			10	\$399.00
DR1625-X3N	●	1.625"			10	\$429.00
DR-1656	●	1.656"			10	\$399.00
DR-1656-X3N	●	1.656"			10	\$429.00
DR-1687	●	1.687"			10	\$399.00
DR-1687-X3N	●	1.687"			10	\$429.00
DR-1693	●	1.693" (43mm)			10	\$419.00
DR-1693-X3N	●	1.693" (43mm)			10	\$449.00
DR-1719	●	1.719"			10	\$419.00
DR-1719-X3N	●	1.719"			10	\$449.00
DR-1732	●	1.732" (44mm)			10	\$419.00
DR-1732-X3N	●	1.732" (44mm)			10	\$449.00
DR-1750	●	1.750"			10	\$419.00
DR-1750-X3N	●	1.750"			10	\$449.00
DR-1772	●	1.772" (45mm)			10	\$419.00
DR-1772-X3N	●	1.772" (45mm)			10	\$449.00
DR-1781	●	1.781"			10	\$419.00
DR-1781-X3N	●	1.781"			10	\$449.00
DR-1812	●	1.812"			10	\$419.00
DR-1812-X3N	●	1.812"			10	\$449.00
DR-1844	●	1.844"			10	\$439.00
DR-1844-X3N	●	1.844"			10	\$469.00
DR-1850	●	1.850" (47mm)			10	\$439.00
DR-1850-X3N	●	1.850" (47mm)			10	\$469.00
DR-1875	●	1.875"			10	\$439.00
DR-1875-X3N	●	1.875"			10	\$469.00
DR-1890-X3N	●	1.890"			10	\$439.00
DR-1906	●	1.906"			10	\$469.00
DR-1906-X3N	●	1.906"			10	\$439.00
DR-1929	●	1.929" (49mm)			10	\$469.00
DR-1929-X3N	●	1.929" (49mm)			10	\$439.00
DR-1937	●	1.937"			10	\$469.00
DR-1937-X3N	●	1.937"			10	\$439.00
DR-1969	●	1.969" (50mm)			10	\$469.00
DR-1969-X3N	●	1.969" (50mm)	10	\$439.00		
DR-2000	●	2.000"	10	\$469.00		
DR-2000-X1	●	2.000"	10	\$439.00		
DR-2000-X3N	●	2.000"	10	\$469.00		

Drill Diameter
1.575"~2.000"

KYOCERA Precision Tools, Inc.

P: 800.823.7284 • F: 828.692.1344 • E: ctsales@kyocera.com
 Official Website | www.kyoceraprecisiontools.com

● : U.S. Stock

HOLESHOT™ (Ø2.008"~Ø2.362")

Choose (1) Drill Body and (10) Inserts

Choose your drill and insert.
 Promo Code: **KYO-DR-KIT**



Drill Description	Stock	Drill Dia.	Insert Description (Pick 1) See Page 40	Grades (Pick 1)	Kit Option	
					Kit Insert Qty.	U.S. Kit Price
DR-2008	●	2.008" (51mm)	WCMX050308M1 WCMX050308M1A	PR1230 Carbon Steel & Alloy Steel	10	\$439.00
DR-2008-X3N	●	2.008" (51mm)			10	\$469.00
DR-2031	●	2.031"			10	\$479.00
DR-2031-X1	●	2.031"			10	\$479.00
DR-2031-X3N	●	2.031"			10	\$479.00
DR-2047	●	2.047" (52mm)			10	\$459.00
DR-2047-X3N	●	2.047" (52mm)			10	\$489.00
DR-2062	●	2.062"			10	\$459.00
DR-2062-X1	●	2.062"			10	\$459.00
DR-2062-X3N	●	2.062"			10	\$489.00
DR-2094	●	2.094"	10		\$459.00	
DR-2094-X1	●	2.094"	10		\$459.00	
DR-2094-X3N	●	2.094"	10		\$489.00	
DR-2125	●	2.125" (54mm)	WCMX06T308M1 WCMX06T308M1A		10	\$459.00
DR-2125-X1	●	2.125" (54mm)			10	\$459.00
DR-2125-X3N	●	2.125" (54mm)			10	\$489.00
DR-2156	●	2.156"			10	\$479.00
DR-2156-X1	●	2.156"			10	\$519.00
DR-2156-X3N	●	2.156"			10	\$479.00
DR-2187	●	2.187"			10	\$519.00
DR-2187-X1	●	2.187"			10	\$479.00
DR-2187-X3N	●	2.187"			10	\$519.00
DR-2205	●	2.205" (56mm)			10	\$479.00
DR-2205-X3N	●	2.205" (56mm)	10		\$519.00	
DR-2219	●	2.219"	10		\$479.00	
DR-2219-X1	●	2.219"	10		\$479.00	
DR-2219-X3N	●	2.219"	10		\$519.00	
DR-2244	●	2.244" (57mm)	10		\$499.00	
DR-2244-X3N	●	2.244" (57mm)	10		\$529.00	
DR-2250	●	2.250"	10		\$499.00	
DR-2250-X1	●	2.250"	10	\$499.00		
DR-2250-X3N	●	2.250"	10	\$529.00		
DR-2281	●	2.281"	10	\$499.00		
DR-2281-X1	●	2.281"	10	\$499.00		
DR-2281-X3N	●	2.281"	10	\$529.00		
DR-2312	●	2.312"	10	\$499.00		
DR-2312-X1	●	2.312"	10	\$499.00		
DR-2312-X3N	●	2.312"	10	\$529.00		
DR-2323	●	2.323" (59mm)	10	\$499.00		
DR-2344	●	2.344"	10	\$499.00		
DR-2344-X1	●	2.344"	10	\$499.00		
DR-2344-X3N	●	2.344"	10	\$529.00		
DR-2362	●	2.362" (60mm)	10	\$499.00		
DR-2362-X3N	●	2.362" (60mm)	10	\$529.00		

Drill Diameter
2.008"~2.362"

All 2017 Summer / Fall Promo Offers Valid through December 31, 2017

● : U.S. Stock

All promo items are available exclusively through Authorized North American Kyocera Precision Tool Distributors. Please use specified Promo Code when placing orders.

To locate a distributor visit www.kyoceraprecisiontools.com/locate. Prices Shown Valid in U.S. Only.

HOLESHOT™ (Ø2.375"~Ø4.000")



Choose (1) Drill Body and (10) Inserts

Choose your drill and insert.
 Promo Code: **KYO-DR-KIT**

Drill Description	Stock	Drill Dia.	Insert Description (Pick 1) See Page 40	Grades (Pick 1)	Kit Option		
					Kit Insert Qty.	U.S. Kit Price	
Drill Diameter 2.375"~4.000"	DR-2375	●	2.375"	WCMX06T308M1 WCMX06T308M1A	PR1230 Carbon Steel & Alloy Steel	10	\$499.00
	DR-2375-X1	●	2.375"			10	\$499.00
	DR-2375-X3N	●	2.375"			10	\$529.00
	DR-2406	●	2.406"			10	\$499.00
	DR-2406-X1	●	2.406"			10	\$499.00
	DR-2406-X3N	●	2.406"			10	\$520.00
	DR-2437	●	2.437"			10	\$499.00
	DR-2437-X1	●	2.437"			10	\$499.00
	DR-2437-X3N	●	2.437"			10	\$529.00
	DR-2441	●	2.441" (62mm)			10	\$499.00
	DR-2441-X3N	●	2.441" (62mm)			10	\$529.00
	DR-2469	●	2.469"			10	\$499.00
	DR-2469-X1	●	2.469"			10	\$499.00
	DR-2469-X3N	●	2.469"			10	\$529.00
	DR-2480	●	2.480" (63mm)			10	\$499.00
	DR-2480-X3N	●	2.480" (63mm)			10	\$529.00
	DR-2500	●	2.500"			10	\$499.00
	DR-2500-X1	●	2.500"			10	\$499.00
	DR-2500-X3N	●	2.500"			10	\$529.00
	DR-2625	●	2.625"			10	\$569.00
	DR-2625-X1	●	2.656"			10	\$569.00
	DR-2750	●	2.750"			10	\$649.00
	DR-2750-X1	●	2.750"			10	\$649.00
	DR-2875	●	2.875"			10	\$669.00
	DR-2875-X1	●	2.875"			10	\$669.00
	DR-3000	●	3.000"			10	\$699.00
	DR-3000-X1	●	3.000"			10	\$699.00
	DR-3125	●	3.125"			10	\$699.00
	DR-3125-X1	●	3.125"			10	\$699.00
	DR-3250	●	3.250"			10	\$699.00
	DR-3250-X1	●	3.250"			10	\$699.00
	DR-3375	●	3.375"			10	\$789.00
	DR-3375-X1	●	3.375"			10	\$789.00
	DR-3500	●	3.500"			10	\$789.00
	DR-3500-X1	●	3.500"			10	\$789.00
	DR-3625	●	3.625"			10	\$809.00
	DR-3625-X1	●	3.625"			10	\$809.00
	DR-3750	●	3.750"			10	\$849.00
	DR-3750-X1	●	3.750"			10	\$849.00
	DR-3875	●	3.875"			10	\$849.00
DR-3875-X1	●	3.875"	10	\$849.00			
DR-4000	●	4.000"	10	\$899.00			
DR-4000-X1	●	4.000"	10	\$899.00			

● : U.S. Stock

KYOCERA Precision Tools, Inc.

P: 800.823.7284 • F: 828.692.1344 • E: ctsales@kyocera.com
 Official Website | www.kyoceraprecisiontools.com



KYOCERA Precision Tools, Inc.

102 Industrial Park Road
Hendersonville, NC 28792
Customer Service | 800.823.7284 - Option 1
Technical Support | 800.823.7284 - Option 2



Official Website | www.kyoceraprecisiontools.com
Distributor Website | mykpti.kyocera.com
Email | cuttingtools@kyocera.com



©KYOCERA Precision Tools, Inc.
07/17, 10K Printed in the U.S.A