



ER Collet Chuck Features

ER Collet Chucks

LYNDEX-NIKKEN

AT3 or better taper tolerance.

- All 40 taper tool angles are manufactured within +/- .0011 degrees angular tolerance
- Largest diameter of taper (where rigidity is established) is held within +/- 80 millionths (.00008")
- Precision ground taper ensures 80% or better taper contact

Drive key depth balanced for high speed rotation.

Body of Collet Chuck equal in diameter to the nut diameter. Thicker diameter and wall thickness results in stronger rigidity.

Reduced gap size to prevent bird nests and other stringy chips from packing in or wrapping about.

ER Nut

Smooth nut prevents coolant flare and provides better balance.

Nickel Chrome Molybdenum Alloy



Lyndex-Nikken toolholders are heat treated in house to a hardness between 55 to 58 Rc under the highest quality standard, ensuring a homogeneous martensite (needle-shaped) crystalline structure. The additional heat treatment process allows for a better ground surface finish and stress stability of the toolholder.

OTHER

AT4 taper tolerance.

- All 40 taper tool angles are manufactured within +/- .0018 degrees angular tolerance
- Largest diameter of taper (where rigidity is established) varies within +/- 138 millionths (.00014")
- Varying aspects of taper angle and diameter can only ensure up to 60% taper contact

Recessed collet chuck body diameter weakens rigidity of holder.

Large Hex nut body design flares coolant away from toolholder.

High Carbon Steel

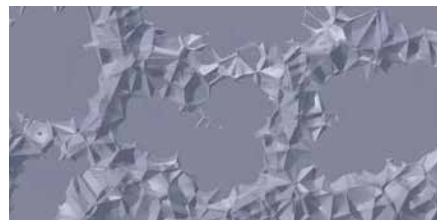

Other toolholders are commonly not heat treated thoroughly in order to reduce production costs, resulting in austenite deposits. Surface finish and material integrity are compromised commonly masked by chrome plating or polishing.

ER Collet Features

We offer the largest ER Collet product range in the industry.

Quality Standard

Made to DIN 6499 Specification

Material

High Tensile Chromium Molybdenum Alloy provides greater hardness and less material deformation compared to traditional spring steel collets

Accuracy

≤0.0001" at cavity bore (collet seating area)

Inspection

100% collet inspection, checked 3 times for concentricity



ER Collet Chucks

ER Collet

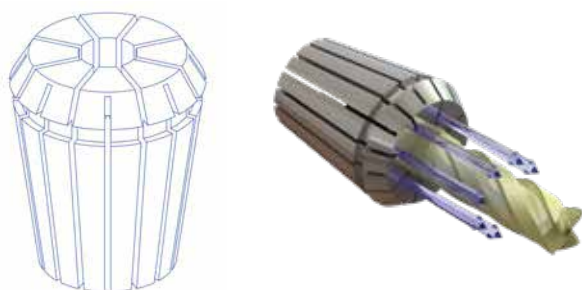

ER Standard Type Collet

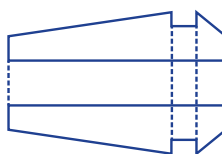

Flexibility and Durability:

We offer the ultimate trifecta: wide clamping range, ultra precision, and super high pressure. Our 1300 psi capable collets have a wide 0.031" collapse range and the ability to maintain less than 0.0001" run out at the collet nose.

ER Counter-Bored Type Collet

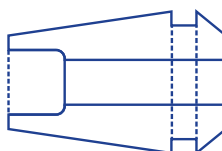

Ultra Precision for Micro Cutters:

Our high precision "On Size" collets have 25% longer collet bore lengths than competitors, resulting in stronger gripping power at higher RPMs. The high-pressure coolant collet's special design reduces cutter vibration due to high pressure.

ER Coolant Collet



High Precision ER Tap Collet

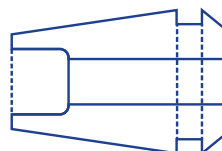

Extreme rigidity, high pressure performance:

Our Tap Collets are designed for all ANSI, DIN, ISO, and JIS Specification Taps. 1300 psi capable Coolant Tap Collets increase tool life by dissipating heat and preventing chip build-up.

ER Collet Dimensional Data

Style	D	D1	L	Collet Range	Coolant Collet Size Range
ER8	0.330"	0.216"	0.535"	0.019 - 0.196"	N/A
ER11	0.460"	0.307"	0.709"	0.019 - 0.275"	0.157 - 0.275"
ER16	0.677"	0.445"	1.063"	0.019 - 0.393"	0.157 - 0.393"
ER20	0.835"	0.571"	1.220"	0.039 - 0.511"	0.196 - 0.511"
ER25	1.031"	0.728"	1.378"	0.039 - 0.629"	0.236 - 0.629"
ER32	1.307"	0.960"	1.575"	0.078 - 0.787"	0.393 - 0.787"
ER40	1.622"	1.228"	1.811"	0.118 - 1.023"	0.393 - 1.023"

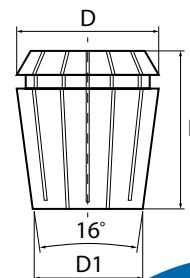

Nut Features

LYNDEX-NIKKEN NUT

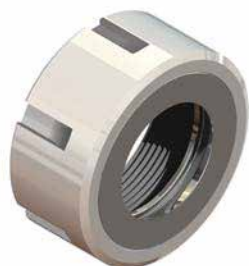

Bearing Nut



Bearing nuts come as a standard on all of our ER Collet Chucks:

- Reduce twisting of the collet and increase T.I.R. accuracy.
- Improve chucking consistency by 6 times compared to non bearing style nut!

Maximum Accuracy

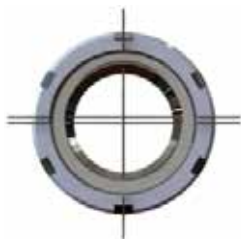

We control all of our manufacturing processes, thereby maintaining the assembly accuracy tolerances between the nut, collet, and holder.

Our ground eccentric bearing race makes set up extremely easy, and ensures the accurate concentric placement of the collet.

Ground Eccentric Nut



Our ground eccentric bearing race increases clamping power by 100% compared to standard nuts!

It also prevents galling and twisting between the collet angle contact surface and the nut to minimize runout and greatly assist in alignment of the collet to the holder.

OTHER NUT



Standard Nut - No Bearing



Non bearing style nuts only provide the ability to retain the collet, and do not carry a functional advantage to improve the T.I.R. or chucking consistency.



Other manufacturers use a commercial snap ring as a retainer for the collet. This can contribute to minor misalignment between the nut, collet, and holder.

No Ground Surface



ER Collet without ground contact locations cannot ensure ultra precision due to surface abnormality.

CAT ER Collet Chucks



T.I.R.: ≤ 0.0001" run out at cavity bore



Speed: up to 23,000 RPM



Set-up: quick and easy



Coolant-Thru: thru-tool coolant



Drilling



Milling



Tapping



Reaming

- Ball bearing nut with ground collet race
- AT3 or better taper
- Equipped with a left-hand-threaded stop screw

Please note that the maximum RPM listed in our catalog may vary depending on the toolholder shank, weight, balanceability and the G rating.

CAT40

Part Number	Style	Collet Size	Collet Range	Nut Wrench	L	L1	D
C4007-0008-2.50	Standard	ER8	0.019 - 0.275"	08-NASPAN	2.50"	0.69"	0.47"
C4017-0008-4.00	Standard	ER8	0.019 - 0.275"	08-NASPAN	4.00"	0.69"	0.47"
C4047-0008-9.00*	Ext. Length	ER8	0.019 - 0.275"	08-NASPAN	9.00"	0.69"	0.47"
C4007-0011-2.50	Standard	ER11	0.019 - 0.275"	011-HEX	2.50"	0.89"	0.75"
C4017-0011-4.00	Standard	ER11	0.019 - 0.275"	011-HEX	4.00"	0.89"	0.75"
C4027-0011-6.00	Standard	ER11	0.019 - 0.275"	011-HEX	6.00"	0.89"	0.75"
C40S7-0016-2.25	Stubby	ER16	0.019 - 0.406"	016-SPAN	2.25"	1.26"	1.26"
C4007-0016-3.50	Standard	ER16	0.019 - 0.406"	016-SPAN	3.50"	1.26"	1.26"
C4017-0016-6.00	Standard	ER16	0.019 - 0.406"	016-SPAN	6.00"	1.26"	1.26"
C4047-0016-9.00*	Ext. Length	ER16	0.019 - 0.406"	016-SPAN	9.00"	1.26"	1.26"
C4007-0020-2.50	Standard	ER20	0.039 - 0.511"	020-SPAN	2.50"	1.50"	1.38"
C4017-0020-4.00	Standard	ER20	0.039 - 0.511"	020-SPAN	4.00"	1.50"	1.38"
C4027-0020-6.00	Standard	ER20	0.039 - 0.511"	020-SPAN	6.00"	1.50"	1.38"
C4047-0020-9.00*	Ext. Length	ER20	0.039 - 0.511"	020-SPAN	9.00"	1.50"	1.38"
C4007-0025-2.50	Standard	ER25	0.039 - 0.629"	025-SPAN	2.50"	1.67"	1.65"
C4017-0025-4.00	Standard	ER25	0.039 - 0.629"	025-SPAN	4.00"	1.67"	1.65"
C4027-0025-6.00	Standard	ER25	0.039 - 0.629"	025-SPAN	6.00"	1.67"	1.65"
C40S7-0032-1.10	Stubby	ER32	0.078 - 0.787"	025-SPAN	1.10"	2.24"	1.57"
C4007-0032-3.13	Standard	ER32	0.078 - 0.787"	032-SPAN	3.13"	1.84"	1.97"
C4017-0032-5.00	Standard	ER32	0.078 - 0.787"	032-SPAN	5.00"	1.84"	1.97"
C4047-0032-9.00*	Ext. Length	ER32	0.078 - 0.787"	032-SPAN	9.00"	1.84"	1.97"
C4007-0040-3.13	Standard	ER40	0.118 - 1.023"	040-SPAN	3.13"	2.07"	2.48"
C4017-0040-5.00	Standard	ER40	0.118 - 1.023"	040-SPAN	5.00"	2.07"	2.48"

Notes:

- Back-up Screw included with ER Collet Chuck.
- *For Extended Length holders, "L" dimension has tapered length. To confirm clearance, please download model/drawing from our website.



Available in **TAPER PLUS** Dual-taper and flange contact

When removing the back-up screw, ER Collet Chucks have coolant-thru capabilities. No disc, special nut or wrench required!
See ER coolant Collets on pages 52-59

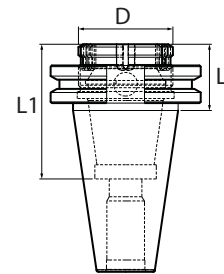

Stubby

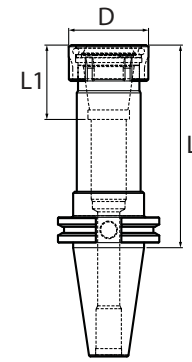

Standard

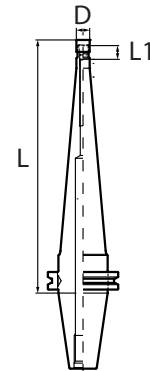

Extended



ER Collets
Pages 52-59



ER Torque Wrench
Page 61



ER Back Up Screw
Page 61



ER Nut
Page 60

CAT ER Collet Chucks

ER Collet Chucks

CAT50

Part Number	Style	Collet Size	Collet Range	Nut Wrench	L	L1	D
C5007-0016-4.12	Standard	ER16	0.019 - 0.406"	016-SPAN	4.12"	1.26"	1.26"
C5017-0016-6.00	Standard	ER16	0.019 - 0.406"	016-SPAN	6.00"	1.26"	1.26"
C5027-0016-8.00*	Ext. Length	ER16	0.019 - 0.406"	016-SPAN	8.00"	1.26"	1.26"
C5057-0016-12.00*	Ext. Length	ER16	0.019 - 0.406"	016-SPAN	12.00"	1.26"	1.26"
C5007-0020-2.50	Standard	ER20	0.039 - 0.511"	020-SPAN	2.50"	1.50"	1.38"
C5017-0020-4.00	Standard	ER20	0.039 - 0.511"	020-SPAN	4.00"	1.50"	1.38"
C5027-0020-6.00	Standard	ER20	0.039 - 0.511"	020-SPAN	6.00"	1.50"	1.38"
C5037-0020-8.00*	Ext. Length	ER20	0.039 - 0.511"	020-SPAN	8.00"	1.50"	1.38"
C5057-0020-12.00*	Ext. Length	ER20	0.039 - 0.511"	020-SPAN	12.00"	1.50"	1.38"
C5007-0025-2.50	Standard	ER25	0.039 - 0.629"	025-SPAN	2.50"	1.67"	1.65"
C5017-0025-4.00	Standard	ER25	0.039 - 0.629"	025-SPAN	4.00"	1.67"	1.65"
C5027-0025-6.00	Standard	ER25	0.039 - 0.629"	025-SPAN	6.00"	1.67"	1.65"
C5037-0025-8.00*	Ext. Length	ER25	0.039 - 0.629"	025-SPAN	8.00"	1.67"	1.65"
C5007-0032-4.00	Standard	ER32	0.078 - 0.787"	032-SPAN	4.00"	1.84"	1.97"
C5017-0032-6.00	Standard	ER32	0.078 - 0.787"	032-SPAN	6.00"	1.84"	1.97"
C5027-0032-8.00*	Ext. Length	ER32	0.078 - 0.787"	032-SPAN	8.00"	1.84"	1.97"
C5057-0032-12.00*	Ext. Length	ER32	0.078 - 0.787"	032-SPAN	12.00"	1.84"	1.97"
C5057-0040-1.10	Stubby	ER40	0.118 - 1.023"	040-SPAN	1.10"	2.44"	1.97"
C5007-0040-4.00	Stubby	ER40	0.118 - 1.023"	040-SPAN	4.00"	2.07"	2.48"
C5017-0040-6.00	Standard	ER40	0.118 - 1.023"	040-SPAN	6.00"	2.07"	2.48"
C5027-0040-8.00*	Ext. Length	ER40	0.118 - 1.023"	040-SPAN	8.00"	2.07"	2.48"
C5057-0040-12.00*	Ext. Length	ER40	0.118 - 1.023"	040-SPAN	12.00"	2.07"	2.48"

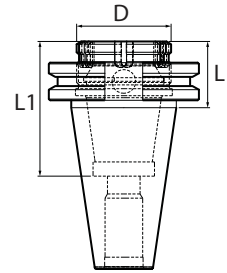

Stubby

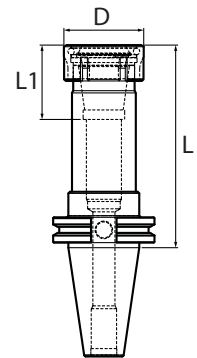

Standard

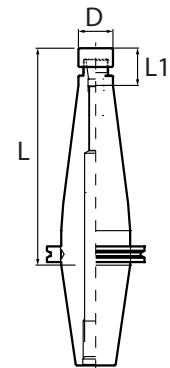

Extended

Notes:

- Back-up Screw included with ER Collet Chuck.
- *For Extended Length holders, "L" dimension has tapered length. To confirm clearance, please download model/drawing from our website.



Available in **TAPER PLUS**  Dual-taper and flange contact

When removing the back-up screw, ER Collet Chucks have coolant-thru capabilities. No disc, special nut or wrench required!

See ER Coolant Collets on pages 52-59



BT ER Collet Chucks



T.I.R.: ≤ 0.0001" run out at cavity bore



Speed: up to 23,000 RPM



Set-up: quick and easy



Coolant-Thru: thru-tool coolant



Drilling



Milling



Tapping



Reaming

- Ball bearing nut with ground collet race
- AT3 or better taper
- Equipped with a left-hand-threaded stop screw

Please note that the maximum RPM listed in our catalog may vary depending on the toolholder shank, weight, balanceability and the G rating.

BT30

Part Number	Style	Collet Size	Collet Range	Nut Wrench	L	L1	D
B3007-0008-2.00	Standard	ER8	0.019 - 0.275"	08-NASPAN	2.00"	0.689"	0.472"
B3017-0008-4.00	Standard	ER8	0.019 - 0.275"	08-NASPAN	4.00"	0.689"	0.472"
B3007-0011-2.00	Standard	ER11	0.019 - 0.275"	011-HEX	2.00"	0.894"	0.75"
B3017-0011-4.00	Standard	ER11	0.019 - 0.275"	011-HEX	4.00"	0.894"	0.75"
B3007-0016-2.36	Standard	ER16	0.019 - 0.406"	016-SPAN	2.36"	1.26"	1.26"
B3017-0016-4.00	Standard	ER16	0.019 - 0.406"	016-SPAN	4.00"	1.26"	1.26"
B3027-0016-5.00	Standard	ER16	0.019 - 0.406"	016-SPAN	5.00"	1.26"	1.26"
B3037-0016-6.00	Standard	ER16	0.019 - 0.406"	016-SPAN	6.00"	1.26"	1.26"
B30S7-0020-1.22	Stubby	ER20	0.039 - 0.511"	FK-3	1.22"	0.79"	1.10"
B3007-0020-2.50	Standard	ER20	0.039 - 0.511"	020-SPAN	2.50"	1.50"	1.38"
B3017-0020-4.00	Standard	ER20	0.039 - 0.511"	020-SPAN	4.00"	1.50"	1.38"
B3007-0025-2.00	Standard	ER25	0.039 - 0.629"	025-SPAN	2.00"	1.67"	1.65"
B3017-0025-4.00	Standard	ER25	0.039 - 0.629"	025-SPAN	4.00"	1.67"	1.65"
B3007-0032-3.00	Standard	ER32	0.078 - 0.787"	032-SPAN	3.00"	1.84"	1.97"
B3017-0032-5.00	Standard	ER32	0.078 - 0.787"	032-SPAN	5.00"	1.84"	1.97"

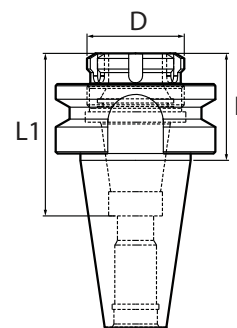

Stubby



Available in **TAPER PLUS** ⁺Dual-taper and flange contact

BT40

Part Number	Style	Collet Size	Collet Range	Nut Wrench	L	L1	D
B4017-0008-4.00	Standard	ER8	0.019 - 0.275"	08-NASPAN	4.00"	0.689"	0.472"
B4007-0011-2.50	Standard	ER11	0.019 - 0.275"	011-HEX	2.50"	0.894"	0.75"
B4017-0011-4.00	Standard	ER11	0.019 - 0.275"	011-HEX	4.00"	0.894"	0.75"
B4027-0011-6.00	Standard	ER11	0.019 - 0.275"	011-HEX	6.00"	0.894"	0.75"
B4007-0016-3.50	Standard	ER16	0.019 - 0.406"	016-SPAN	3.50"	1.26"	1.26"
B4017-0016-5.00	Standard	ER16	0.019 - 0.406"	016-SPAN	5.00"	1.26"	1.26"
B4007-0020-2.50	Standard	ER20	0.039 - 0.511"	020-SPAN	2.50"	1.50"	1.38"
B4017-0020-4.00	Standard	ER20	0.039 - 0.511"	020-SPAN	4.00"	1.50"	1.38"
B4027-0020-6.00	Standard	ER20	0.039 - 0.511"	020-SPAN	6.00"	1.50"	1.38"
B4007-0025-2.25	Standard	ER25	0.039 - 0.629"	025-SPAN	2.25"	1.67"	1.65"
B4017-0025-4.00	Standard	ER25	0.039 - 0.629"	025-SPAN	4.00"	1.67"	1.65"
B4027-0025-6.00	Standard	ER25	0.039 - 0.629"	025-SPAN	6.00"	1.67"	1.65"
B4007-0032-3.13	Standard	ER32	0.078 - 0.787"	032-SPAN	3.13"	1.84"	1.97"
B4017-0032-5.00	Standard	ER32	0.078 - 0.787"	032-SPAN	5.00"	1.84"	1.97"
B4017-0040-5.00	Standard	ER40	0.118 - 1.023"	040-SPAN	5.00"	2.07"	2.48"

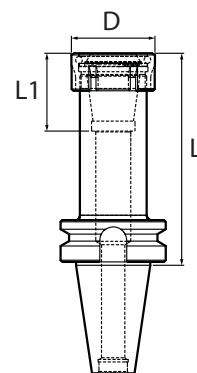

Standard

When removing the back-up screw, ER Collet Chucks have coolant-thru capabilities. No disc, special nut or wrench required!

See ER coolant Collets on pages 52-59



ER Collets
Pages 52-59



ER Torque Wrench
Page 61



ER Back Up Screw
Page 61



ER Nut
Page 60

BT ER Collet Chucks

BT50

Part Number	Style	Collet Size	Collet Range	Nut Wrench	L	L1	D
B5007-0016-4.12	Standard	ER16	0.019 - 0.406"	016-SPAN	4.12"	1.26"	1.26"
B5017-0016-6.00	Standard	ER16	0.019 - 0.406"	016-SPAN	6.00"	1.26"	1.26"
B5007-0020-2.75	Standard	ER20	0.039 - 0.511"	020-SPAN	2.75"	1.50"	1.38"
B5017-0020-4.00	Standard	ER20	0.039 - 0.511"	020-SPAN	4.00"	1.50"	1.38"
B5007-0032-4.00	Standard	ER32	0.078 - 0.787"	032-SPAN	4.00"	1.84"	1.97"
B5017-0032-6.00	Standard	ER32	0.078 - 0.787"	032-SPAN	6.00"	1.84"	1.97"
B5017-0040-6.00	Standard	ER40	0.118 - 1.023"	040-SPAN	6.00"	2.07"	2.50"

Note: ER Collet Chucks come with back-up screw.

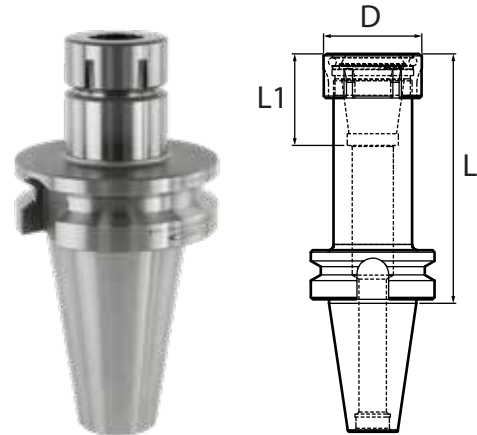

Standard

When removing the back-up screw, ER Collet Chucks have coolant-thru capabilities. No disc, special nut or wrench required!
See ER coolant Collets on pages 52-59



HSK ER Collet Chucks



T.I.R.: ≤ 0.0001" run out at cavity bore



Speed: up to 23,000 RPM



Set-up: quick and easy



Coolant-Thru: thru-tool coolant



Drilling



Milling



Tapping



Reaming

- Ball bearing nut with ground collet race
- AT3 or better taper
- Equipped with a left-hand-threaded stop screw

Please note that the maximum RPM listed in our catalog may vary depending on the toolholder shank, weight, balanceability and the G rating.

HSK40A/63A

Part Number	Taper	Collet Size	Collet Range	Nut Wrench	L	L1	D
HSK40A-ER11-75	HSK40A	ER11	0.019 - 0.275"	011-HEX	2.95"	0.89"	0.75"
HSK40A-ER16-75	HSK40A	ER16	0.019 - 0.406"	016-SPAN	2.95"	1.26"	1.26"
HSK40A-ER20-75	HSK40A	ER20	0.039 - 0.511"	020-SPAN	2.95"	1.50"	1.38"
HSK40A-ER32-80	HSK40A	ER32	0.078 - 0.787"	032-SPAN	3.15"	1.84"	1.97"
HSK63A-ER16-3.00	HSK63A	ER16	0.019 - 0.406"	016-SPAN	3.00"	1.26"	1.26"
HSK63A-ER16-5.00	HSK63A	ER16	0.019 - 0.406"	016-SPAN	5.00"	1.26"	1.26"
HSK63A-ER20-3.00	HSK63A	ER20	0.039 - 0.511"	020-SPAN	3.00"	1.50"	1.38"
HSK63A-ER20-5.00	HSK63A	ER20	0.039 - 0.511"	020-SPAN	5.00"	1.50"	1.38"
HSK63A-ER25-3.00	HSK63A	ER25	0.039 - 0.629"	025-SPAN	3.00"	1.67"	1.65"
HSK63A-ER25-5.00	HSK63A	ER25	0.039 - 0.629"	025-SPAN	5.00"	1.67"	1.65"
HSK63A-ER32-4.00	HSK63A	ER32	0.078 - 0.787"	032-SPAN	4.00"	1.84"	1.97"
HSK63A-ER32-6.00	HSK63A	ER32	0.078 - 0.787"	032-SPAN	6.00"	1.84"	1.97"
HSK63A-ER40-4.00	HSK63A	ER40	0.118 - 1.023"	040-SPAN	4.00"	2.07"	2.48"
HSK63A-ER40-6.00	HSK63A	ER40	0.118 - 1.023"	040-SPAN	6.00"	2.07"	2.48"

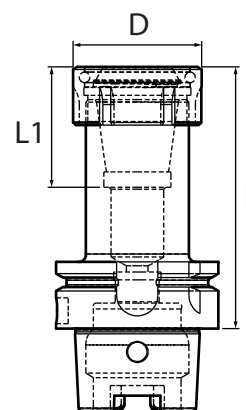

HSK100A

Part Number	Taper	Collet Size	Collet Range	Nut Wrench	L	L1	D
HSK100A-ER16-4.00	HSK100A	ER16	0.019 - 0.406"	016-SPAN	4.00"	1.26"	1.26"
HSK100A-ER16-6.00	HSK100A	ER16	0.019 - 0.406"	016-SPAN	6.00"	1.26"	1.26"
HSK100A-ER20-4.00	HSK100A	ER20	0.039 - 0.511"	020-SPAN	4.00"	1.50"	1.38"
HSK100A-ER20-6.00	HSK100A	ER20	0.039 - 0.511"	020-SPAN	6.00"	1.50"	1.38"
HSK100A-ER25-4.00	HSK100A	ER25	0.039 - 0.629"	025-SPAN	4.00"	1.67"	1.65"
HSK100A-ER25-6.00	HSK100A	ER25	0.039 - 0.629"	025-SPAN	6.00"	1.67"	1.65"
HSK100A-ER32-4.00	HSK100A	ER32	0.078 - 0.787"	032-SPAN	4.00"	1.84"	1.97"
HSK100A-ER32-6.00	HSK100A	ER32	0.078 - 0.787"	032-SPAN	6.00"	1.84"	1.97"
HSK100A-ER40-4.00	HSK100A	ER40	0.118 - 1.023"	040-SPAN	4.00"	2.07"	2.48"
HSK100A-ER40-6.00	HSK100A	ER40	0.118 - 1.023"	040-SPAN	6.00"	2.07"	2.48"

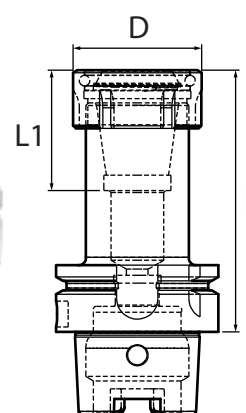

Note: Coolant tube and coolant wrench not included. See page 61 for details.

When removing the back-up screw, ER Collet Chucks have coolant-thru capabilities. No disc, special nut or wrench required!

See ER coolant Collets on pages 52-59



ER Collets
Pages 52-59



ER Torque Wrench
Page 61



ER Back Up Screw
Page 61



ER Nut
Page 60

NMTB and R8 ER Collet Chucks

ER Collet Chucks

- Ball bearing nut with ground collet race
- AT3 or better taper



T.I.R.: <.0005" at collet face



Set-up: quick and easy



Coolant-Thru: thru-tool coolant



Drilling



Milling



Tapping



Reaming

NMTB40

Part Number	Taper	Collet Size	Collet Range	Nut Wrench	L	L1	D
N4007-0016-1.77	NMTB40	ER16	0.019 - 0.406"	016-SPAN	1.77"	1.26"	1.26"
N4007-0025-2.00	NMTB40	ER25	0.039 - 0.629"	025-SPAN	2.00"	1.67"	1.65"

Note: NMTB shanks are suitable for use with Erickson Quick Change spindles.

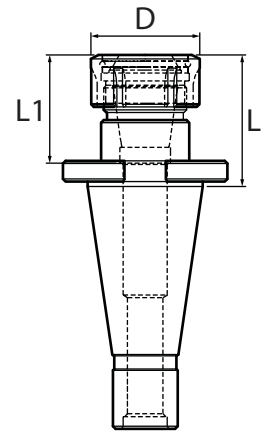

R8

Part Number	Collet Size	Collet Range	Nut Wrench	L	L1	D
R8007-0016-1.00	ER16	0.019 - 0.406"	016-SPAN	1.00"	1.27"	1.26"
R8007-0020-2.00	ER20	0.039 - 0.511"	020-SPAN	2.00"	1.50"	1.38"

Note: ER Collet Chucks come with back-up screw.

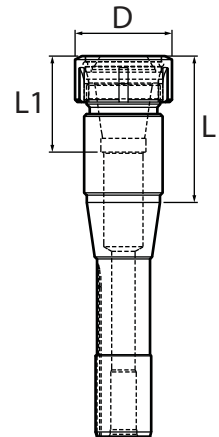

When removing the back-up screw, ER Collet Chucks have coolant-thru capabilities. No disc, special nut or wrench required!

See ER coolant Collets on pages 52-59



ER Collet Chuck Extensions

Part Number	Collet Size	Collet Range	Nut Wrench	D	D1	L	L1
ER8-EXT-500	ER8	0.019 - 0.275"	08-NASPAN	1/2"	0.49"	5.95"	0.75"
ER8-EXT-625	ER8	0.019 - 0.275"	08-NASPAN	5/8"	0.49"	5.95"	0.75"
E11-EXT-500	ER11	0.019 - 0.275"	011-HEX	1/2"	0.75"	6.11"	0.91"
E11-EXT-625	ER11	0.019 - 0.275"	011-HEX	5/8"	0.75"	6.11"	0.91"
E11-EXT-750	ER11	0.019 - 0.275"	011-HEX	3/4"	0.75"	5.65"	0.91"
E16-EXT-100	ER16	0.019 - 0.406"	016-SPAN	1"	1.26"	5.89"	1.28"
E16-EXT-625	ER16	0.019 - 0.406"	016-SPAN	5/8"	1.26"	6.48"	1.28"
E16-EXT-750	ER16	0.019 - 0.406"	016-SPAN	3/4"	1.26"	6.48"	1.28"
E20-EXT-100	ER20	0.039 - 0.511"	020-SPAN	1"	1.38"	6.40"	1.48"
E20-EXT-125	ER20	0.039 - 0.511"	020-SPAN	1-1/4"	1.38"	6.40"	1.48"
E20-EXT-750	ER20	0.039 - 0.511"	020-SPAN	3/4"	1.38"	6.68"	1.48"
E25-EXT-100	ER25	0.039 - 0.629"	025-SPAN	1"	1.65"	6.85"	1.65"
E25-EXT-125	ER25	0.039 - 0.629"	025-SPAN	1-1/4"	1.65"	6.00"	1.65"
E25-EXT-750	ER25	0.039 - 0.629"	025-SPAN	3/4"	1.65"	6.85"	1.65"
E32-EXT-100	ER32	0.078 - 0.787"	032-SPAN	1"	1.97"	7.09"	1.85"
E32-EXT-125	ER32	0.078 - 0.787"	032-SPAN	1-1/4"	1.97"	7.09"	1.85"

Note: ER Collet Chucks come with back-up screw.

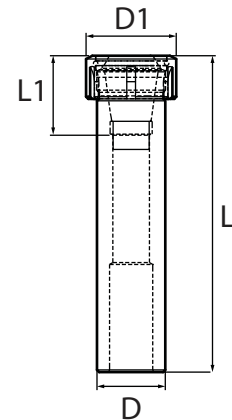

When removing the back-up screw, ER Collet Chucks have coolant-thru capabilities. No disc, special nut or wrench required!

See ER coolant Collets on pages 52-59



ER Collet Chucks

Lyndex-Nikken Offers Single and Dual Plane Balancing for Large Diameter or Long Tooling Assemblies

Benefits of ER Collet Chuck Balancing:

- Balanced assemblies can reduce spindle vibration—prolonging the life of your cutting tools and spindle.
- Increase the quality and consistency of machined surface finishes.
- Achieves greater machined surface flatness.
- Balancing service is only required once during initial set up.



ER Collets
Pages 52-59



ER Torque Wrench
Page 61



ER Back Up Screw
Page 61



ER Nut
Page 60

Taper Plus CAT ER Collet Chucks

Taper Plus Advantages

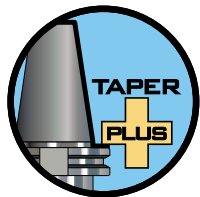

- Outstanding runout accuracy for longer tool life
- Vibration dampening for increased productivity
- High rigidity for smooth and stable cutting
- Interchangeable between standard and dual face contact spindles
- 53% more surface area contact than just the taper alone

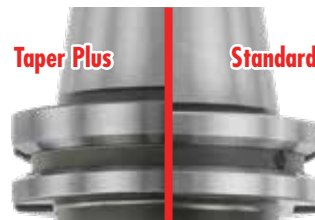
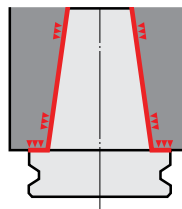

Taper Plus - CAT40

Part Number	Collet Size	Collet Range	Nut Wrench	L	L1	D
NC4007-0016-3.50	ER16	0.019 - 0.406"	016-SPAN	3.50"	1.26"	1.26"
NC4007-0020-2.50	ER20	0.039 - 0.511"	020-SPAN	2.50"	1.50"	1.38"
NC4007-0025-2.50	ER25	0.039 - 0.629"	025-SPAN	2.50"	1.67"	1.65"
NC4007-0032-3.13	ER32	0.078 - 0.787"	032-SPAN	3.13"	1.84"	1.97"
NC4007-0040-3.13	ER40	0.188 - 1.023"	040-SPAN	3.13"	2.07"	2.48"
NC4017-0016-6.00	ER16	0.019 - 0.406"	016-SPAN	6.00"	1.26"	1.26"
NC4017-0020-4.00	ER20	0.039 - 0.511"	020-SPAN	4.00"	1.50"	1.38"
NC4017-0025-4.00	ER25	0.039 - 0.629"	025-SPAN	4.00"	1.67"	1.65"
NC4017-0032-5.00	ER32	0.078 - 0.787"	032-SPAN	5.00"	1.84"	1.97"

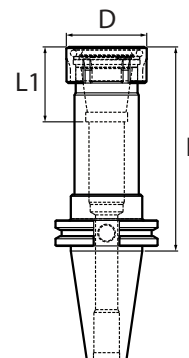

Taper Plus - CAT50

Part Number	Collet Size	Collet Range	Nut Wrench	L	L1	D
NC5007-0016-4.12	ER16	0.019 - 0.406"	016-SPAN	4.12"	1.26"	1.26"
NC5007-0032-4.00	ER32	0.078 - 0.787"	032-SPAN	4.00"	1.84"	1.97"
NC5007-0040-4.00	ER40	0.118 - 1.023"	040-SPAN	4.00"	2.07"	2.48"
NC5017-0016-6.00	ER16	0.019 - 0.406"	016-SPAN	6.00"	1.26"	1.26"
NC5017-0020-4.00	ER20	0.039 - 0.511"	020-SPAN	4.00"	1.50"	1.38"
NC5017-0025-4.00	ER25	0.039 - 0.629"	025-SPAN	4.00"	1.67"	1.65"
NC5017-0032-6.00	ER32	0.078 - 0.787"	032-SPAN	6.00"	1.84"	1.97"

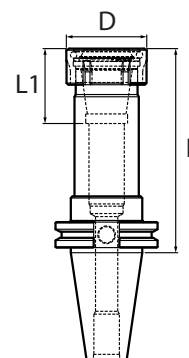

ER Collet Dimensional Data

Style	D	D1	L	Collet Range	Coolant Collet Size Range
ER16	0.677"	0.445"	1.063"	0.019 - 0.393"	0.157 - 0.393"
ER20	0.835"	0.571"	1.220"	0.039 - 0.511"	0.196 - 0.511"
ER25	1.031"	0.728"	1.378"	0.039 - 0.629"	0.236 - 0.629"
ER32	1.307"	0.960"	1.575"	0.078 - 0.787"	0.393 - 0.787"
ER40	1.622"	1.228"	1.811"	0.118 - 1.023"	0.393 - 1.023"

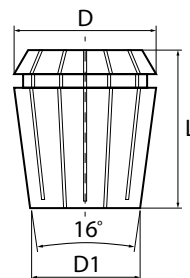

ER Coolant Collets with high pressure coolant-thru the tool capability are available. Mechanically sealing design eliminates the need for discs, special nuts, or wrenches. See ER Coolant Collets on pages 52 - 57.



Taper Plus BT ER Collet Chucks

Taper Plus Advantages

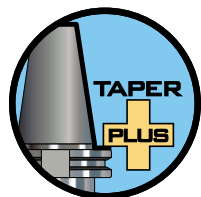

- Outstanding runout accuracy for longer tool life
- Vibration dampening for increased productivity
- High rigidity for smooth and stable cutting
- Interchangeable between standard and dual face contact spindles
- 53% more surface area contact than just the taper alone

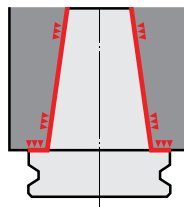

Taper Plus - BT30

Part Number	Collet Size	Collet Range	Nut Wrench	L	L1	D
NB3007-0008-2.00	ER8	0.019 - 0.275"	08-NASPAN	2.00"	0.69"	0.47"
NB3017-0008-4.00	ER8	0.019 - 0.275"	08-NASPAN	4.00"	0.69"	0.47"
NB3007-0011-2.00	ER11	0.019 - 0.275"	011-HEX	2.00"	0.89"	0.75"
NB3017-0011-4.00	ER11	0.019 - 0.275"	011-HEX	4.00"	0.89"	0.75"
NB3007-0016-2.36	ER16	0.019 - 0.406"	016-SPAN	2.36"	1.26"	1.26"
NB3017-0016-4.00	ER16	0.019 - 0.406"	016-SPAN	4.00"	1.26"	1.26"
NB3027-0016-5.00	ER16	0.019 - 0.406"	016-SPAN	5.00"	1.26"	1.26"
NB3037-0016-6.00	ER16	0.019 - 0.406"	016-SPAN	6.00"	1.26"	1.26"
NB3057-0020-1.22	ER20	0.039 - 0.511"	FK-3	1.22"	0.79"	1.10"
NB3007-0020-2.50	ER20	0.039 - 0.511"	020-SPAN	2.50"	1.50"	1.38"
NB3017-0020-4.00	ER20	0.039 - 0.511"	020-SPAN	4.00"	1.50"	1.38"
NB3007-0025-2.00	ER25	0.039 - 0.629"	025-SPAN	2.00"	1.67"	1.65"
NB3017-0025-4.00	ER25	0.039 - 0.629"	025-SPAN	4.00"	1.67"	1.65"
NB3007-0032-3.00	ER32	0.078 - 0.787"	032-SPAN	3.00"	1.84"	1.97"
NB3017-0032-5.00	ER32	0.078 - 0.787"	032-SPAN	5.00"	1.84"	1.97"

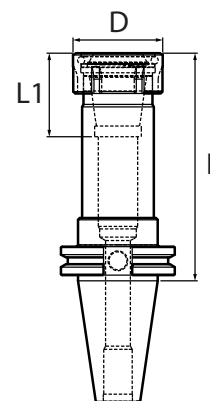

ER Collet Dimensional Data

Style	D	D1	L	Collet Range	Coolant Collet Size Range
ER8	0.330"	0.216"	0.535"	0.019 - 0.196"	N/A
ER11	0.460"	0.307"	0.709"	0.019 - 0.275"	0.157 - 0.275"
ER16	0.677"	0.445"	1.063"	0.019 - 0.393"	0.157 - 0.393"
ER20	0.835"	0.571"	1.220"	0.039 - 0.511"	0.196 - 0.511"
ER25	1.031"	0.728"	1.378"	0.039 - 0.629"	0.236 - 0.629"
ER32	1.307"	0.960"	1.575"	0.078 - 0.787"	0.393 - 0.787"

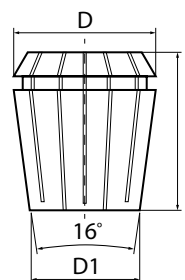

ER Coolant Collets with high pressure coolant-thru the tool capability are available. Mechanically sealing design eliminates the need for discs, special nuts, or wrenches. See ER Coolant Collets on pages 52 - 57.



ER Collets
Pages 52-59



ER Torque Wrench
Page 61



ER Back Up Screw
Page 61



ER Nut
Page 60

ER8 and ER11 Collets

ER8 Collets

Size range: 1.00 - 5.00mm (0.039" - 0.197")

Metric

Part Number	Size	Collapse Range
ER8-039	1.0mm	1.0 - 0.5mm
ER8-059	1.5mm	1.5 - 1.0mm
ER8-078	2.0mm	2.0 - 1.5mm
ER8-098	2.5mm	2.5 - 2.0mm
ER8-118	3.0mm	3.0 - 2.5mm
ER8-137	3.5mm	3.5 - 3.0mm
ER8-157	4.0mm	4.0 - 3.5mm
ER8-177	4.5mm	4.5 - 4.0mm
ER8-196	5.0mm	5.0 - 4.5mm

ER8-SET-09-MM 9 Piece Set
0.5 - 5.0mm by 0.5mm



Precision Standard

Precision slots allow for even distribution of clamping pressure and minimal run out.



Coolant-Thru

Our patented Coolant Collets are designed for use with cylindrical shank tools (no flats). Cutting tool should be inserted the full length of the collet. If these conditions are not met, coolant leakage may result. Seals up to maximum coolant pressure of 1000 psi.

ER11 Collets

Size range: 1/32 - 17/64"
(0.031 - 0.266")

Size range: 1.0 - 7.0mm
(0.039 - 0.276")

Inch

Part Number	Size	Collapse Range
E11-002	1/32"	0.031 - 0.027"
E11-003	3/64"	0.047 - 0.031"
E11-004	1/16"	0.063 - 0.047"
E11-005	5/64"	0.078 - 0.063"
E11-006	3/32"	0.094 - 0.078"
E11-007	7/64"	0.109 - 0.094"
E11-008	1/8"	0.125 - 0.109"
E11-009	9/64"	0.141 - 0.125"
E11-010	5/32"	0.156 - 0.141"
E11-011	11/64"	0.172 - 0.156"
E11-012	3/16"	0.187 - 0.172"
E11-013	13/64"	0.203 - 0.187"
E11-014	7/32"	0.219 - 0.203"
E11-015	15/64"	0.234 - 0.219"
E11-016	1/4"	0.250 - 0.234"
E11-017	17/64"	0.266 - 0.250"

Metric

Part Number	Size	Collapse Range
E11-039	1.0mm	1.0 - 0.5mm
E11-059	1.5mm	1.5 - 1.0mm
E11-078	2.0mm	2.0 - 1.5mm
E11-098	2.5mm	2.5 - 2.0mm
E11-118	3.0mm	3.0 - 2.5mm
E11-137	3.5mm	3.5 - 3.0mm
E11-157	4.0mm	4.0 - 3.5mm
E11-177	4.5mm	4.5 - 4.0mm
E11-196	5.0mm	5.0 - 4.5mm
E11-216	5.5mm	5.5 - 5.0mm
E11-236	6.0mm	6.0 - 5.5mm
E11-255	6.5mm	6.5 - 6.0mm
E11-275	7.0mm	7.0 - 6.5mm

ER11 Collet Sets

E11-SET-14 14 Piece Set: 1/16" - by 1/64ths
E11-SET-12-MM 12 Piece Set: 1.0 - 7.0mm by 0.5mm

Note: See dimensional data for ER8 & ER11 Collets on page 41.

Size range: 3/16 - 17/64"
(0.188 - 0.266")

Size range: 4.0 - 7.0mm
(0.157 - 0.276")

Inch Coolant-Thru

Part Number	Size	Collapse Range
E11-012(C)	3/16"	0.187 - 0.183"
E11-013(C)	13/64"	0.203 - 0.199"
E11-014(C)	7/32"	0.218 - 0.214"
E11-015(C)	15/64"	0.234 - 0.230"
E11-016(C)	1/4"	0.250 - 0.246"
E11-017(C)	17/64"	0.265 - 0.261"

Metric Coolant-Thru

Part Number	Size	Collapse Range
E11-157(C)	4.0mm	4.0 - 3.5mm
E11-177(C)	4.5mm	4.5 - 4.0mm
E11-196(C)	5.0mm	5.0 - 4.5mm
E11-216(C)	5.5mm	5.5 - 5.0mm
E11-236(C)	6.0mm	6.0 - 5.5mm
E11-255(C)	6.5mm	6.5 - 6.0mm
E11-275(C)	7.0mm	7.0 - 6.5mm

ER11 Coolant Collet Sets

E11-SET-06(C) 6 Piece Set: 3/16" - 17/64" by 1/64ths
E11-SET-07(C)-MM 7 Piece Set: 3.9 - 7.0mm by 0.5mm

ER16 Collets



Precision Standard

Precision slots allow for even distribution of clamping pressure and minimal run out.

Size range: 1/32 - 13/32"
(0.031 - 0.406")

Size range: 1.0 - 10.0mm
(0.039 - 0.394")

Inch

Part Number	Size	Collapse Range	Part Number	Size	Collapse Range
E16-002	1/32"	0.031 - 0.027"	E16-039	1.0mm	1.0 - 0.5mm
E16-004	1/16"	0.063 - 0.047"	E16-059	1.5mm	1.5 - 1.0mm
E16-006	3/32"	0.094 - 0.078"	E16-078	2.0mm	2.0 - 1.5mm
E16-008	1/8"	0.125 - 0.109"	E16-098	2.5mm	2.5 - 2.0mm
E16-010	5/32"	0.156 - 0.125"	E16-118	3.0mm	3.0 - 2.5mm
E16-012	3/16"	0.187 - 0.156"	E16-137	3.5mm	3.5 - 3.0mm
E16-014	7/32"	0.219 - 0.187"	E16-157	4.0mm	4.0 - 3.5mm
E16-016	1/4"	0.250 - 0.219"	E16-177	4.5mm	4.5 - 4.0mm
E16-018	9/32"	0.281 - 0.250"	E16-196	5.0mm	5.0 - 4.5mm
E16-020	5/16"	0.312 - 0.281"	E16-216	5.5mm	5.5 - 5.0mm
E16-022	11/32"	0.344 - 0.312"	E16-236	6.0mm	6.0 - 5.5mm
E16-024	3/8"	0.375 - 0.344"	E16-255	6.5mm	6.5 - 6.0mm
E16-026	13/32"	0.406 - 0.375"	E16-275	7.0mm	7.0 - 6.5mm

Metric

Part Number	Size	Collapse Range	Part Number	Size	Collapse Range
E16-039	1.0mm	1.0 - 0.5mm	E16-295	7.5mm	7.5 - 7.0mm
E16-059	1.5mm	1.5 - 1.0mm	E16-314	8.0mm	8.0 - 7.5mm
E16-078	2.0mm	2.0 - 1.5mm	E16-334	8.5mm	8.5 - 8.0mm
E16-098	2.5mm	2.5 - 2.0mm	E16-354	9.0mm	9.0 - 8.5mm
E16-118	3.0mm	3.0 - 2.5mm	E16-374	9.5mm	9.5 - 9.0mm
E16-137	3.5mm	3.5 - 3.0mm	E16-393	10.0mm	10.0 - 9.5mm

ER16 Collet Sets

E16-SET-12	12 Piece Set: 1/32" - 13/32" by 1/32nds
E16-SET-09-MM	9 Piece Set: 2.0 - 10.0mm by 1mm

Note: See dimensional data for ER16 Collets on page 41.



Coolant-Thru

Our patented Coolant Collets are designed for use with cylindrical shank tools (no flats). Cutting tool should be inserted the full length of the collet. If these conditions are not met, coolant leakage may result. Seals up to maximum coolant pressure of 1000 psi.

Size range: 3/32 - 13/32"
(0.094 - 0.406")

Size range: 4.0 - 10.0mm
(0.157 - 0.394")

Inch Coolant-Thru

Part Number	Size	Collapse Range	Part Number	Size	Collapse Range
E16-006(C)	3/32"	0.094 - 0.089"	E16-157(C)	4.0mm	4.0 - 3.5mm
E16-007(C)	7/64"	0.109 - 0.105"	E16-177(C)	4.5mm	4.5 - 4.0mm
E16-008(C)	1/8"	0.125 - 0.121"	E16-196(C)	5.0mm	5.0 - 4.5mm
E16-009(C)	9/64"	0.140 - 0.136"	E16-216(C)	5.5mm	5.5 - 5.0mm
E16-010(C)	5/32"	0.156 - 0.152"	E16-236(C)	6.0mm	6.0 - 5.5mm
E16-011(C)	11/64"	0.171 - 0.167"	E16-255(C)	6.5mm	6.5 - 6.0mm
E16-012(C)	3/16"	0.187 - 0.183"	E16-275(C)	7.0mm	7.0 - 6.5mm
E16-013(C)	13/64"	0.203 - 0.199"	E16-295(C)	7.5mm	7.5 - 7.0mm
E16-014(C)	7/32"	0.219 - 0.203"	E16-314(C)	8.0mm	8.0 - 7.5mm
E16-015(C)	15/64"	0.234 - 0.219"	E16-334(C)	8.5mm	8.5 - 8.0mm
E16-016(C)	1/4"	0.250 - 0.234"	E16-354(C)	9.0mm	9.0 - 8.5mm
E16-017(C)	17/64"	0.266 - 0.250"	E16-374(C)	9.5mm	9.5 - 9.0mm
E16-018(C)	9/32"	0.281 - 0.266"	E16-393(C)	10.0mm	10.0 - 9.5mm
E16-019(C)	19/64"	0.297 - 0.281"			
E16-020(C)	5/16"	0.312 - 0.297"			
E16-021(C)	21/64"	0.328 - 0.312"			
E16-022(C)	11/32"	0.344 - 0.328"			
E16-023(C)	23/64"	0.359 - 0.344"			
E16-024(C)	3/8"	0.375 - 0.359"			
E16-025(C)	25/64"	0.391 - 0.375"			
E16-026(C)	13/32"	0.406 - 0.391"			

ER16 Coolant Collet Sets

E16-SET-11(C)	11 Piece Set: 3/32" - 13/32" by 1/32nds
E16-SET-15(C)	15 Piece Set: 3/16" - 11/32" by 1/32nds
E16-SET-13(C)-MM	13 Piece Set: 4.0 - 10.0mm by 0.5mm

ER20 Collets

Precision Standard

Precision slots allow for even distribution of clamping pressure and minimal run out.



Size range: 1/16 - 1/2"
(0.062 - 0.500")

Size range: 2.0 - 13.0mm
(0.079 - 0.512")

Coolant-Thru

Our patented Coolant Collets are designed for use with cylindrical shank tools (no flats). Cutting tool should be inserted the full length of the collet. If these conditions are not met, coolant leakage may result. Seals up to maximum coolant pressure of 1000 psi.



Size range: 5/32 - 1/2"
(0.156 - 0.500")

Size range: 5.0 - 13.0mm
(0.197 - 0.512")

Inch

Part Number	Size	Collapse Range
E20-004	1/16"	0.063 - 0.047"
E20-006	3/32"	0.094 - 0.078"
E20-008	1/8"	0.125 - 0.109"
E20-010	5/32"	0.156 - 0.125"
E20-012	3/16"	0.187 - 0.156"
E20-014	7/32"	0.219 - 0.187"
E20-016	1/4"	0.250 - 0.219"
E20-018	9/32"	0.281 - 0.250"
E20-020	5/16"	0.312 - 0.281"
E20-022	11/32"	0.344 - 0.312"
E20-024	3/8"	0.375 - 0.344"
E20-026	13/32"	0.406 - 0.375"
E20-028	7/16"	0.437 - 0.406"
E20-030	15/32"	0.469 - 0.437"
E20-032	1/2"	0.500 - 0.469"

Metric

Part Number	Size	Collapse Range
E20-078	2.0mm	2.0 - 1.0mm
E20-118	3.0mm	3.0 - 2.5mm
E20-137	3.5mm	3.5 - 2.5mm
E20-157	4.0mm	4.0 - 3.5mm
E20-196	5.0mm	5.0 - 4.0mm
E20-236	6.0mm	6.0 - 5.0mm
E20-275	7.0mm	7.0 - 6.0mm
E20-314	8.0mm	8.0 - 7.0mm
E20-354	9.0mm	9.0 - 8.0mm
E20-393	10.0mm	10.0 - 9.0mm
E20-433	11.0mm	11.0 - 10.0mm
E20-452	11.5mm	11.5 - 11.0mm
E20-472	12.0mm	12.0 - 11.0mm
E20-511	13.0mm	13.0 - 12.0mm

Inch Coolant-Thru

Part Number	Size	Collapse Range
E20-010(C)	5/32"	0.156 - 0.152"
E20-011(C)	11/64"	0.172 - 0.167"
E20-012(C)	3/16"	0.187 - 0.183"
E20-013(C)	13/64"	0.203 - 0.199"
E20-014(C)	7/32"	0.219 - 0.203"
E20-015(C)	15/64"	0.234 - 0.219"
E20-016(C)	1/4"	0.250 - 0.234"
E20-017(C)	17/64"	0.266 - 0.250"
E20-018(C)	9/32"	0.281 - 0.266"
E20-019(C)	19/64"	0.297 - 0.281"
E20-020(C)	5/16"	0.312 - 0.297"
E20-021(C)	21/64"	0.328 - 0.312"
E20-022(C)	11/32"	0.344 - 0.328"
E20-023(C)	23/64"	0.359 - 0.344"
E20-024(C)	3/8"	0.375 - 0.359"
E20-025(C)	25/64"	0.391 - 0.375"
E20-026(C)	13/32"	0.406 - 0.391"
E20-027(C)	27/64"	0.422 - 0.406"
E20-028(C)	7/16"	0.437 - 0.422"
E20-029(C)	29/64"	0.453 - 0.437"
E20-030(C)	15/32"	0.469 - 0.453"
E20-031(C)	31/64"	0.484 - 0.469"
E20-032(C)	1/2"	0.500 - 0.484"

Metric Coolant-Thru

Part Number	Size	Collapse Range
E20-196(C)	5.0mm	5.0 - 4.5mm
E20-216(C)	5.5mm	5.5 - 5.0mm
E20-236(C)	6.0mm	6.0 - 5.5mm
E20-255(C)	6.5mm	6.5 - 6.0mm
E20-275(C)	7.0mm	7.0 - 6.5mm
E20-295(C)	7.5mm	7.5 - 7.0mm
E20-314(C)	8.0mm	8.0 - 7.5mm
E20-334(C)	8.5mm	8.5 - 8.0mm
E20-354(C)	9.0mm	9.0 - 8.5mm
E20-374(C)	9.5mm	9.5 - 9.0mm
E20-393(C)	10.0mm	10.0 - 9.5mm
E20-413(C)	10.5mm	10.5 - 10.0mm
E20-433(C)	11.0mm	11.0 - 10.5mm
E20-452(C)	11.5mm	11.5 - 11.0mm
E20-472(C)	12.0mm	12.0 - 11.5mm
E20-492(C)	12.5mm	12.5 - 12.0mm
E20-511(C)	13.0mm	13.0 - 12.5mm

ER20 Collet Sets

E20-SET-15	15 Piece Set: 1/16" - 1/2" by 1/32nds
E20-SET-11-MM	11 Piece Set: 2.0 - 13.0mm by 1mm

Note: See dimensional data for ER20 Collets on page 41.

ER20 Coolant Collet Sets

E20-SET-12(C)	12 Piece Set: 5/32" - 1/2" by 1/32nds
E20-SET-17(C)-MM	17 Piece Set: 5.0 - 13.0mm by 0.5mm

ER25 Collets



Precision Standard

Precision slots allow for even distribution of clamping pressure and minimal run out.

Size range: 1/16" - 5/8"
(0.0625 - 0.625")

Size range: 2.0 - 16.0mm
(0.079 - 0.630")

Inch

Part Number	Size	Collapse Range	Part Number	Size	Collapse Range
E25-004	1/16"	0.063 - 0.047"	E25-078	2.0mm	2.0 - 1.0mm
E25-006	3/32"	0.094 - 0.078"	E25-118	3.0mm	3.0 - 2.0mm
E25-008	1/8"	0.125 - 0.109"	E25-137	3.5mm	3.5 - 2.5mm
E25-010	5/32"	0.156 - 0.125"	E25-157	4.0mm	4.0 - 3.0mm
E25-012	3/16"	0.187 - 0.156"	E25-196	5.0mm	5.0 - 4.0mm
E25-014	7/32"	0.218 - 0.187"	E25-236	6.0mm	6.0 - 5.0mm
E25-016	1/4"	0.250 - 0.219"	E25-275	7.0mm	7.0 - 6.0mm
E25-018	9/32"	0.281 - 0.250"	E25-314	8.0mm	8.0 - 7.0mm
E25-020	5/16"	0.312 - 0.281"	E25-354	9.0mm	9.0 - 8.0mm
E25-022	11/32"	0.344 - 0.312"	E25-393	10.0mm	10.0 - 9.0mm
E25-024	3/8"	0.375 - 0.344"	E25-433	11.0mm	11.0 - 10.0mm
E25-026	13/32"	0.406 - 0.375"	E25-452	11.5mm	11.5 - 11.0mm
E25-028	7/16"	0.437 - 0.406"	E25-472	12.0mm	12.0 - 11.0mm
E25-030	15/32"	0.469 - 0.437"	E25-511	13.0mm	13.0 - 12.0mm
E25-032	1/2"	0.500 - 0.469"	E25-551	14.0mm	14.0 - 13.0mm
E25-034	17/32"	0.531 - 0.500"	E25-590	15.0mm	15.0 - 14.0mm
E25-036	9/16"	0.563 - 0.531"	E25-629	16.0mm	16.0 - 15.0mm
E25-038	19/32"	0.594 - 0.563"			
E25-040	5/8"	0.625 - 0.594"			

ER25 Collet Sets

E25-SET-19	19 Piece Set: 1/16" - 5/8" by 1/32nds
E25-SET-14-MM	14 Piece Set: 2.0 - 16.0mm by 1mm

Note: See dimensional data for ER25 Collets on page 41.



Coolant-Thru

Our patented Coolant Collets are designed for use with cylindrical shank tools (no flats). Cutting tool should be inserted the full length of the collet. If these conditions are not met, coolant leakage may result. Seals up to maximum coolant pressure of 1000 psi.

Size range: 7/32" - 5/8"
(0.219 - 0.625")

Size range: 6.0 - 16.0mm
(0.236 - 0.630")

Inch Coolant-Thru

Part Number	Size	Collapse Range	Part Number	Size	Collapse Range
E25-014(C)	7/32"	0.219 - 0.203"	E25-236(C)	6.0mm	6.0 - 5.5mm
E25-015(C)	15/64"	0.234 - 0.219"	E25-255(C)	6.5mm	6.5 - 6.0mm
E25-016(C)	1/4"	0.250 - 0.234"	E25-275(C)	7.0mm	7.0 - 6.5mm
E25-017(C)	17/64"	0.266 - 0.250"	E25-295(C)	7.5mm	7.5 - 7.0mm
E25-018(C)	9/32"	0.281 - 0.266"	E25-314(C)	8.0mm	8.0 - 7.5mm
E25-019(C)	19/64"	0.297 - 0.281"	E25-334(C)	8.5mm	8.5 - 8.0mm
E25-020(C)	5/16"	0.312 - 0.297"	E25-354(C)	9.0mm	9.0 - 8.5mm
E25-021(C)	21/64"	0.328 - 0.312"	E25-374(C)	9.5mm	9.5 - 9.0mm
E25-022(C)	11/32"	0.344 - 0.328"	E25-393(C)	10.0mm	10.0 - 9.5mm
E25-023(C)	23/64"	0.359 - 0.344"	E25-413(C)	10.5mm	10.5 - 10.0mm
E25-024(C)	3/8"	0.375 - 0.359"	E25-433(C)	11.0mm	11.0 - 10.5mm
E25-025(C)	25/64"	0.391 - 0.375"	E25-452(C)	11.5mm	11.5 - 11.0mm
E25-026(C)	13/32"	0.406 - 0.391"	E25-472(C)	12.0mm	12.0 - 11.5mm
E25-027(C)	27/64"	0.422 - 0.406"	E25-492(C)	12.5mm	12.5 - 12.0mm
E25-028(C)	7/16"	0.437 - 0.422"	E25-511(C)	13.0mm	13.0 - 12.5mm
E25-029(C)	29/64"	0.453 - 0.437"	E25-531(C)	13.5mm	13.5 - 13.0mm
E25-030(C)	15/32"	0.469 - 0.453"	E25-551(C)	14.0mm	14.0 - 13.5mm
E25-031(C)	31/64"	0.484 - 0.469"	E25-570(C)	14.5mm	14.5 - 14.0mm
E25-032(C)	1/2"	0.500 - 0.484"	E25-590(C)	15.0mm	15.0 - 14.5mm
E25-033(C)	33/64"	0.516 - 0.500"	E25-610(C)	15.5mm	15.5 - 15.0mm
E25-034(C)	17/32"	0.531 - 0.516"	E25-629(C)	16.0mm	16.0 - 15.5mm
E25-035(C)	35/64"	0.547 - 0.531"			
E25-036(C)	9/16"	0.563 - 0.547"			
E25-037(C)	37/64"	0.578 - 0.563"			
E25-038(C)	19/32"	0.594 - 0.578"			
E25-039(C)	39/64"	0.609 - 0.594"			
E25-040(C)	5/8"	0.625 - 0.609"			

ER25 Coolant Collet Sets

E25-SET-13(C)	13 Piece Set: 1/4" - 5/8" by 1/32nds
E25-SET-21(C)-MM	21 Piece Set: 6.0 - 16.0mm by 0.5mm

ER32 Collets

Precision Standard

Precision slots allow for even distribution of clamping pressure and minimal run out.



Size range: 1/8" - 25/32"
(0.125" - 0.781")

Size range: 3.0 - 20.0mm
(0.118 - 0.787")

Coolant-Thru

Our patented Coolant Collets are designed for use with cylindrical shank tools (no flats). Cutting tool should be inserted the full length of the collet. If these conditions are not met, coolant leakage may result. Seals up to maximum coolant pressure of 1000 psi.



Size range: 1/4" - 25/32"
(0.250 - 0.781")

Size range: 10.0 - 20.0mm
(0.394 - 0.787")

Inch

Part Number	Size	Collapse Range
E32-008	1/8"	0.125 - 0.109"
E32-010	5/32"	0.156 - 0.125"
E32-012	3/16"	0.187 - 0.156"
E32-014	7/32"	0.219 - 0.187"
E32-016	1/4"	0.250 - 0.219"
E32-018	9/32"	0.281 - 0.250"
E32-020	5/16"	0.312 - 0.281"
E32-022	11/32"	0.344 - 0.312"
E32-024	3/8"	0.375 - 0.344"
E32-026	13/32"	0.406 - 0.375"
E32-028	7/16"	0.437 - 0.406"
E32-030	15/32"	0.469 - 0.437"
E32-032	1/2"	0.500 - 0.469"
E32-034	17/32"	0.531 - 0.500"
E32-036	9/16"	0.594 - 0.563"
E32-038	19/32"	0.594 - 0.562"
E32-040	5/8"	0.625 - 0.594"
E32-042	21/32"	0.688 - 0.656"
E32-044	11/16"	0.719 - 0.688"
E32-046	23/32"	0.719 - 0.687"
E32-048	3/4"	0.750 - 0.719"
E32-050	25/32"	0.781 - 0.750"

Metric

Part Number	Size	Collapse Range
E32-118	3.0mm	3.0 - 2.0mm
E32-137	3.5mm	3.5 - 2.5mm
E32-157	4.0mm	4.0 - 3.0mm
E32-196	5.0mm	5.0 - 4.0mm
E32-236	6.0mm	6.0 - 5.0mm
E32-275	7.0mm	7.0 - 6.0mm
E32-314	8.0mm	8.0 - 7.0mm
E32-354	9.0mm	9.0 - 8.0mm
E32-393	10.0mm	10.0 - 9.0mm
E32-433	11.0mm	11.0 - 10.0mm
E32-452	11.5mm	11.5 - 10.5mm
E32-472	12.0mm	12.0 - 11.0mm
E32-511	13.0mm	13.0 - 12.0mm
E32-551	14.0mm	14.0 - 13.0mm
E32-590	15.0mm	15.0 - 14.0mm
E32-629	16.0mm	16.0 - 15.0mm
E32-669	17.0mm	17.0 - 16.0mm
E32-708	18.0mm	18.0 - 17.0mm
E32-748	19.0mm	19.0 - 18.0mm
E32-767	19.5mm	19.5 - 18.5mm
E32-787	20.0mm	20.0 - 19.0mm

ER32 Collet Sets

E32-SET-21	21 Piece Set: 1/8" - 3/4" by 1/32nds
E32-SET-18-MM	18 Piece Set: 2.0 - 20.0mm by 1.0mm

Note: See dimensional data for ER32 Collets on page 41.

Inch Coolant-Thru

Part Number	Size	Collapse Range
E32-016(C)	1/4"	0.250 - 0.234"
E32-017(C)	17/64"	0.266 - 0.250"
E32-018(C)	9/32"	0.281 - 0.266"
E32-019(C)	19/64"	0.297 - 0.281"
E32-020(C)	5/16"	0.312 - 0.297"
E32-021(C)	21/64"	0.328 - 0.312"
E32-022(C)	11/32"	0.344 - 0.328"
E32-023(C)	23/64"	0.359 - 0.344"
E32-024(C)	3/8"	0.375 - 0.359"
E32-025(C)	25/64"	0.391 - 0.375"
E32-026(C)	13/32"	0.406 - 0.391"
E32-027(C)	27/64"	0.422 - 0.406"
E32-028(C)	7/16"	0.437 - 0.422"
E32-029(C)	29/64"	0.453 - 0.437"
E32-030(C)	15/32"	0.469 - 0.453"
E32-031(C)	31/64"	0.484 - 0.469"
E32-032(C)	1/2"	0.500 - 0.484"
E32-033(C)	33/64"	0.516 - 0.500"
E32-034(C)	17/32"	0.531 - 0.516"
E32-035(C)	35/64"	0.547 - 0.531"
E32-036(C)	9/16"	0.563 - 0.547"
E32-037(C)	37/64"	0.578 - 0.563"
E32-038(C)	19/32"	0.594 - 0.578"
E32-039(C)	39/64"	0.609 - 0.594"
E32-040(C)	5/8"	0.625 - 0.609"
E32-041(C)	41/64"	0.641 - 0.625"
E32-042(C)	21/32"	0.656 - 0.641"
E32-043(C)	43/64"	0.672 - 0.656"
E32-044(C)	11/16"	0.688 - 0.672"
E32-045(C)	45/64"	0.703 - 0.688"
E32-046(C)	23/32"	0.719 - 0.703"
E32-047(C)	47/64"	0.734 - 0.719"
E32-048(C)	3/4"	0.750 - 0.734"
E32-049(C)	49/64"	0.766 - 0.750"
E32-050(C)	25/32"	0.781 - 0.766"

Metric Coolant-Thru

Part Number	Size	Collapse Range
E32-393(C)	10.0mm	10.0 - 9.5mm
E32-413(C)	10.5mm	10.5 - 10.0mm
E32-433(C)	11.0mm	11.0 - 10.5mm
E32-452(C)	11.5mm	11.5 - 11.0mm
E32-472(C)	12.0mm	12.0 - 11.5mm
E32-492(C)	12.5mm	12.5 - 12.4mm
E32-511(C)	13.0mm	13.0 - 12.9mm
E32-531(C)	13.5mm	13.5 - 13.0mm
E32-551(C)	14.0mm	14.0 - 13.5mm
E32-570(C)	14.5mm	14.5 - 14.4mm
E32-590(C)	15.0mm	15.0 - 14.9mm
E32-610(C)	15.5mm	15.5 - 15.4mm
E32-629(C)	16.0mm	16.0 - 15.5mm
E32-649(C)	16.5mm	16.5 - 16.0mm
E32-669(C)	17.0mm	17.0 - 16.5mm
E32-688(C)	17.5mm	17.5 - 17.0mm
E32-708(C)	18.0mm	18.0 - 17.5mm
E32-728(C)	18.5mm	18.5 - 18.0mm
E32-748(C)	19.0mm	19.0 - 18.5mm
E32-767(C)	19.5mm	19.5 - 19.0mm
E32-787(C)	20.0mm	20.0 - 19.5mm

ER32 Coolant Collet Sets

E32-SET-17(C)	17 Piece Set: 1/4" - 3/4" by 1/32nds
E32-SET-21(C)-MM	21 Piece Set: 10.0 - 20.0mm by 0.5mm

ER40 Collets



Precision Standard

Precision slots allow for even distribution of clamping pressure and minimal run out.

Size range: 5/32 - 1"
(0.156 - 1.000")

Size range: 4.0 - 26.0mm
(0.157 - 1.024")

Inch

Part Number	Size	Collapse Range	Part Number	Size	Collapse Range
E40-010	5/32"	0.156 - 0.125"	E40-157	4.0mm	4.0 - 3.0mm
E40-012	3/16"	0.187 - 0.156"	E40-196	5.0mm	5.0 - 4.0mm
E40-014	7/32"	0.219 - 0.187"	E40-236	6.0mm	6.0 - 5.0mm
E40-016	1/4"	0.250 - 0.219"	E40-275	7.0mm	7.0 - 6.0mm
E40-018	9/32"	0.281 - 0.250"	E40-314	8.0mm	8.0 - 7.0mm
E40-020	5/16"	0.312 - 0.281"	E40-354	9.0mm	9.0 - 8.0mm
E40-022	11/32"	0.344 - 0.312"	E40-393	10.0mm	10.0 - 9.0mm
E40-024	3/8"	0.375 - 0.344"	E40-433	11.0mm	11.0 - 10.0mm
E40-026	13/32"	0.406 - 0.375"	E40-452	11.5mm	11.5 - 10.5mm
E40-028	7/16"	0.437 - 0.406"	E40-472	12.0mm	12.0 - 11.0mm
E40-030	15/32"	0.469 - 0.437"	E40-511	13.0mm	13.0 - 12.0mm
E40-032	1/2"	0.500 - 0.469"	E40-551	14.0mm	14.0 - 13.0mm
E40-034	17/32"	0.531 - 0.500"	E40-590	15.0mm	15.0 - 14.0mm
E40-036	9/16"	0.563 - 0.531"	E40-629	16.0mm	16.0 - 15.0mm
E40-038	19/32"	0.594 - 0.563"	E40-669	17.0mm	17.0 - 16.0mm
E40-040	5/8"	0.625 - 0.594"	E40-708	18.0mm	18.0 - 17.0mm
E40-042	21/32"	0.656 - 0.625"	E40-748	19.0mm	19.0 - 18.0mm
E40-044	11/16"	0.688 - 0.656"	E40-767	19.5mm	19.5 - 18.5mm
E40-046	23/32"	0.719 - 0.688"	E40-787	20.0mm	20.0 - 19.0mm
E40-048	3/4"	0.750 - 0.719"	E40-826	21.0mm	21.0 - 20.0mm
E40-050	25/32"	0.781 - 0.750"	E40-866	22.0mm	22.0 - 21.0mm
E40-052	13/16"	0.813 - 0.781"	E40-905	23.0mm	23.0 - 22.0mm
E40-054	27/32"	0.844 - 0.813"	E40-944	24.0mm	24.0 - 23.0mm
E40-056	7/8"	0.875 - 0.844"	E40-984	25.0mm	25.0 - 24.0mm
E40-058	29/32"	0.906 - 0.875"	E40-1023	26.0mm	26.0 - 25.0mm
E40-060	15/16"	0.938 - 0.906"			
E40-062	31/32"	0.969 - 0.938"			
E40-064	1"	1.000 - 0.969"			

ER40 Collet Sets

E40-SET-25	25 Piece Set 1/4" - 1" by 1/32nds
E40-SET-23-MM	23 Piece Set 4.0mm - 26.0mm by 1.0mm

Note: See dimensional data for ER40 Collets on page 41.



Coolant-Thru

Our patented Coolant Collets are designed for use with cylindrical shank tools (no flats). Cutting tool should be inserted the full length of the collet. If these conditions are not met, coolant leakage may result. Seals up to maximum coolant pressure of 1000 psi.

Size range: 5/16 - 1"
(0.312 - 1.000")

Size range: 10.0 - 26.0mm
(0.394 - 1.024")

Inch Coolant-Thru

Part Number	Size	Collapse Range
E40-020(C)	5/16"	0.312 - 0.297"
E40-024(C)	3/8"	0.375 - 0.359"
E40-028(C)	7/16"	0.437 - 0.422"
E40-032(C)	1/2"	0.500 - 0.484"
E40-036(C)	9/16"	0.563 - 0.547"
E40-040(C)	5/8"	0.625 - 0.609"

Metric Coolant-Thru

Part Number	Size	Collapse Range
E40-393(C)	10.0mm	10.0 - 9.5mm
E40-413(C)	10.5mm	10.5 - 10.0mm
E40-433(C)	11.0mm	11.0 - 10.5mm
E40-452(C)	11.5mm	11.5 - 11.0mm
E40-472(C)	12.0mm	12.0 - 11.5mm
E40-492(C)	12.5mm	12.5 - 12.0mm
E40-511(C)	13.0mm	13.0 - 12.5mm
E40-531(C)	13.5mm	13.5 - 13.0mm
E40-551(C)	14.0mm	14.0 - 13.5mm
E40-570(C)	14.5mm	14.5 - 14.0mm
E40-590(C)	15.0mm	15.0 - 14.5mm
E40-610(C)	15.5mm	15.5 - 15.0mm
E40-629(C)	16.0mm	16.0 - 15.5mm
E40-649(C)	16.5mm	16.5 - 16.0mm
E40-669(C)	17.0mm	17.0 - 16.5mm
E40-688(C)	17.5mm	17.5 - 17.0mm
E40-708(C)	18.0mm	18.0 - 17.5mm
E40-728(C)	18.5mm	18.5 - 18.0mm
E40-748(C)	19.0mm	19.0 - 18.5mm
E40-767(C)	19.5mm	19.5 - 19.0mm
E40-787(C)	20.0mm	20.0 - 19.5mm
E40-807(C)	20.5mm	20.5 - 20.0mm
E40-826(C)	21.0mm	21.0 - 20.5mm
E40-846(C)	21.5mm	21.5 - 21.0mm
E40-866(C)	22.0mm	22.0 - 21.5mm
E40-885(C)	22.5mm	22.5 - 22.0mm
E40-905(C)	23.0mm	23.0 - 22.5mm
E40-925(C)	23.5mm	23.5 - 23.0mm
E40-944(C)	24.0mm	24.0 - 23.5mm
E40-964(C)	24.5mm	24.5 - 24.0mm
E40-984(C)	25.0mm	25.0 - 24.5mm
E40-1003(C)	25.5mm	25.5 - 25.0mm
E40-1023(C)	26.0mm	26.0 - 25.0mm

ER40 Coolant Collet Sets

E40-SET-33(C)-MM	33 Piece Set 10.0mm - 26.0mm by 0.5mm
------------------	---------------------------------------

ER Tap Collets

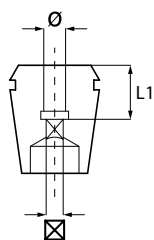

ER Tap Collets feature a unique design that incorporates an internal square drive with our popular ER Series Collets. The square drive matches the tap square, providing a tight fit for all rigid tapping applications.

Note: Diameter and Square size are in accordance with U.S. Standard Taps.

Part Number	ER Series	Tap Inch Style	Tap Metric Size	L1 (mm)	∅	⊠
ET16-168	ER16	#8, 5/32"	M4	15	0.168"	0.131"
ET16-194	ER16	#10, 3/16"	M4.5, M5	15	0.194"	0.152"
ET16-220	ER16	#12, 7/32"	-	15	0.220"	0.165"
ET16-255	ER16	#14, 1/4"	M6, M6.5	22	0.255"	0.191"
ET20-168	ER20	#8, 5/32"	M4	15	0.168"	0.131"
ET20-194	ER20	#10, 3/16"	M4.5, M5	15	0.194"	0.152"
ET20-220	ER20	#12, 7/32"	-	15	0.220"	0.165"
ET20-255	ER20	#14, 1/4"	M6, M6.5	20	0.255"	0.191"
ET20-318	ER20	5/16"	M7, M6.5, M8	20	0.318"	0.238"
ET20-323	ER20	7/16"	-	20	0.323"	0.242"
ET20-367	ER20	1/2"	M12, M12.5	25	0.367"	0.275"
ET20-381	ER20	3/8"	M10	20	0.381"	0.286"
ET25-168	ER25	#8, 5/32"	M4	15	0.168"	0.131"
ET25-194	ER25	#10, 3/16"	M4.5, M5	15	0.194"	0.152"
ET25-220	ER25	#12, 7/32"	-	15	0.220"	0.165"
ET25-255	ER25	#14, 1/4"	M6, M6.5	20	0.255"	0.191"
ET25-318	ER25	5/16"	M7, M6.5, M8	20	0.318"	0.238"
ET25-323	ER25	7/16"	-	20	0.323"	0.242"
ET25-367	ER25	1/2"	M12, M12.5	25	0.367"	0.275"
ET25-381	ER25	3/8"	M10	20	0.381"	0.286"
ET25-429	ER25	9/16"	M14	25	0.429"	0.322"
ET25-437	ER25	1/8" NPT(L)	-	18	0.437"	0.328"
ET25-480	ER25	5/8"	M16	25	0.480"	0.360"
ET32-168	ER32	#8, 5/32"	M4	15	0.168"	0.131"
ET32-194	ER32	#10, 3/16"	M4.5, M5	15	0.194"	0.152"
ET32-220	ER32	#12, 7/32"	-	15	0.220"	0.165"
ET32-255	ER32	#14, 1/4"	M6, M6.5	20	0.255"	0.191"
ET32-318	ER32	5/16"	M7, M6.5, M8	20	0.318"	0.238"
ET32-323	ER32	7/16"	-	20	0.323"	0.242"
ET32-367	ER32	1/2"	M12, M12.5	25	0.367"	0.275"
ET32-381	ER32	3/8"	M10	20	0.381"	0.286"
ET32-429	ER32	9/16"	M14	25	0.429"	0.322"
ET32-437	ER32	1/8" NPT	-	18	0.437"	0.328"
ET32-480	ER32	5/8"	M16	25	0.480"	0.360"
ET32-542	ER32	1 1/16"	M18	30	0.542"	0.406"
ET32-562	ER32	1/4" NPT	-	18	0.562"	0.421"
ET32-590	ER32	3/4"	-	30	0.590"	0.442"
ET32-652	ER32	13/16"	M20	30	0.652"	0.489"
ET40-255	ER40	#14, 1/4"	M6, M6.5	25	0.255"	0.191"
ET40-318	ER40	5/16"	M7, M6.5, M8	25	0.318"	0.238"
ET40-323	ER40	7/16"	-	25	0.323"	0.242"
ET40-367	ER40	1/2"	M12, M12.5	25	0.367"	0.275"
ET40-381	ER40	3/8"	M10	25	0.381"	0.286"
ET40-429	ER40	9/16"	M14	25	0.429"	0.322"
ET40-437	ER40	1/8" NPT	-	18	0.437"	0.328"
ET40-480	ER40	5/8"	M16	25	0.480"	0.360"
ET40-542	ER40	1 1/16"	M18	30	0.542"	0.406"
ET40-562	ER40	1/4" NPT	-	18	0.562"	0.421"
ET40-590	ER40	3/4"	-	30	0.590"	0.442"
ET40-652	ER40	13/16"	M20	30	0.652"	0.489"
ET40-687	ER40	1/2" NPT	-	18	0.687"	0.515"
ET40-697	ER40	7/8"	M22	30	0.697"	0.523"
ET40-700	ER40	3/8" NPT	-	18	0.700"	0.531"
ET40-760	ER40	15/16"	M24	35	0.760"	0.570"
ET40-800	ER40	1"	M25	35	0.800"	0.600"

ER Tap Coolant Collets

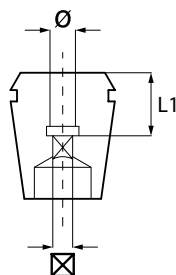

Lyndex-Nikken has now combined the versatility of our ER Tapping Collets with the popularity of our Coolant Collets to create our patented ER Coolant Tap Collets.

Note: Diameter and Square size are in accordance with U.S. Standard Taps.

Part Number	ER Series	Tap Inch Style	Tap Metric Size	L1 (mm)	ø	⊠
ET16-255(C)	ER16	#14, 1/4"	M6, M6.5	22	0.255"	0.191"
ET16-318(C)	ER16	5/16"	M7, M6.5, M8	22	0.318"	0.238"
ET20-255(C)	ER20	#14, 1/4"	M6, M6.5	25	0.255"	0.191"
ET20-318(C)	ER20	5/16"	M7, M6.5, M8	25	0.318"	0.238"
ET20-323(C)	ER20	7/16"	-	25	0.323"	0.242"
ET20-367(C)	ER20	1/2"	M12, M12.5	25	0.367"	0.275"
ET20-381(C)	ER20	3/8"	M10	25	0.381"	0.286"
ET25-255(C)	ER25	#14, 1/4"	M6, M6.5	25	0.255"	0.191"
ET25-318(C)	ER25	5/16"	M7, M6.5, M8	25	0.318"	0.238"
ET25-323(C)	ER25	7/16"	-	25	0.323"	0.242"
ET25-367(C)	ER25	1/2"	M12, M12.5	25	0.367"	0.275"
ET25-381(C)	ER25	3/8"	M10	27	0.381"	0.286"
ET25-429(C)	ER25	9/16"	M14	25	0.429"	0.322"
ET25-480(C)	ER25	5/8"	M16	30	0.480"	0.360"
ET32-255(C)	ER32	#14, 1/4"	M6, M6.5	30	0.255"	0.191"
ET32-318(C)	ER32	5/16"	M7, M6.5, M8	25	0.318"	0.238"
ET32-323(C)	ER32	7/16"	-	25	0.323"	0.242"
ET32-367(C)	ER32	1/2"	M12, M12.5	25	0.367"	0.275"
ET32-381(C)	ER32	3/8"	M10	27	0.381"	0.286"
ET32-429(C)	ER32	9/16"	M14	25	0.429"	0.322"
ET32-480(C)	ER32	5/8"	M16	30	0.480"	0.360"
ET32-542(C)	ER32	11/16"	M18	30	0.542"	0.406"
ET32-590(C)	ER32	3/4"	-	35	0.590"	0.442"
ET32-652(C)	ER32	13/16"	M20	35	0.652"	0.489"
ET40-323(C)	ER40	7/16"	-	35	0.323"	0.242"
ET40-367(C)	ER40	1/2"	M12, M12.5	25	0.367"	0.275"
ET40-381(C)	ER40	3/8"	M10	27	0.381"	0.286"
ET40-429(C)	ER40	9/16"	M14	25	0.429"	0.322"
ET40-480(C)	ER40	5/8"	M16	30	0.480"	0.360"
ET40-542(C)	ER40	11/16"	M18	30	0.542"	0.406"
ET40-590(C)	ER40	3/4"	-	35	0.590"	0.442"
ET40-652(C)	ER40	13/16"	M20	35	0.652"	0.489"
ET40-697(C)	ER40	7/8"	M22	35	0.697"	0.523"
ET40-760(C)	ER40	15/16"	M24	38	0.760"	0.570"
ET40-800(C)	ER40	1"	M25	38	0.800"	0.600"

Note: Seals up to a maximum coolant pressure of 1000 psi.

ER Collet Chuck Accessories

ER Collet Rack

Part Number	Description
RACK-ER11/SK6	ER11 Collet Rack, 35 collet capacity
RACK-ER20/1TAP	ER20 Collet Rack, 24 collet capacity
RACK-180DA/SK16/ER25	ER25 Collet Rack, 30 collet capacity
RACK-ER32/2TAP	ER32 Collet Rack, 24 collet capacity
RACK-ER40	ER40 Collet Rack, 24 collet capacity



Replacement Nut for ER Collet Chuck

Part Number	Description
08-NANUT	ER8 Nut
E11-NUT	ER11 Hex Nut
E16-NUT	ER16 Nut
O16-NUT	ER16 Hex Nut
E20-NUT	ER20 Nut
E25-NUT	ER25 Nut
E32-NUT	ER32 Nut
E32-NUT-ST	ER32 Nut (Short) for C5057-0032-12.00
E40-NUT	ER40 Nut
E40-NUT-ST	ER40 Nut (Short) for C5057-0040-12.00



Spanner Wrench for ER Collet Chuck Nut

Part Number	Description
08-NASPAN	Wrench for ER8 Chuck Nut
O11-HEX	Wrench for ER11 Chuck Nut
O16-SPAN	Wrench for ER16 Chuck Nut
O20-SPAN	Wrench for ER20 Chuck Nut
O25-SPAN	Wrench for ER25 Chuck Nut
O32-SPAN	Wrench for ER32 Chuck Nut
O40-SPAN	Wrench for ER40 Chuck Nut



ER Collet Chuck Accessories

Torque Wrench and Attachment for ER Collet Chuck Nut

Part Number	Description
TQW-025	Torque Wrench for ER8 Chuck Nut
TQW-150	Torque Wrench for ER11/16/20/25/32/40 Chuck Nut
TQW-ER08	ER8 Attachment for TQW-025 Torque Wrench
TQW-ER11(17)	ER11 Attachment for TQW-150 Torque Wrench
TQW-ER16(32)	ER16 Attachment for TQW-150 Torque Wrench
TQW-ER20(32)	ER20 Attachment for TQW-150 Torque Wrench
TQW-ER25(43)	ER25 Attachment for TQW-150 Torque Wrench
TQW-ER32(50)	ER32 Attachment for TQW-150 Torque Wrench
TQW-ER40(63)	ER40 Attachment for TQW-150 Torque Wrench

Note: (XX) Denotes nut diameter.



Replacement Back Up Screws for ER Collet Chuck

Part Number	Description
ER8-3	ER8 Backup Screws
ER8-3 (C)	ER8 Coolant-thru Backup Screws
ER11-3	ER11 Backup Screws*
ER11-3 (C)	ER11 Coolant-thru Backup Screws*
ER16-3	ER16 Backup Screws
ER16-3 (C)	ER16 Coolant-thru Backup Screws
ER20-3	ER20 Backup Screws
ER20-3 (C)	ER20 Coolant-thru Backup Screws
ER25-3	ER25 Backup Screws
ER25-3 (C)	ER25 Coolant-thru Backup Screws
ER32-3	ER32 Backup Screws
ER32-3 (C)	ER32 Coolant-thru Backup Screws
ER40-3	ER40 Backup Screws
ER40-3 (C)	ER40 Coolant-thru Backup Screws

Note: *ER11-3 can also be used with ER16 Collet Chuck Extension.



Coolant Tube Wrench for HSK Holders

Part Number	Description
HSK40-WRENCH	Wrench for HSK40 Coolant Tube
HSK63-WRENCH	Wrench for HSK63 Coolant Tube
HSK100-WRENCH	Wrench for HSK100 Coolant Tube

Note: Coolant Tube Wrenches are needed to remove or install coolant tubes in HSK toolholders.



Coolant Tube for HSK Holders

Part Number	Description
HSK40-TUBE	Coolant Tube for HSK40 holder
HSK63-TUBE	Coolant Tube for HSK63 holder
HSK100-TUBE	Coolant Tube for HSK100 holder



ADVANCED TOOLHOLDERS

SK COLLET CHUCKS

LEAN, TOUGH AND EFFICIENT (Pages 9-38)

- Narrow body design accesses tight spots.
- Applicable for all milling, drilling, reaming and rigid tapping applications.
- Two times more accurate than ER Collet Chucks, within 10 times better repeatability.
- Over 1 million SK Collet Chucks and 15 million SK collets sold worldwide.



VC COLLET CHUCKS

ULTRA PERFORMANCE (Pages 63-74)

- Extremely precise with 0.00012" or less concentricity guarantee with any collet.
- Ideal for high-speed machining, thread milling, ultra precision reaming.
- Two times more accurate than ER Collet Chucks, within 10 times better repeatability.



SHRINK FIT HOLDERS

HIGH ACCURACY WITH OPTIMAL CLEARANCE (Pages 83-96)

- Shrink fit holders provide minimal run out.
- Pre-balanced for up to 40,000 RPM.
- Excellent surface finish, extreme gripping and ideal for high-speed applications.
- Increase cutting tool life, material removal rate and workpiece accuracy.

