

COOLANT PORT OPTION

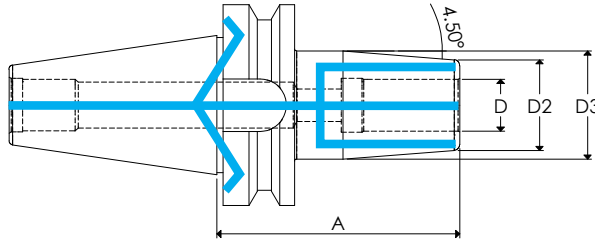

STANDARD TYPE



Part Number	D	A	D2	D3
BT50-SF0250-3.94CP*	1/4"	3.94"	0.79"	1.06"
BT50-SF0375-3.94CP*	3/8"	3.94"	0.94"	1.26"
BT50-SF0500-3.94CP*	1/2"	3.94"	0.94"	1.26"
BT50-SF0625-3.94CP*	5/8"	3.94"	1.06"	1.34"
BT50-SF0750-3.94CP*	3/4"	3.94"	1.30"	1.65"
BT50-SF1000-3.94CP*	1"	3.94"	1.73"	2.09"
BT50-SF1250-3.94CP*	1.1/4"	3.94"	1.73"	2.09"

Part Number	D	A	D2	D3
BT50-SF8-100CP*	8mm	100	20	27
BT50-SF10-100CP*	10mm	100	24	32
BT50-SF12-100CP*	12mm	100	24	32
BT50-SF16-100CP*	16mm	100	27	34
BT50-SF20-100CP*	20mm	100	33	42
BT50-SF25-100CP*	25mm	100	44	53
BT50-SF32-100CP*	32mm	100	44	53

INCH

METRIC

\*Pricing on Request

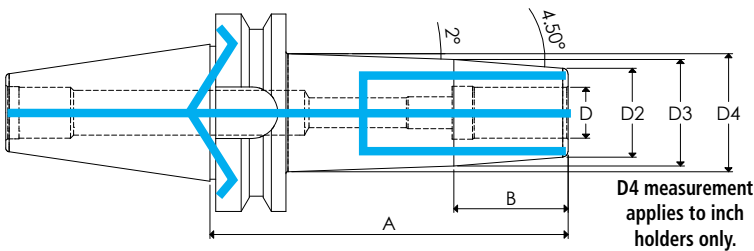

EXTENDED TYPE



Part Number	D	A	D2	D3	D4	B
BT50-SF0250-6.30CP*	1/4"	6.30"	0.79"	1.06"	1.32"	1.50"
BT50-SF0375-6.30CP*	3/8"	6.30"	0.94"	1.26"	1.32"	1.50"
BT50-SF0500-6.30CP*	1/2"	6.30"	0.94"	1.26"	1.49"	2.00"
BT50-SF0625-6.30CP*	5/8"	6.30"	1.06"	1.34"	1.49"	2.00"
BT50-SF0750-6.30CP*	3/4"	6.30"	1.30"	1.65"	1.78"	1.75"
BT50-SF1000-6.30CP*	1"	6.30"	1.73"	2.09"	2.29"	2.25"
BT50-SF1250-6.30CP*	1.1/4"	6.30"	1.73"	2.09"	2.30"	2.25"

Part Number	D	A	D2	D3	B
BT50-SF8-160CP*	8mm	160	20	27	38.12
BT50-SF10-160CP*	10mm	160	24	32	50.83
BT50-SF12-160CP*	12mm	160	24	32	50.83
BT50-SF16-160CP*	16mm	160	27	34	44.47
BT50-SF20-160CP*	20mm	160	33	42	57.18
BT50-SF25-160CP*	25mm	160	44	53	57.18
BT50-SF32-160CP*	32mm	160	44	53	57.18

\*Pricing on Request

D4 measurement applies to inch holders only.