

Standard: DIN69893 HSK E  
 Material: H11 High Alloy Steel  
 Hardness: 52 HRC tempered  
 Runout: .000040" to .00012" at 3 X Diameter of Tool  
 Balancing: <1g.mm (HSK32E and 40E) - <1.5g (HSK50E) at 42,000 RPM  
 Cooling: Center-thru

Features: All shrink fit holders 6 mm (1/4") and above include a backup screw.  
 Application: Compatible with h6 tolerance Steel, HSS, Carbide  
 Accessories: **Compatible with Part# RE011 shrink fit reductions and shrink fit extensions (see pages 36-37). Replacement Backup Screw (see page 37). HSK32/40/50E Coolant Tube and wrench (not included, see page 37 to order).**

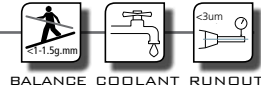

STANDARD TYPE

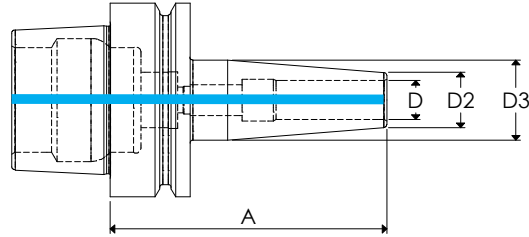

INCH

Part Number	D	A	D2	D3
H32E-SF0125-2.76	1/8"	2.76"	0.35"	-
H32E-SF0250-2.76	1/4"	2.76"	0.79"	1.06"
H32E-SF0375-2.95	3/8"	2.95"	0.95"	1.26"
H40E-SF0250-3.15	1/4"	3.15"	0.79"	1.06"
H40E-SF0375-3.15	3/8"	3.15"	0.95"	1.26"
H40E-SF0500-3.54	1/2"	3.54"	0.95"	1.26"
H40E-SF0625-3.54	5/8"	3.54"	1.06"	1.34"
H50E-SF0250-3.15	1/4"	3.15"	0.79"	1.06"
H50E-SF0375-3.35	3/8"	3.35"	0.95"	1.26"
H50E-SF0500-3.54	1/2"	3.54"	0.95"	1.26"
H50E-SF0625-3.54	5/8"	3.54"	1.06"	1.34"

METRIC

Part Number	D	A	D2	D3
H32E-SF3-70	3mm	70	9	-
H32E-SF6-70	6mm	70	20	27
H32E-SF10-75	10mm	75	24	32
H40E-SF4-70	4mm	70	10	-
H40E-SF6-80	6mm	80	20	27
H40E-SF10-80	10mm	80	24	32
H40E-SF12-90	12mm	90	24	32
H40E-SF16-90	16mm	90	27	34
H50E-SF4-80	4mm	80	10	22
H50E-SF6-80	6mm	80	20	27
H50E-SF10-85	10mm	85	24	32
H50E-SF12-90	12mm	90	24	32
H50E-SF16-90	16mm	90	27	34

MOLD TYPE

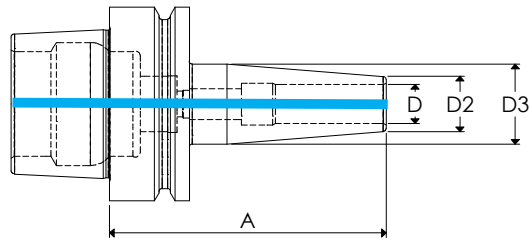

Part Number	D	A	D2	D3
H50E-SF0125-6.30MT	1/8"	6.30"	0.35"	0.87"
H50E-SF0250-6.30MT	1/4"	6.30"	0.47"	1.06"
H50E-SF0375-6.30MT	3/8"	6.30"	0.63"	1.26"
H50E-SF0500-6.30MT	1/2"	6.30"	0.71"	1.26"
H50E-SF0625-6.30MT	5/8"	6.30"	0.95"	1.34"

Part Number	D	A	D2	D3
H50E-SF3-160MT	3mm	160	9	22
H50E-SF6-160MT	6mm	160	12	27
H50E-SF10-160MT	10mm	160	16	32
H50E-SF12-160MT	12mm	160	18	32
H50E-SF16-160MT	16mm	160	24	34