

Standard: DIN69893A/ DIN 69882-8
 Material: H11 High Alloy Steel
 Hardness: 52 HRC tempered
 Runout: .000040" to .00012" at 3 X Diameter of Tool
 Balancing: <3g.mm at 24,000 RPM (HSK63A)
 Cooling: Center-thru and Face Coolant (HSK63A Standard and Extended only)

Features: All shrink fit holders 6 mm (1/4") and above include a backup screw.
 Application: Compatible with h6 tolerance Steel, HSS, Carbide
 Accessories: **Compatible with Part# RE011 shrink fit reductions and shrink fit extensions (see pages 36-37). Replacement Backup Screw (see page 37). HSK63A Coolant Tube and wrench (not included, see page 37 to order).**

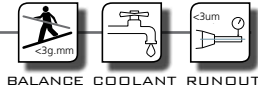

STANDARD TYPE

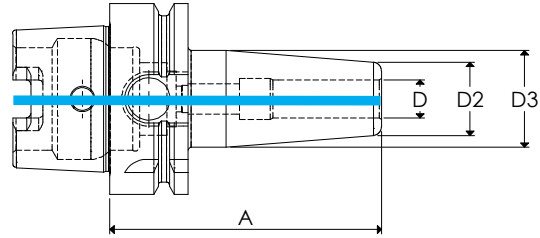

INCH

Part Number	D	A	D2	D3
H63A-SF0250-3.15	1/4"	3.15"	0.79"	1.06"
H63A-SF0312-3.15	5/16"	3.15"	0.79"	1.06"
H63A-SF0375-3.35	3/8"	3.35"	0.94"	1.26"
H63A-SF0500-3.54	1/2"	3.54"	0.94"	1.26"
H63A-SF0625-3.74	5/8"	3.74"	1.06"	1.34"
H63A-SF0750-3.94	3/4"	3.94"	1.30"	1.65"
H63A-SF1000-4.53	1"	4.53"	1.73"	2.09"

METRIC

Part Number	D	A	D2	D3
H63A-SF6-80	6mm	80	20	27
H63A-SF8-80	8mm	80	20	27
H63A-SF10-85	10mm	85	24	32
H63A-SF12-90	12mm	90	24	32
H63A-SF16-95	16mm	95	27	34
H63A-SF20-100	20mm	100	33	42
H63A-SF25-115	25mm	115	44	53

EXTENDED TYPE

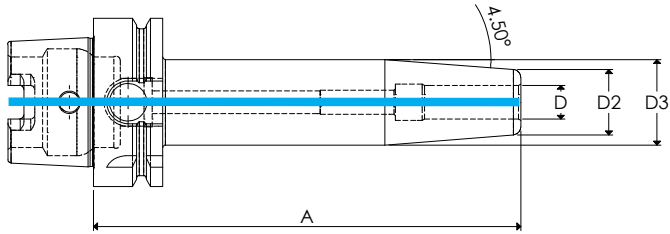

Part Number	D	A	D2	D3
H63A-SF0250-4.72	1/4"	4.72"	0.79"	1.06"
H63A-SF0250-6.30	1/4"	6.30"	0.79"	1.06"
H63A-SF0312-4.72	5/16"	4.72"	0.79"	1.06"
H63A-SF0312-6.30	5/16"	6.30"	0.79"	1.06"
H63A-SF0375-4.72	3/8"	4.72"	0.95"	1.26"
H63A-SF0375-6.30	3/8"	6.30"	0.95"	1.26"
H63A-SF0500-4.72	1/2"	4.72"	0.95"	1.26"
H63A-SF0500-6.30	1/2"	6.30"	0.95"	1.26"
H63A-SF0625-4.72	5/8"	4.72"	1.06"	1.34"
H63A-SF0625-6.30	5/8"	6.30"	1.06"	1.34"
H63A-SF0750-6.30	3/4"	6.30"	1.30"	1.65"
H63A-SF1000-6.30	1"	6.30"	1.73"	2.07"

Part Number	D	A	D2	D3
H63A-SF6-120	6mm	120	20	27
H63A-SF6-160	6mm	160	20	27
H63A-SF8-120	8mm	120	20	27
H63A-SF8-160	8mm	160	20	27
H63A-SF10-120	10mm	120	24	32
H63A-SF10-160	10mm	160	24	32
H63A-SF12-120	12mm	120	24	32
H63A-SF12-160	12mm	160	24	32
H63A-SF16-120	16mm	120	27	34
H63A-SF16-160	16mm	160	27	34
H63A-SF20-160	20mm	160	33	42
H63A-SF25-160	25mm	160	44	52.6