

## HSK Milling Chucks

- Nikken patented design
- Nut body contact, nose clamping and anti-vibration mechanism
- Thick body and internal slots provide extremely strong chucking torque and rigidity
- Quiet and stable heavy milling
- 140% more bearing surface than competitors' milling chucks



**T.I.R.:** <0.0002" at 3xD



**Speed:** up to 20,000 RPM



**Set-up:** quick and easy



**Coolant-Thru:** thru-tool coolant



Milling



Drilling



Tapping



Reaming

Please note that the maximum RPM listed in our catalog may vary depending on the toolholder shank, weight, balanceability and the G rating.

### HSK63A

Part Number	Collet Size	Clamping Range	Spanner Wrench	d	L	L1	D
HSK63A-C3/4-95	KM3/4	0.125-0.750"	9HC22	0.750"	3.740"	2.677"	2.027"
HSK63A-C3/4-110	KM3/4	0.125-0.750"	9HC22	0.750"	4.330"	3.149"	2.027"
HSK63A-C1-100	KM1	0.125-1.000"	9HC25	1.000"	3.937"	2.972"	2.342"
HSK63A-C1-130	KM1	0.125-1.000"	9HC25	1.000"	5.118"	3.149"	2.342"
HSK63A-C1.1/4-110	KM1.1/4	0.187-1.250"	9HC32	1.250"	4.330"	3.267"	2.716"
HSK63A-C1.1/4-130	KM1.1/4	0.187-1.250"	9HC32	1.250"	5.118"	3.188"	2.716"
HSK63A-C32-130	KM32	6 - 32mm	9HC32	32mm	5.118"	3.188"	2.716"

Note: Spanner wrench, coolant tube and coolant tube wrench not included.  
Please see page 117 for more details.

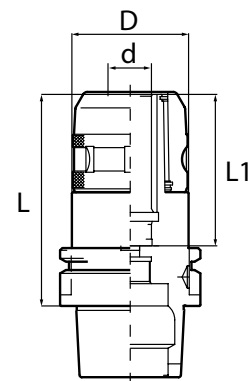

### HSK63A High Speed

Part Number	Collet Size	Clamping Range	High-Speed Spanner Wrench	d	L	L1	D
HSK63A-C3/4-95G	KM3/4	0.125-0.750"	GH20	0.750"	3.740"	2.677"	1.889"
HSK63A-C3/4-110G	KM3/4	0.125-0.750"	GH20	0.750"	4.330"	3.149"	1.889"
HSK63A-C1-100G	KM1	0.125-1.000"	GH25	1.000"	3.937"	2.972"	2.149"
HSK63A-C1-130G	KM1	0.125-1.000"	GH25	1.000"	5.118"	2.149"	2.165"
HSK63A-C1.1/4-110G	KM1.1/4	0.187-1.250"	GH32	1.250"	4.330"	3.267"	2.677"
HSK63A-C1.1/4-130G	KM1.1/4	0.187-1.250"	GH32	1.250"	5.118"	3.188"	2.677"

Note:

- High-Speed Spanner wrench, coolant tube and coolant tube wrench not included. Please see page 117 for more details.
- High-speed HSK63A Milling Chucks use special high-speed spanner wrenches.

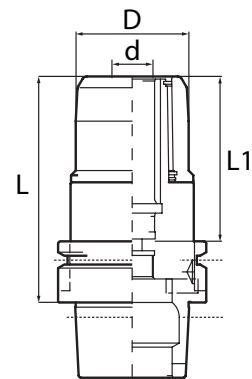

### HSK63F High Speed

Part Number	Collet Size	Clamping Range	High-Speed Spanner Wrench	d	L	L1	D
HSK63F-C3/4-95G	KM3/4	0.125-0.750"	GH20	0.750"	3.740"	2.677"	3.307"
HSK63F-C1-100G	KM1	0.125-1.000"	GH25	1.000"	3.937"	2.952"	2.149"
HSK63F-C1.1/4-110G	KM1.1/4	0.187-1.250"	GH32	1.250"	4.330"	3.267"	2.677"

Note:

- High-Speed Spanner wrench, coolant tube, and coolant tube wrench not included. Please see page 117 for more details.
- High-speed HSK63F Milling Chucks use special high-speed spanner wrenches.

