



AUTOMOTIVE SPECIALTY TOOLS

You will find Stanley[®] Proto[®] tools earning their keep in every type of shop and in every imaginable industry. Our tools are used in workplaces that range from aircraft hangars to manufacturing plants to military bases. While each of these industries has unique needs they all have at least one thing in common: they all have vehicles. Some in fact have entire fleets. As part of our commitment to meeting all our customers' hand tool needs, we offer the tools needed to maintain and repair those vehicles.

Because most of the tools used by the automotive technician are also used by other industries you will find them spread across the various sections of this catalog. These tools include screwdrivers, socket sets, combination and ratcheting wrenches, pullers, precision torque tools, and a number of others.

While nearly all trades use wrenches, there are some tools that are used mostly – and in some cases exclusively by people who work on cars, trucks, and heavy equipment.

These specialty items include things like feeler gauges, compression testers, gasket scrapers, budd wheel sockets, and ignition wrenches, as well as hose clamps and oil filter wrenches. The following pages list these tools and many others.

These pages also list tools like screw extractors which are used in many different industries, but that are of particular value to the automotive technician.

We can even create a tool technician's complete tool set. With our custom set program, a Proto[®] rep can show you how to combine any of our tools into a custom set that's perfectly tailored to the work done on your vehicles.

Proto[®] tools are engineered to meet various government, ASME, and aerospace specifications. So whether you're changing the brakes on the company pickup truck or overhauling a tank, we have tools that live up to the high standards that you need and trust.

22 BLADE STEP CUT FEELER GAUGE SET

- "Go and no-go" blades 1/2" wide by 3-5/16" long in holder.
- Each blade has two different thicknesses.
- Sizes include: .004/.006", .005/.007", .006/.008", .007/.009", .008/.010", .009/.011", .010/.012", .011/.013", .012/.014", .013/.015", .014/.016", .015/.017", .016/.018", .017/.019", .018/.020", .019/.021", .020/.022", .021/.023", .022/.024", .023/.025", .024/.026", .025/.027".
- Blades etched with both decimal size and metric equivalent.

Product ID No.	Weight lbs.
J000N	.18



25 BLADE MASTER FEELER GAUGE SET

- Contains twenty-five short blades in holder.
- Includes all short blade sizes .0015" thru .040" except .019".
- Blades etched with both decimal size and metric equivalent.

Product ID No.	Weight lbs.
J000AA	0.19



9 BLADE STANDARD FEELER GAUGE SET

- Contains 9 short blades in holder.
- Short blades in sizes .003", .004", .005", .006", .008", .010", .012", .015", .018", in No. 000C holder.
- Blades etched with both decimal size and metric equivalent.

Product ID No.	Weight lbs.
J000A	0.07



25 BLADE LONG FEELER GAUGE SET

- 1/2" wide by 12" long blades in steel blade holder.
- Sizes: .0015", .002", .003", .004", .005", .006", .007", .008", .009", .010", .011", .012", .013", .014", .015", .016", .017", .018", .019", .020", .021", .025", .027", .030", .040".
- Blades etched with both decimal size and metric equivalent.

Product ID No.	Weight lbs.
J000TL	0.72





12 BLADE LONG FEELER GAUGE SET

- Blades 1/2" wide by 12" long in steel holder.
- Includes sizes: .0015", .002", .003", .004", .005", .006", .008", .010", .012", .014", .015", .020".
- Blades etched with both decimal size and metric equivalent.

Product ID No.	Weight lbs.
J000SL	0.30



25 BLADE METRIC FEELER GAUGE SET

- 1/2" x 3-5/16" metric blades in steel holder.
- Sizes: 0.04 mm, 0.05 mm, 0.06 mm, 0.07 mm, 0.08 mm, 0.09 mm, 0.10 mm, 0.15 mm, 0.20 mm, 0.25 mm, 0.30 mm, 0.35 mm, 0.40 mm, 0.45 mm, 0.50 mm, 0.55 mm, 0.60 mm, 0.65 mm, 0.70 mm, 0.75 mm, 0.80 mm, 0.85 mm, 0.90 mm, 0.95 mm, 1.00 mm.

Product ID No.	Weight lbs.
J00MM25	0.22



16 BLADE OVERHEAD VALVE FEELER GAUGE SET

- 1/2" wide bent gauges for setting overhead valves.
- Includes sizes .009", .010", .011", .014", .015", .016", .017", .018", .019", .020", .021", .023", .024", .025", .026", .027".
- Blades are etched with both the decimal size and metric equivalent.
- Blades are offset at a right angle to help protect hands from a hot manifold while setting an overhead valve.

Product ID No.	Weight lbs.
J000R	0.25



11 BLADE BENT FEELER GAUGE SET

- Blades 1/2" wide by 4-3/16" in sizes .006", .008", .010", .011", .012", .013", .014", .015", .018", .019", .020".
- Blades are etched with both the decimal size and metric equivalent.

Product ID No.	Weight lbs.
J000M	0.13



15 BLADE METRIC FEELER GAUGE SET

- Steel blade holder contains one each of the following 1/2" x 3-5/16" blades; 0.06mm, 0.07mm, 0.08mm, 0.10mm, 0.15mm, 0.20mm, 0.25mm, 0.30mm, 0.35mm, 0.40mm, 0.45mm, 0.50mm, 0.55mm, 0.60mm, 0.70mm.

Product ID No.	Weight lbs.
J00MM15	0.13



9 BLADE METRIC FEELER GAUGE SET

- 1/2" x 3-5/16" blades in steel holder.
- Includes sizes: 0.06mm, 0.10mm, 0.15mm, 0.20mm, 0.30mm, 0.35mm, 0.40mm, 0.50mm, 0.60mm.

Product ID No.	Weight lbs.
J00MM9	0.09



6 BLADE NON-MAGNETIC FEELER GAUGE SET

- Contains non-magnetic brass feeler blades for checking the air gap in electronic ignition systems for all weather conditions.
- Each blade is 1/2" wide, 3-5/16" long in sizes .006", .008", .010", .012", .014", .016".
- Etched with both decimal sizes and metric equivalents.

Product ID No.	Weight lbs.
J000BR	0.08



SHORT BLADE HOLDER

- Large enough to accommodate all 26 short blades.

Product ID No.	Weight lbs.
J000C	0.05





10 BLADE IGNITION FEELER GAUGE SET

- Blades 1/4" wide by 1-3/4" in holder.
- Includes sizes .013", .015", .017", .018", .020", .025", .030", .032", .035", .040".
- Etched with both decimal sizes and metric equivalent.

Product ID No.	Weight lbs.
J000D	0.06



HIGH ENERGY SPARK PLUG GAP GAUGE SET

- For use in setting gaps and spark plugs with high energy ignition systems.
- Includes blade holder, electrode bender and six bent wire gauges in sizes .044", .045", .050", .054", .060", .080".
- Gauges marked with both decimal sizes and metric equivalent.

Product ID No.	Weight lbs.
J000J	0.08



SPARK PLUG GAP GAUGE SET

- Spark plug electrode bender and eight bent wire gauges in sizes .020", .025", .028", .030", .032", .034", .035", .040".
- Gauges marked with both decimal sizes and metric equivalent.

Product ID No.	Weight lbs.
J000K	.07

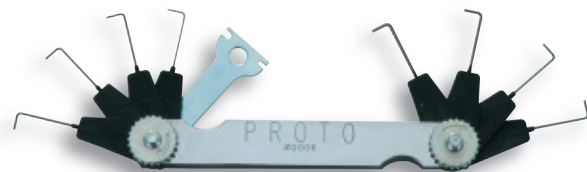

LONG BLADE HOLDER

- Large enough to accommodate all 28 long blades.

Product ID No.	Weight lbs.
J000L	.13

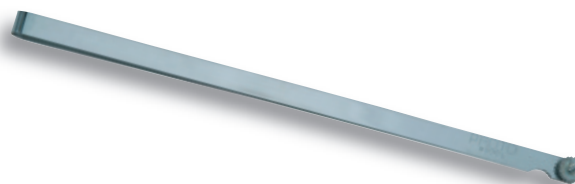

FEELER GAUGES - SHORT BLADE

Product ID No.	Blade Thickness	Weight lbs.
J0015	.0015"	0.01
J002	.002"	0.01
J003	.003"	0.01
J004	.004"	0.04
J005	.005"	0.01
J006	.006"	0.01
J007	.007"	0.01
J008	.008"	0.02
J009	.009"	0.01
J010	.010"	0.02

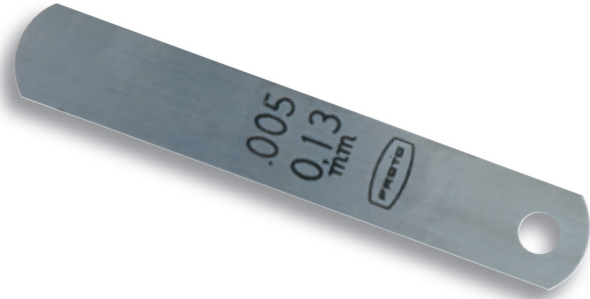



FEELER GAUGES - LONG BLADE

Product ID No.	Blade Thickness	Weight lbs.
J0015L	.0015"	0.01
J002L	.002"	0.01
J003L	.003"	0.03
J004L	.004"	0.01
J005L	.005"	0.01
J006L	.006"	0.02
J008L	.008"	0.02
J010L	.010"	0.02
J015L	.015"	0.03



BUDD WHEEL DEEP LENGTH IMPACT SOCKETS

Product ID No.	 in.	 in.	B	C	L	Weight lbs.
J07524-LS	1-1/2"	3/4"	2-1/4"	1-5/8"	4"	2.96 lbs.
J09924LS	1-1/2"	No. 5 Spline	2-3/8"	2-3/8"	4-3/16"	3.20 lbs.
J10024LS	1-1/2"	1"	2-3/8"	2-3/8"	4"	3.80 lbs.





SET NO. J3200C - 13 PC. IGNITION SET

- Satin finish provides corrosion resistance and a slip resistant grip.
- 15° and 60° angle heads combined with the same opening size on both ends allows the wrench to be used in four different turning angles.
- Standard open end wrench configuration.
- Weight: .67 lbs.



Product ID No.	Contents	15° 	60° 	Length
J3200C	J3210	13/64"	15/64"	3"
	J3211	15/64"	13/64"	3"
	J3215	7/32"	1/4"	3"
	J3216	1/4"	7/32"	3"
	J3220	9/32"	5/16"	3-1/2"
	J3221	5/16"	9/32"	3-1/2"
	J3225	11/32"	3/8"	3-3/4"
	J3226	3/8"	11/32"	3-3/4"
	J000D	Ignition Gauge Set		
	J235	Midget Angle Nose Pliers		
	J2302	Ignition Point File		
	J9853	Screw Starter		
	ST-1150S	Screwdriver, 2" x 1/8" Slotted		
	J25TR10C	Tool Roll		

SET NO. J3200B - 5 PC. IGNITION SET

- Satin finish provides corrosion resistance and a slip resistant grip.
- 15° and 60° angle heads combined with the same opening size on both ends allow the wrench to be used in four different turning angles.
- Standard open end wrench configuration.
- Weight: .47 lbs.



Product ID No.	Contents	15° 	60° 	Length
J3200B	J3210	13/64"	15/64"	3"
	J3215	7/32"	1/4"	3"
	J3220	9/32"	5/16"	3-1/2"
	J3225	11/32"	3/8"	3-3/4"
	J235	Midget Angle Nose Pliers		

This set is packaged in a standard shipping box, not in a tool roll as pictured.

SET NO. J3200D - 9 PC. IGNITION SET

- Satin finish provides corrosion resistance and a slip resistant grip.
- 15° and 60° angle heads combined with the same opening size on both ends allow the wrench to be used in four different turning angles.
- Standard open end wrench configuration.
- Weight: .47 lbs.



Product ID No.	Contents	15°	60°	Length
J3200D	J3210	13/64"	15/64"	3"
	J3211	15/64"	13/64"	3"
	J3215	7/32"	1/4"	3"
	J3216	1/4"	7/32"	3"
	J3220	9/32"	5/16"	3-1/2"
	J3221	5/16"	9/32"	3-1/2"
	J3225	11/32"	3/8"	3-3/4"
	J3226	3/8"	11/32"	3-3/4"
	J235	Midget Angle Nose Pliers		
	J25TR09C	Tool Roll		

IGNITION POINT FILE

- Tungsten file for spark plugs, distributors and other electrical contact points.
- Has chisel tip and smooth extended grip.

Product ID No.	Length	Weight lbs.
J2302	5-1/4"	.01



MIDGET ANGLE NOSE PLIERS

- Nose angled for easy access.
- Angled teeth provide superior gripping power over standard right angled teeth.
- Plastisol grips for added comfort.

Product ID No.	L	A	B	C	Weight lbs.
J235	4-1/16"	3/4"	5/8"	11/64"	.10

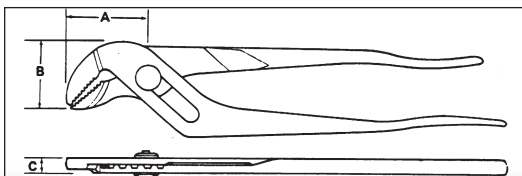



GASKET SCRAPER AND CARBON SCRAPER

- Ideal for removing gaskets and carbon.
- Comfortable, four sided handle.

Product ID No.	Blade Width	Length In	Weight lbs.
J2336	1-1/2"	12"	.30



GASKET AND CARBON SCRAPER

- Narrow, angled blade for access into tight areas.
- Ideal for removing gaskets and carbon.
- Comfortable, four sided handle.

Product ID No.	Blade Width	Length	Weight lbs.
J2338	1-1/16"	11"	.38

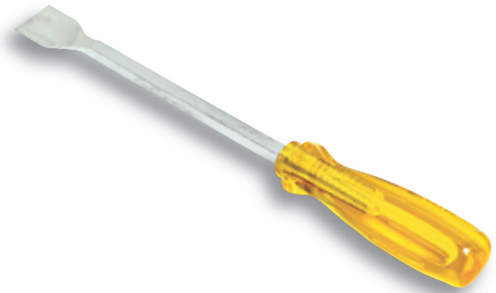

FLEXIBLE CARBON SCRAPER

- Excellent for removing carbon from contoured or flat surfaces.
- Flexibility of ten individual spring steel blades is regulated with sliding steel band.
- Weight: .30

Product ID No.	Blade Width	Blade Length	Weight lbs.
J2337	7/8"	9"	.30



COTTER PIN PULLER

- Precision formed curves provide excellent leverage in prying out cotter pins quickly and easily.
- Large plastic handle.

Product ID No.	Blade Length	Weight lbs.
J2306	7-3/4"	.25



PISTON RING COMPRESSOR

- Wide band has ratchet mechanism to prevent breakage and slippage.
- Includes ell handle.

Product ID No.	Bland Width	Diameter Range	Weight lbs.
J2316	3-1/2"	2-1/8" to 5"	.70



BATTERY POST AND TERMINAL CLEANER

Product ID No.	Length	Weight lbs.
J2320	3-15/16"	0.14 lbs.



BATTERY TERMINAL SPREADER AND REAMER

- Plastisol grips for added comfort.

Product ID No.	Length	Weight lbs.
J319	7-1/2"	.55



BRAKE ADJUSTING TOOL

Product ID No.	Length	Weight lbs.
J2006	6-19/32"	0.27 lbs.





OIL FILTER WRENCH

- Handle swivels to avoid obstructions.
- Stainless steel band for added strength.

Product ID No.	Diameter Capacity	Length	Weight lbs.
J3006	3-1/2" to 3-7/8"	8-1/2"	.81
J3007	2-7/8" to 3-1/4"	8"	.81
J3008	4-1/8" to 4-1/2"	9-1/2"	.88



FLEXIBLE RETRIEVING AND HOLDING TOOLS

- Designed to position or retrieve small objects.
- Spring loaded plunger actuates jaws at end of flexible casing.

Product ID No.	Length	Weight lbs.
J2344	13-1/2"	.19
J2345	23-1/2"	.26



POCKET MAGNETIC RETRIEVING TOOL

- Versatile telescoping handle and all-angle ball joint.

Product ID No.	Length	Weight lbs.
J2375	16-3/4" to 26-3/4"	.40



POCKET MAGNETIC RETRIEVING TOOL

- Aluminum head that contains a neodymium magnet.
- All angle ball joint.
- Magnet can lift up to 1-1/2 lbs.
- Pocket clip.

Product ID No.	Length	Weight lbs.
J2376A	8"	0.08 lbs.

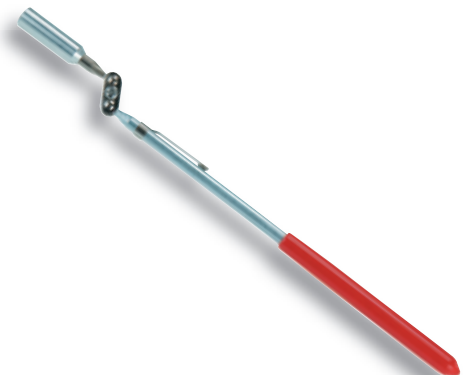

FLEXIBLE MAGNETIC RETRIEVING TOOLS

- Retrieves small objects from hard to reach places.
- Push button allows reaching an object before energizing the magnet.

Product		Weight	
ID No.	Strength	Length	lbs.
J2377	1.5 lbs.	19-1/2"	.27
J2378	3.0 lbs.	24-1/2"	.37



CIRCULAR INSPECTION MIRROR

- Versatile all-angle ball joint.

Product		Weight	
ID No.	Mirror Size	Length	lbs.
J2370	7/8" Dia.	7-1/2"	.08
J2374	1-1/4" Dia.	8"	.09



OVAL INSPECTION MIRROR

- Versatile all-angle ball joint.

Product		Weight	
ID No.	Mirror Size	Length	lbs.
J2371	1" x 2"	8-3/4"	.08



TELESCOPIC CIRCULAR INSPECTION MIRROR

- Versatile all-angle ball joint.
- Features telescoping handle.

Product		Weight	
ID No.	Mirror Size	Length	lbs.
J2372	2-1/4" Dia.	10" to 14"	.25

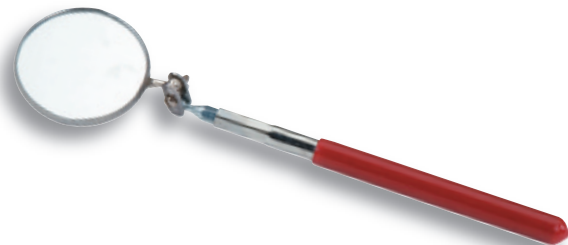



TELESCOPIC RECTANGULAR INSPECTION MIRROR

- Versatile all-angle ball joint.
- Features telescoping handle.
- With pocket clip.

Product ID No.	Mirror Size	Length	Weight lbs.
J2373	2-1/8" x 3-1/2"	11-1/4" to 15-1/2"	.30

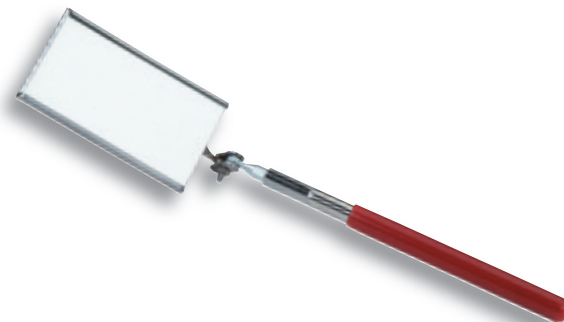

BRAKE PLIERS - ALL-PURPOSE

- Easily installs and removes brake shoe retaining spring on drum brakes.
- Socket end removes spring from anchor stud.
- Notched and installs spring on anchor.

Product ID No.	Length	Weight lbs.
J217	12-7/8"	1.05



HOSE CLAMP PLIERS

- Installs and removes wire spring tension clamps.
- Two position jaws grip full range of clamp sizes.
- Plastisol grips for added comfort.

Product ID No.	Length	Weight lbs.
J252G	7-3/4"	.56

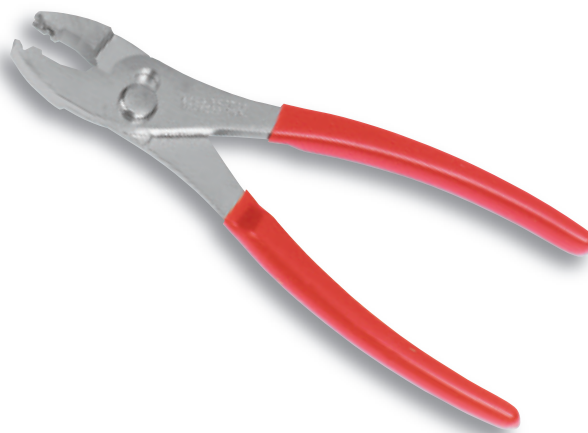

SET NO. J7099A - 3/8" DRIVE 13 PC. HAND IMPACT DRIVER SET

- Designed to loosen hard to turn bolts and nuts.
- Hand Impact Driver has heavy-duty spring for added torque.
- Popular interchangeable bits are packaged in plastic blow molded box for easy storage.
- Weight: 2.36 lbs.



Product ID No.	Contents	Description	Length
J7099A	J7099	Driver Hand Impact 3/8" Dr.	5-1/2"
	J60002	Bit Insert 1 Phillips® 1/4" Hex	1"
	J60008	Bit Insert 2 Phillips® 1/4" Hex	1"
	J60020	Bit Insert 3 Phillips® 1/4" Hex	1"
	J60202	Bit Insert 4F-5R Slot 1/4" Hex	1"
	J60208	Bit Insert 10F-12R Slot 1/4" Hex	1"
	J60050	Bit Insert 1 Phillips® 5/16" Hex	1-1/4"
	J60052	Bit Insert 2 Phillips® 5/16" Hex	1-1/4"
	J60054	Bit Insert 3 Phillips® 5/16" Hex	1-1/4"
	J60256	Bit Insert 10F-12R Slot 5/16"	1-1/2"
	J60262	Bit Insert 14F-16R Slot 5/16" Hex	1-1/2"
	J6930	Bit Holder Power 3/8" Dr. 5/16"	1-5/16"
	J6931	Bit Holder	1-1/4"

3/8" DRIVE SPARK PLUG SOCKETS - 6 POINT

- With rubber insert.

Product ID No.	in.	L	Width	Weight lbs.
J5020-50	5/8"	2-1/2"	0.19	0.21 lbs.
J5026HPA	13/16"	2-1/2"	0.30	0.35 lbs.



3/8" DRIVE UNIVERSAL SPARK PLUG SOCKETS - 6 POINTS

- With rubber insert.

Product ID No.	in.	B	C	D	L	Weight lbs.
J5020-70	5/8"	27/32"	27/32"	3/8"	3-1/2"	0.26 lbs.
J5026-50	13/16"	1-1/16"	23/32"	1/4"	3-3/8"	0.34 lbs.

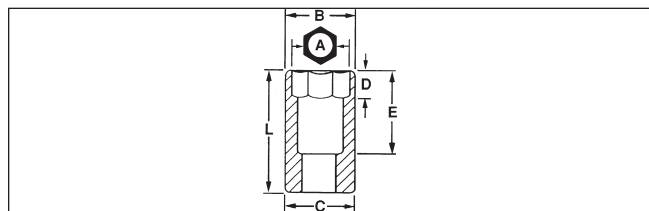
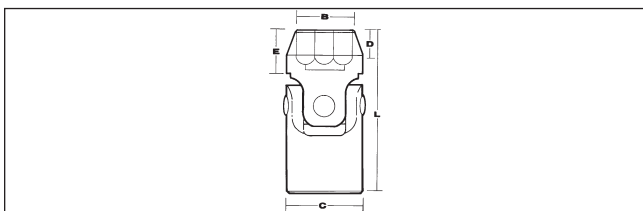



FACOM® STUD EXTRACTORS EXTERNAL CAM / KNURL TYPE

- Turn extractor with a ratchet, wrench or socket to engage the cam and stud, then pull out stud.
- 1/2" and 1/4" drive capacity.
- Knurled wheel grips stud when pressure is applied.
- Hex drive can be driven with wrench or ratcheting tool.
- Ideal for bolts with rusted, corroded or stripped threads.
- Heavy duty finish.



Product ID No.	Length In	Weight lbs.
FA-286A	2-5/32"	0.86
FA-286.PL	2-15/16"	2.11

SET NO. FA-287B.JS5 - FACOM® 5 PC. STUD EXTRACTOR ROLLER SET

- 5 Stud drivers for sizes M6, M7, M8, M9 and M10.
- Supplied in a CKS rack.
- Weight: 2.58 lbs.



Product ID No.	Contents	Capacity	Capacity mm	Length	Weight lbs.
FA-287B.JS5	FA-287B.6	13/32"	6	2-3/4"	0.38
	FA-287B.7	15/32"	7	2-3/4"	0.38
	FA-287B.8	9/16"	8	2-3/4"	0.38
	FA-287B.9	5/8"	9	3-5/32"	0.56
	FA-287B.10	1/4"	10	3-5/32"	0.55

FACOM® STUD EXTRACTORS INTERNAL CAM / ROLLER TYPE

- Designed to grip studs using cam assemblies.
- Capacity ranging from 6-16mm.
- 1/2" drive.
- Full polish finish.



Product ID No.	Capacity [In]	Capacity [mm]	Length In	Weight lbs.
FA-287B.6	13/32"	6	2-3/4"	0.38
FA-287B.7	15/32"	7	2-3/4"	0.38
FA-287B.8	9/16"	8	2-3/4"	0.38
FA-287B.9	5/8"	9	3-5/32"	0.56
FA-287B.10	1/4"	10	3-5/32"	0.55
FA-287B.12	9/32"	7	3-5/32"	0.53
FA-287B.14	5/16"	8	2-15/16"	0.76
FA-287B.16	11/32"	9	2-15/16"	0.69

SET NO. FA-289 - FACOM® 3 PC. NUT SPLITTER

- Supplied in a plastic tray.
- Weight: 1.19 lbs.

Product ID No.	Contents	Item Description	Length
FA-289	FA-289.19	Nut Splitter 19mm	4-11/32"
	FA-289.30	Nut Splitter 30mm	4-29/32"
	FA-289.V1	Spare Screw	3-15/16"



FACOM® NUT SPLITTERS

- Removes frozen, corroded or rusted nuts.
- 4 parts to choose from with nut capacity ranging from 2mm minimum to 46mm maximum across flats.
- Will not damage bolt threads.
- 3 Replacement chisel point screws available.



Product ID No.	External Diameter	Internal Diameter	Length	Maximum Screw Size	Minimum Screw Size	Weight lbs.
FA-289.19	1-1/4"	3/4"	4-11/32"	8	2	0.59
FA-289.30	1-31/32"	1-1/8"	4-29/32"	16	10	0.71
FA-289.36	2-7/16"	1-7/16"	8-1/16"	20	16	2.5
FA-289.54	3-1/2"	1-31/32"	9-9/32"	30	20	6.14

FACOM® NUT SPLITTERS - SPARE SCREWS

Product ID No.	Length	Weight lbs.
FA-289.V1	3-15/16"	0.24
FA-289.V2	6-1/2"	0.84
FA-289.V3	7-15/32"	1.77

COMPRESSION TESTER

- Hold in type for quick accurate compression readings.
- Dual scale indicates both psi and metric values (0 - 300 psi, 0 to 20 kg/cm²).
- Weight: 1.2 lbs.

Product ID No.	Length	Weight lbs.
JCT21	6-1/2"	1.2 lbs.





COMPRESSION GAUGE PARTS FOR JCT21

Product ID No.	Description	Length	Weight lbs.
JCTG1	Gauge Compression 2-1/2"	3-1/2"	0.39 lbs.
JCT21-8	Rubber Compression Cone	1-1/2"	0.03 lbs.
JCT21RK	Compression Tester Repair Kit	7-3/16"	0.29 lbs.

COMPRESSION TESTER

- Includes compression gauge, O-ring, compression gauge and instructional pamphlet.
- Flexible hose and quick-disconnect coupler permit fast, easy engagement of threaded fitting into spark plug hole.
- Gauge has convenient side release valve and dual reading scale for both psi and metric values (0 to 300 psi, 0 to 20 kg/cm²).
- Equipped with neoprene "O" rings for positive finger-tight seal.
- Includes adapters for regular 18mm spark plugs and for regular and long 14mm spark plugs.



Product ID No.	Description	Length	Weight lbs.
JCTR10	Compression Tester	10-29/32"	1.08 lbs.

COMPRESSION GAUGES PARTS FOR JCTR10

Product ID No.	Item Description	Length	Weight lbs.
JCTR10-7A	O Ring	7/16"	0.01 lbs.
JCTG1	Gauge Compression 2-1/2"	3-1/2"	0.39 lbs.
JCTR10RK	Compression Tester Repair Kit	22-5/16"	0.8 lbs.



COMPRESSION TESTER

- Includes compression gauge, O-ring, compression gauge and instructional pamphlet.

Product ID No.	Item Description	Length	Weight lbs.
JCTR20	Compression Tester	11-29/32"	1.06 lbs.



COMPRESSION GAUGE PARTS FOR JCTR20

Product ID No.	Item Description	Length	Weight lbs.
JCTR20-4C	Gauge Compression 2/Side	2-5/16"	0.35 lbs.
JCTR20RK	Compression Tester Repair Kit	9-11/2"	0.48 lbs.



FACOM® MONKEY WRENCHES

- Sturdy, wide-opening tools for heavyduty work on farms and building sites.
- Body and gear in hardened steel.



Product ID No.	Size	Length	Jaw Depth	Jaw Thickness	Weight lbs.
FA-105.230	2-3/8"	9-1/16"	1-25/32"	25/32"	1.15 lbs.
FA-105.280	2-3/4"	11-1/2"	1-11/32"	21/32"	1.79 lbs.
FA-105.375	3-1/8"	14-23/32"	1-25/32"	7/8"	3.36 lbs.

SET NO. J9500B - 10 PC. SCREW EXTRACTOR SET

- Weight: 4.5 lbs.

Product ID No.	Contents	Description	Length
J9500B	J9521	1/8"	2-5/16"
	J9522	3/16"	2-5/8"
	J9523	7/32"	2-7/8"
	J9524	5/16"	3"
	J9525	3/8"	3-1/4"
	J9525B	15/32"	3-7/8"
	J9526	9/16"	4-1/5"
	J9527	21/32"	4-7/8"
	J9528	13/16"	5-3/8"
	J9529	1-1/16"	5-1/2"



SET NO. J9500A - 5 PC. SCREW EXTRACTOR SET

- Weight: 0.28 lbs.

Product ID No.	Contents	Description	Length
J9500A	J9521	1/8"	2-5/16"
	J9522	3/16"	2-5/8"
	J9523	7/32"	2-7/8"
	J9524	5/16"	3"
	J9525	3/8"	3-1/4"
J25TR49C	Tool Roll 5 Pockets		6-3/32"





SCREW EXTRACTORS

- Drive into end of broken pipe or fitting.
- Use tap holder or wrench on extractor to turn out broken part.
- Size stamped on extractor refers to drill bit size to be used with that extractor.



Product ID No.	U.S.S.	D	A	B	L	Weight lbs.
J9521	1/4", 5/16"	1/8"	1/8"	3/16"	2-5/16"	0.02
J9522	3/8"	3/16"	11/64"	3/16"	2-5/8"	0.02
J9523	7/16"	7/32"	13/64"	1/4"	2-7/8"	0.05
J9524	1/2", 9/16"	5/16"	19/64"	5/16"	3"	0.07
J9525	5/8"	3/8"	11/32"	3/8"	3-1/4"	0.12
J9525B	3/4"	15/32"	1/8"	1/8"	3-7/8"	0.18
J9526	7/8"	9/16"	1/2"	1/2"	4-1/5"	0.29
J9527	1", 1 1/8"	21/32"	19/32"	5/8"	4-7/8"	0.47
J9528	1-1/4", 1-3/8"	13/16"	23/32"	3/4"	5-3/8"	0.72
J9529	1-1/2"	1-1/16"	31/32"	1"	5-1/2"	1.30

SET NO. J69X00 - 10 PC. BOLT EXTRACTOR SOCKET SET

- Proto® Bolt Extractor Sockets make it easy to remove rusted, rounded or damaged nuts and bolts.
- The working end has 18 - 30 teeth in a hexagonal configuration to help grip rounded hexagonal fasteners, round head bolts and pan head screws.
- Low profile design helps gain access to fasteners in tight spaces.
- The non-working hex-shaped end can be turned with wrenches or sockets.
- Proto® Bolt Extractor Sockets can be used in combination with other drive tools (such as extensions, universal joints or ratchets with short arc swings) to help reach fasteners in difficult locations.
- Through-hole design helps gain access to fasteners at the end of long bolts or studs.
- Can be used on SAE or metric fasteners.
- Sets provided in mar-resistant tool holders.
- Weight: 0.87 lbs.

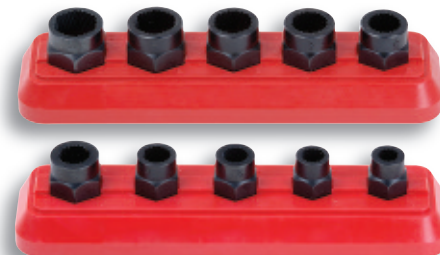

Product ID No.	Contents	Description
J69X00	J69X09	Xtr Skt 7mm 1/4", 9/32"
	J69X10	Xxt Skt 8mm 5/16"
	J69X11	Xtr Skt 9mm 11/32"
	J69X12	Xtr Skt 3/8"
	J69X13	Xtr Skt 10mm
	J69X14	Xtr Skt 11mm 7/16"
	J69X15	Xtr Skt 12mm
	J69X16	Xtra Skt 13mm 1/2"
	J69X18	Xtr Skt 14mm 9/16"
	J69X20	Xtr Skt 15mm 16mm 5/8"

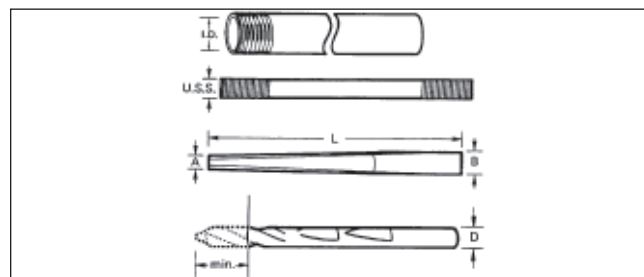

SET NO. J69X01- 5 PC. BOLT EXTRACTOR SOCKET SET

- Proto® Bolt Extractor Sockets make it easy to remove rusted, rounded or damaged nuts and bolts.
- The working end has 18 - 30 teeth in a hexagonal configuration to help grip rounded hexagonal fasteners, round head bolts and pan head screws.
- Low profile design helps gain access to fasteners in tight spaces.
- The non-working hex-shaped end can be turned with wrenches or sockets.
- Proto® Bolt Extractor Sockets can be used in combination with other drive tools (such as extensions, universal joints or ratchets with short arc swings) to help reach fasteners in difficult locations.
- Through-hole design helps gain access to fasteners at the end of long bolts or studs.
- Can be used on SAE or metric fasteners.
- Sets provided in mar-resistant tool holders.
- Weight: 0.40 lbs.



Product

ID No.	Contents	Description
J69X01	J69X09	Xtr Skt 7mm 1/4", 9/32"
	J69X10	Xxt Skt 8mm 5/16"
	J69X11	Xtr Skt 9mm 11/32"
	J69X12	Xtr Skt 3/8"
	J69X13	Xtr Skt 10mm

SET NO. J69X02 - 5 PC. BOLT EXTRACTOR SOCKET SET

- Proto® Bolt Extractor Sockets make it easy to remove rusted, rounded or damaged nuts and bolts.
- The working end has 18 - 30 teeth in a hexagonal configuration to help grip rounded hexagonal fasteners, round head bolts and pan head screws.
- Low profile design helps gain access to fasteners in tight spaces.
- The non-working hex-shaped end can be turned with wrenches or sockets.
- Proto® Bolt Extractor Sockets can be used in combination with other drive tools (such as extensions, universal joints or ratchets with short arc swings) to help reach fasteners in difficult locations.
- Through-hole design helps gain access to fasteners at the end of long bolts or studs.
- Can be used on SAE or metric fasteners.
- Sets provided in mar-resistant tool holders.
- Weight: 0.49 lbs.



Product

ID No.	Contents	Description
J69X02	J69X14	Xtr Skt 11mm 7/16"
	J69X15	Xtr Skt 12mm
	J69X16	Xtra Skt 13mm 1/2"
	J69X18	Xtr Skt 14mm 9/16"
	J69X20	Xtr Skt 15mm 16mm 5/8"



BOLT EXTRACTOR SOCKETS

- Proto® Bolt Extractor Sockets make it easy to remove rusted, rounded or damaged nuts and bolts.
- The working end has 18 - 30 teeth in a hexagonal configuration to help grip rounded hexagonal fasteners, round head bolts and pan head screws.
- Low profile design helps gain access to fasteners in tight spaces.
- The non-working hex-shaped end can be turned with wrenches or sockets.
- Proto® Bolt Extractor Sockets can be used in combination with other drive tools (such as extensions, universal joints or ratchets with short arc swings) to help reach fasteners in difficult locations.
- Through-hole design helps gain access to fasteners at the end of long bolts or studs.
- Can be used on SAE or metric fasteners.

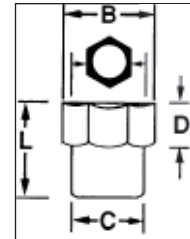

Product ID No.	Approximate Bolt Size	Size (mm)	B inches	C inches	D inches	L inches	Weight lbs.
J69X09	1/4", 9/32"	7mm	9/16"	5/8"	7/16"	3/4"	0.05 lbs.
J69X10	5/16"	8mm	9/16"	5/8"	7/16"	3/4"	0.04 lbs.
J69X11	11/32"	9mm	5/8"	11/16"	7/16"	3/4"	0.06 lbs.
J69X12	3/8"	-	5/8"	11/16"	7/16"	3/4"	0.05 lbs.
J69X13	13/32"	10mm	3/4"	13/16"	7/16"	3/4"	0.08 lbs.
J69X14	7/16"	11mm	3/4"	13/16"	7/16"	3/4"	0.07 lbs.
J69X15	15/32"	12mm	7/8"	7/8"	7/16"	3/4"	0.08 lbs.
J69X16	1/2"	13mm	7/8"	7/8"	7/16"	3/4"	0.08 lbs.
J69X18	9/16"	14mm	29/32"	15/16"	7/16"	3/4"	0.09 lbs.
J69X20	5/8"	15mm, 16mm	29/32"	15/16"	7/16"	3/4"	0.08 lbs.



SET NO. J4041 - BATTERY CABLE AND SMALL BEARING PULLER

- Uses toggle-type action to grip onto all standard post battery terminals.
- Pulls small bearings and gears with 1" reach and spread.
- Weight: .65 lbs.



SET NO. J4053 – PULLEY PULLER

- For removing single and two-groove pulleys from alternators and power steering pumps.
- Two position yoke permits pulling bearings on both standard and heavy-duty alternators.
- Weight: 2.10 lbs.

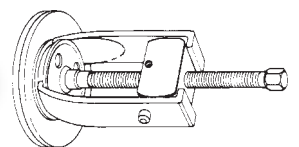

SET NO. J4059 - CLOSE QUARTERS PILOT BEARING PULLER

- Designed to pull flywheel pilot bearings with inside diameters 1/2" to 1-1/2".
- Removes bearings and bushings from starters, generators, magnetos and small electric motors.
- Weight: 2.30 lbs.



SET NO. J4001G – HUB PULLER

- Pulls wheel hubs on cars and light trucks.
- Legs are drilled for 9/16" studs.
- Unit can be used without legs as a cap screw puller with bolts up to 1/2".
- J4001T Steel Storage Box
- Weight: 13.00 lbs.

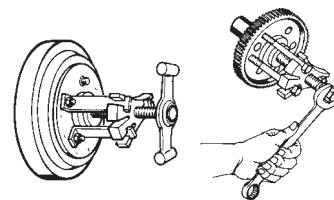

Product

ID No.	Contents	Description	
J4001	J4001B	Hub Crossarm	1
	J4001J	Hub Leg	3
	J4001S	Forcing Screw	1
	J4001ST	Puller Tip	1
	J4001T	Puller Box	1
	J4001W	Striking Wrench	1

SET NO. J5040 - 10-WAY PROTO-EASE™ ADVANTAGE SLIDE HAMMER PULLER SET

- Slide hammer puller set packaged in a convenient plastic blow molded carrying/storage case.
- Weight: 25 lbs.



SET NO. J5049 - REVERSIBLE JAW SLIDE HAMMER PULLER

- Versatile puller which will accomplish many pulling jobs involving gears, bearings, outer races, grease retainers, oil seals, etc.
- Either two or three puller jaws may be used to handle "inside" pulling jobs such as bearing cups and outer racers, as well as regular "outside" pulling jobs.
- The 5 lb. slide hammer can be removed and used independently.
- Weight: 11 lbs.
- Overall Length: 27"



2-Jaw Spread				3-Jaw Spread			
Inside		Outside		Inside		Outside	
Min.	Max.	Min.	Max.	Min.	Max.	Min.	Max.
1-1/4"	3-1/2"	1"	4-1/2"	1-1/2"	4-1/4"	1-1/2"	4-1/2"