

Reel Accessories | Bumpers / Inlet Assemblies

Adjustable Hose Bumpers

Adjustable hose bumpers are solid molded rubber assuring a long life and nonslip grip. Hose bumpers allow the desired length of hose to be permanently stored outside the reel. Hose bumpers are included on the reels purchased with hose. Reels purchased without hose do not include the hose bumper. When ordering, advise the part number, reel model and the hose I.D. and O.D. **NOTE: To order hose bumper with stainless steel hardware, change part number prefix from HR to HS.**

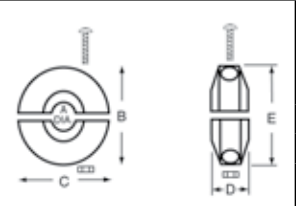

For Reel Series	Part Number	Hose O.D. (dia A)	Hose I.D.	Dia. B-C-E		Dia. D		Weight	
		in (mm)	in mm	in mm	in mm	lbs	kg		
4000 / 5000 / RT400 / 3100 6000 / L4500 / L5000 / DP	1-HR1004-A	.438 (11) - .625 (16)	1/4 6	2 1/2	64	1 1/4	32	.24	.10
4000 / 5000 / D8000 / RT400 RT600 / 6000	1-HR1004	.625 (16) - .749 (19)	3/8 10	2 1/2	64	1 1/4	32	.25	.11
7000 / 80000 / E8000 / 3100 RT800 / 5000 / D80000 / DP	1-HR1004-3	.625 (16) - .749 (19)	3/8 10	3	73	1 1/4	32	.24	.10
5000 / A5005 / 7000 / 80000 D8000 / E8000 / RT800 / DP	2-HR1004-3	.750 (19) - 1.05 (27)	1/2 or 3/8 13 or 10	3	73	1 1/4	32	.23	.10
7000 / 8000 / D8000 / 80000 GC7000 / F7000 / F80000 / L7000 / DGM	3-HR1004-3	1.06 (27) - 1.38 (35)	3/4 19	3	73	1 1/4	32	.32	.14
TW5000 / TW7000 / 3100T TW80000 / TWD80000	8-HR1004-3	.530 (13) twin	1/4 twin 6	3	73	1 1/4	32	.24	.10
TH80000 / TW80000 / 3100T TH7000 / TW8000	600521	.680 (17) twin	3/8 twin 10	3 1/2	89	2	51	.45	.20
3100T / 4800T / TH80000	600522	.810 (21) twin	1/2 twin 13	3 1/2	89	2	51	.49	.22
D9000 / E9000 / 3100 / 4800	2-HR1005	.750 (19) - 1.05 (27)	1/2 13	3 1/2	89	2 7/8	73	.95	.43
D9000 / E9000 / FE9000 / 3100 / 4800 / SD	3-HR1005	1.06 (27) - 1.38 (35)	3/4 19	3 1/2	89	2 7/8	73	.95	.43
D80000 / D8000 / D9000 / E9000 / FD9000 / FE9000 / 3100 / 4800 / SD	4-HR1005	1.39 (35) - 1.55 (39)	1 25	3 1/2	89	2 7/8	73	.81	.36
FE9500 / FF9500 / 4800	S600547-1	1.55 (39) - 1.75 (44)	1 1/4 32	3 3/4	95	2 7/8	73	.70	.31
FE9600 / FF9600 / 4800	S600547-2	1.75 (44) - 2.03 (52)	1 1/2 38	3 3/4	95	2 7/8	73	.57	.25



Inlet Hose Assemblies

A flexible hose connection must be used between the hose reel inlet and the source of supply to prevent possible misalignment and binding or warranty is void. Please furnish the following information when ordering: Part number, product and pressure to be handled. Other sizes available as well. **NOTE:** Swivel fittings are recommended to protect hose during installation.

Part Number	Hose I.D.		Hose O.D.		Length		End Fittings	Pressure		Weight	
	in	mm	in	mm	ft	m	in	psi	bar	lbs	kg
Low Pressure Air and water - PVC nylon braid											
S601024-2	3/8	10	.600	15	2	.61	3/8 x 3/8 NPTF(M)	300	21	.54	.24
S601020-2	1/2	13	.750	19	2	.61	1/2 x 1/2 NPTF(M)	300	21	.70	.32
S601026-2	3/4	19	1.075	27	2	.61	3/4 x 3/4 NPTF(M)	250	17	1.50	.68
S601034-3	3/4	19	1.075	27	3	.91	3/4 x 3/4 NPTF(M)	250	17	1.72	.78
S601026-7	3/4	19	1.075	27	7	2.13	3/4 x 3/4 NPTF(M)	250	17	3.00	1.36
S601027-2	1	27	1.375	35	2	.61	3/4 x 1 NPTF(M)	250	17	1.72	.78
S601027-5	1	27	1.375	35	5	1.52	1 x 1 NPTF(M)	250	17	3.25	1.47
Medium Pressure Oil and petroleum fluids - 100 R1T one wire braid											
S32-260043	3/8	10	.710	18	2	.61	3/8 x 3/8 NPTF(M)	2250	155	1.00	.45
S17-260043	1/2	13	.850	22	2	.61	1/2 x 1/2 NPTF(M)	2000	138	.91	.41
S39-260043	1/2	13	.850	22	5	1.52	1/2 x 1/2 NPTF(M)	2000	138	2.00	.91
High Pressure Chassis grease - 100 R2T two wire braid											
S17-260044	1/4	6	0.580	15	2	.61	1/4 x 1/4 NPTF(M)	5000	345	.75	.34
S14-260044	3/8	10	0.730	19	2	.61	3/8 x 1/2 NPTF(M)	4000	276	.83	.38

