

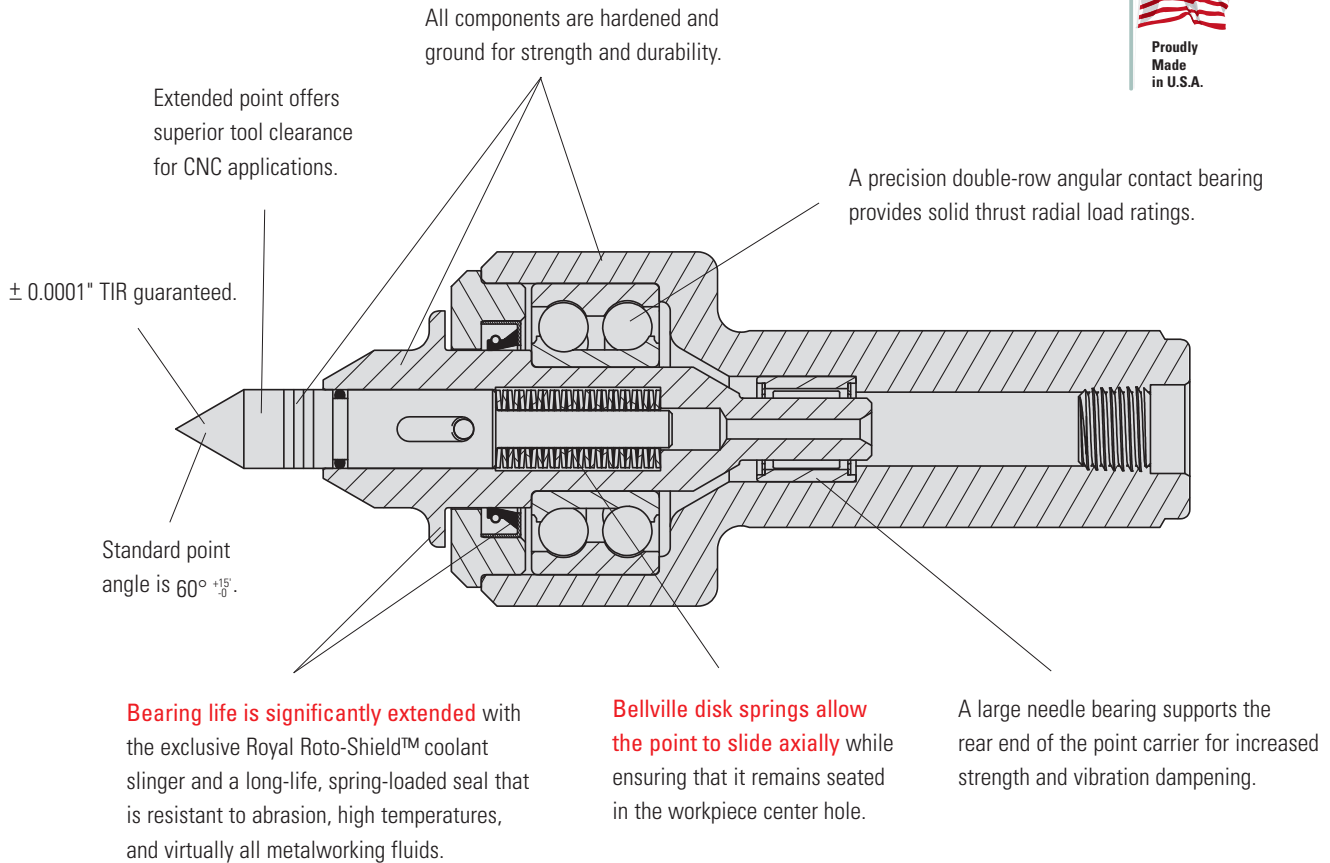

ROYAL ULTIMATE™ MULTI-TASKING LIVE CENTERS



Spring-Loaded Point for Lower Turret and Sub-Spindle Applications

- ❑ Designed specifically for use on the latest multi-tasking **CNC machines with lower turrets and/or sub-spindles.**
- ❑ Spring-loaded point overcomes the lack of hydraulic compensation found on tailstocks, protecting lower turrets and sub-spindles from overloading and/or crashes.
- ❑ Much longer operating life than other spring-type live centers due to the outstanding sealing characteristics of the exclusive Royal Roto-Shield™ coupled with a long-life spring-loaded neoprene seal.
- ❑ Heavy-duty bearing configuration and **optimized spring-pak** make the Royal Ultimate™ the perfect choice for all multi-tasking machines.

ROYAL ULTIMATE™ MULTI-TASKING LIVE CENTERS



Spring-Loaded Point for Lower Turret and Sub-Spindle Applications



**EXCLUSIVE ROYAL
ROTO-SHIELD™
TECHNOLOGY**

**✓ High-Pressure
Coolant Approved**

A graphical representation laser-marked onto the body of each Ultimate™ Multi-Tasking Live Center takes the guesswork out of the setup process by clearly identifying optimal working parameters.

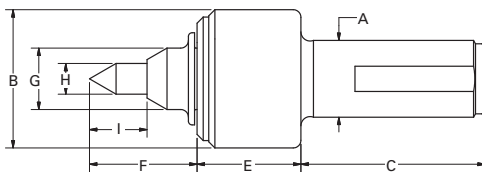

SPRING PRESSURE	MAX WORKPIECE WEIGHT	
	lbs (kgs)	lbs (kgs)
206 (93)	355 (161)	
159 (72)	275 (125)	
110 (50)	190 (86)	
58 (26)	100 (45)	

The Royal Ultimate™ Multi-Tasking Live Center

A SHANK STYLE	B	C	E	F	G	H	I	SPRING TRAVEL	MAX. SUGGESTED RPM ¹	WEIGHT OF WORKPIECE (lbs.)	THRUST LOAD (lbs.) ²	PART NUMBER	PRICE
1¼ SS	2.25	3.00	1.69	1.75	1.00	0.50	0.94	0.25	5,000	350	200	10590	\$880
4 MT	2.25	N/A	1.69	1.75	1.00	0.50	0.94	0.25	5,000	350	200	10592	880
5 MT	2.25	N/A	1.69	1.75	1.00	0.50	0.94	0.25	5,000	350	200	10594	923

¹ Maximum recommended operating limit. Operating above this speed could result in heat build-up and accelerated bearing wear.

² Exceeding this value will bottom-out springs.

Insist on Roto-Shield™ Technology – Only Available on Royal Live Centers