

# Slow Spiral Drills

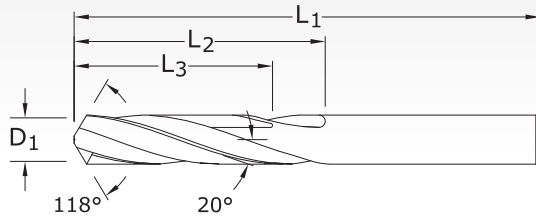

**101**

FRACTIONAL & METRIC SERIES

TECH INFO 178-179

- STEELS
- STAINLESS STEELS
- CAST IRON
- HIGH TEMP ALLOYS
- TITANIUM
- NON-FERROUS
- PLASTICS/COMPOSITES

| CUTTING DIAMETER<br>D <sub>1</sub> | DECIMAL EQUIV. | OVERALL LENGTH<br>L <sub>1</sub> | FLUTE LENGTH<br>L <sub>2</sub> | CLEARED LENGTH<br>L <sub>3</sub> | EDP NO.  |                     |
|------------------------------------|----------------|----------------------------------|--------------------------------|----------------------------------|----------|---------------------|
|                                    |                |                                  |                                |                                  | UNCOATED | Ti-NAMITE-A (AlTiN) |
| #80                                | 0.0135         | 3/4                              | 3/16                           | 5/32                             | 51080    | 57076               |
| #79                                | 0.0145         | 3/4                              | 3/16                           | 5/32                             | 51079    | 57077               |
| 1/64                               | 0.0156         | 3/4                              | 3/16                           | 5/32                             | 51101    | 57078               |
| #78                                | 0.0160         | 3/4                              | 3/16                           | 5/32                             | 51078    | 57079               |
| #77                                | 0.0180         | 3/4                              | 3/16                           | 5/32                             | 51077    | 57080               |
| #76                                | 0.0200         | 7/8                              | 1/4                            | 13/64                            | 51076    | 57081               |
| #75                                | 0.0210         | 7/8                              | 1/4                            | 13/64                            | 51075    | 57082               |
| #74                                | 0.0225         | 7/8                              | 1/4                            | 13/64                            | 51074    | 57083               |
| #73                                | 0.0240         | 7/8                              | 1/4                            | 13/64                            | 51073    | 57084               |
| #72                                | 0.0250         | 1                                | 5/16                           | 1/4                              | 51072    | 57085               |
| #71                                | 0.0260         | 1                                | 5/16                           | 1/4                              | 51071    | 57086               |
| 0,7 mm                             | 0.0276         | 28,0                             | 9,0                            | 7,0                              | 61001    | 68268               |
| #70                                | 0.0280         | 1-1/4                            | 1/2                            | 13/32                            | 51070    | 57087               |
| #69                                | 0.0292         | 1-1/4                            | 1/2                            | 13/32                            | 51069    | 57088               |
| #68                                | 0.0310         | 1-1/4                            | 1/2                            | 13/32                            | 51068    | 57089               |
| 1/32                               | 0.0312         | 1-1/4                            | 1/2                            | 13/32                            | 51102    | 57090               |
| 0,8 mm                             | 0.0315         | 30,0                             | 10,0                           | 8,0                              | 61003    | 68269               |
| #67                                | 0.0320         | 1-1/4                            | 1/2                            | 13/32                            | 51067    | 57091               |
| #66                                | 0.0330         | 1-1/4                            | 1/2                            | 13/32                            | 51066    | 57092               |
| #65                                | 0.0350         | 1-3/8                            | 5/8                            | 1/2                              | 51065    | 57093               |
| 0,9 mm                             | 0.0354         | 32,0                             | 11,0                           | 8,0                              | 61005    | 68270               |
| #64                                | 0.0360         | 1-3/8                            | 5/8                            | 1/2                              | 51064    | 57094               |
| #63                                | 0.0370         | 1-3/8                            | 5/8                            | 1/2                              | 51063    | 57095               |
| #62                                | 0.0380         | 1-3/8                            | 5/8                            | 1/2                              | 51062    | 57096               |
| #61                                | 0.0390         | 1-3/8                            | 5/8                            | 1/2                              | 51061    | 57097               |
| 1,0 mm                             | 0.0394         | 34,0                             | 12,0                           | 9,0                              | 61007    | 68271               |
| #60                                | 0.0400         | 1-1/2                            | 3/4                            | 39/64                            | 51060    | 57098               |
| #59                                | 0.0410         | 1-1/2                            | 3/4                            | 39/64                            | 51059    | 57099               |
| #58                                | 0.0420         | 1-1/2                            | 3/4                            | 39/64                            | 51058    | 57100               |
| #57                                | 0.0430         | 1-1/2                            | 3/4                            | 39/64                            | 51057    | 57101               |
| 1,1 mm                             | 0.0433         | 36,0                             | 14,0                           | 11,0                             | 61052    | 68294               |
| #56                                | 0.0465         | 1-1/2                            | 3/4                            | 39/64                            | 51056    | 57102               |
| 3/64                               | 0.0469         | 1-1/2                            | 3/4                            | 39/64                            | 51103    | 57103               |
| 1,2 mm                             | 0.0472         | 38,0                             | 16,0                           | 12,0                             | 61053    | 68295               |
| 1,3 mm                             | 0.0512         | 38,0                             | 16,0                           | 12,0                             | 61054    | 68296               |
| #55                                | 0.0520         | 1-1/2                            | 3/4                            | 39/64                            | 51055    | 57104               |
| #54                                | 0.0550         | 1-1/2                            | 3/4                            | 39/64                            | 51054    | 57105               |
| 1,4 mm                             | 0.0551         | 40,0                             | 18,0                           | 14,0                             | 61055    | 68297               |

continued on next page

TOLERANCES (inch)

D<sub>1</sub> = +.0000/-0.0005

TOLERANCES (mm)

D<sub>1</sub> = +0,0000/-0,0127



# Slow Spiral Drills



## 101

FRACTIONAL & METRIC SERIES

CONTINUED

| CUTTING DIAMETER<br>D <sub>1</sub> | DECIMAL EQUIV. | OVERALL LENGTH<br>L <sub>1</sub> | FLUTE LENGTH<br>L <sub>2</sub> | CLEARED LENGTH<br>L <sub>3</sub> | EDP NO.  |                     |
|------------------------------------|----------------|----------------------------------|--------------------------------|----------------------------------|----------|---------------------|
|                                    |                |                                  |                                |                                  | UNCOATED | Ti-NAMITE-A (AITIN) |
| 1,5 mm                             | 0.0591         | 40,0                             | 18,0                           | 14,0                             | 61009    | 68272               |
| #53                                | 0.0595         | 1-1/2                            | 3/4                            | 39/64                            | 51053    | 57106               |
| *1/16                              | 0.0625         | 1-1/2                            | 3/4                            | 39/64                            | 51104    | 57107               |
| 1,6 mm                             | 0.0630         | 43,0                             | 20,0                           | 16,0                             | 61056    | 68298               |
| #52                                | 0.0635         | 1-1/2                            | 3/4                            | 39/64                            | 51052    | 57108               |
| 1,7 mm                             | 0.0669         | 43,0                             | 20,0                           | 17,0                             | 61057    | 68299               |
| #51                                | 0.0670         | 1-1/2                            | 3/4                            | 39/64                            | 51051    | 57109               |
| #50                                | 0.0700         | 1-3/4                            | 7/8                            | 45/64                            | 51050    | 57110               |
| 1,8 mm                             | 0.0709         | 46,0                             | 22,0                           | 17,0                             | 61058    | 68300               |
| #49                                | 0.0730         | 1-3/4                            | 7/8                            | 45/64                            | 51049    | 57111               |
| 1,9 mm                             | 0.0748         | 46,0                             | 22,0                           | 17,0                             | 61059    | 68301               |
| #48                                | 0.0760         | 1-3/4                            | 7/8                            | 45/64                            | 51048    | 57112               |
| 5/64                               | 0.0781         | 1-3/4                            | 7/8                            | 45/64                            | 51105    | 57113               |
| #47                                | 0.0785         | 1-3/4                            | 7/8                            | 45/64                            | 51047    | 57114               |
| 2,0 mm                             | 0.0787         | 49,0                             | 24,0                           | 19,0                             | 61011    | 68273               |
| #46                                | 0.0810         | 1-3/4                            | 7/8                            | 45/64                            | 51046    | 57115               |
| #45                                | 0.0820         | 1-3/4                            | 7/8                            | 45/64                            | 51045    | 57116               |
| 2,1 mm                             | 0.0827         | 49,0                             | 24,0                           | 19,0                             | 61060    | 68302               |
| #44                                | 0.0860         | 2                                | 1                              | 51/64                            | 51044    | 57117               |
| 2,2 mm                             | 0.0866         | 53,0                             | 27,0                           | 21,0                             | 61061    | 68303               |
| #43                                | 0.0890         | 2                                | 1                              | 51/64                            | 51043    | 57118               |
| 2,3 mm                             | 0.0906         | 53,0                             | 27,0                           | 21,0                             | 61062    | 68304               |
| #42                                | 0.0935         | 2                                | 1                              | 51/64                            | 51042    | 57119               |
| 3/32 mm                            | 0.0938         | 2                                | 1                              | 51/64                            | 51106    | 57120               |
| 2,4 mm                             | 0.0945         | 57,0                             | 30,0                           | 24,0                             | 61063    | 68305               |
| #41                                | 0.0960         | 2                                | 1                              | 51/64                            | 51041    | 57121               |
| #40                                | 0.0980         | 2                                | 1                              | 51/64                            | 51040    | 57122               |
| 2,5 mm                             | 0.0984         | 57,0                             | 30,0                           | 24,0                             | 61013    | 68274               |
| #39                                | 0.0995         | 2-1/4                            | 1-1/4                          | 1                                | 51039    | 57123               |
| #38                                | 0.1015         | 2-1/4                            | 1-1/4                          | 1                                | 51038    | 57124               |
| 2,6 mm                             | 0.1024         | 57,0                             | 30,0                           | 24,0                             | 61064    | 68306               |
| #37                                | 0.1040         | 2-1/4                            | 1-1/4                          | 1                                | 51037    | 57125               |
| 2,7 mm                             | 0.1063         | 61,0                             | 33,0                           | 26,0                             | 61065    | 68307               |
| #36                                | 0.1065         | 2-1/4                            | 1-1/4                          | 1                                | 51036    | 57126               |
| 7/64                               | 0.1094         | 2-1/4                            | 1-1/4                          | 1                                | 51107    | 57127               |
| #35                                | 0.1100         | 2-1/4                            | 1-1/4                          | 1                                | 51035    | 57128               |
| 2,8 mm                             | 0.1102         | 61,0                             | 33,0                           | 26,0                             | 61066    | 68308               |
| #34                                | 0.1110         | 2-1/4                            | 1-1/4                          | 1                                | 51034    | 57129               |
| #33                                | 0.1130         | 2-1/4                            | 1-1/4                          | 1                                | 51033    | 57130               |
| 2,9 mm                             | 0.1142         | 61,0                             | 33,0                           | 26,0                             | 61067    | 68309               |
| #32                                | 0.1160         | 2-1/4                            | 1-1/4                          | 1                                | 51032    | 57131               |
| 3,0 mm                             | 0.1181         | 61,0                             | 33,0                           | 26,0                             | 61015    | 68275               |
| #31                                | 0.1200         | 2-1/4                            | 1-1/4                          | 1                                | 51031    | 57132               |
| 3,1 mm                             | 0.1220         | 65,0                             | 36,0                           | 28,0                             | 61068    | 68310               |

continued on next page



# Slow Spiral Drills

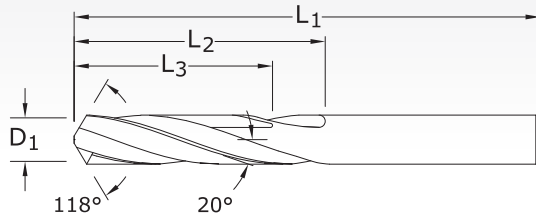

**101**

FRACTIONAL & METRIC SERIES

TECH INFO 178-179

- STEELS
- STAINLESS STEELS
- CAST IRON
- HIGH TEMP ALLOYS
- TITANIUM
- NON-FERROUS
- PLASTICS/COMPOSITES

| CUTTING DIAMETER<br>D <sub>1</sub> | DECIMAL EQUIV. | OVERALL LENGTH<br>L <sub>1</sub> | FLUTE LENGTH<br>L <sub>2</sub> | CLEARED LENGTH<br>L <sub>3</sub> | EDP NO.  |                     |
|------------------------------------|----------------|----------------------------------|--------------------------------|----------------------------------|----------|---------------------|
|                                    |                |                                  |                                |                                  | UNCOATED | Ti-NAMITE-A (AlTiN) |
| *1/8                               | 0.1250         | 2-1/4                            | 1-1/4                          | 1                                | 51108    | 57133               |
| 3,2 mm                             | 0.1260         | 65,0                             | 36,0                           | 28,0                             | 61069    | 68311               |
| #30                                | 0.1285         | 2-1/4                            | 1-1/4                          | 1                                | 51030    | 57134               |
| 3,3 mm                             | 0.1299         | 65,0                             | 36,0                           | 28,0                             | 61070    | 68312               |
| 3,4 mm                             | 0.1339         | 70,0                             | 39,0                           | 31,0                             | 61071    | 68313               |
| #29                                | 0.1360         | 2-1/2                            | 1-3/8                          | 1-7/64                           | 51029    | 57135               |
| 3,5 mm                             | 0.1378         | 70,0                             | 39,0                           | 31,0                             | 61017    | 68276               |
| #28                                | 0.1405         | 2-1/2                            | 1-3/8                          | 1-7/64                           | 51028    | 57136               |
| 9/64                               | 0.1406         | 2-1/2                            | 1-3/8                          | 1-7/64                           | 51109    | 57137               |
| 3,6 mm                             | 0.1417         | 70,0                             | 39,0                           | 31,0                             | 61072    | 68314               |
| #27                                | 0.1440         | 2-1/2                            | 1-3/8                          | 1-7/64                           | 51027    | 57138               |
| 3,7 mm                             | 0.1457         | 70,0                             | 39,0                           | 31,0                             | 61073    | 68315               |
| #26                                | 0.1470         | 2-1/2                            | 1-3/8                          | 1-7/64                           | 51026    | 57139               |
| #25                                | 0.1495         | 2-1/2                            | 1-3/8                          | 1-7/64                           | 51025    | 57140               |
| 3,8 mm                             | 0.1496         | 75,0                             | 43,0                           | 34,0                             | 61074    | 68316               |
| #24                                | 0.1520         | 2-1/2                            | 1-3/8                          | 1-7/64                           | 51024    | 57141               |
| 3,9 mm                             | 0.1535         | 75,0                             | 43,0                           | 34,0                             | 61075    | 68317               |
| #23                                | 0.1540         | 2-1/2                            | 1-3/8                          | 1-7/64                           | 51023    | 57142               |
| 5/32                               | 0.1562         | 2-1/2                            | 1-3/8                          | 1-7/64                           | 51110    | 57143               |
| #22                                | 0.1570         | 2-1/2                            | 1-3/8                          | 1-7/64                           | 51022    | 57144               |
| 4,0 mm                             | 0.1575         | 75,0                             | 43,0                           | 34,0                             | 61019    | 68277               |
| #21                                | 0.1590         | 2-1/2                            | 1-3/8                          | 1-7/64                           | 51021    | 57145               |
| #20                                | 0.1610         | 2-1/2                            | 1-3/8                          | 1-7/64                           | 51020    | 57146               |
| 4,1 mm                             | 0.1614         | 75,0                             | 43,0                           | 34,0                             | 61076    | 68318               |
| 4,2 mm                             | 0.1654         | 75,0                             | 43,0                           | 34,0                             | 61077    | 68319               |
| #19                                | 0.1660         | 2-1/2                            | 1-5/8                          | 1-19/64                          | 51019    | 57147               |
| 4,3 mm                             | 0.1693         | 80,0                             | 47,0                           | 37,0                             | 61078    | 68320               |
| #18                                | 0.1695         | 2-3-4                            | 1-5/8                          | 1-19/64                          | 51018    | 57148               |
| 11/64                              | 0.1719         | 2-3-4                            | 1-5/8                          | 1-19/64                          | 51111    | 57149               |
| #17                                | 0.1730         | 2-3-4                            | 1-5/8                          | 1-19/64                          | 51017    | 57150               |
| 4,4 mm                             | 0.1732         | 80,0                             | 47,0                           | 37,0                             | 61079    | 68321               |
| #16                                | 0.1770         | 2-3-4                            | 1-5/8                          | 1-19/64                          | 51016    | 57151               |
| 4,5 mm                             | 0.1772         | 80,0                             | 47,0                           | 37,0                             | 61021    | 68278               |
| #15                                | 0.1800         | 2-3-4                            | 1-5/8                          | 1-19/64                          | 51015    | 57152               |
| 4,6 mm                             | 0.1811         | 80,0                             | 47,0                           | 37,0                             | 61080    | 68322               |
| #14                                | 0.1820         | 2-3-4                            | 1-5/8                          | 1-19/64                          | 51014    | 57153               |
| 4,7 mm                             | 0.1850         | 80,0                             | 47,0                           | 37,0                             | 61081    | 68323               |
| #13                                | 0.1850         | 2-3-4                            | 1-5/8                          | 1-19/64                          | 51013    | 57154               |

continued on next page

TOLERANCES (inch)

D<sub>1</sub> = +.0000/-0.0005

TOLERANCES (mm)

D<sub>1</sub> = +0,0000/-0,0127



# Slow Spiral Drills



## 101

FRACTIONAL & METRIC SERIES

CONTINUED

| CUTTING DIAMETER<br>D <sub>1</sub> | DECIMAL EQUIV. | OVERALL LENGTH<br>L <sub>1</sub> | FLUTE LENGTH<br>L <sub>2</sub> | CLEARED LENGTH<br>L <sub>3</sub> | EDP NO.  |                     |
|------------------------------------|----------------|----------------------------------|--------------------------------|----------------------------------|----------|---------------------|
|                                    |                |                                  |                                |                                  | UNCOATED | TI-NAMITE-A (AITIN) |
| *3/16                              | 0.1875         | 2-3-4                            | 1-5/8                          | 1-19/64                          | 51112    | 57155               |
| 4,8 mm                             | 0.1890         | 86,0                             | 52,0                           | 41,0                             | 61082    | 68324               |
| #12                                | 0.1890         | 2-3-4                            | 1-5/8                          | 1-19/64                          | 51012    | 57156               |
| #11                                | 0.1910         | 2-3-4                            | 1-5/8                          | 1-19/64                          | 51011    | 57157               |
| 4,9 mm                             | 0.1929         | 86,0                             | 52,0                           | 41,0                             | 61083    | 68325               |
| #10                                | 0.1935         | 2-3-4                            | 1-5/8                          | 1-19/64                          | 51010    | 57158               |
| #9                                 | 0.1960         | 3                                | 1-3/4                          | 1-13/32                          | 51009    | 57159               |
| 5,0 mm                             | 0.1969         | 86,0                             | 52,0                           | 41,0                             | 61023    | 68279               |
| #8                                 | 0.1990         | 3                                | 1-3/4                          | 1-13/32                          | 51008    | 57160               |
| 5,1 mm                             | 0.2008         | 86,0                             | 52,0                           | 41,0                             | 61084    | 68326               |
| #7                                 | 0.2010         | 3                                | 1-3/4                          | 1-13/32                          | 51007    | 57161               |
| 13/64                              | 0.2031         | 3                                | 1-3/4                          | 1-13/32                          | 51113    | 57162               |
| #6                                 | 0.2040         | 3                                | 1-3/4                          | 1-13/32                          | 51006    | 57163               |
| 5,2 mm                             | 0.2047         | 86,0                             | 52,0                           | 41,0                             | 61085    | 68327               |
| #5                                 | 0.2055         | 3                                | 1-3/4                          | 1-13/32                          | 51005    | 57164               |
| 5,3 mm                             | 0.2087         | 86,0                             | 52,0                           | 41,0                             | 61086    | 68328               |
| #4                                 | 0.2090         | 3                                | 1-3/4                          | 1-13/32                          | 51004    | 57165               |
| 5,4 mm                             | 0.2126         | 93,0                             | 57,0                           | 45,0                             | 61087    | 68329               |
| #3                                 | 0.2130         | 3                                | 1-3/4                          | 1-13/32                          | 51003    | 57166               |
| 5,5 mm                             | 0.2165         | 94,5                             | 57,0                           | 1-13/32                          | 61025    | 68280               |
| 7/32                               | 0.2188         | 3                                | 1-3/4                          | 1-13/32                          | 51114    | 57167               |
| 5,6 mm                             | 0.2205         | 93,0                             | 57,0                           | 45,0                             | 61088    | 68330               |
| #2                                 | 0.2210         | 3                                | 1-3/4                          | 1-13/32                          | 51002    | 57168               |
| 5,7 mm                             | 0.2244         | 93,0                             | 57,0                           | 45,0                             | 61089    | 68331               |
| #1                                 | 0.2280         | 3                                | 1-3/4                          | 1-13/32                          | 51001    | 57169               |
| 5,8 mm                             | 0.2283         | 93,0                             | 57,0                           | 45,0                             | 61090    | 68332               |
| 5,9 mm                             | 0.2323         | 93,0                             | 57,0                           | 45,0                             | 61091    | 68333               |
| A                                  | 0.2340         | 3-1/4                            | 2                              | 1-39/64                          | 51201    | 57170               |
| 15/64                              | 0.2344         | 3-1/4                            | 2                              | 1-39/64                          | 51115    | 57171               |
| 6,0 mm                             | 0.2362         | 93,0                             | 57,0                           | 45,0                             | 61027    | 68281               |
| B                                  | 0.2380         | 3-1/4                            | 2                              | 1-39/64                          | 51202    | 57172               |
| 6,1 mm                             | 0.2402         | 101,0                            | 63,0                           | 50,0                             | 61092    | 68334               |
| C                                  | 0.2420         | 3-1/4                            | 2                              | 1-39/64                          | 51203    | 57173               |
| 6,2 mm                             | 0.2441         | 101,0                            | 63,0                           | 50,0                             | 61093    | 68335               |
| D                                  | 0.2460         | 3-1/4                            | 2                              | 1-39/64                          | 51204    | 57174               |
| 6,3 mm                             | 0.2480         | 101,0                            | 63,0                           | 50,0                             | 61094    | 68336               |
| *E                                 | 0.2500         | 3-1/4                            | 2                              | 1-39/64                          | 51116    | 57175               |
| 1/4                                | 0.2500         | 3-1/4                            | 2                              | 1-39/64                          | 51205    | 57176               |
| 6,4 mm                             | 0.2520         | 101,0                            | 63,0                           | 50,0                             | 61095    | 68337               |
| 6,5 mm                             | 0.2559         | 101,0                            | 63,0                           | 50,0                             | 61029    | 68282               |
| F                                  | 0.2570         | 3-1/4                            | 2                              | 1-39/64                          | 51206    | 57177               |
| 6,6 mm                             | 0.2598         | 101,0                            | 63,0                           | 50,0                             | 61096    | 68338               |
| G                                  | 0.2610         | 3-1/2                            | 2-1/8                          | 1-45/64                          | 51207    | 57178               |
| 6,7 mm                             | 0.2638         | 101,0                            | 63,0                           | 50,0                             | 61097    | 68339               |

continued on next page



# Slow Spiral Drills

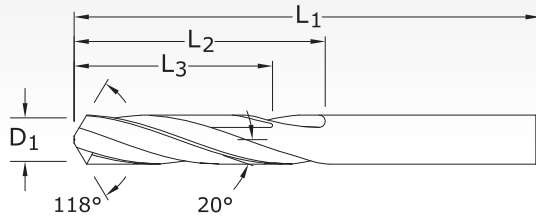

**101**

FRACTIONAL & METRIC SERIES

TECH INFO 178-179

- STEELS
- STAINLESS STEELS
- CAST IRON
- HIGH TEMP ALLOYS
- TITANIUM
- NON-FERROUS
- PLASTICS/COMPOSITES

| CUTTING DIAMETER<br>D <sub>1</sub> | DECIMAL EQUIV. | OVERALL LENGTH<br>L <sub>1</sub> | FLUTE LENGTH<br>L <sub>2</sub> | CLEARED LENGTH<br>L <sub>3</sub> | EDP NO.  |                     |
|------------------------------------|----------------|----------------------------------|--------------------------------|----------------------------------|----------|---------------------|
|                                    |                |                                  |                                |                                  | UNCOATED | Ti-NAMITE-A (AlTiN) |
| 17/64                              | 0.2656         | 3-1/2                            | 2-1/8                          | 1-45/64                          | 51117    | 57179               |
| H                                  | 0.2660         | 3-1/2                            | 2-1/8                          | 1-45/64                          | 51208    | 57180               |
| 6,8 mm                             | 0.2677         | 109,0                            | 69,0                           | 55,0                             | 61098    | 68340               |
| 6,9 mm                             | 0.2717         | 109,0                            | 69,0                           | 55,0                             | 61099    | 68341               |
| I                                  | 0.2720         | 3-1/2                            | 2-1/8                          | 1-45/64                          | 51209    | 57181               |
| 7,0 mm                             | 0.2756         | 109,0                            | 69,0                           | 55,0                             | 61031    | 68283               |
| J                                  | 0.2770         | 3-1/2                            | 2-1/8                          | 1-45/64                          | 51210    | 57182               |
| 7,1 mm                             | 0.2795         | 109,0                            | 69,0                           | 55,0                             | 61100    | 68342               |
| K                                  | 0.2810         | 3-1/2                            | 2-1/8                          | 1-45/64                          | 51211    | 57183               |
| 9/32                               | 0.2812         | 3-1/2                            | 2-1/8                          | 1-45/64                          | 51118    | 57184               |
| 7,2 mm                             | 0.2835         | 109,0                            | 69,0                           | 55,0                             | 61101    | 68343               |
| 7,3 mm                             | 0.2874         | 109,0                            | 69,0                           | 55,0                             | 61102    | 68344               |
| L                                  | 0.2900         | 3-1/2                            | 2-1/8                          | 1-45/64                          | 51212    | 57185               |
| 7,4 mm                             | 0.2913         | 109,0                            | 69,0                           | 55,0                             | 61103    | 68345               |
| M                                  | 0.2950         | 3-3/4                            | 2-3/8                          | 1-29/32                          | 51213    | 57186               |
| 7,5 mm                             | 0.2953         | 109,0                            | 69,0                           | 55,0                             | 61033    | 68284               |
| 19/64                              | 0.2969         | 3-3/4                            | 2-3/8                          | 1-29/32                          | 51119    | 57187               |
| 7,6 mm                             | 0.2992         | 117,0                            | 75,0                           | 60,0                             | 61104    | 68346               |
| N                                  | 0.3020         | 3-3/4                            | 2-3/8                          | 1-29/32                          | 51214    | 57188               |
| 7,7 mm                             | 0.3031         | 117,0                            | 75,0                           | 60,0                             | 61105    | 68347               |
| 7,8 mm                             | 0.3071         | 117,0                            | 75,0                           | 60,0                             | 61106    | 68348               |
| 7,9 mm                             | 0.3110         | 117,0                            | 75,0                           | 60,0                             | 61107    | 68349               |
| *5/16                              | 0.3125         | 3-3/4                            | 2-3/8                          | 1-29/32                          | 51120    | 57189               |
| 8,0 mm                             | 0.3150         | 117,0                            | 75,0                           | 60,0                             | 61035    | 68285               |
| O                                  | 0.3160         | 3-3/4                            | 2-3/8                          | 1-29/32                          | 51215    | 57190               |
| 8,1 mm                             | 0.3189         | 117,0                            | 75,0                           | 60,0                             | 61108    | 68350               |
| 8,2 mm                             | 0.3228         | 117,0                            | 75,0                           | 60,0                             | 61109    | 68351               |
| P                                  | 0.3230         | 3-3/4                            | 2-3/8                          | 1-29/32                          | 51216    | 57191               |
| 8,3 mm                             | 0.3268         | 117,0                            | 75,0                           | 60,0                             | 61110    | 68352               |
| 21/64                              | 0.3281         | 4                                | 2-1/2                          | 2                                | 51121    | 57192               |
| 8,4 mm                             | 0.3307         | 117,0                            | 75,0                           | 60,0                             | 61111    | 68353               |
| Q                                  | 0.3320         | 4                                | 2-1/2                          | 2                                | 51217    | 57193               |
| 8,5 mm                             | 0.3346         | 117,0                            | 75,0                           | 60,0                             | 61037    | 68286               |
| 8,6 mm                             | 0.3386         | 125,0                            | 81,0                           | 64,0                             | 61112    | 68354               |
| R                                  | 0.3390         | 4                                | 2-1/2                          | 2                                | 51218    | 57194               |
| 8,7 mm                             | 0.3425         | 125,0                            | 81,0                           | 64,0                             | 61113    | 68355               |
| 11/32                              | 0.3438         | 4                                | 2-1/2                          | 2                                | 51122    | 57195               |
| 8,8 mm                             | 0.3465         | 125,0                            | 81,0                           | 64,0                             | 61114    | 68356               |

TOLERANCES (inch)

D<sub>1</sub> = +0.0000/-0.0005

TOLERANCES (mm)

D<sub>1</sub> = +0,0000/-0,0127

continued on next page



# Slow Spiral Drills



## 101

FRACTIONAL & METRIC SERIES

CONTINUED

| CUTTING DIAMETER<br>D <sub>1</sub> | DECIMAL EQUIV. | OVERALL LENGTH<br>L <sub>1</sub> | FLUTE LENGTH<br>L <sub>2</sub> | CLEARED LENGTH<br>L <sub>3</sub> | EDP NO.  |                     |
|------------------------------------|----------------|----------------------------------|--------------------------------|----------------------------------|----------|---------------------|
|                                    |                |                                  |                                |                                  | UNCOATED | TI-NAMITE-A (AITIN) |
| S                                  | 0.3480         | 4                                | 2-1/2                          | 2                                | 51219    | 57196               |
| 8,9 mm                             | 0.3504         | 125,0                            | 81,0                           | 64,0                             | 61115    | 68357               |
| 9,0 mm                             | 0.3543         | 125,0                            | 81,0                           | 64,0                             | 61039    | 68287               |
| T                                  | 0.3580         | 4-1/4                            | 2-3/4                          | 2-13/64                          | 51220    | 57197               |
| 9,1 mm                             | 0.3583         | 125,0                            | 81,0                           | 64,0                             | 61116    | 68358               |
| 23/64                              | 0.3594         | 4-1/4                            | 2-3/4                          | 2-13/64                          | 51123    | 57198               |
| 9,2 mm                             | 0.3622         | 125,0                            | 81,0                           | 64,0                             | 61117    | 68359               |
| 9,3 mm                             | 0.3661         | 125,0                            | 81,0                           | 64,0                             | 61118    | 68360               |
| U                                  | 0.3680         | 4-1/4                            | 2-3/4                          | 2-13/64                          | 51221    | 57199               |
| 9,4 mm                             | 0.3701         | 125,0                            | 81,0                           | 64,0                             | 61119    | 68361               |
| 9,5 mm                             | 0.3740         | 125,0                            | 81,0                           | 64,0                             | 61041    | 68288               |
| *3/8                               | 0.3750         | 4-1/4                            | 2-3/4                          | 2-13/64                          | 51124    | 57200               |
| V                                  | 0.3770         | 4-1/4                            | 2-3/4                          | 2-13/64                          | 51222    | 57201               |
| 9,6 mm                             | 0.3780         | 133,0                            | 87,0                           | 69,0                             | 61120    | 68362               |
| 9,7 mm                             | 0.3819         | 133,0                            | 87,0                           | 69,0                             | 61121    | 68363               |
| 9,8 mm                             | 0.3858         | 133,0                            | 87,0                           | 69,0                             | 61122    | 68364               |
| W                                  | 0.3860         | 4-1/2                            | 2-7/8                          | 2-19/64                          | 51223    | 57202               |
| 9,9 mm                             | 0.3898         | 133,0                            | 87,0                           | 69,0                             | 61123    | 68365               |
| 25/64                              | 0.3906         | 4-1/2                            | 2-7/8                          | 2-19/64                          | 51125    | 57203               |
| 10,0 mm                            | 0.3937         | 133,0                            | 87,0                           | 69,0                             | 61043    | 68289               |
| X                                  | 0.3970         | 4-1/2                            | 2-7/8                          | 2-19/64                          | 51224    | 57204               |
| 10,2 mm                            | 0.4016         | 133,0                            | 87,0                           | 69,0                             | 61124    | 68366               |
| Y                                  | 0.4040         | 4-1/2                            | 2-7/8                          | 2-19/64                          | 51225    | 57205               |
| 13/32                              | 0.4062         | 4-1/2                            | 2-7/8                          | 2-19/64                          | 51126    | 57206               |
| Z                                  | 0.4130         | 4-1/2                            | 2-7/8                          | 2-19/64                          | 51226    | 57207               |
| 10,5 mm                            | 0.4134         | 133,0                            | 87,0                           | 69,0                             | 61045    | 68290               |
| 27/64                              | 0.4219         | 4-1/2                            | 2-7/8                          | 2-19/64                          | 51127    | 57208               |
| 11,0 mm                            | 0.4331         | 142,0                            | 94,0                           | 75,0                             | 61047    | 68291               |
| 7/16                               | 0.4375         | 4-1/2                            | 2-7/8                          | 2-19/64                          | 51128    | 57209               |
| 11,5 mm                            | 0.4528         | 142,0                            | 94,0                           | 75,0                             | 61049    | 68292               |
| 29/64                              | 0.4531         | 4-3/4                            | 3                              | 2-13/32                          | 51129    | 57210               |
| 15/32                              | 0.4688         | 4-3/4                            | 3                              | 2-13/32                          | 51130    | 57211               |
| 12,0 mm                            | 0.4724         | 151,0                            | 101,0                          | 80,0                             | 61051    | 68293               |
| 31/64                              | 0.4844         | 4-3/4                            | 3                              | 2-13/32                          | 51131    | 57212               |
| 1/2                                | 0.5000         | 4-3/4                            | 3                              | 2-13/32                          | 51132    | 57213               |
|                                    |                |                                  |                                |                                  | 61175    | 57351               |

\*Series 101 Set

