

## Cutting heads with CoroTurn® SL coupling

CoroTurn® 111 screw clamp design

Entering angle:

570-STFPR/L  
 $\kappa_r 91^\circ$



TPMT

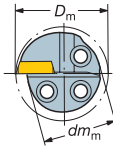
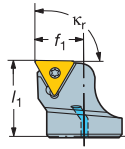

### All with internal coolant supply

Right hand style shown

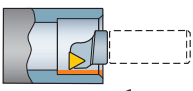
$\kappa_r$	Main application	△	Ordering code	Dimensions, mm					Gauge inserts	Nm <sup>2)</sup>
				$dm_m$	$D_m$ min	$f_1$	$l_1$	$\lambda_s$ <sup>1)</sup>		
91°		11	570-STFPR/L-16-11	16	20	11.0	20	-1°	TPMT 11 03 04	0.9
			570-STFPR/L-20-11	20	25	13.0	20	0°	TPMT 11 03 04	0.9
			570-STFPR/L-25-11	25	32	17.0	20	1°	TPMT 11 03 04	0.9

<sup>1)</sup>  $\lambda_s$  = Angle of inclination.

<sup>2)</sup> Insert tightening torque Nm

Ordering example: 2 pieces 570-STFPR-16-11  
570-STFPL-16-11  
R = Right hand, L = Left hand

### Main spare parts

Insert size			
△	Bar dia.	Insert screw	Key Torx Plus
11	16-25	5513 020-03	5680 051-02 (7IP)



A9



A318



A2



A219

## Cutting heads with CoroTurn® SL coupling

CoroTurn® 111 screw clamp design



Entering angle:

**570-SVQCR/L**  
 $\kappa_r 107.5^\circ$

**570-SVUCR/L**  
 $\kappa_r 93^\circ$

VCMT, VCEX,  
VCGX  
VCMW

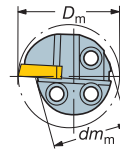
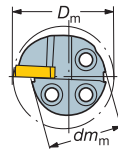
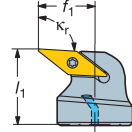
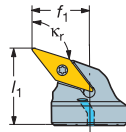

All with internal coolant supply

Right hand style shown

$\kappa_r$	Main application	Ordering code	Dimensions, mm					Gauge inserts	Nm <sup>2)</sup>
			$dm_m$	$D_m$ min	$f_1$	$l_1$	$\lambda_s$ <sup>1)</sup>		
107.5°		11 570-SVQCR/L-20-11-E	20	27	15.0	20	-3°	VCMT 11 03 04	0.9
		570-SVQCR/L-25-11-D	25	33	18.0	20	-2°	VCMT 11 03 04	0.9
93°		11 570-SVUCR/L-20-11-E	20	27	15.0	20	-4°	VCMT 11 03 04	0.9
		570-SVUCR/L-25-11-D	25	33	18.0	20	-2°	VCMT 11 03 04	0.9

<sup>1)</sup>  $\lambda_s$  = Angle of inclination.

<sup>2)</sup> Insert tightening torque Nm

Ordering example: 2 pieces 570-SVQCR-20-11-E

570-SVQCL-20-11-E

R = Right hand, L = Left hand

### Main spare parts

Insert size	Bar dia.	Insert screw	Key Torx Plus
11	20-25	5513 020-03	5680 051-02 (7IP)



A9



A318



A2



A219

## Cutting heads with CoroTurn® SL coupling

CoroTurn® 111 screw clamp design



WPMT

Entering angle:

570-SWLPR/L  
 $\kappa_r 95^\circ$

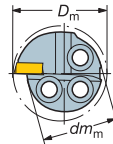
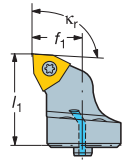

### All with internal coolant supply

Right hand style shown

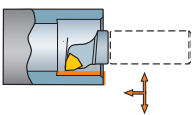
$\kappa_r$	Main application	Ordering code	Dimensions, mm					Gauge inserts	Nm <sup>2)</sup>
			$dm_m$	$D_m$ min	$f_1$	$l_1$	$\lambda_s$ <sup>1)</sup>		
95°		04 570-SWLPR/L-16-04	16	20	11.0	20	-2°	WPMT 04 02 04	0.9

<sup>1)</sup>  $\lambda_s$  = Angle of inclination.

<sup>2)</sup> Insert tightening torque Nm

Ordering example: 2 pieces 570-SWLPR-16-04

570-SWLPL-16-04

R = Right hand, L = Left hand

### Main spare parts

Insert size			
$\kappa_r$	Bar dia.	Insert screw	Key Torx Plus
04	16	5513 020-46	5680 051-02 (7IP)



A9



A318



A2



A219

## Cutting heads with CoroTurn® SL coupling

## Blanks

R/L570-

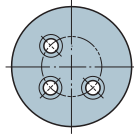
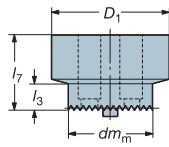

Right hand style shown

Ordering code	Dimensions, mm			
	$dm_m$	$D_1$	$l_3$	$l_7$
R/L570-162513B	16	26	7	25
R/L570-202517B	20	34	7	25
R/L570-252517B	25	34	7	25
R/L570-324022B	32	44	11	40
R/L570-404527B	40	54	11	45
R/L570-504535B	50	70	16	45
R/L570-604543B	60	86	16	45

Ordering example: 2 pieces R570-162513B  
L570-162513B

R = Right hand, L = Left hand



Coolant nozzles, see page A241.

## Main spare parts

Coupling size		
$dm_m$	Locating tube	Locating pin
16	5552 058-01	5552 040-01
20-40	5552 058-02	5552 040-02
50	5552 058-03	5552 040-03
60	5552 058-04	5552 040-04



A9



A2



A219

# CoroTurn® SL (Type 570)

Coromant Capto® boring bars

## C...-570-2C

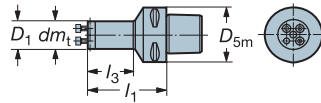
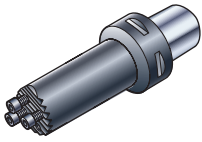

## C...-570-2C...-40R/L

Bars with reduction dia (50–40, 60–40 mm)

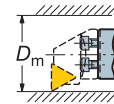
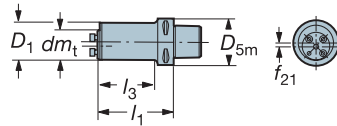
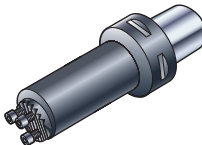

All with internal coolant supply

Bar dia.	Ordering code	Dimensions, mm					
		Coupling size					
$D_1$		$D_{m \min}$	$dm_t$	$D_{5m}$	$f_{21}$	$l_1$	$l_3$
16	C3-570-2C 16 045	20	16	32	–	45	28
20	C3-570-2C 20 050	25	20	32	–	50	33
25	C3-570-2C 25 064	32	25	32	–	64	48
32	C3-570-2C 32 053	40	32	32	–	53	53
16	C4-570-2C 16 048	20	16	40	–	48	25
20	C4-570-2C 20 058	25	20	40	–	58	35
25	C4-570-2C 25 064	32	25	40	–	64	42
32	C4-570-2C 32 074	40	32	40	–	74	53
40	C4-570-2C 40 073	50	40	40	–	73	73
16	C5-570-2C 16 052	20	16	50	–	52	28
20	C5-570-2C 20 059	25	20	50	–	59	35
25	C5-570-2C 25 067	32	25	50	–	67	44
32	C5-570-2C 32 075	40	32	50	–	75	53
40	C5-570-2C 40 094	50	40	50	–	94	73
16	C6-570-2C 16 056	20	16	63	–	56	28
20	C6-570-2C 20 068	25	20	63	–	67	40
25	C6-570-2C 25 082	32	25	63	–	82	55
32	C6-570-2C 32 081	40	32	63	–	81	55
40	C6-570-2C 40 092	50	40	63	–	92	67
40	C8-570-2C 40 105	50	40	80	–	105	77
50	C5-570-2C 50 098-40R/L	60	40	50	5	98	98
50	C6-570-2C 50 124-40R/L	60	40	63	5	124	98
60	C6-570-2C 60 148-40R/L	72	40	63	10	148	123
50	C8-570-2C 50 125-40R/L	60	40	80	5	125	96
60	C8-570-2C 60 150-40R/L	72	40	80	10	150	123

A reduction adaptor, can be used to build tools such as:

Ordering example: 2 pieces C3-570-2C 16 045

C5 dmt 16 mm,  
C6 dmt 16–25 mm,  
C8 dmt 16–60 mm

See page G33.



A9



A238



A238



G6



A2

## CoroTurn® SL (Type 570)

Coromant Capto® damped boring bars

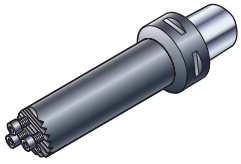

C...-570-3C

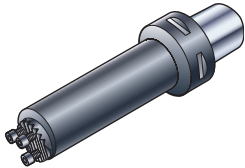
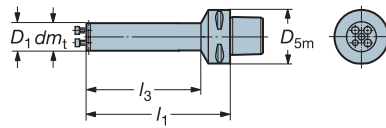

C...-570-3C...-40R/L

Bars with reduction dia (50–40, 60–40 mm)

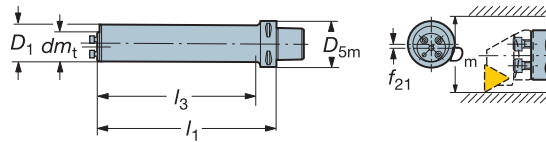

All with internal coolant supply

Bar dia.	Ordering code	Dimensions, mm					
		Coupling size					
$D_1$		$D_m$ min	$dm_t$	$D_{5m}$	$f_{21}$	$l_1$	$l_3$
16	C3-570-3C 16 082	20	16	32	–	82	65
20	C3-570-3C 20 101	25	20	32	–	101	85
25	C3-570-3C 25 125	32	25	32	–	125	110
32	C3-570-3C 32 133	40	32	32	–	133	133
16	C4-570-3C 16 088	20	16	40	–	88	65
20	C4-570-3C 20 107	25	20	40	–	107	85
25	C4-570-3C 25 132	32	25	40	–	132	110
32	C4-570-3C 32 154	40	32	40	–	154	133
40	C4-570-3C 40 173	50	40	40	–	173	173
16	C5-570-3C 16 085	20	16	50	–	84	60
20	C5-570-3C 20 109	25	20	50	–	109	85
25	C5-570-3C 25 133	32	25	50	–	133	110
32	C5-570-3C 32 154	40	32	50	–	154	133
40	C5-570-3C 40 194	50	40	50	–	194	173
16	C6-570-3C 16 088	20	16	63	–	88	60
20	C6-570-3C 20 108	25	20	63	–	108	80
25	C6-570-3C 25 132	32	25	63	–	132	105
32	C6-570-3C 32 159	40	32	63	–	159	133
40	C6-570-3C 40 198	50	40	63	–	198	173
25	C8-570-3C 25 147	32	25	80	–	147	110
32	C8-570-3C 32 172	40	32	80	–	172	136
40	C8-570-3C 40 224	50	40	50	–	224	189
50	C5-570-3C 50 223-40R/L	60	40	50	5	223	223
50	C6-570-3C 50 247-40R/L	60	40	50	5	247	221
60	C6-570-3C 60 295-40R/L	72	40	63	10	295	267
50	C8-570-3C 50 297-40R	60	40	80	5	297	263
60	C8-570-3C 60 355-40R	72	40	80	10	355	322

A reduction adaptor, can be used to build tools such as:

C5 dmt 16 mm,  
C6 dmt 16–25 mm,  
C8 dmt 16–60 mm

See page G33.

Ordering example: 2 pieces C3-570-3C 16 082



## CoroTurn® SL (Type 570)

Coromant Capto® boring bars

Short version

**C..-570-2C Type 1**

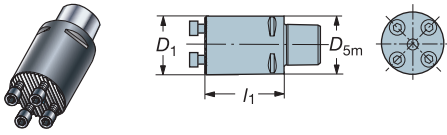

**C..-570-2C...R Type 2**

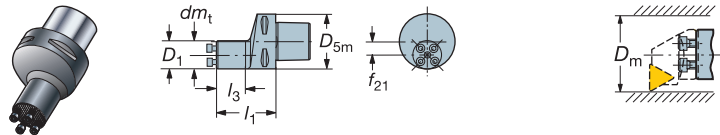

Bars with reduction dia (50–40, 60–40 mm)

**C..-570-2C...R40 Type 3**

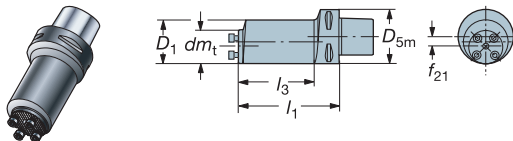

**C..-570-2C...-40R Type 4**

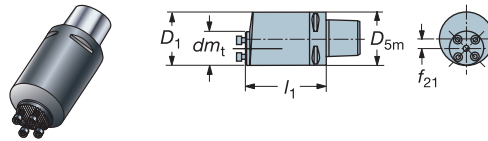

All with internal coolant supply

Right hand style shown

Bar dia.		Ordering code	Dimensions, mm					
$D_1$	Type		Coupling size					
			$D_m$ min	$dm_t$	$D_{5m}$	$f_{21}$	$l_1$	$l_3$
16	2	C3-570-2C 16 033R/L	20	16	32	8	33	12
20	2	C3-570-2C 20 040R/L	25	20	32	6	40	20
25	2	C3-570-2C 25 044R/L	32	25	32	3,5	44	25
32	1	C3-570-2C 32 037	40	32	32	-	37	-
16	2	C4-570-2C 16 041R/L	20	16	40	12	41	12
20	2	C4-570-2C 20 047R/L	25	20	40	10	47	20
25	2	C4-570-2C 25 051R/L	32	25	40	7,5	51	25
32	2	C4-570-2C 32 056R/L	40	32	40	4	56	32
40	1	C4-570-2C 40 053	50	40	40	-	53	-
16	2	C5-570-2C 16 040R	20	16	50	12	40	12
20	2	C5-570-2C 20 050R	25	20	50	15	50	20
25	2	C5-570-2C 25 054R/L	32	25	50	12:05	54	25
32	2	C5-570-2C 32 061R/L	40	32	50	9	61	32
40	2	C5-570-2C 40 075R/L	50	40	50	5	75	48
50	4	C5-570-2C 50 073-40R/L	60	40	50	5	73	-
16	2	C6-570-2C 16 045R	20	16	63	23,5	45	12
20	2	C6-570-2C 20 052R	25	20	63	21,5	52	20
25	2	C6-570-2C 25 056R/L	32	25	63	19	56	25
32	2	C6-570-2C 32 066R/L	40	32	63	15,5	66	32
40	2	C6-570-2C 40 080R/L	50	40	63	11,5	80	48
50	3	C6-570-2C 50 097R/L40	60	40	63	6,5	97	68
60	3	C6-570-2C 60 112R/L40	70	40	63	6,5	112	88
40	2	C8-570-2C 40 081R/L	50	40	80	20	81	48
50	3	C8-570-2C 50 102R/L40	60	40	80	15	102	68
60	3	C8-570-2C 60 119R/L40	70	40	80	15	119	88

A reduction adaptor, can be used to build tools such as:

C5 dmt 16 mm,  
C6 dmt 16–25 mm,  
C8 dmt 16–60 mm

See page G33.

Ordering example: 2 pieces C3-570-2C 16 033R

C3-570-2C 16 033L

R = Right hand, L = Left hand



## CoroTurn® SL (Type 570)

## Boring bars

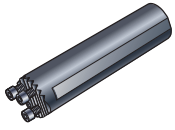

## 570-2C

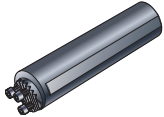
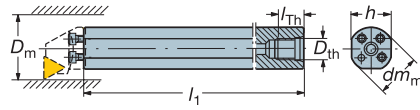

## 570-2C-40

Bars with reduction dia (50–40, 60–40 mm)

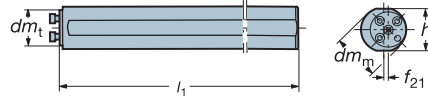

All with internal coolant supply

Max recommended overhang 4 x  $dm_m$ 

Ordering code	Dimensions, mm							
	$dm_m$	$h$	$dm_t$	Coupling size		$f_{21}$	$l_1$	$l_{th}$
570-2C 16 105	16	15	16	$D_m$ min	$D_{th}$		105	12
570-2C 20 140	20	18	20		G 1/8"		140	15
570-2C 25 200	25	23	25		G 1/4"		200	15
570-2C 32 218	32	30	32		G 3/8"		218	19
570-2C 40 283	32	37	40		G 1/2"		283	23
570-2C 50 368-40	50	47	40		-	5	368	-
570-2C 60 468-40	60	57	40		-	10	468	-

Ordering example: 2 pieces 570-2C 16 105





## CoroTurn® SL (Type 570)

Damped boring bars, cylindrical

### 570-3C

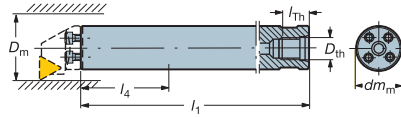
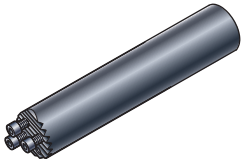

### 570-3C-40

Bars with reduction dia (50–40, 60–40 mm)

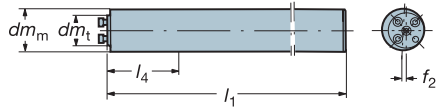
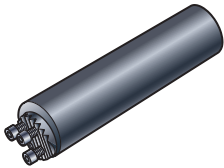

**Silent** Tools™

All with internal coolant supply

Short design. Max overhang  $7 \times dm_m$

Long design. Max overhang  $10 \times dm_m$

Bar dia.		Ordering code	Dimensions, mm						
$dm_m$	Coupling size $dm_t$		$D_m$ min	$D_{th}$	$f_{21}$	$l_1$	$l_4^{1)}$	$l_{th}$	
16	16	570-3C 16 156	20	G1/8"	–	156	55	12	
20	20	570-3C 20 200	25	G1/4"	–	200	70	15	
25	25	570-3C 25 255	32	G1/4"	–	255	85	15	
32	32	570-3C 32 320	40	G3/8"	–	320	100	19	
40	40	570-3C 40 408	50	G1/2"	–	408	120	23	
25	25	570-3C 25 330	32	G1/4"	–	330	115	15	
32	32	570-3C 32 416	40	G3/8"	–	416	140	19	
40	40	570-3C 40 528	50	G1/2"	–	528	165	23	
50	40	570-3C 50 518-40	60	–	5	518	174	–	
60	40	570-3C 60 628-40	72	–	10	628	208	–	
50	40	570-3C 50 668-40	60	–	5	668	319	–	
60	40	570-3C 60 808-40	72	–	10	808	388	–	

1) Do not clamp in this area.

Ordering example: 2 pieces 570-3C 16 156

Damped reinforced boring bar

### 570-3C CR

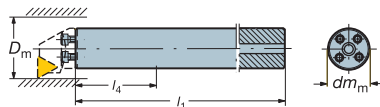
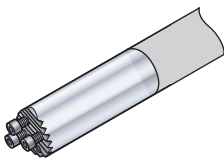

**Silent** Tools™

All with internal coolant supply

Max recommended overhang  $10 \times dm_m$

Bar dia.		Ordering code	Dimensions, mm			
$dm_m$	Coupling size $dm_t$		$D_m$ min	$f_{21}$	$l_1$	$l_4^{1)}$
16	16	570-3C 16 204 CR	20	–	204	–
20	20	570-3C 20 260 CR	25	–	260	–

1) Do not clamp in this area.

Ordering example: 2 pieces 570-3C 16 204 CR



## CoroTurn® SL (Type 570)

Carbide reinforced boring bars with overhang more than 10 x diameter

When machining with an overhang beyond 10 times the diameter of a boring bar, we recommend our Carbide Reinforced Boring Bars. These bars are designed for productive machining up to 14 times the diameter of the bar.

Delivery time is 2-3 weeks. Pricing and other technical information is available from your Sandvik Coromant sales representative.

### Damped carbide reinforced boring bars with 570 coupling

Max recommended overhang 10-12 x  $dm_m$   
Short design

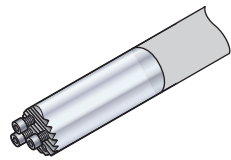

Ordering code	Weight kg	Ordering code	Weight kg	Ordering code	Weight kg
570-3C-25-380-CR	1.7	570-3C-50-760-CR-40	12.6	570-3C-80-1240-CR	45.3
570-3C-32-480-CR	3.8	570-3C-60-920-CR-40	21.3	570-3C-100-1560-CR	105.3
570-3C-40-608-CR	6.9	570-3C-63-968-CR-40	25.1		

Max recommended overhang 12-14 x  $dm_m$   
Long design

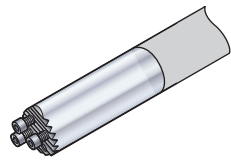

Ordering code	Weight kg	Ordering code	Weight kg	Ordering code	Weight kg
570-3C-25-430-CR	1.9	570-3C-50-861-CR-40	15.3	570-3C-80-1400-CR	54.9
570-3C-32-544-CR	4.3	570-3C-60-1040-CR-40	25.9	570-3C-100-1760-CR	128.9
570-3C-40-688-CR	7.8	570-3C-63-1094-CR-40	30.5		

### Reduction adaptor for CoroTurn® SL boring bars

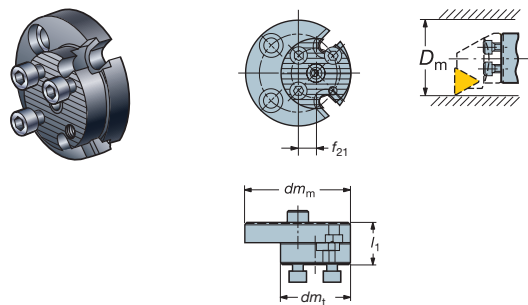

All with internal coolant supply

Bar dia.

Dimensions, mm

$dm_m$	Ordering code	Coupling size $dm_t$	$D_m$ min		
			$f_{21}$	$l_1$	
50	570-50 23-32	32	60	9	23
60	570-60 23-40	40	72	10	23

Ordering example: 2 pieces 570-50 23-32



A2

This catalogue has been split into smaller parts  
to enhance downloading speeds.

If you want to view the next page  
please click [HERE!](#)