



- Quick quotation
- Easy to order
- Competitive delivery

Even more possibilities thanks to tailored design!
 If you do not find what you need in our comprehensive standard programme, choose the tool shape you require and we will tailor it for you to *your* dimensions.

CoroCut® 1-2 shanks for face grooving

With spring clamp design & internal coolant

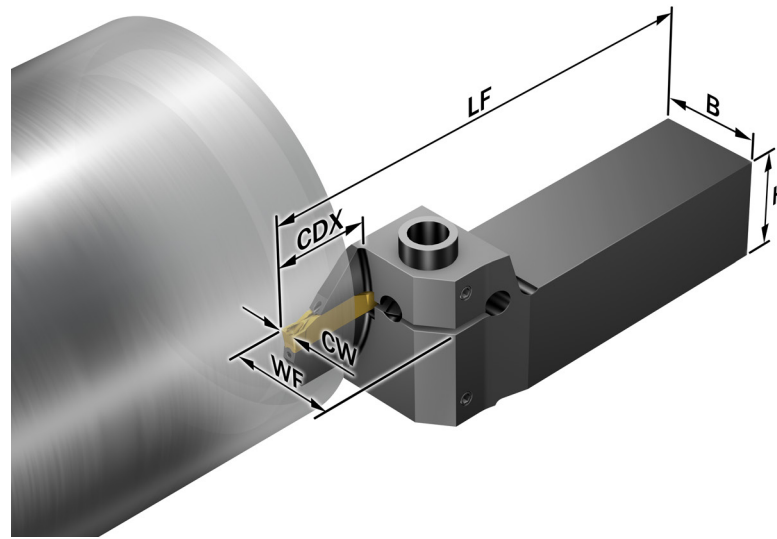

Options

Note! For specific details regarding the options, contact your Sandvik Coromant sales representative.

Unit system	Metric or Inch
Coupling type	Shank
Coupling size	2020-3232 (12-20)
Blade type	A or B
Tool in hand	R, L
Insert width (Tip seat)	2.5 - 10 mm (0.098-0.394 inch) (F-M)
CDX (max cutting depth)	Depending on insert width

Coolant type	None, Over, Under, Over+Under
WF (tool width)	Depending on shank size
LF (tool length)	Depending on coupling size



CoroCut® 1-2 shanks for face grooving
 With spring clamp design & internal coolant

Inquiry/ordering No.

Customer	Customer No. (Coromant internal)	Date
Street	Telephone	Customer attention
Post Code/City/State	Telefax	Issuer
Quantity	Customer denomination	

State nearest standard catalogue code, see main catalogue or supplement catalogue

R/LF 123	-																		
----------	---	--	--	--	--	--	--	--	--	--	--	--	--	--	--	--	--	--	--

Metric std

Your value/
Your choice

State only your options deviating from the above standard

Unit system	Metric or Inch	<input type="text"/>
Coupling type	Shank	<input type="text"/>
Coupling size	2020-3232 (12-20)	<input type="text"/>
Blade type	A or B	<input type="text"/>
Tool in hand	R, L	<input type="text"/>
Insert width (Tip seat)	2.5 - 10 mm (0.098-0.394 inch) (F-M)	<input type="text"/>
CDX (max cutting depth)	Depending on insert width	<input type="text"/>
Coolant type	None, Over, Under, Over+Under	<input type="text"/>
WF (tool width)	Depending on shank size	<input type="text"/>
LF (tool length)	Depending on coupling size	<input type="text"/>

Form No. C -1250327-US
 Family code = T613
 CoroPak 16.1



The value/choice must be given
 If no value/choice is specified, it will be recommended by the system

Tailor Made

- Quick quotation
- Easy to order
- Competitive delivery

Even more possibilities thanks to tailored design!
 If you do not find what you need in our comprehensive standard programme, choose the tool shape you require and we will tailor it for you to *your* dimensions.

CoroCut® 1-2 QS-shanks for face grooving

With spring clamp design & internal coolant

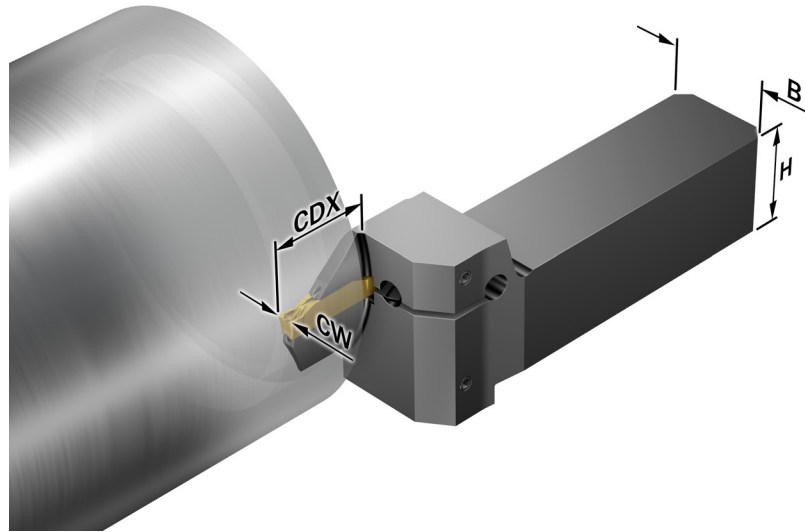

Options

Note! For specific details regarding the options, contact your Sandvik Coromant sales representative.

Unit system	Metric or Inch
Coupling type	QS shank
Coupling size	2020-2525 (12-16)
Approach angle	0° or 90°
Blade type	A or B
Tool in hand	R, L
Insert width (Tip seat)	2.5 - 10 mm (0.098-0.394 inch) (F-M)

CDX (max cutting depth)	Depending on insert width
Coolant type	None, Over, Under, Over+Under



CoroCut® 1-2 QS-shanks for face grooving
 With spring clamp design & internal coolant

Inquiry/ordering No.

Customer	Customer No. (Coromant internal)	Date
Street	Telephone	Customer attention
Post Code/City/State	Telefax	Issuer
Quantity	Customer denomination	

State nearest standard catalogue code, see main catalogue or supplement catalogue

QS-R/LF 123 -

Metric std

Your value/
Your choice

State only your options deviating from the above standard

Unit system	Metric or Inch	<input type="text"/>
Coupling type	QS shank	<input type="text"/>
Coupling size	2020-2525 (12-16)	<input type="text"/>
Approach angle	0° or 90°	<input type="text"/>
Blade type	A or B	<input type="text"/>
Tool in hand	R, L	<input type="text"/>
Insert width (Tip seat)	2.5 - 10 mm (0.098-0.394 inch) (F-M)	<input type="text"/>
CDX (max cutting depth)	Depending on insert width	<input type="text"/>
Coolant type	None, Over, Under, Over+Under	<input type="text"/>

Form No. C -1250327-US
 Family code = T613
 CoroPak 16.1



The value/choice must be given
 If no value/choice is specified, it will be recommended by the system

Tailor Made

- Quick quotation
- Easy to order
- Competitive delivery

Even more possibilities thanks to tailored design!
 If you do not find what you need in our comprehensive standard programme, choose the tool shape you require and we will tailor it for you to *your* dimensions.

CoroCut® 1-2 Coromant Capto® for face grooving

With spring clamp design & internal coolant

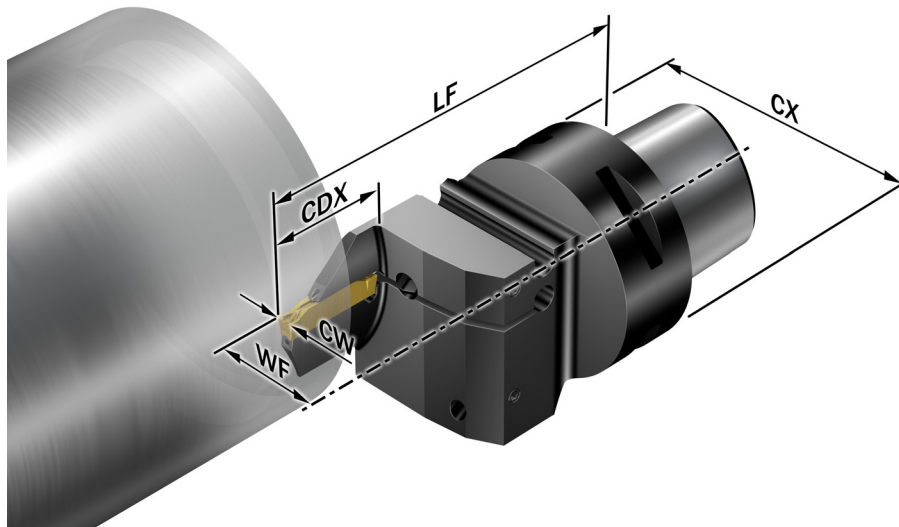

Options

Note! For specific details regarding the options, contact your Sandvik Coromant sales representative.

Unit system	Metric or Inch
Coupling type	Coromant Capto
Coupling size	C3-C8
Blade type	A or B
Tool in hand	R, L
Insert width	2.5 - 10 mm (0.098-0.394 inch)
(Tip seat)	(F-M)
CDX (max cutting depth)	Depending on insert width

Coolant type	None, Over, Under, Over+Under
WF (tool width)	Depending on shank size
LF (tool length)	Depending on coupling size

