

Starrett®



3900A & B

2700

2900

W2900

W4900-1

ELECTRONIC INDICATORS

METROLOGY **S**OLUTIONS

3900A AND 3900B ELECTRONIC INDICATORS

AGD GROUP 2 RANGES UP TO 1" AND 25.4MM

3900 Series Electronic Indicators have simple, powerful, easy-to-use functions, all at an attractive price. 3900A is Starrett's entry level electronic indicator. 3900B adds SPC output capability. Versions are available in inch/metric (3/8" stem, 4-48 screw thread) and metric/inch (8mm stem, M2.5 x 0.45 screw thread).

FEATURES

- Large, easy-to-read LCD
- Reverse travel (\pm control indicates direction)
- Zero setting at any position
- Long battery life
- 3/8" diameter stem for inch/mm models (8mm on metric-only models)
- #4-48 screw thread on inch/mm models (M2.5 X 0.45 thread on metric-only models)
- Lug-on-center back with additional flat back
- Dust cap
- Plastic storage case with form-fit foam insert



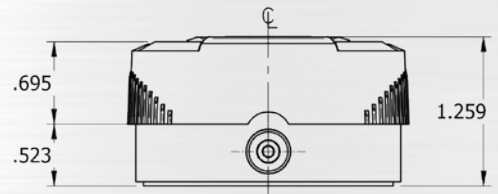
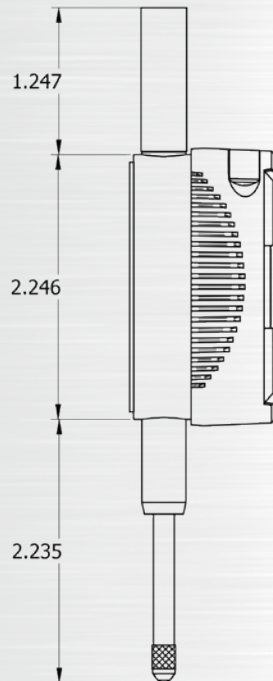
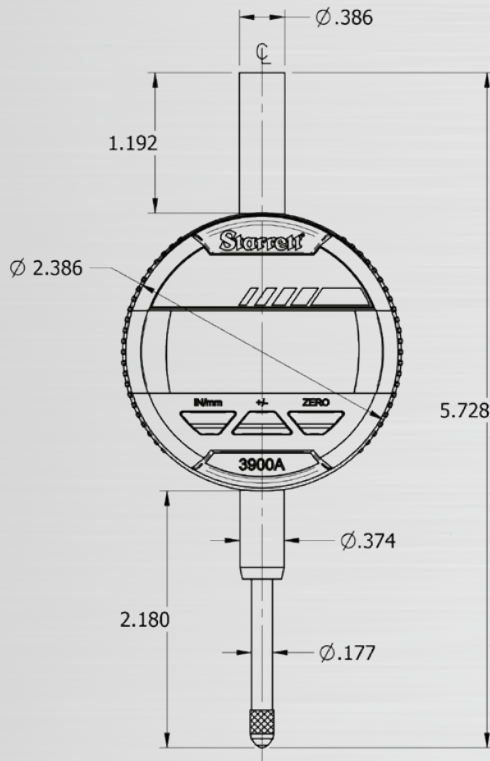

Cat. No.	EDP	Range		Resolution		Accuracy		Stem Diameter	Screw Thread
		in	mm	in	mm	in ±	mm ±		
3900A-5	62418	.5	12.7	.0005	0.01	.001	0.03	3/8"	#4-48
3900MA-5	62420	.5	12.7	.0005	0.01	.001	0.03	8mm	M2.5 x 0.45
3900A-1	62419	1	25.4	.0005	0.01	.001	0.03	3/8"	#4-48
3900MA-25	62426	1	25.4	.0005	0.01	.001	0.03	8mm	M2.5 x 0.45
3900B-5	62421	.5	12.7	.0005	0.01	.001	0.03	3/8"	#4-48
3900MB-5	62423	.5	12.7	.0005	0.01	.001	0.03	8mm	M2.5 x 0.45
3900B-1	62422	1	25.4	.0005	0.01	.001	0.03	3/8"	#4-48
3900MB-25	62427	1	25.4	.0005	0.01	.001	0.03	8mm	M2.5 x 0.45
Accessory									
Part No.	EDP	Description							
PT99492	65650	CR2032 Lithium 3 Volt Battery (Pack of 2)							
1403-25N	62443	End Node for Wireless Data Collection with DataSure 4.0							
3900USB-0	62459	3900B Indicator Cable Set							

2700 GROUP 1 DIGITAL INDICATORS

AGD GROUP 1

The 2700 AGD Group 1 Digital Indicator is the only electronic indicator with true Group 1 dimensions. Applications that traditionally applied mechanical dial indicators can now be replaced with electronic indication. This enables the existing application to become more flexible by outputting data, setting tolerances, increasing resolution, and all other benefits of electronic indication.

FEATURES

- 270 degree Rotating Bezel
- Small Diameter - A dimensional match to AGD Group 1 mechanical indicators (1.700"/43mm)
- Two Available Displays - Single LCD Numeric IQ model (largest of its class) with low battery warning and programmable ratios or Numeric/Analog AD model showing its two displays simultaneously
- .400" travel
- Store and view 200 readings internally, or download with included software and USB style cable
- Compatible with Starrett DataSure® wireless (contact Starrett)
- Long battery life with one CR232 cell battery (3,000 hours under typical use) or connect using a PC



Inch/Metric - 8mm Stem - M2.5 x 0.45 Thread							
Cat. No.	EDP	Range		Resolution		Accuracy	
F2715IQ	72970	in	mm	in	mm	in	mm
F2715AD	72971	0.4	10	.001/.0005/.0001/.00005	0.02/0.01/0.002/0.001	±.0001	±0.002
		0.4	10	.001/.0005/.0001/.00005	0.02/0.01/0.002/0.001	±.0001	±0.002

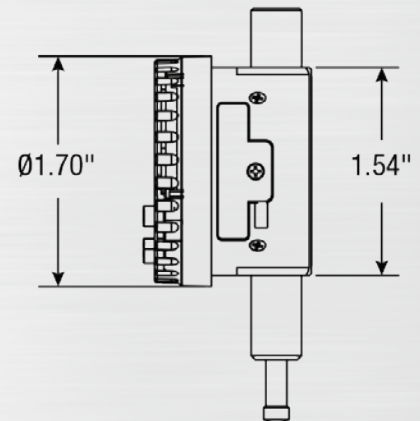
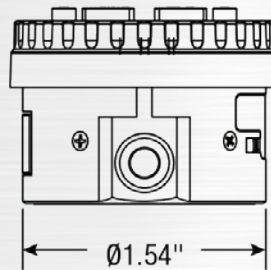
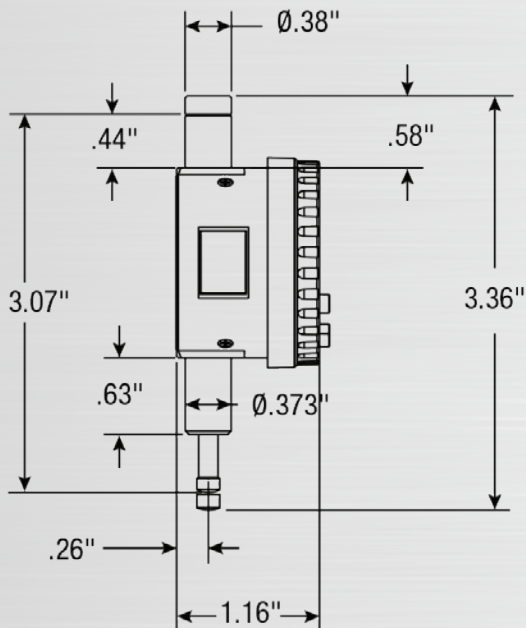

2700 BACKLIGHT INDICATORS

The 2700 Backlight Indicators are offered in 1", 2" and 4" ranges. The deep backlight color indicates tolerances and allows the indicator to be easily read at far distances, in poor lighting and with limited operator experience.



FEATURES

- Backlight relates a reading to tolerance values
- SPC Cables, USB, MTI, RS232
- Inch/metric display
- Travel reverse
- Maximum reading hold
- Single gage simple data collection software included
- Floating zero
- Minimum reading hold
- Abs./preset measuring mode
- T.I.R. with low and high storage recall
- USB/AC power cable included
- Lock combination



Cat. No.	EDP	Range	SPC Output	Accuracy	Resolution
2700-800	72689	1"	x	(±) 2. Res.	.0001"
2700-801	72690	1"	x	(±) 2. Res.	.000050"
2700-802	72691	2"	x	(±) 2. Res.	.0005"
2700-803	72692	2"	x	(±) 2. Res.	.0001"
2700-804	72693	4"	x	(±) 2. Res.	.0005"
2700-805	72694	4"	x	(±) 2. Res.	.0001"
Accessories, Power Source, Cables					
Part No.	EDP	Description			
PT60646	72592	Cable to SPC computer, not foul switch			
2700SCKB	69891	SmartCable with USB 2.0 for 2700 Micrometer with foul switch and built-in wedge			
2700SCU	23956	USB Cable, 2700 Series			
Backs/Lever*					
Part No.	EDP	Description			
PT26406	65886	Flat back			
PT26407	65887	Offset lug back			
PT26411	65891	Adjustable lug back			
PT26408	65888	Adjustable back			
PT26409	65889	Post-type back			
PT26410	65890	Screw bracket back			
PT26848	66293	Adjustable mounting bracket back			
PT26405	65885	Lifting lever			

*Other backs, styles and accessories also available by request.

2900, W2900 ELECTRONIC INDICATORS

1/2"-4" / 12MM/100MM

The 2900 Indicator is available in a choice of configurations to meet a wide range of requirements. Innovative True Absolute Sensor Technology minimizes the chance of data loss for exceptional reliability. Built with IP67 protection and renowned Starrett quality, they maintain their reliability in hostile shop environments. W2900 models include built-in wireless functionality for data collection.



Catalog Number	2900-1	2900-6	2900-1-1	2900-3-1	2900-5-1	2900-6-1	2900-1-2	2900-6-2
EDP	09980	09985	09960	09963	09967	09969	72676	72678
Wireless Version Catalog Number	W2900-1	W2900-6	W2900-1-1	W2900-3-1	W2900-5-1	W2900-6-1	W2900-1-2	W2900-6-2
Wireless Version EDP	60730	60731	60750	73347	73349	60798	60799	60846
Range								
.500" / 12mm	X	X						
1" / 25mm			X	X	X	X		
2" / 50mm							X	X
4" / 100mm								
Resolution								
.00005"/0.001mm	X		X				X	
.0005"/0.01mm				X	X			
.0005/.0001/.00005"/0.01/0.001mm		X				X		X
Accuracy								
+/- .00012"	X	X	X			X	X	X
+/- 0.003mm	X	X	X			X	X	X
+/- .001"/0.03mm				X	X			
Mechanical Features								
.375" Stem - #4-48 UNF Thread	X	X	X	X	X	X	X	X
8mm Stem - M2.5 x 0.45 Thread								
Lug & Flat Back	X	X	X	X	X	X	X	X
Absolute Sensor	X	X	X			X	X	X
RS232 Data Output*	X	X	X	X	X	X	X	X
*Indicators with a "W" are wireless and do not have RS232 Data Output								
1/2" tall characters	X	X	X	X	X	X	X	X
Dust Cap	X	X	X	X	X	X	X	X
Rechargeable Battery	X	X	X	X	X	X	X	X
IP67	X	X	X	X	X	X	X	X
Electronic Features								
Limit Set		X			X	X		X
Origin Set, Zero Set	X	X	X	X	X	X	X	X
Counting Direction +/-	X	X	X	X	X	X	X	X
Power On/Off	X	X	X	X	X	X	X	X
Inch/Metric Conversation	X	X	X	X	X	X	X	X
URS232 Cable for Data*	X	X	X	X	X	X	X	X
USB Cable and Cube for Charging	X	X	X	X	X	X	X	X
Preset		X				X		X
TIR with Max/Min display		X				X		X
Max/Min Freeze Hold		X				X		X
Feature Lock		X				X		X
Selectable Resolution		X				X		X
Low Battery Warning	X	X	X	X	X	X	X	X
Easy Exit Programming	X	X	X	X	X	X	X	X
270 Degree Bezel Rotation	X	X	X	X	X	X	X	X

*Applies to non-wireless 2900 Indicators only

FEATURES

- Intuitive design and layout - easy to learn and use
- Positive, tactile-feel button activation
- Rechargeable battery
- Data output on all models
- Choice of Basic, Standard and Advanced feature levels
- One micron resolution available
- Selectable resolution models available and fixed ratio measurement systems available
- Inch/millimeter conversion
- Metric-only versions available
- Lug-on center back (also ships with flat back)
- Compatible with Starrett 25 Series Indicator backs
- IP67
- Origin set, zero set
- Auto-off after 20 minutes of non-use
- True Absolute Sensor Technology, -1 & -6 models only
- W2900 Models: Embedded radio allows to send data up to 30' with no end nodes or cables

[illegible]



Catalog Number	2900-1M	-	2900-1M-25	2900-3M-25	2900-5M-25	2900-6M-25	2900-1M-50	2900-6M-50
EDP	09986	-	09961	09964	09968	09970	72680	72684
Wireless Version Catalog Number	W2900-1M	W2900-6M	W2900-1M-25	W2900-3M-25	W2900-5M-25	W2900-6M-25	W2900-1M-50	W2900-6M-50
Wireless Version EDP	62224	62225	62226	73348	73378	62227	62228	62229
Range								
.500" / 12mm	X	X						
1" / 25mm			X	X	X	X		
2" / 50mm							X	X
4" / 100mm								
Resolution								
.00005"/0.001mm	X		X				X	
.0005"/0.01mm				X	X			
.0005/.0001/.00005"/0.01/0.001mm		X				X		X
Accuracy								
+/- .00012"								
+/- 0.003mm	X		X			X	X	X
+/- .001"/0.03mm								
Mechanical Features								
.375" Stem - #4-48 UNF Thread								
8mm Stem - M2.5 x 0.45 Thread	X	X	X	X	X	X	X	X
Lug & Flat Back	X	X	X	X	X	X	X	X
Absolute Sensor	X		X	X	X	X	X	X
RS232 Data Output*	X	X	X			X	X	X
*Indicators with a "W" are wireless and do not have RS232 Data Output								
1/2" tall characters	X	X	X	X	X	X	X	X
Dust Cap	X	X	X	X	X	X	X	X
Rechargeable Battery	X	X	X	X	X	X	X	X
IP67	X	X	X	X	X	X	X	X
Electronic Features								
Limit Set		X			X	X		X
Origin Set, Zero Set	X	X	X	X	X	X	X	X
Counting Direction +/-	X	X	X	X	X	X	X	X
Power On/Off	X	X	X	X	X	X	X	X
Inch/Metric Conversation								
URS232 Cable for Data*	X		X	X	X	X	X	X
USB Cable and Cube for Charging	X	X	X	X	X	X	X	X
Preset		X				X		X
TIR with Max/Min display		X				X		X
Max/Min Freeze Hold		X				X		X
Feature Lock		X				X		X
Selectable Resolution		X				X		X
Low Battery Warning	X	X	X	X	X	X	X	X
Easy Exit Programming	X	X	X	X	X	X	X	X
270 Degree Bezel Rotation	X	X	X	X	X	X	X	X

*Applies to non-wireless 2900 Indicators only

Specifications subject to change

W4900-1 TOUCHSCREEN ELECTRONIC INDICATOR



1" / 25MM

The new Starrett W4900-1 Touchscreen Electronic Indicator combines innovation and versatility with unparalleled ease of use. Built for shop floors, quality labs, inspection areas and in-process applications, this highly capable IP67 indicator can also be used in OEM applications on custom build and design tools and machinery.

FEATURES

- Large, easy-to-read and navigate touchscreen user interface
- Wireless SPC output for data collection with DataSure® 4.0
- Compliant with ISO and ANSI/ASME accuracy specifications
- IP67 protection
- Rugged: Built to withstand hazards common to shop floor environments
- Rechargeable battery with long service life
- Customizable auto-off settings
- Analog and digital readouts
- Customizable backlighting function
- Easy-to-navigate settings with multi-option menus for dial configuration, graduation, presets, limits, color options, profiles, rotation, scale factor, and more



**SCAN TO
SEE THE
TOOL IN
ACTION !**

W4900-1 Touchscreen Electronic Indicator

Cat. No.	EDP	Range		Resolution		Accuracy		AGD Group	Spindle Thread	Stem Diameter
		in	mm	in	mm	in	mm			
W4900-1	62424	1	25	.001 / .0005 / .0001 / .00005	0.01 / 0.005 / 0.002 / 0.001	+/- .00012	+/- 0.003	4	#4-48	.375"

HOME SCREEN AND SETTINGS MENU

The Home screen links to the Dial and Digital Indicator screens, the Power Menu and the Settings Menu. The Settings Menu configures many Indicator features.

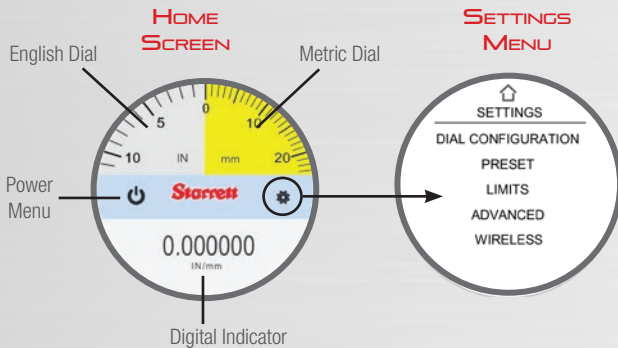

ANALOG AND DIGITAL INDICATORS

The English and Metric Dial Indicators are a faithful digital representation of our customary dial indicators with some helpful digital options.

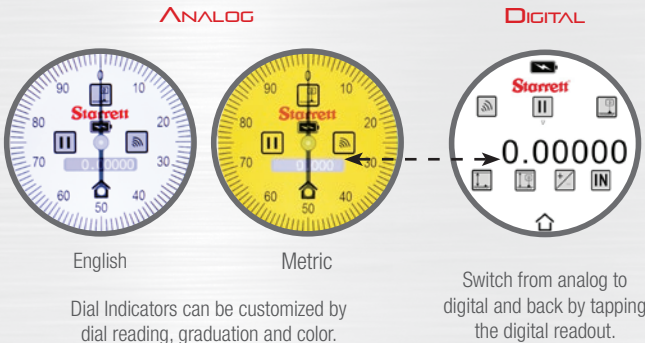

DIAL READING

The Dial Reading Menu provides a range of numerical displays for English or metric.

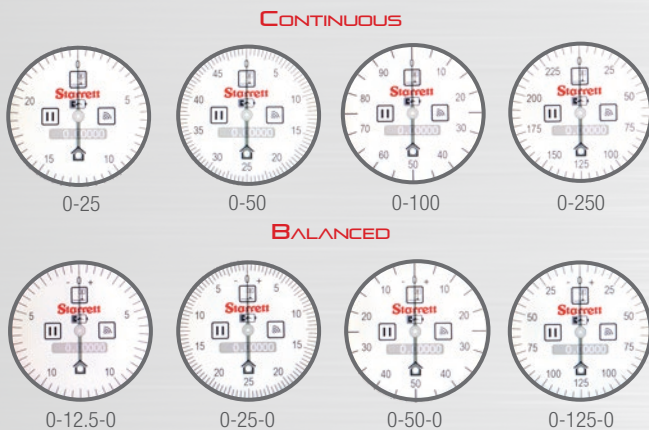

GRADUATION

The Graduation Menu offers selectable resolutions for English or metric.



PRESETS

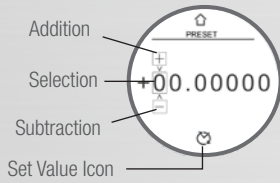

LIMITS

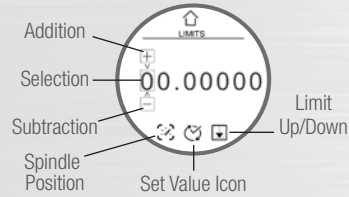

COLOR OPTIONS

Choose from four color options for the Dial Indicator background.



PROFILES



ROTATION

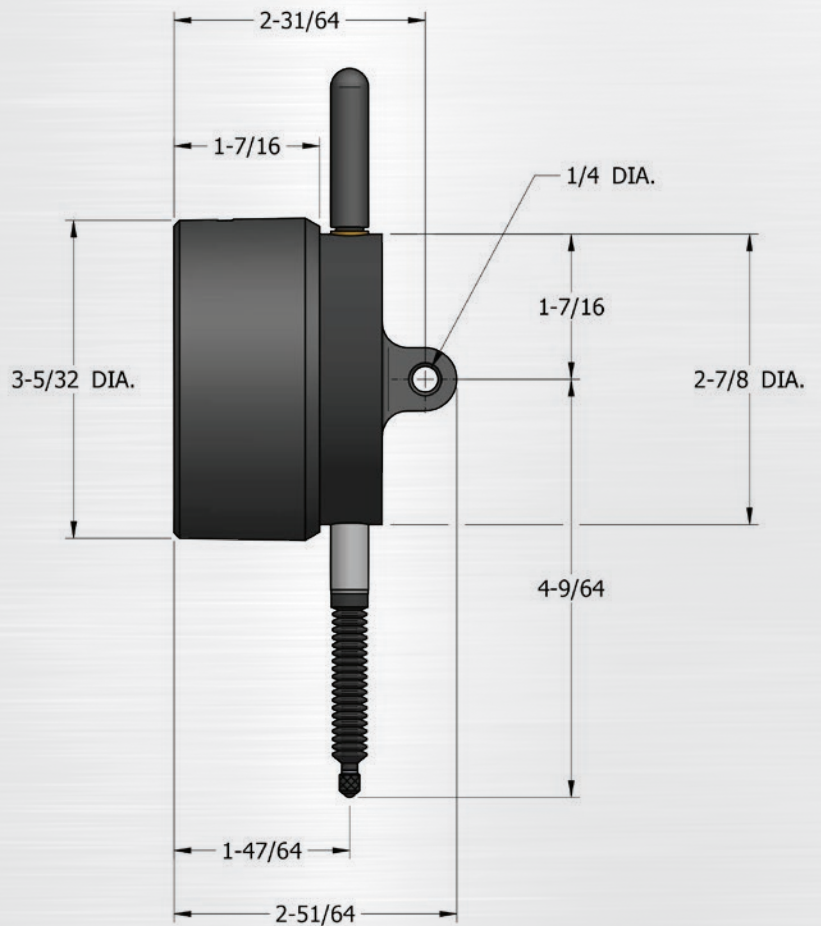
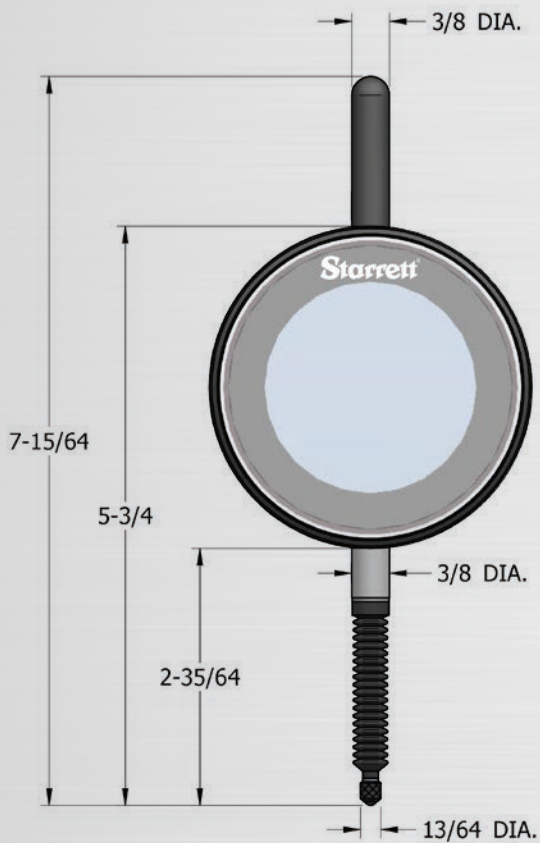

The L.S. Starrett Company
121 Crescent Street
Athol, MA 01332
Tel: 978-249-3551



starrett.com

Electronic Indicator Brochure
Bulletin 450
1.5M/Q 08/24
The L.S. Starrett Company 2024®
Specifications Subject to Change