

Techniks Certified Face Mill Arbors

Manufactured from H13 tool steel for performance and long life.

NEW

Extended Length Face Mill Arbors

- CAT40, CAT50 now up to 12" gauge lengths
- H6 arbor tolerance reduces chatter



CAT40-50, BT30-40-50, HSK63A-100A, R8

- Compatible with all face mills
- Use CoolBLAST arbor screws for high-pressure coolant



DualDRIVE for Dual Contact Spindles

- Techniks Certified for dual contact
- Compatible with standard spindles too



View the DualDRIVE video for face mill arbors.
<http://ow.ly/sUOqL>



CAT40 Precision Face Mill Arbors



Techniks Certified for accuracy

Features

- Compatible with all face mills
- H6 arbor tolerance for less chatter & better tool life
- Taper ground to AT3 tolerance or better



Arbor
Screws
pg. 128



Tightening
Stands
pg. 234



Retention
Knobs
pg. 228



Wrenches
pg. 232

CoolBLAST Coolant Option

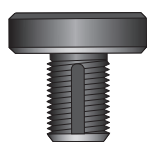

CoolBLAST arbor screw
provides coolant path.
Order on page 128.

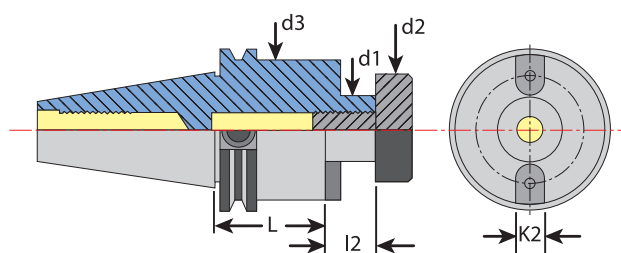

CAT40 Face Mill Arbors

Part No.	Description	L	l2	d1	d2	d3	K2	Screw	Key
22709	CAT40 x FMA 1/2" - 1.37"	1.37"	.55"	1/2"	.66"	1.45"	.25"	WF0.5	FMAKEY-1/2
22709-4	CAT40 x FMA 1/2" - 4"	4"	.55"	1/2"	.66"	1.45"	.25"	WF0.5	FMAKEY-1/2
22711	CAT40 x FMA 3/4" - 1.37"	1.37"	.69"	3/4"	.88"	1.69"	.31"	WF0.75	FMAKEY-3/4
22711-4	CAT40 x FMA 3/4" - 4.0"	4"	.69"	3/4"	.88"	1.69"	.31"	WF0.75	FMAKEY-3/4
22711-6	CAT40 x FMA 3/4" - 6.0"	6"	.69"	3/4"	.88"	1.69"	.31"	WF0.75	FMAKEY-3/4
NEW 22711-8	CAT40 x FMA 3/4" - 8.0"	8"	.69"	3/4"	.88"	1.69"	.31"	WF0.75	FMAKEY-3/4
22713	CAT40 x FMA 1.0" - 2.06"	2.06"	.69"	1.0"	1.19"	2.2"	.38"	WF1	FMAKEY-1
22713-4	CAT40 x FMA 1.0" - 4.0"	4"	.69"	1.0"	1.19"	2.2"	.38"	WF1	FMAKEY-1
22713-6	CAT40 x FMA 1.0" - 6.0"	6"	.69"	1.0"	1.19"	2.2"	.38"	WF1	FMAKEY-1
NEW 22713-8	CAT40 x FMA 1.0" - 6.0"	8"	.69"	1.0"	1.19"	2.2"	.38"	WF1	FMAKEY-1
22715	CAT40 x FMA 1-1/4" - 2.21"	2.21"	.69"	1-1/4"	1.5"	2.75"	.5"	WF1.25	FMAKEY-1-1/4
22715-4	CAT40 x FMA 1-1/4" - 4.0"	4"	.69"	1-1/4"	1.5"	2.75"	.5"	WF1.25	FMAKEY-1-1/4
22715-6	CAT40 x FMA 1-1/4" - 6.0"	6"	.69"	1-1/4"	1.5"	3."	.5"	WF1.25	FMAKEY-1-1/4
NEW 22715-8	CAT40 x FMA 1-1/4" - 8.0"	8"	.69"	1-1/4"	1.5"	3."	.5"	WF1.25	FMAKEY-1-1/4
22717	CAT40 x FMA 1-1/2" - 2.21"	2.21"	.94"	1-1/2"	1.88"	3.8"	.63"	WF1.5	FMAKEY-1-1/2
22717-4	CAT40 x FMA 1-1/2" - 4"	4"	.94"	1-1/2"	1.88"	3.8"	.63"	WF1.5	FMAKEY-1-1/2

All Techniks Face Mill Arbors come with the solid arbor screw and key listed.

CAT40 DualDRIVE for Dual-Contact Spindles



Techniks Certified for accuracy

Features

- Techniks Certified for dual-contact spindles
- Compatible with all face mills
- H6 arbor tolerance for less chatter & better tool life

Benefits

- Better rigidity and reduced vibration
- Improved performance at high metal removal rates and when machining at extended lengths

CoolBLAST Coolant Option

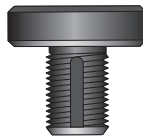

CoolBLAST arbor screw provides coolant path. Order on page 128.

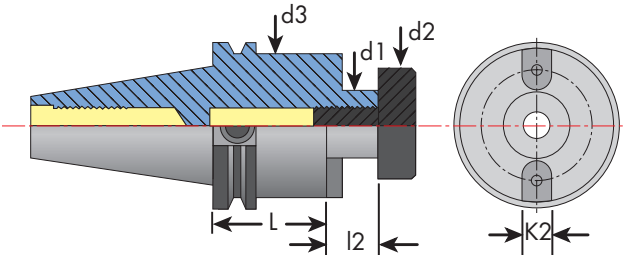

CAT40 DualDRIVE Face Mill Arbors

Part No.	Description	L	l2	d1	d2	d3	K2	Screw	Key
43.151.64.137	CAT40 x FMA 3/4" - 1.37" DualDRIVE	1.37"	.69"	3/4"	.88"	1.69"	.31"	WF0.75	FMAKEY-3/4
43.151.64.400	CAT40 x FMA 3/4" - 4" DualDRIVE	4"	.69"	3/4"	.88"	1.69"	.31"	WF0.75	FMAKEY-3/4
43.151.64.600	CAT40 x FMA 3/4" - 6" DualDRIVE	6"	.69"	3/4"	.88"	1.69"	.31"	WF0.75	FMAKEY-3/4
43.151.68.206	CAT40 x FMA 1.0" - 2.06" DualDRIVE	2.06"	.69"	1.0"	1.19"	2.2"	.38"	WF1	FMAKEY-1
43.151.68.400	CAT40 x FMA 1.0" - 4" DualDRIVE	4"	.69"	1.0"	1.19"	2.2"	.38"	WF1	FMAKEY-1
43.151.68.600	CAT40 x FMA 1.0" - 6" DualDRIVE	6"	.69"	1.0"	1.19"	2.2"	.38"	WF1	FMAKEY-1
43.151.72.221	CAT40 x FMA 1-1/4" - 2.21" DualDRIVE	2.21"	.69"	1-1/4"	1.5"	2.75"	.5"	WF1.25	FMAKEY-1-1/4
43.151.72.400	CAT40 x FMA 1-1/4" - 4" DualDRIVE	4"	.69"	1-1/4"	1.5"	2.75"	.5"	WF1.25	FMAKEY-1-1/4
43.151.72.600	CAT40 x FMA 1-1/4" - 6" DualDRIVE	6"	.69"	1-1/4"	1.5"	3"	.5"	WF1.25	FMAKEY-1-1/4
43.151.77.221	CAT40 x FMA 1-1/2" - 2.21" DualDRIVE	2.21"	.94"	1-1/2"	1.88"	3.8"	.63"	WF1.5	FMAKEY-1-1/2
43.151.77.400	CAT40 x FMA 1-1/2" - 4" DualDRIVE	4"	.94"	1-1/2"	1.88"	3.8"	.63"	WF1.5	FMAKEY-1-1/2

All Techniks Face Mill Arbors come with the solid arbor screw and key listed.

Dual-Contact Spindles

Use Techniks DualDRIVE holders if your machine has a dual-contact spindle. Dual-Contact is a spindle option offered by some machine tool builders.

Dual-contact means both the toolholder taper and the flange make contact with the spindle. Dual-contact increases rigidity and accuracy during machining.

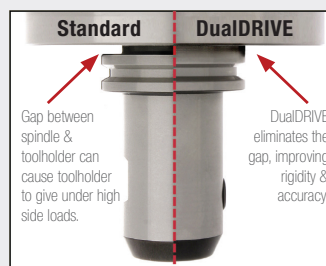

See our demonstration video of DualDRIVE at: <http://ow.ly/sUOqL>



CAT50 Precision Face Mill Arbors



Techniks Certified for accuracy

Features

- Compatible with all face mills
- H6 arbor tolerance for less chatter & better tool life
- Taper ground to AT3 tolerance or better



Arbor
Screws
pg. 128



Tightening
Stands
pg. 234



Retention
Knobs
pg. 228



Wrenches
pg. 232

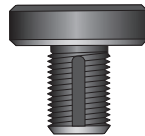

CoolBLAST arbor screw
provides coolant path.
Order on page 128.

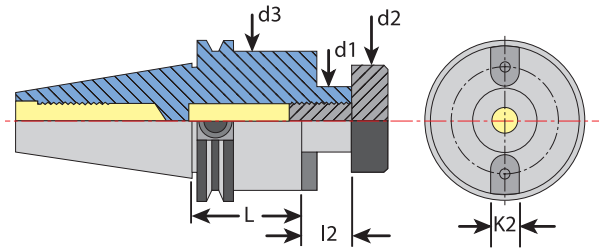

CAT50 Face Mill Arbors

Part No.	Description	L	I2	d1	d2	d3	K2	Screw	Key
22719	CAT50 x FMA 1/2" - 1.5"	1.5"	.055"	1/2"	.66"	1.45"	.25"	WF0.5	FMAKEY-1/2
22721	CAT50 x FMA 3/4" - 1.5"	1.5"	.69"	3/4"	.88"	2.75"	.31"	WF0.75	FMAKEY-3/4
22721-3.5	CAT50 x FMA 3/4" - 3.5"	3.5"	.69"	3/4"	.88"	1.69"	.31"	WF0.75	FMAKEY-3/4
22721-5.5	CAT50 x FMA 3/4" - 5.5"	5.5"	.69"	3/4"	.88"	1.69"	.31"	WF0.75	FMAKEY-3/4
NEW 22721-8	CAT50 x FMA 3/4" - 8"	8"	.69"	3/4"	.88"	1.69"	.31"	WF0.75	FMAKEY-3/4
NEW 22721-10	CAT50 x FMA 3/4" - 10"	10"	.69"	3/4"	.88"	1.69"	.31"	WF0.75	FMAKEY-3/4
NEW 22721-12	CAT50 x FMA 3/4" - 12"	12"	.69"	3/4"	.88"	1.69"	.31"	WF0.75	FMAKEY-3/4
22723	CAT50 x FMA 1" - 2.0"	2.0"	.69"	1.0"	1.19"	2.2"	.38"	WF1	FMAKEY-1
22723-4	CAT50 x FMA 1" - 4.0"	4"	.69"	1.0"	1.19"	2.2"	.38"	WF1	FMAKEY-1
22723-6	CAT50 x FMA 1" - 6.0"	6"	.69"	1.0"	1.19"	2.2"	.38"	WF1	FMAKEY-1
22723-8	CAT50 x FMA 1" - 8.0"	8"	.69"	1.0"	1.19"	2.2"	.38"	WF1	FMAKEY-1
NEW 22723-10	CAT50 x FMA 1" - 10.0"	10"	.69"	1.0"	1.19"	2.2"	.38"	WF1	FMAKEY-1
NEW 22723-12	CAT50 x FMA 1" - 12.0"	12"	.69"	1.0"	1.19"	2.2"	.38"	WF1	FMAKEY-1
22725	CAT50 x FMA 1-1/4" - 1.50"	1.5"	.69"	1-1/4"	1.5"	2.75"	.5"	WF1.25	FMAKEY-1-1/4
22725-3.5	CAT50 x FMA 1-1/4" - 3.5"	3.5"	.69"	1-1/4"	1.5"	2.75"	.5"	WF1.25	FMAKEY-1-1/4
22725-6	CAT50 x FMA 1-1/4" - 6.0"	6"	.69"	1-1/4"	1.5"	2.75"	.5"	WF1.25	FMAKEY-1-1/4
22725-8	CAT50 x FMA 1-1/4" - 8.0"	8"	.69"	1-1/4"	1.5"	2.75"	.5"	WF1.25	FMAKEY-1-1/4
NEW 22725-10	CAT50 x FMA 1-1/4" - 10.0"	10"	.69"	1-1/4"	1.5"	2.75"	.5"	WF1.25	FMAKEY-1-1/4
NEW 22725-12	CAT50 x FMA 1-1/4" - 12.0"	12"	.69"	1-1/4"	1.5"	2.75"	.5"	WF1.25	FMAKEY-1-1/4
22727	CAT50 x FMA 1-1/2" - 2.4"	2.4"	.94"	1-1/2"	1.88"	3.8"	.63"	WF1.5	FMAKEY-1-1/2
22727-4	CAT50 x FMA 1-1/2" - 4.0"	4"	.94"	1-1/2"	1.88"	3.8"	.63"	WF1.5	FMAKEY-1-1/2
22727-6	CAT50 x FMA 1-1/2" - 6.0"	6"	.94"	1-1/2"	1.88"	3.8"	.63"	WF1.5	FMAKEY-1-1/2
22727-8	CAT50 x FMA 1-1/2" - 8.0"	8"	.94"	1-1/2"	1.88"	3.8"	.63"	WF1.5	FMAKEY-1-1/2
22729	CAT50 x FMA 2" - 2.4"	2.4"	.94"	2"	2.5"	4.88"	.75"	WF2	FMAKEY-2
22729-4	CAT50 x FMA 2" - 4.0"	4"	.94"	2"	2.5"	4.88"	.75"	WF2	FMAKEY-2

All Techniks Face Mill Arbors come with the solid arbor screw and key listed.

CAT50 DualDRIVE for Dual-Contact Spindles



Techniks Certified for accuracy

Features

- Designed for dual-contact spindles
- Compatible with all face mills
- H6 arbor tolerance for less chatter & better tool life

Benefits

- Better rigidity and reduced vibration
- Improved performance at high metal removal rates and when machining at extended lengths

CoolBLAST Coolant Option

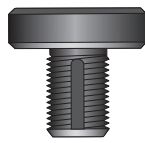

CoolBLAST arbor screw provides coolant path. Order on page 128.

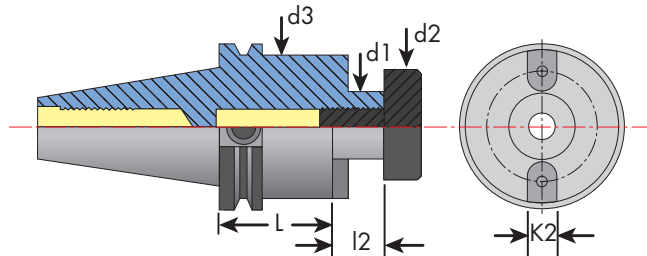

CAT50 DualDRIVE Face Mill Arbors

Part No.	Description	L	l2	d1	d2	d3	K2	Screw	Key
44.151.64.150	CAT50 x FMA 3/4" - 1.5" DualDRIVE	1.5"	.69"	3/4"	.88"	2.75"	.31"	WF0.75	FMAKEY-3/4
44.151.64.350	CAT50 x FMA 3/4" - 3.5" DualDRIVE	3.5"	.69"	3/4"	.88"	1.69"	.31"	WF0.75	FMAKEY-3/4
44.151.64.550	CAT50 x FMA 3/4" - 5.5" DualDRIVE	5.5"	.69"	3/4"	.88"	1.69"	.31"	WF0.75	FMAKEY-3/4
44.151.68.200	CAT50 x FMA 1.0" - 2" DualDRIVE	2"	.69"	1.0"	1.19"	2.2"	.38"	WF1	FMAKEY-1
44.151.68.400	CAT50 x FMA 1.0" - 4" DualDRIVE	4"	.69"	1.0"	1.19"	2.2"	.38"	WF1	FMAKEY-1
44.151.68.600	CAT50 x FMA 1.0" - 6" DualDRIVE	6"	.69"	1.0"	1.19"	2.2"	.38"	WF1	FMAKEY-1
44.151.72.150	CAT50 x FMA 1-1/4" - 1.5" DualDRIVE	1.5"	.69"	1-1/4"	1.5"	2.75"	.5"	WF1-1/4	FMAKEY-1-1/4
44.151.72.350	CAT50 x FMA 1-1/4" - 3.5" DualDRIVE	3.5"	.69"	1-1/4"	1.5"	2.75"	.5"	WF1-1/4	FMAKEY-1-1/4
44.151.72.600	CAT50 x FMA 1-1/4" - 6" DualDRIVE	6"	.69"	1-1/4"	1.5"	2.75"	.5"	WF1-1/4	FMAKEY-1-1/4
44.151.77.240	CAT50 x FMA 1-1/2" - 2.4" DualDRIVE	2.4"	.94"	1-1/2"	1.88"	3.8"	.63"	WF1-1/2	FMAKEY-1-1/2
44.151.77.400	CAT50 x FMA 1-1/2" - 4" DualDRIVE	4"	.94"	1-1/2"	1.88"	3.8"	.63"	WF1-1/2	FMAKEY-1-1/2
44.151.77.600	CAT50 x FMA 1-1/2" - 6" DualDRIVE	6"	.94"	1-1/2"	1.88"	3.8"	.63"	WF1-1/2	FMAKEY-1-1/2
44.151.77.800	CAT50 x FMA 1-1/2" - 8" DualDRIVE	8"	.94"	1-1/2"	1.88"	3.8"	.63"	WF1-1/2	FMAKEY-1-1/2
44.151.86.240	CAT50 x FMA 2" - 2.4" DualDRIVE	2.4"	.94"	2"	2.5"	4.88"	.75"	WF2	FMAKEY-2
44.151.86.400	CAT50 x FMA 2" - 4" DualDRIVE	4"	.94"	2"	2.5"	4.88"	.75"	WF2	FMAKEY-2

All Techniks Face Mill Arbors come with the solid arbor screw and key listed.

Dual-Contact Spindles

Use Techniks DualDRIVE holders if your machine has a dual-contact spindle. Dual-Contact is a spindle option offered by some machine tool builders.

Dual-contact means both the toolholder taper and the flange make contact with the spindle. Dual-contact increases rigidity and accuracy during machining.

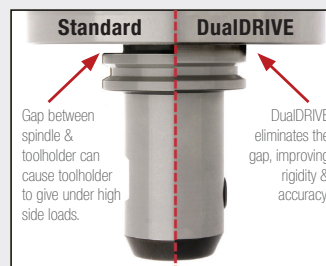

See our demonstration video of DualDRIVE at: <http://ow.ly/sUOqL>



BT30 Arbors & DualDRIVE for Dual-Contact Spindles



Techniks Certified for accuracy

CoolBLAST Coolant Option

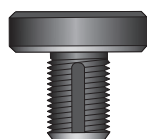
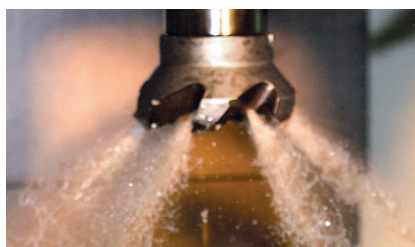

CoolBLAST arbor screw provides coolant path. Order on page 128.

Features

- H6 arbor tolerance for less chatter & better tool life
- Each arbor lab certified for accuracy
- Taper ground to AT3 tolerance for maximum spindle contact



Arbor Screws
pg. 128



Tightening Stands
pg. 234



Retention Knobs
pg. 228



Wrenches
pg. 232

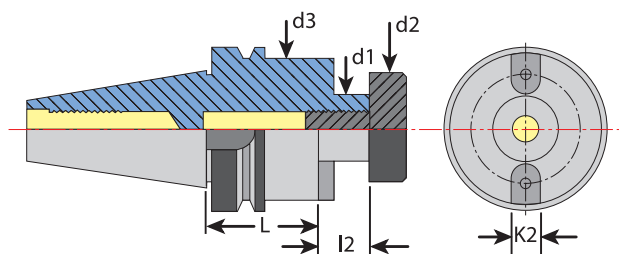

BT30 Precision Face Mill Arbors

Part No.	Description	L	l2	d1	d2	d3	K2	Screw	Key
16611	BT30 x FMA 3/4" - 1.18"	1.18"	.69"	3/4"	.88"	1.66"	.313"	WF0.75	FMAKEY-3/4
16612	BT30 x FMA 1" - 1.77"	1.77"	.69"	1.0"	1.18"	2.2"	.375"	WF1	FMAKEY-1
16614	BT30 x FMA 1-1/4" - 1.77"	1.77"	.87"	1-1/4"	1.5"	2.37"	.5"	WF1.25	FMAKEY-1-1/4

All Techniks Face Mill Arbors come with the solid arbor screw and key listed.



Techniks Certified for accuracy

BT30 DualDRIVE Face Mill Arbors

Part No.	Description d1 – l1	L	l2	d1	d2	d3	K2	Screw	Key
25.151.64.200	BT30 x DualDRIVE FMA 3/4" - 2"	2"	.69"	3/4"	.88"	1.66"	.313"	WF0.75	FMAKEY-3/4
25.151.68.200	BT30 x DualDRIVE FMA 1.0" - 2"	2"	.69"	1.0"	1.18"	2.2"	.375"	WF1	FMAKEY-1

All Techniks Face Mill Arbors come with the solid arbor screw and key listed.

Features

- Designed for dual-contact spindles
- Compatible with all face mills
- H6 arbor tolerance for less chatter & better tool life

Benefits

- Better rigidity and reduced vibration (chatter)
- Improved performance at high metal removal rates and when machining at extended lengths

Dual-Contact Spindles

Use Techniks DualDRIVE holders if your machine has a dual-contact spindle. Dual-Contact is a spindle option offered by some machine tool builders.

Dual-contact means both the toolholder taper and the flange make contact with the spindle. Dual-contact increases rigidity and accuracy during machining.

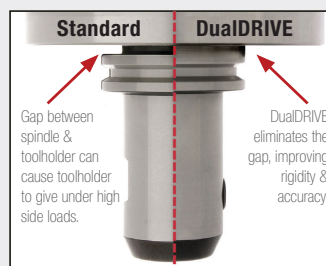

See our demonstration video of DualDRIVE at:
<http://ow.ly/sUOqL>

BT40, BT50 Precision Face Mill Arbors



Techniks Certified for accuracy

Features

- Compatible with all face mills
- H6 arbor tolerance for less chatter & better tool life
- Taper ground to AT3 tolerance or better



Arbor
Screws
pg. 128



Tightening
Stands
pg. 234



Retention
Knobs
pg. 228



Wrenches
pg. 232

CoolBLAST Coolant Option

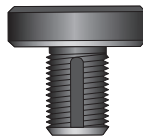

CoolBLAST arbor screw
provides coolant path.
Order on page 128.

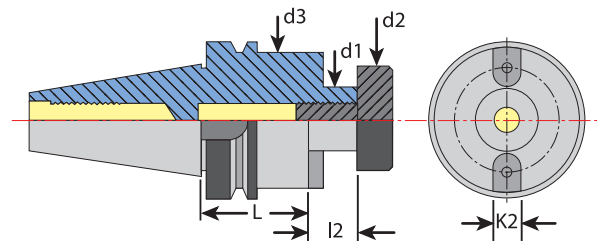

BT40 Face Mill Arbors

Part No.	Description	L	l2	d1	d2	d3	K2	Screw	Key
16615-3/4	BT40 x FMA 3/4" - 1"	1.0"	.69"	3/4"	.88"	1.69"	.313"	WF0.75	FMAKEY-3/4
16615-4	BT40 x FMA 3/4" - 4.0"	4"	.69"	3/4"	.88"	1.69"	.313"	WF0.75	FMAKEY-3/4
16615-6	BT40 x FMA 3/4" - 6.0"	6"	.69"	3/4"	.88"	1.69"	.313"	WF0.75	FMAKEY-3/4
16615	BT40 x FMA 1.0" - 1.77"	1.77"	.69"	1.0"	1.18"	2.2"	.375"	WF1	FMAKEY-1
16617	BT40 x FMA 1.0" - 3.54"	3.54"	.69"	1.0"	1.18"	2.2"	.375"	WF1	FMAKEY-1
16620	BT40 x FMA 1-1/4" - 1.77"	1.77"	.69"	1-1/4"	1.5"	2.75"	.5"	WF1.25	FMAKEY-1-1/4
16620-4	BT40 x FMA 1-1/4" - 4"	4"	.69"	1-1/4"	1.5"	2.75"	.5"	WF1.25	FMAKEY-1-1/4
16626	BT40 x FMA 1-1/2" - 2.36"	2.36"	.94"	1-1/2"	1.88"	3.8"	.625"	WF1.5	FMAKEY-1-1/2

All Techniks Face Mill Arbors come with the solid arbor screw and key listed.

BT50 Face Mill Arbors

Part No.	Description	L	l2	d1	d2	d3	K2	Screw	Key
16639	BT50 x 1.0" - 1.77"	1.77"	.79"	1.0"	1.19"	1.97"	.375"	WF1	FMAKEY-1
16639-3	BT50 x 1.0" - 3"	3"	.79"	1.0"	1.19"	1.97"	.375"	WF1	FMAKEY-1
16642	BT50 x 1-1/4" - 1.77"	1.77"	.87"	1-1/4"	1.5"	2.34"	.5"	WF1.25	FMAKEY-1-1/4
16645	BT50 x 1-1/2" - 1.77"	1.77"	.94"	1-1/2"	1.88"	3.8"	.625"	WF1.5	FMAKEY-1-1/2
16646	BT50 x 1-1/2" - 75mm	75mm	.94"	1-1/2"	1.88"	3.8"	.625"	WF1.5	FMAKEY-1-1/2
16646-105	BT50 x 1-1/2" - 105mm	105mm	.94"	1-1/2"	1.88"	3.8"	.625"	WF1.5	FMAKEY-1-1/2
16646-150	BT50 x 1-1/2" - 150mm	150mm	.94"	1-1/2"	1.88"	3.8"	.625"	WF1.5	FMAKEY-1-1/2
16648	BT50 x 2.0" - 2.95"	2.95"	.94"	2"	3.13"	4.88"	.75"	WF2	FMAKEY-2

All Techniks Face Mill Arbors come with the solid arbor screw and key listed.



We stand behind all our products with our 100% Satisfaction Guarantee • www.techniksusa.com

HSK63A and HSK63F Precision Face Mill Arbors



Techniks Certified for accuracy

Features

- Compatible with all face mills
- H6 arbor tolerance for less chatter & better tool life
- Taper ground to AT3 tolerance or better



Arbor
Screws
pg. 128



Tightening
Stands
pg. 234



Retention
Knobs
pg. 228



Wrenches
pg. 232

CoolBLAST Coolant Option

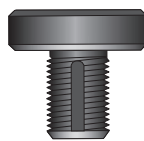

CoolBLAST arbor screw provides coolant path. Order on page 128.

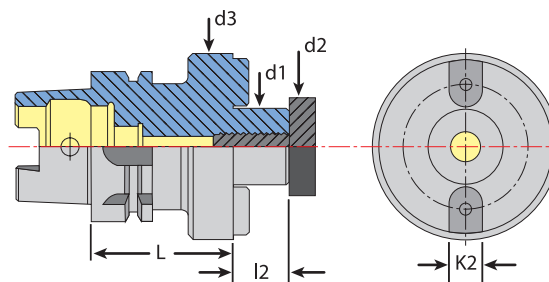

HSK63A Face Mill Arbors Standard and Extended Lengths

Part No.	Description	L	l2	d1	d2	d3	K2	Screw	Key
93500	HSK63A x FMA 3/4" - 2"	2"	.687"	.75"	.875"	1.69"	.313"	WF0.75	FMAKEY-3/4
93510	HSK63A x FMA 3/4" - 4"	4"	.687"	.75"	.875"	1.69"	.313"	WF0.75	FMAKEY-3/4
NEW 93510-8	HSK63A x FMA 3/4" - 8"	8"	.687"	.75"	.875"	1.69"	.313"	WF0.75	FMAKEY-3/4
93501	HSK63A x FMA 1.0" - 2.37"	2.37"	.687"	1.0"	1.24"	2.2"	.375"	WF1	FMAKEY-1
93520	HSK63A x FMA 1.0" - 4"	4"	.687"	1.0"	1.24"	2.2"	.375"	WF1	FMAKEY-1
NEW 93520-6	HSK63A x FMA 1.0" - 6"	6"	.687"	1.0"	1.24"	2.2"	.375"	WF1	FMAKEY-1
NEW 93520-8	HSK63A x FMA 1.0" - 8"	8"	.687"	1.0"	1.24"	2.2"	.375"	WF1	FMAKEY-1
93502	HSK63A x FMA 1-1/4" - 2.75"	2.75"	.687"	1.25"	1.5"	2.75	.5"	WF1.25	FMAKEY-1-1/4
93530	HSK63A x FMA 1-1/4" - 4"	4"	.687"	1.25"	1.5"	2.75	.5"	WF1.25	FMAKEY-1-1/4
NEW 93530-6	HSK63A x FMA 1-1/4" - 6"	6"	.687"	1.25"	1.5"	2.75	.5"	WF1.25	FMAKEY-1-1/4
NEW 93530-8	HSK63A x FMA 1-1/4" - 8"	8"	.687"	1.25"	1.5"	2.75	.5"	WF1.25	FMAKEY-1-1/4
NEW 93550	HSK63A x FMA 1-1/2" - 4"	4"	.94"	1.5"	1.88"	3.8"	.63"	WF1.5	FMAKEY-1-1/2

All Techniks Face Mill Arbors come with the solid arbor screw and key listed.

HSK63F Face Mill Arbors

Part No.	Description - I.D.	L	l2	d1	d2	d3	K2	Screw	Key
NEW 93510-F	HSK63F x FMA 3/4" - 4.0"	4.0"	.69"	3/4"	.88"	1.69"	.31"	WF0.75	FMAKEY-3/4
NEW 93520-F	HSK63F x FMA 1" - 4.0"	4.0"	.69"	1.0"	1.19"	2.20"	.38"	WF1	FMAKEY-1
NEW 93530-F	HSK63F x FMA 1-1/4" - 4.0"	4.0"	.69"	1-1/4"	1.50"	2.75"	.50"	WF1.25	FMAKEY-1-1/4
NEW 93550-F	HSK63F x FMA 1-1/2" - 4.0"	4.0"	.94"	1-1/2"	1.88"	3.80"	.63"	WF1.5	FMAKEY-1-1/2

All Techniks Face Mill Arbors come with the solid arbor screw and key listed.

HSK100A and R8 Precision Face Mill Arbors



Techniks Certified for accuracy

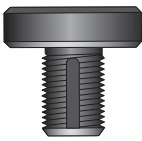

CoolBLAST arbor screw provides coolant path. Order on page 128.

Features

- Compatible with all face mills
- H6 arbor tolerance for less chatter & better tool life
- Taper ground to AT3 tolerance or better



Arbor Screws
pg. 128



Tightening Stands
pg. 234



Retention Knobs
pg. 228



Wrenches
pg. 232

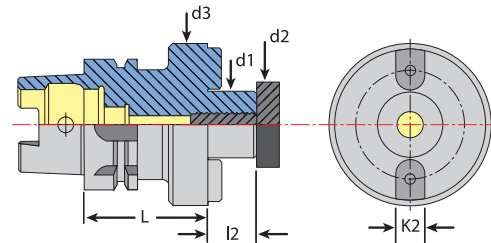

HSK100A Face Mill Arbors

Part No.	Description	L	l2	d1	d2	d3	K2	Screw	Key
95901	HSK100A x FMA 3/4" - 2"	2"	.69"	.75"	.88"	1.69"	.31"	WF0.75	FMAKEY-3/4
NEW 95901-6	HSK100A x FMA 3/4" - 6"	6"	.69"	.75"	.88"	1.69"	.31"	WF0.75	FMAKEY-3/4
95903	HSK100A x FMA 1.0" - 2"	2"	.69"	1.0"	1.19"	2.2"	.38"	WF1	FMAKEY-1
NEW 95903-6	HSK100A x FMA 1.0" - 6"	6"	.69"	1.0"	1.19"	2.2"	.38"	WF1	FMAKEY-1
95905	HSK100A x FMA 1-1/4" - 2.5"	2.5"	.69"	1.25"	1.5"	2.75"	.5"	WF1.25	FMAKEY-1-1/4
NEW 95905-6	HSK100A x FMA 1-1/4" - 6"	6"	.69"	1.25"	1.5"	2.75"	.5"	WF1.25	FMAKEY-1-1/4
95907	HSK100A x FMA 1-1/2" - 2.5"	2.5"	.94"	1.5"	1.88"	3.8"	.63"	WF1.5	FMAKEY-1-1/2
NEW 95907-6	HSK100A x FMA 1-1/2" - 6"	6"	.94"	1.5"	1.88"	3.8"	.63"	WF1.5	FMAKEY-1-1/2

All Techniks Face Mill Arbors come with the solid arbor screw and key listed.



Techniks Certified for accuracy

Features

- Compatible with all face mills
- H6 arbor tolerance for less chatter & better tool life
- Taper ground to AT3 tolerance or better

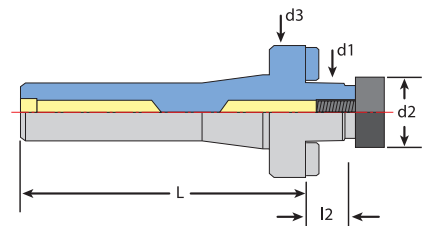

R8 Face Mill Arbors

Part No.	Description	L	l2	d1	d2	d3	K2	Screw	Key
7582401	R8 x FMA - 0.75	4.7"	.675"	.75"	-	1.93	.37"	WF0.75	FMAKEY-3/4
7582402	R8 x FMA - 1.0	4.85"	.85"	1.0"	1.24"	1.81"	.37"	WF1	FMAKEY-1
7582403	R8 x FMA - 1.25	4.90"	.75"	1.25"	1.62"	2.28"	.47"	WF1.25	FMAKEY-1-1/4

All Techniks Face Mill Arbors come with the solid arbor screw and key listed.



CoolBLAST and Standard Face Mill Arbor Screws



CoolBLAST arbor screw provides coolant path.

Features

- Compatible with all face mills
- Works with all Techniks face mill arbors
- For coolant up to 1,500 PSI

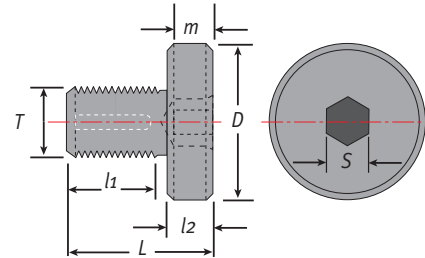

CAT, BT, and HSK CoolBLAST Coolant Arbor Screws

Part No.	Description	Style	Size	D	L	I1	I2	T	S	m
WF.C1-0.5	CoolBLAST arbor screw 1/2"	B	1/2"	5/8"	.84"	.5"	.34"	1/4"-28UNF	3/16"	.157"
WF.C1-0.75	CoolBLAST arbor screw 3/4"	B	3/4"	7/8"	1.8"	1.4"	.37"	3/8"-24UNF	1/4"	.197"
9851125	CAS-A-0.75 smaller "D"	A	3/4"	5/8"	1.375"	1.0"	.36"	3/8"-24UNF	1/4"	.37"
WF.C1-1	CoolBLAST arbor screw 1.0"	B	1.0"	1-3/16"	1.4"	0.81"	.37"	1/2"-20UNF	5/16"	.197"
9851135	CAS-A-1.00 smaller "D"	A	1.0"	3/4"	1.375"	1.0"	.38"	1/2"-20UNF	5/16"	.37"
WF.C1-1.25	CoolBLAST arbor screw 1-1/4"	B	1-1/4"	1-1/2"	1.44"	0.94"	.5"	5/8"-18UNF	5/16"	.236"
WF.C1-1.5	CoolBLAST arbor screw 1-1/2"	B	1-1/2"	1-7/8"	1.63"	1.13"	.5"	3/4"-16UNF	3/8"	.276"
WF.C1-2	CoolBLAST arbor screw 2.0"	B	2"	2-1/2"	1.81"	1.31"	.5"	1.0"-14UNF	1/2"	.354"

Blue indicates coolant.

CAT, BT, and HSK Standard Arbor Screws

Part No.	Description	Arbor Size	D	L	I1	I2	T	S	m
WF0.5	FMA screw 1/2"	1/2"	5/8"	.84"	.5"	.34"	1/4"-28UNF	3/16"	.157"
WF0.75	FMA screw 3/4"	3/4"	7/8"	1.8"	1.4"	.37"	3/8"-24UNF	1/4"	.197"
WF1	FMA screw 1.0"	1.0"	1-3/16"	1.4"	0.81"	.37"	1/2"-20UNF	5/16"	.197"
WF1.25	FMA screw 1-1/4"	1-1/4"	1-1/2"	1.44"	0.94"	.5"	5/8"-18UNF	5/16"	.236"
WF1.5	FMA screw 1-1/2"	1-1/2"	1-7/8"	1.63"	1.13"	.5"	3/4"-16UNF	3/8"	.276"
WF2	FMA screw 2.0"	2"	2-1/2"	1.81"	1.31"	.5"	1.0"-14UNF	1/2"	.354"