

X.treme PLUS

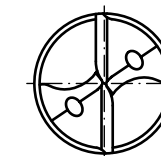

5:1

Characteristics:	
No. of flutes	2
Direction of cut	right
Standard	DIN 6537 L
Shank	DIN 6535-HA 6
Type of tool	X.treme PLUS

Qty.	Description	Det.	Dwg. No.	Material
Proprietary Information DIN ISO 16016:2002-5				Scale: 2:1
We reserve all Rights to this drawing including for the purpose of issuing patents and registration of petty patents. Without our written consent this drawing may not be copied, whole or partially, and may not be misused by the recipient as well as third parties. Any infraction will result in compensation for occurred damages and could lead to legal action by the author.				Format: A3
				Material: K30F
				Surface: DPL
		Date	Name	Description: <b>X.treme PLUS</b> 3.7 28 / 66
		Drawn 21.03.11	Titex	
		Checked		
				Drawing-No.:
				1A3389-5337010 D10
Rev.	Revision	Date	Name	Cust. No.:
				Ord.-Code: A3389DPL-3.7