

X.treme PLUS

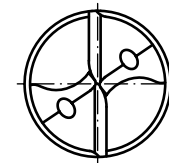

Characteristics:	
No. of flutes	2
Direction of cut	right
Standard	DIN 6537 L
Shank	DIN 6535-HA 10
Type of tool	X.treme PLUS

Qty.	Description	Det.	Dwg. No.	Material	
Proprietary Information DIN ISO 16016:2002-5				Scale: 2:1	Format: A3
We reserve all Rights to this drawing including for the purpose of issuing patents and registration of petty patents. Without our written consent this drawing may not be copied, whole or partially, and may not be misused by the recipient as well as third parties. Any infraction will result in compensation for occurred damages and could lead to legal action by the author.				Material: K30F	Description: X.treme PLUS 10 61 / 103
				Surface: DPL	
			Date	Name	Drawing-No.: 1A3389-5337085 D10
			Drawn 01.04.11	Titex	
			Checked		
			WALTER TITEX		Ord.-Code: A3389DPL-10
Rev.	Revision	Date	Name	Cust. No.:	