

X.treme M

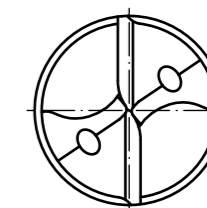

10:1

Characteristics:	
No. of flutes	2
Direction of cut	right
Standard	TITEX Std.
Shank	DIN 6535-HA 3
Type of tool	X.treme DM

Qty.	Description	Det.	Dwg. No.	Material
Proprietary Information DIN ISO 16016:2002-5 We reserve all Rights to this drawing including for the purpose of issuing patents and registration of petty patents. Without our written consent this drawing may not be copied, whole or partially, and may not be misused by the recipient as well as third parties. Any infraction will result in compensation for occurred damages and could lead to legal action by the author.				Scale: 2:1 Format: A3
				Material: K30F Surface: AMP
				Description: X.treme DM16 2.5 49 / 87
				Drawing-No.: 1A6689-6354001 D10
				Ord.-Code: A6689AMP-2.5
Rev.	Revision	Date	Name	Cust. No.:

