

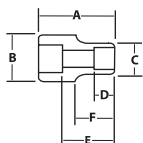

## 1/2" DRIVE SHALLOW SOCKETS, 12 POINT, METRIC

### High-Polished Chrome Finish



STM-1229

STM-1212



MSS-15RC



MSS-15SRC



MSS-24RC

Product Code	Size (MM)	Dimensions						
		A (Inches)	B Drive End Diameter (Inches)	C Working End Diameter (Inches)	D Broach Depth (Inches)	E Bolt Clearance Depth (Inches)	F Bolt Clearance Diameter (Inches)	Nose Length (Inches)
STM-1210	10	1 1/2	29/32	19/32	5/16	7/8	11/32	23/32
STM-1211	11	1 1/2	29/32	11/16	9/16	7/8	13/32	23/32
STM-1212	12	1 1/2	29/32	29/32	13/32	7/8	7/16	23/32
STM-1213	13	1 1/2	29/32	29/32	3/8	7/8	15/32	23/32
STM-1214	14	1 1/2	29/32	27/32	3/8	7/8	15/32	23/32
STM-1215	15	1 1/2	29/32	7/8	3/8	7/8	15/32	-
STM-1216	16	1 1/2	29/32	29/32	9/16	7/8	15/32	-
STM-1217	17	1 1/2	31/32	31/32	9/16	7/8	15/32	-
STM-1218	18	1 1/2	1	1	13/16	27/32	15/32	-
STM-1219	19	1 1/2	1 1/32	1 1/32	13/16	27/32	23/32	-
STM-1220	20	1 1/2	1 1/16	1 1/16	13/16	27/32	23/32	-
STM-1221	21	1 1/2	1 1/8	1 1/8	13/16	27/32	3/4	-
STM-1222	22	1 1/2	1 3/16	1 3/16	13/16	27/32	25/32	-
STM-1223	23	1 1/2	1 1/4	1 1/4	25/32	13/16	27/32	-
STM-1224	24	1 17/32	1 9/32	1 9/32	13/16	27/32	7/8	-
STM-1225	25	1 3/16	1 5/16	1 5/16	13/16	7/8	15/16	-
STM-1226	26	1 5/8	1 3/8	1 3/8	29/32	15/16	31/32	-
STM-1227	27	1 23/32	1 7/16	1 7/16	31/32	1	1	-
STM-1228	28	1 3/4	1 1/2	1 1/2	1	1 1/16	1 1/32	-
STM-1229	29	1 3/4	1 9/16	1 9/16	1 1/32	1 1/16	1 1/16	-
STM-1230	30	1 3/4	1 5/8	1 5/8	1 1/32	1 1/32	1 3/32	-
STM-1232	32	1 7/8	1 11/16	1 11/16	1 1/8	1 5/32	1 3/16	-
STM-1234	34	2 1/16	1 3/4	1 3/4	7/8	1 7/16	1	-
STM-1236	36	2 1/16	1 15/16	1 15/16	7/8	1 7/16	1 13/32	-

Fed. Spec: ANSI B107.110

### MSS-15RC 15 Piece 1/2" Drive Shallow 12 Point Socket Set on Clip Rail

#### Contents Include:

Product Code	Size (MM)	Product Code	Size (MM)	Product Code	Size (MM)	Product Code	Size (MM)
STM-1210	10	STM-1214	14	STM-1218	18	STM-1222	22
STM-1211	11	STM-1215	15	STM-1219	19	STM-1223	23
STM-1212	12	STM-1216	16	STM-1220	20	STM-1224	24
STM-1213	13	STM-1217	17	STM-1221	21		

### MSS-15SRC 15 Piece 1/2" Drive Shallow 12 Point Socket Set on Clip Rail

#### Contents Include:

Product Code	Size (MM)	Product Code	Size (MM)	Product Code	Size (MM)	Product Code	Size (MM)
STM-1210	10	STM-1217	17	STM-1222	22	STM-1227	27
STM-1213	13	STM-1218	18	STM-1223	23	STM-1230	30
STM-1214	14	STM-1219	19	STM-1224	24	STM-1232	32
STM-1215	15	STM-1220	20	STM-1226	26		

### MSS-24RC 24 Piece 1/2" Drive Shallow 12 Point Socket Set on Clip Rail

#### Contents Include:

Product Code	Size (MM)	Product Code	Size (MM)	Product Code	Size (MM)	Product Code	Size (MM)
STM-1210	10	STM-1216	16	STM-1222	22	STM-1228	28
STM-1211	11	STM-1217	17	STM-1223	23	STM-1229	29
STM-1212	12	STM-1218	18	STM-1224	24	STM-1230	30
STM-1213	13	STM-1219	19	STM-1225	25	STM-1232	32
STM-1214	14	STM-1220	20	STM-1226	26	STM-1234	34
STM-1215	15	STM-1221	21	STM-1227	27	STM-1236	36

#### Features

- SUPERTORQUE® lobular openings for greater turning power without deforming the fastener.
- Designed for quick engagement on both 6 and 12 point fasteners.



1/2" DRIVE

SOCKETS AND DRIVE TOOLS